



CUSHMAN &
WAKEFIELD



47,953 RSF FOR SUBLEASE

101 WEST COLFAX AVENUE
SUITE 500
DENVER, COLORADO 80202

**SPECTACULAR SUBLEASE
IMMEDIATELY AVAILABLE
FULLY FURNISHED**

**SUBLEASE RATE
\$19/SF GROSS**

PROPERTY DETAILS

Spectacular sublease available immediately that is fully furnished and perfectly laid out for social distancing. Great mountain views as well as vistas overlooking Civic Center Park and the State Capitol. 2 Sizeable outdoor balconies, 143 8x8 workstations that are 6 ft tall, 10 ft. high ceilings throughout, 28 fully furnished offices, 7 fully furnished conference rooms of various sizes that accommodate from 4 people to 30 people, outstanding kitchen area that is completely furnished with an outdoor balcony. Excellent credit sublessor.

**TERM
THROUGH
3/31/23**





PROPERTY INFORMATION

Available	Suite 500: 47,953 RSF
Building Size	320,463 SF
Class	A
Year Built	2006
Stories	11
Parking	12 Spaces
Building Amenities	<ul style="list-style-type: none">• Lunch room• Yoga room• Fitness center• Private balconies• 231 Seat auditorium

AREA AMENITIES

Denver International Airport	29 Minute drive time 26.9 Miles
Transit / Light Rail	16th and California (D, F, H lines) 5 Minute walk Convention Center-Performing Arts 7 Minute walk Civic Center Bus Station & 16th Street Mall Shuttle / 1 Minute walk
Energy Efficiency	This building was awarded the Energy Star rating in 2007-2011 for operating efficiency



CUSHMAN &
WAKEFIELD



SUITE 500 - 47,953 RSF

Outdoor balcony

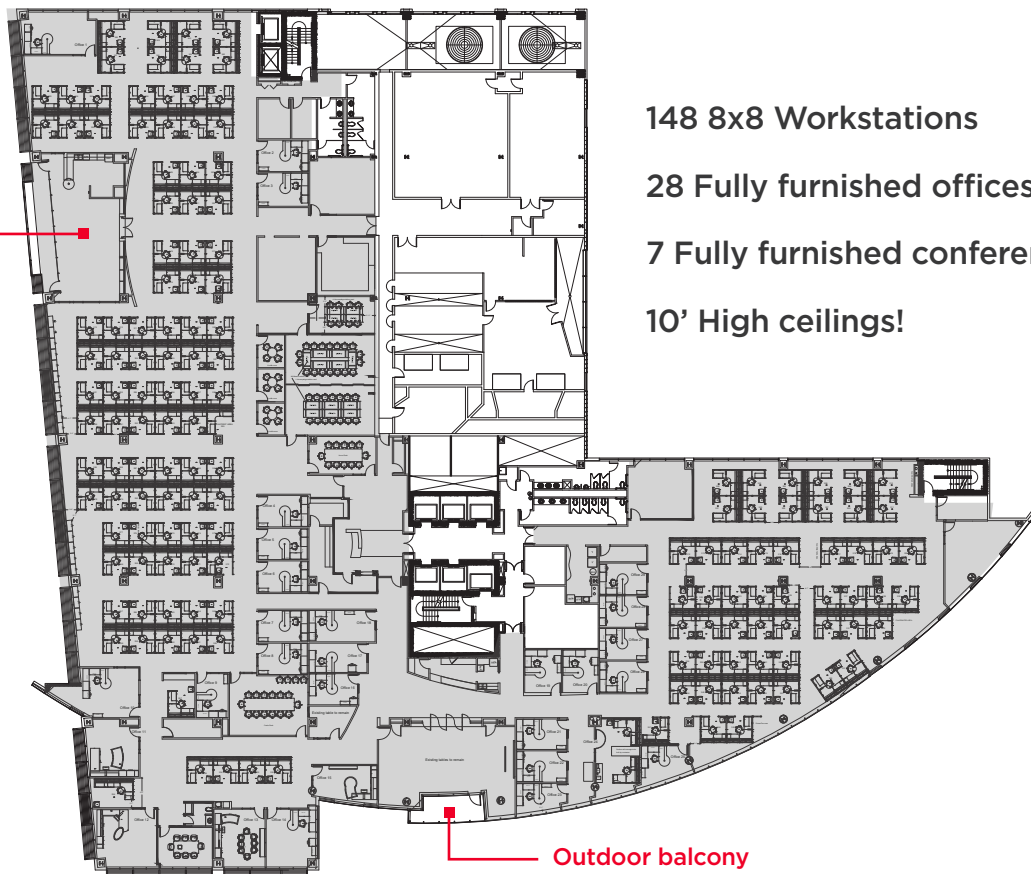

148 8x8 Workstations

28 Fully furnished offices

7 Fully furnished conference rooms

10' High ceilings!

Outdoor balcony



FOR SUBLEASE 101 WEST COFAX AVENUE

SUITE 500
DENVER, COLORADO 80202

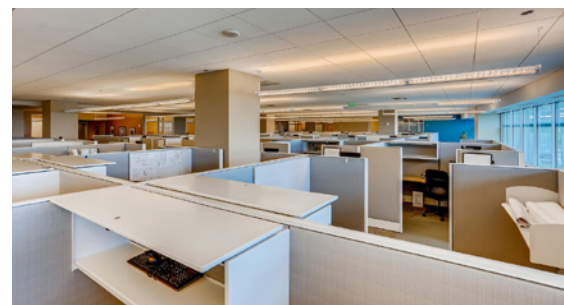
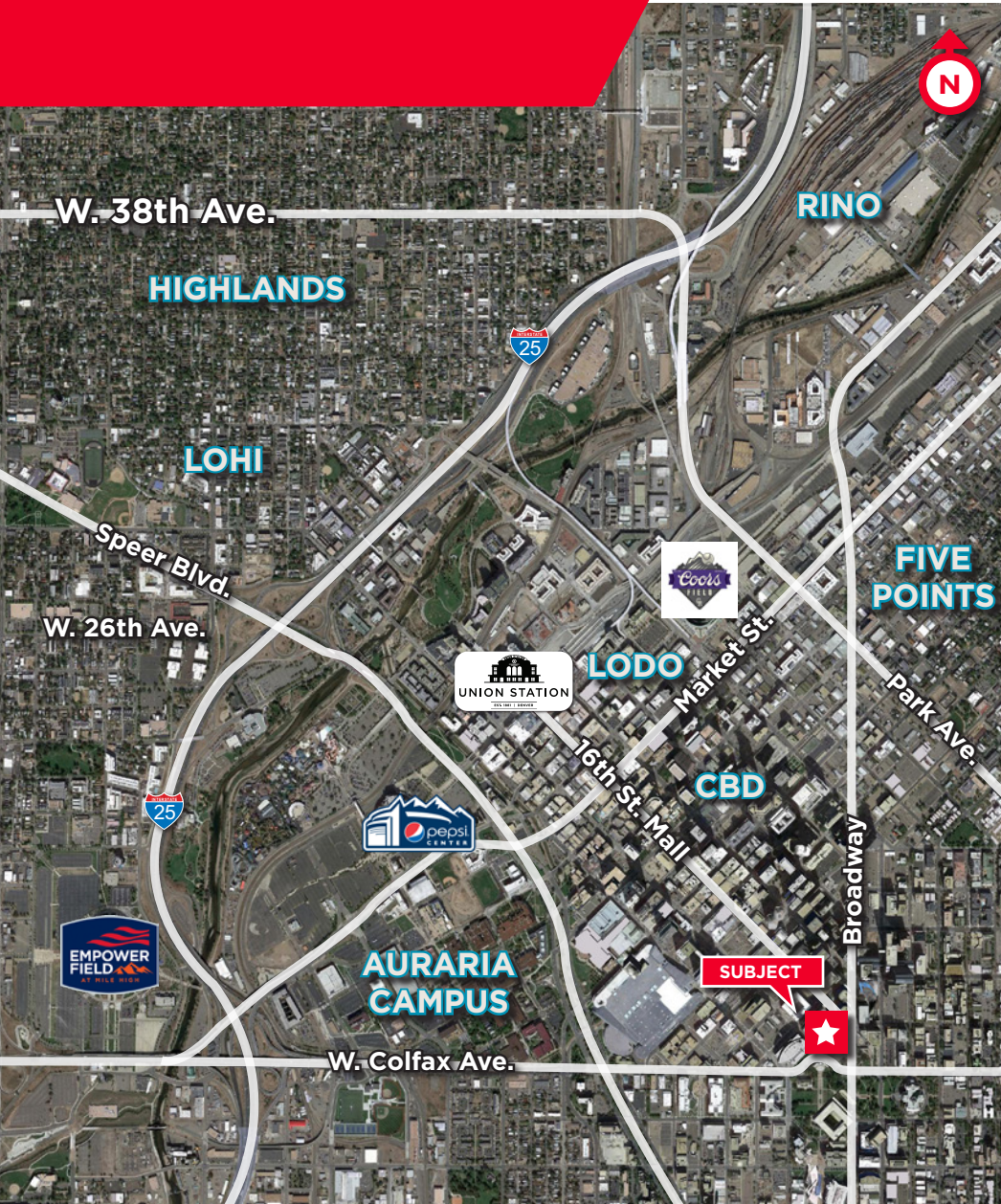

For more information, please contact:

Doug Wulf
Executive Managing Director
+1 303 312 4218
doug.wulf@cushwake.com

Dan Miller
Managing Director
+1 303 312 4272
dan.miller@cushwake.com

Andrew McCabe
Director
+1 303 312 4253
andrew.mccabe@cushwake.com

1401 Lawrence Street, Suite 1100
Denver, Colorado 80202
T +1 303 292 3700
F +1 303 534 8270
cushmanwakefield.com

© 2020 Cushman & Wakefield. All rights reserved. The information contained in this communication is strictly confidential. This information has been obtained from sources believed to be reliable but has not been verified. NO WARRANTY OR REPRESENTATION, EXPRESS OR IMPLIED, IS MADE AS TO THE CONDITION OF THE PROPERTY (OR PROPERTIES) REFERENCED HEREIN OR AS TO THE ACCURACY OR COMPLETENESS OF THE INFORMATION CONTAINED HEREIN, AND SAME IS SUBMITTED SUBJECT TO ERRORS, OMISSIONS, CHANGE OF PRICE, RENTAL OR OTHER CONDITIONS, WITHDRAWAL WITHOUT NOTICE, AND TO ANY SPECIAL LISTING CONDITIONS IMPOSED BY THE PROPERTY OWNER(S). ANY PROJECTIONS, OPINIONS OR ESTIMATES ARE SUBJECT TO UNCERTAINTY AND DO NOT SIGNIFY CURRENT OR FUTURE PROPERTY PERFORMANCE.