

Class “A” Professional & Medical Space For Lease

1055 Parsippany Boulevard | Parsippany, NJ

AVAILABILITIES:

- » 1,052 RSF up to 13,964 SF
- » Suite 308 will be available January 2026

KEY HIGHLIGHTS

- » **Location:** 1055 Parsippany Boulevard, Parsippany, NJ
- » **Building Type:** Premier Five-Story Class “A” office building in Parsippany, New Jersey (Morris County).
- » **Size & Space:** The building covers 86,160 square feet and offers a variety of office sizes and configurations, including some move-in-ready options.
- » **Ideal Users:** Suitable for professional and medical office users.
- » **Recent Renovations:** Upgrades include a renovated atrium lobby, common corridors, interior lighting, restrooms, and a new on-site café with a Micro Mart.
- » **Tenant Amenities:** Features include ample surface parking, 24-hour building access, conferencing facilities, and janitorial services.
- » **Accessibility:** Conveniently located with access to I-80 and I-287, and excellent public transportation options.

ASKING RENT:

- » Call for Pricing



Matt Miller

SVP, INVESTMENT SALES & LEASING

C | 908.770.0686

Matt@legacyrealtynj.com

Logan Gurtman

VP, INVESTMENT SALES

C | 908.692.9890

Logan@legacyrealtynj.com

Seth Katz

BROKER OF RECORD / CEO

C | 908.770.7111

Seth@legacyrealtynj.com

AERIAL VIEW



REGIONAL MAP

**1055 PARSIPPANY BOULEVARD
PARSIPPANY, NJ**

25 MILES

5-Mile

MANHATTAN

1055 PARSIPPANY BOULEVARD, PARSIPPANY, NJ

3

LEGACY
Commercial Realty, LLC

**1055 PARSIPPANY BOULEVARD
PARSIPPANY, NJ**

25 MILES

5-Mile

MANHATTAN

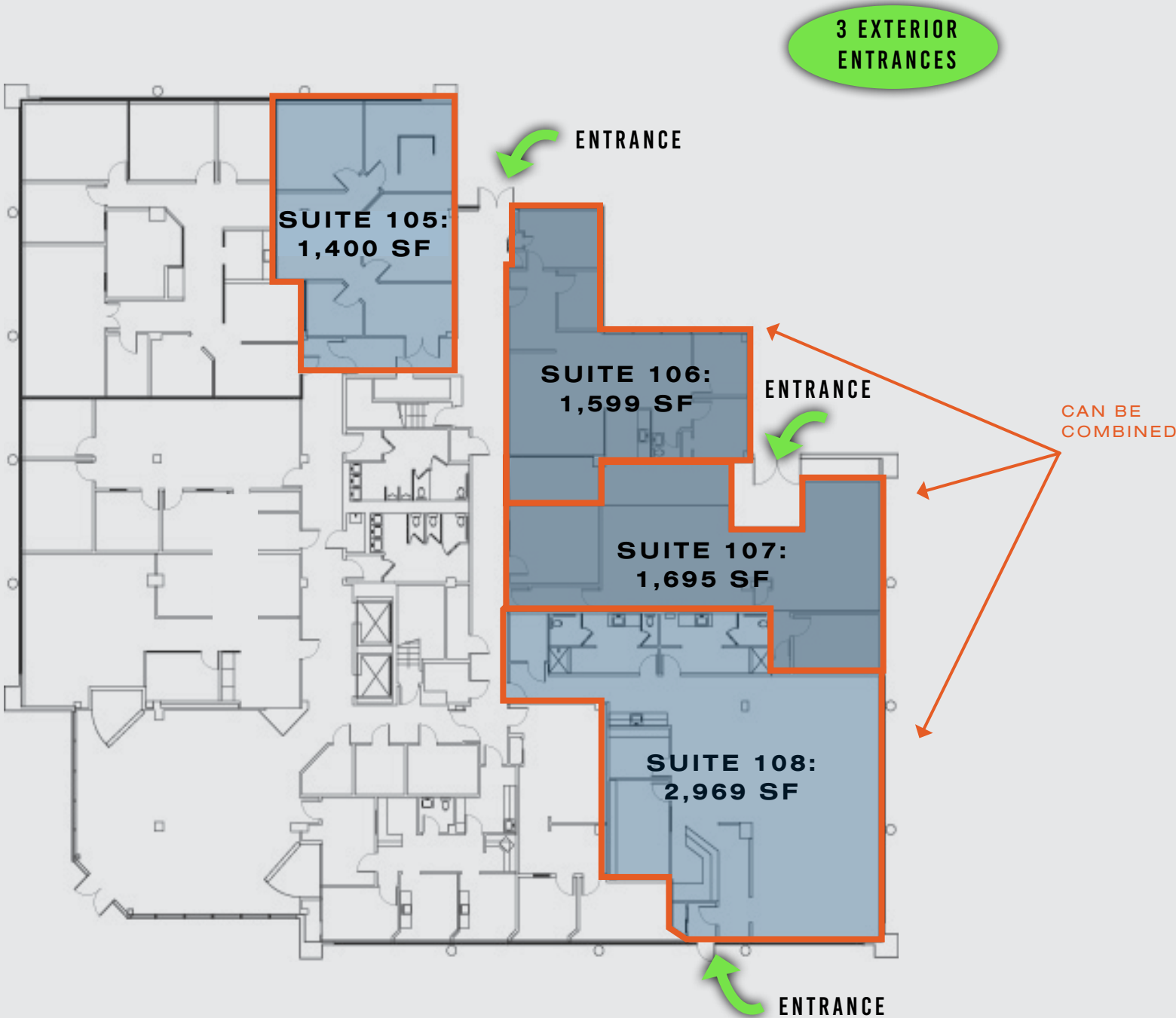

FLOOR PLAN - 2ND FLOOR

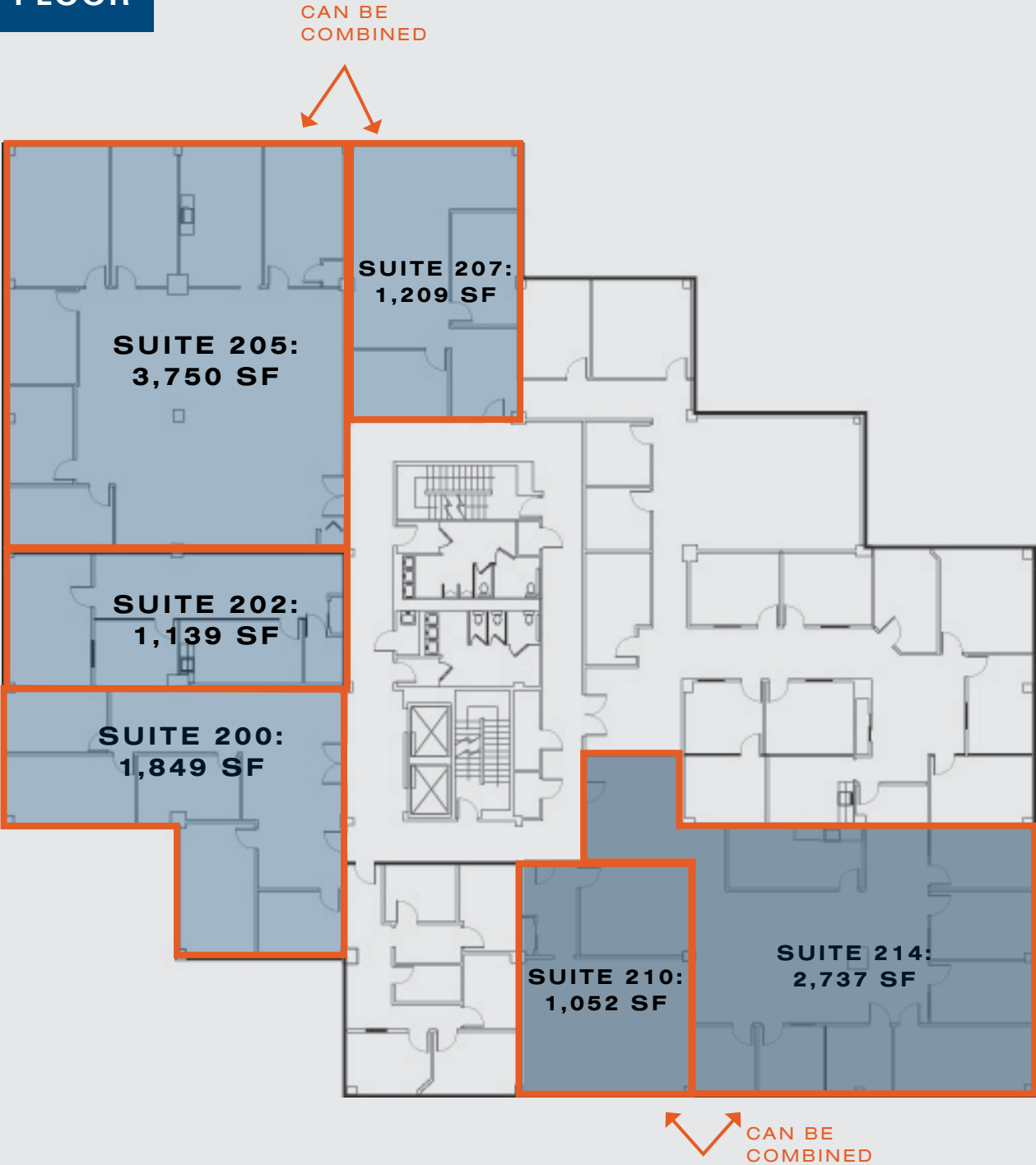

FLOOR PLAN - 3RD FLOOR

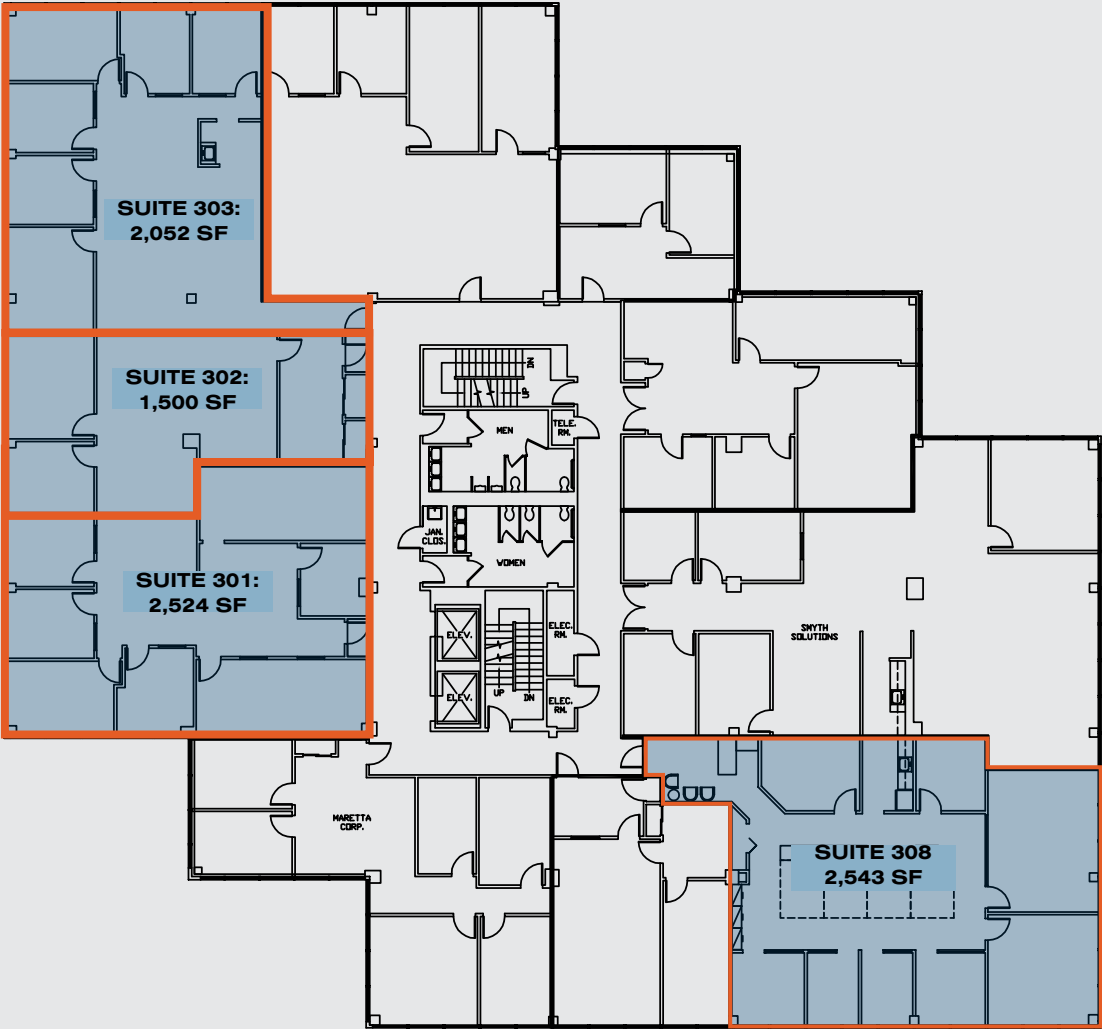

3RD FLOOR PLAN

0' 5' 10' 15' 20' 25' 30'

1055 PARSIPPANY BLVD.
PARSIPPANY, N.J.
3RD FLOOR PLAN
SCALE: 1/8" = 1'-0" DATE: 07/11/2012

FLOOR PLAN - 4TH FLOOR

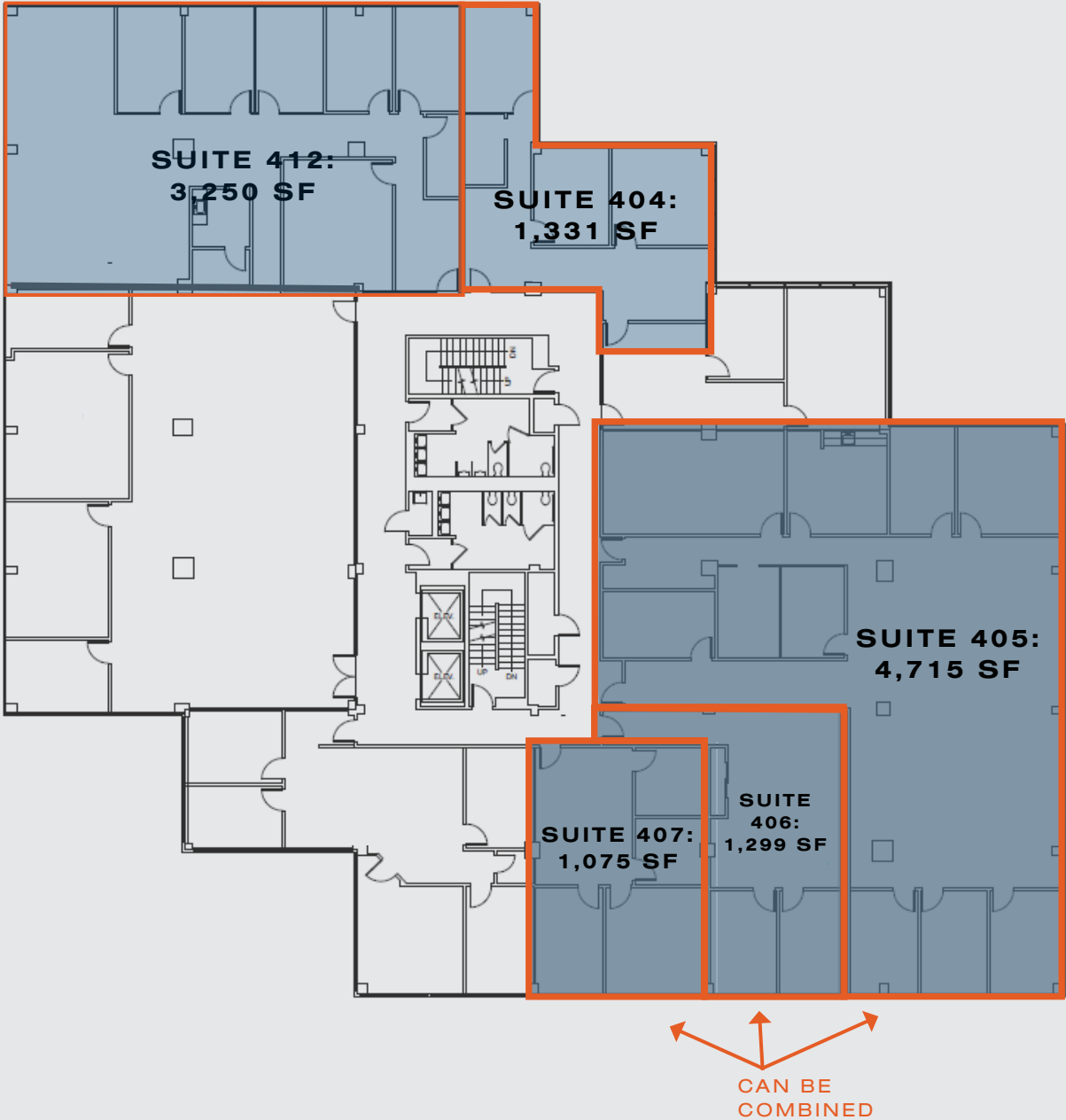

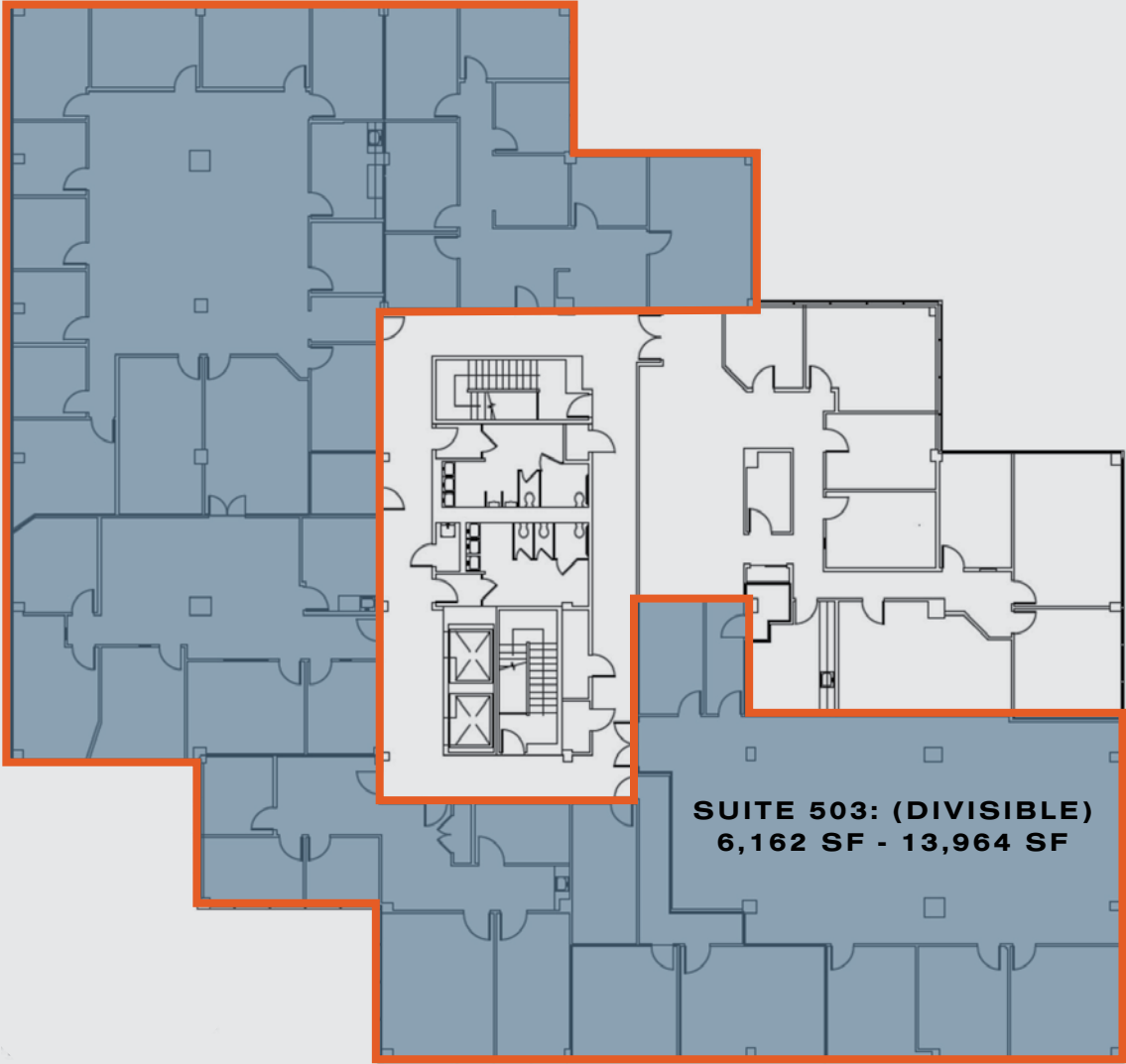

INTERIOR PHOTOGRAPHY



EXTERIOR PHOTOGRAPHY



1055 PARSIPPANY BOULEVARD, PARSIPPANY, NJ