

**SALE PRICE** Contact Broker  
**LEASE RATE** Contact Broker

**WEIGAND**  
COMMERCIAL



# KECHI OFFICE/WAREHOUSE

FOR SALE/LEASE 812 Venture Ct., Kechi, KS 67067

**SITE SIZE**  
15,982.2 SF (0.37 A)

**BUILDING SIZE**  
7,920 SF±

**TOTAL AVAILABLE SF**  
7,920 SF±

**ZONING**  
C-3, HEAVY COMMERCIAL

**CEILING HEIGHT**  
18'

**YEAR BUILT**  
2023

**CONSTRUCTION**  
STEEL

**OVERHEAD DOORS**  
1 - 14' X 12'

**2024 TAXES**  
GENERALS: \$11,456.35 SPECIALS: \$3,124.28

## PROPERTY HIGHLIGHTS

- Free-standing office/warehouse available for purchase or lease in Kechi, KS.
- Office area – finish-to-suit.
- Located in close proximity to K-254.

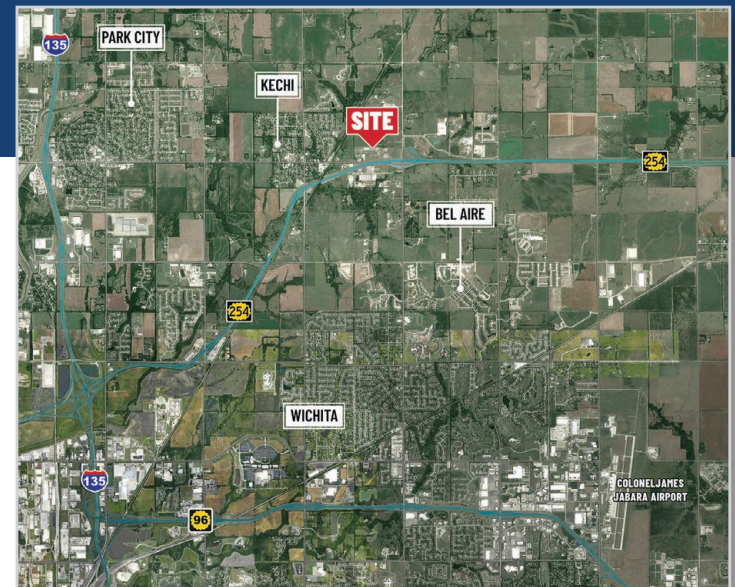

Grant Tidemann, SIOR  
316-292-3908  
tidemann@weigand.com

Bradley Tidemann, SIOR  
316-650-8853  
bradley@tidemannre.com



## PROJECTED FLOOR PLAN

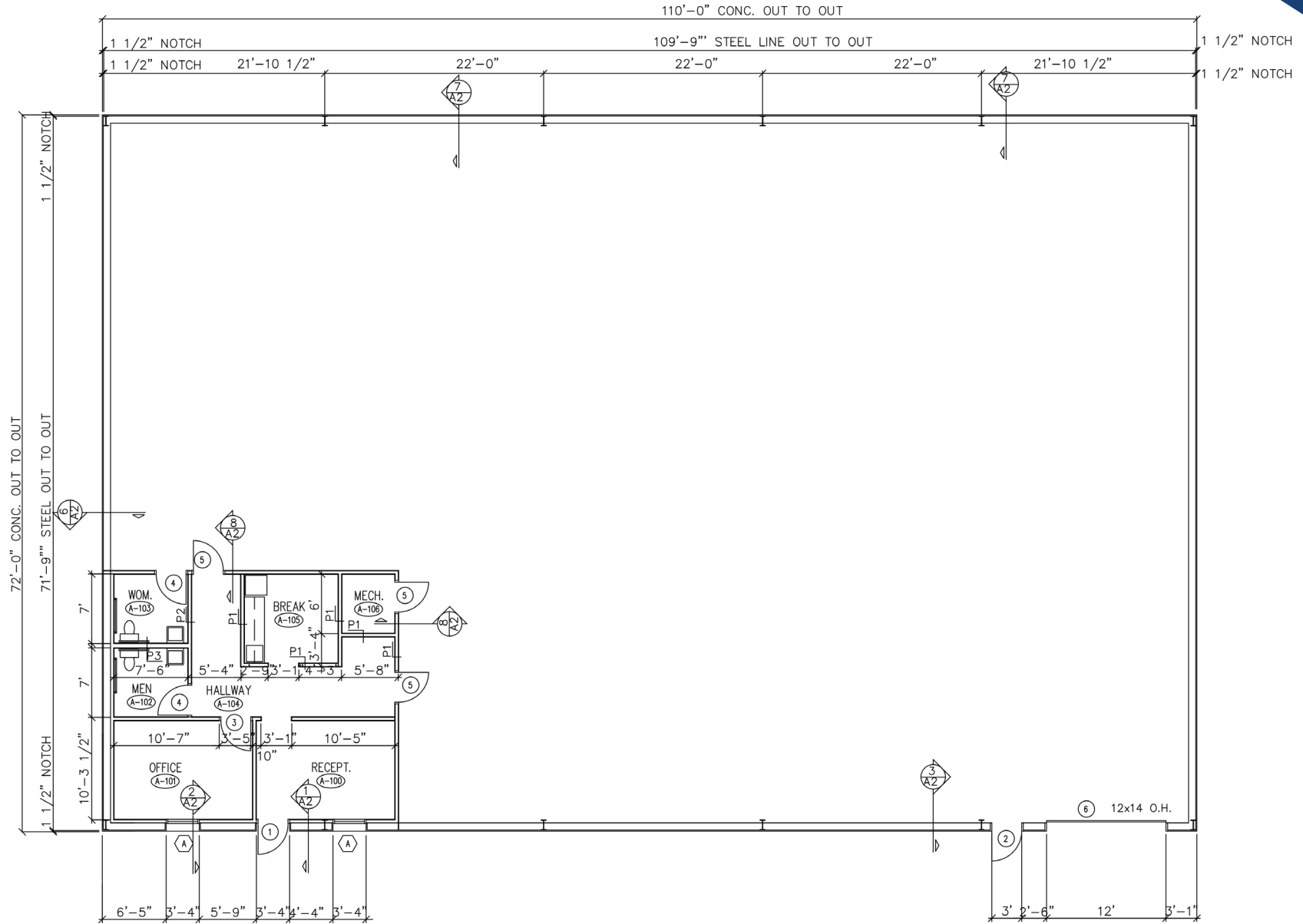



# KECHI BUSINESS PARK ADDITION

FOR SALE 812 Venture Ct. | Kechi, KS 67067

**WEIGAND**  
COMMERCIAL

## AERIAL VIEW



All information furnished regarding property for sale, lease, exchange or financing is from sources deemed reliable but no guarantee is made or responsibility assumed as to its accuracy or completeness and you are advised to make your own analysis and verification.  
Agent hereby notifies prospective buyer/lessee that (a) Agent will be acting as a designated agent of seller/lessor with the duty to represent seller/lessor's interest; and (b) Information given to Agent will be disclosed to seller/lessor.



Grant Tidemann, SIOR  
316-292-3908  
tidemann@weigand.com

Bradley Tidemann, SIOR  
316-650-8853  
bradley@tidemannre.com

