

# FOR LEASE

1,710 SF | \$2.25/SF/MO. NNN

## DISTRICT 2 WEST West Side Flex Space

2783 NW Lolo Dr., Suite 120, Bend, OR 97703



### PROPERTY DETAILS

<b>Suite 120:</b>	1,710 SF
<b>Lease Rate:</b>	\$2.25/SF/Mo. NNN
<b>NNNs:</b>	Est. at \$0.55/SF/Mo. <i>(suite is separately metered for gas and electricity)</i>
<b>Zoning:</b>	Light Industrial (IL)
<b>Parking:</b>	61 onsite shared spaces

### HIGHLIGHTS

- Campus setting ideal for innovative tech companies and light industrial tenants
- Suite features a glass roll-up door for natural light
- Close to NorthWest Crossing restaurants, shops, schools and businesses
- Near Phil's Trail Complex and Shevlin Park
- Join Luno Life, Argonaut Cycles, Rezolute Bio, AKS Engineering & Forestry, Rise Fitness, Revolvrr and Sparrow Bakery

**Bruce Churchill, Principal Broker**  
**Jay Lyons, SIOR, CCIM | Grant Schultz, SIOR, CCIM**  
600 SW Columbia St., Ste. 6100 | Bend, OR 97702  
**541.383.2444** | [www.CompassCommercial.com](http://www.CompassCommercial.com)

**COMPASS**  
COMMERCIAL

**REAL  
ESTATE  
SERVICES**



# FOR LEASE

1,710 SF | \$2.25/SF/MO. NNN

## DISTRICT 2 WEST West Side Flex Space

2783 NW Lolo Dr., Suite 120, Bend, OR 97703

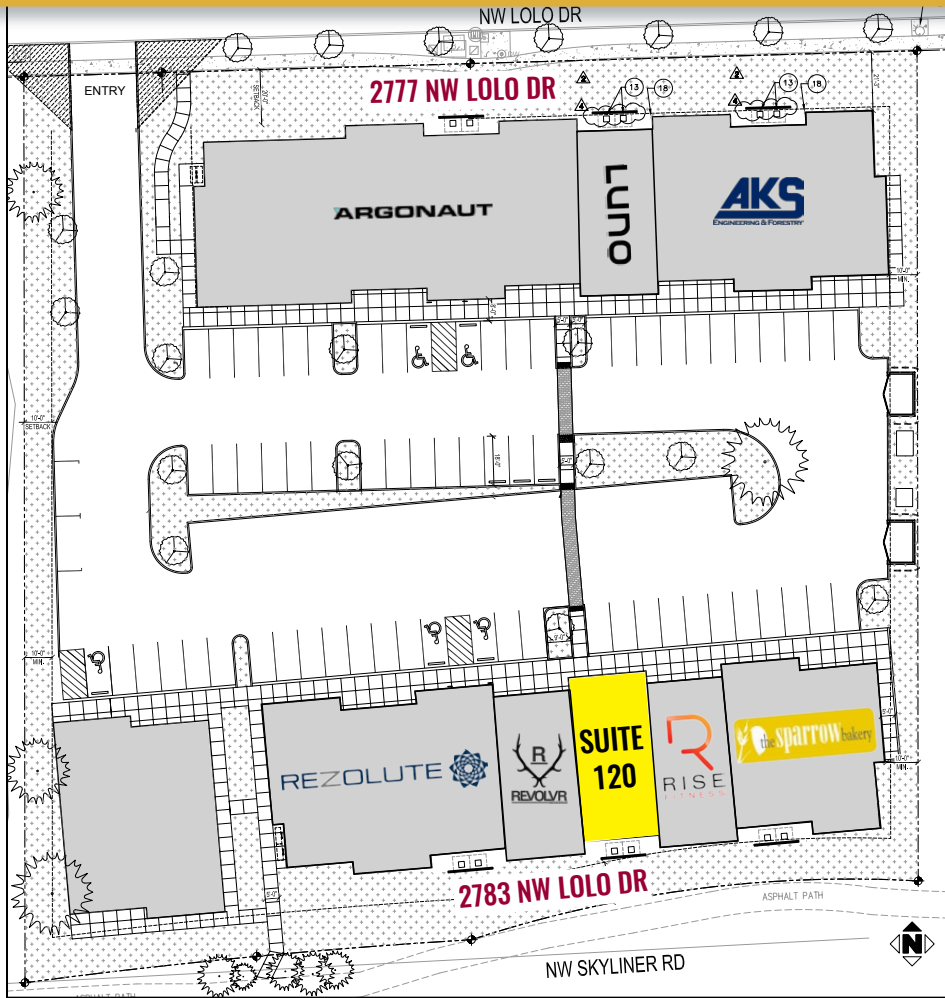

Brokers are licensed in the state of Oregon. This information has been furnished from sources we deem reliable, but for which we assume no liability. This is an exclusive listing. The information contained herein is given in confidence with the understanding that all negotiations pertaining to this property be handled through Compass Commercial Real Estate Services. All measurements are approximate.



**Bruce Churchill**

Principal Broker

Cell 541.280.7560

bchurchill@compasscommercial.com



**Jay Lyons, SIOR, CCIM**

Partner, Principal Broker

Cell 541.410.6519

jlyons@compasscommercial.com



**Grant Schultz, SIOR, CCIM**

Broker

Cell 541.480.9873

gschultz@compasscommercial.com

**COMPASS COMMERCIAL**

**REAL ESTATE SERVICES**