

Available For Lease  
**47,165 SF**  
Corporate HQ

# 14300 Arminta Street

Van Nuys, CA 91402

**47,165 Sq. Ft.**

## Property Highlights

- CORPORATE HEADQUARTERS FACILITY IN MASTER PLANNED BUSINESS PARK
- SHOWROOM/OFFICE WITH GLASS, MARBLE, GRANITE UPGRADES
- RETAIL AMENITIES
- 28' CLEAR HEIGHT
- DOCK HIGH AND GROUND LEVEL LOADING
- LIGHTING: T-5'S WITH SENSORS IN WAREHOUSE
- SIGNAGE - MONUMENT SIGN AVAILABILITY



For more information:

**Chris Jackson**  
CEO  
818 933 2368  
cjackson@naicapital.com  
DRE License #01255538

**Todd Lorber**  
Executive Vice President  
818 933 2376  
tlorber@naicapital.com  
DRE License #01014637

15821 Ventura Blvd.  
Suite 320  
Encino, CA 91436  
[naicapital.com](http://naicapital.com)

No warranty, express or implied, is made as to the accuracy of the information contained herein. This information is submitted subject to errors, omissions, change of price, rental or other conditions, withdrawal without notice, and is subject to any special listing conditions imposed by our principals. Cooperating brokers, buyers, tenants and other parties who receive this document should not rely on it, but should use it as a starting point of analysis, and should independently confirm the accuracy of the information contained herein through a due diligence review of the books, records, files and documents that constitute reliable sources of the information described herein.



COMMERCIAL REAL ESTATE SERVICES, WORLDWIDE

14300 Arminta Street, Van Nuys, CA 91402

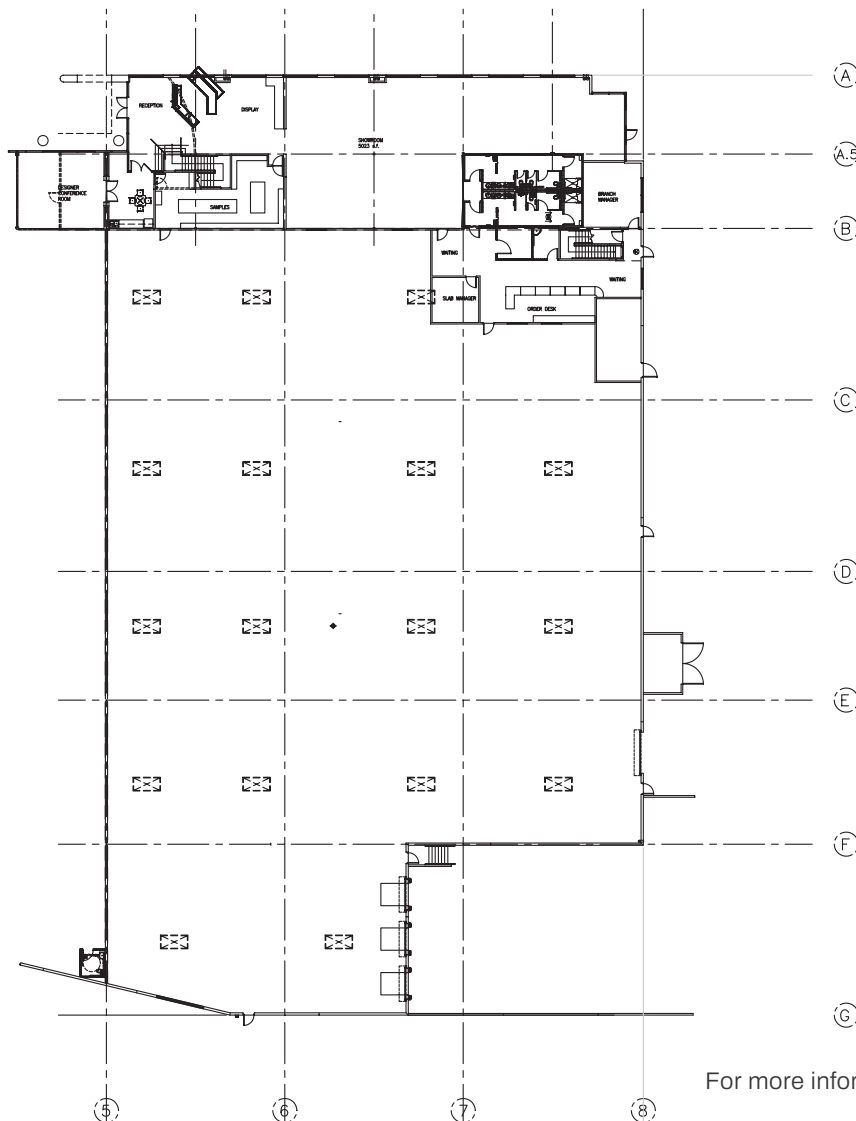

No warranty, express or implied, is made as to the accuracy of the information contained herein. This information is submitted subject to errors, omissions, change of price, rental or other conditions, withdrawal without notice, and is subject to any special listing conditions imposed by our principals. Cooperating brokers, buyers, tenants and other parties who receive this document should not rely on it, but should use it as a starting point of analysis, and should independently confirm the accuracy of the information contained herein through a due diligence review of the books, records, files and documents that constitute reliable sources of the information described herein.

For more information:

**Chris Jackson**  
CEO  
818 933 2368  
cjackson@naicapital.com  
DRE License #01255538

Available For Lease  
**47,165 SF**  
Corporate HQ

Asking Rate	\$1.95 NNN
Available SF:	47,165 SF
Const Status/Yr. Built:	2006
Region:	LA Northwest
Zoning:	M2
Ground Level Doors:	1
Dock High:	3
Sprinklered:	Yes, .45/3000
Roof Type:	LAM
Construction Type:	Concrete Tilt Up
Specific Use:	Light or Heavy
Industrial Lot Size/Acres:	Part of Larger
Heat/Cool:	Yes
Parking:	94
Thomas Guide:	532-A-3
Office SF / #:	14,800 Square Feet
Clear Height:	28'
Power:	A: 800 V: 240/480 0:3 W:4
Office Heat:	Yes
Office Air:	Yes
Rental Rate:	TBD

**Todd Lorber**  
Executive Vice President  
818 933 2376  
tlorber@naicapital.com  
DRE License #01014637

15821 Ventura Blvd.  
Suite 320  
Encino, CA 91436  
[naicapital.com](http://naicapital.com)



14300 Arminta Street, Van Nuys, CA 91402

Available For Lease  
**47,165 SF**  
Corporate HQ



For more information:

**Chris Jackson**  
CEO  
818 933 2368  
cjackson@naicapital.com  
DRE License #01255538

**Todd Lorber**  
Executive Vice President  
818 933 2376  
tlorber@naicapital.com  
DRE License #01014637

15821 Ventura Blvd.  
Suite 320  
Encino, CA 91436  
[naicapital.com](http://naicapital.com)

No warranty, express or implied, is made as to the accuracy of the information contained herein. This information is submitted subject to errors, omissions, change of price, rental or other conditions, withdrawal without notice, and is subject to any special listing conditions imposed by our principals. Cooperating brokers, buyers, tenants and other parties who receive this document should not rely on it, but should use it as a starting point of analysis, and should independently confirm the accuracy of the information contained herein through a due diligence review of the books, records, files and documents that constitute reliable sources of the information described herein.



14300 Arminta Street, Van Nuys, CA 91402

Available For Lease  
**47,165 SF**  
Corporate HQ

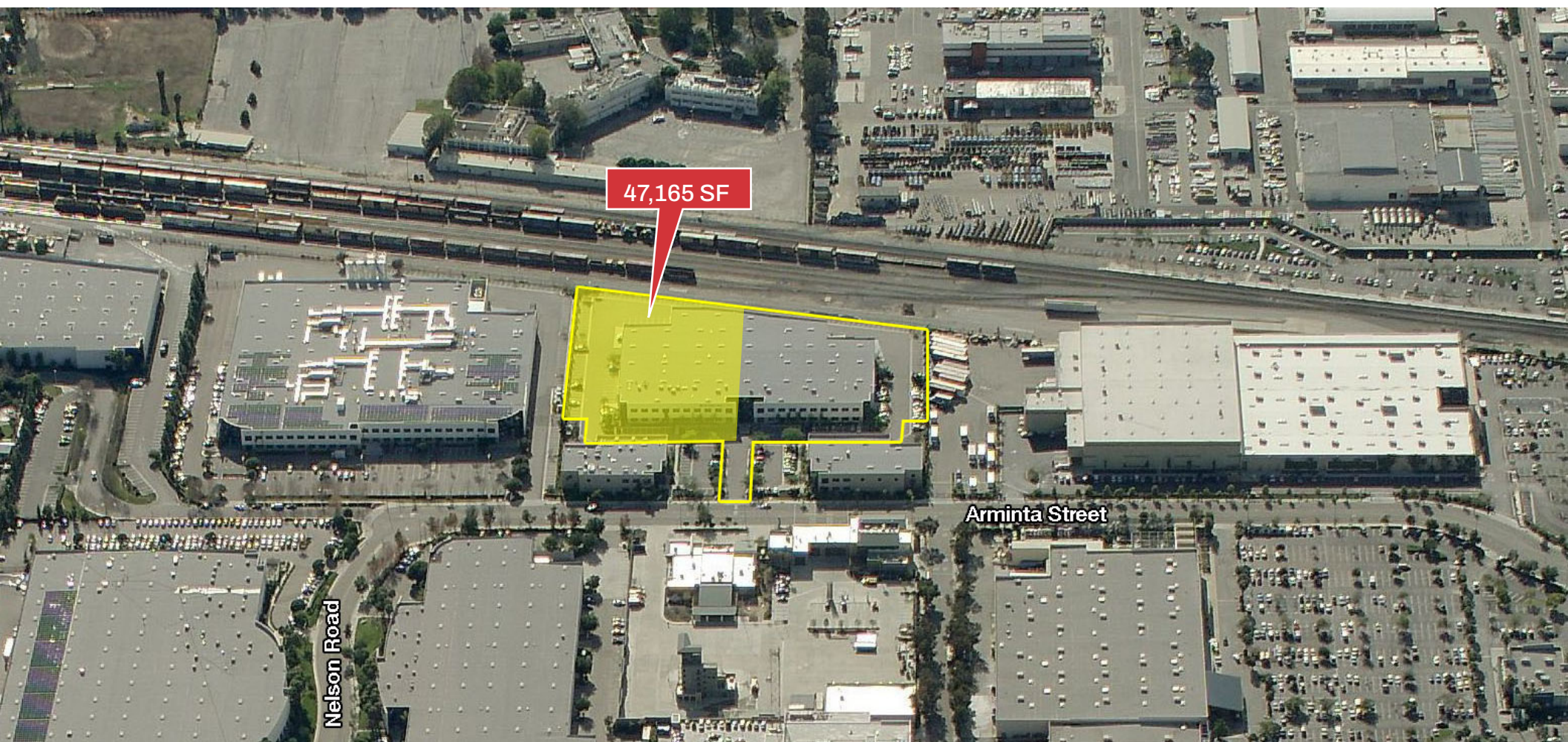

For more information:

**Chris Jackson**  
CEO  
818 933 2368  
cjackson@naicapital.com  
DRE License #01255538

**Todd Lorber**  
Executive Vice President  
818 933 2376  
tlorber@naicapital.com  
DRE License #01014637

15821 Ventura Blvd.  
Suite 320  
Encino, CA 91436  
[naicapital.com](http://naicapital.com)

No warranty, express or implied, is made as to the accuracy of the information contained herein. This information is submitted subject to errors, omissions, change of price, rental or other conditions, withdrawal without notice, and is subject to any special listing conditions imposed by our principals. Cooperating brokers, buyers, tenants and other parties who receive this document should not rely on it, but should use it as a starting point of analysis, and should independently confirm the accuracy of the information contained herein through a due diligence review of the books, records, files and documents that constitute reliable sources of the information described herein.



14300 Arminta Street, Van Nuys, CA 91402

Available For Lease  
**47,165 SF**  
Corporate HQ

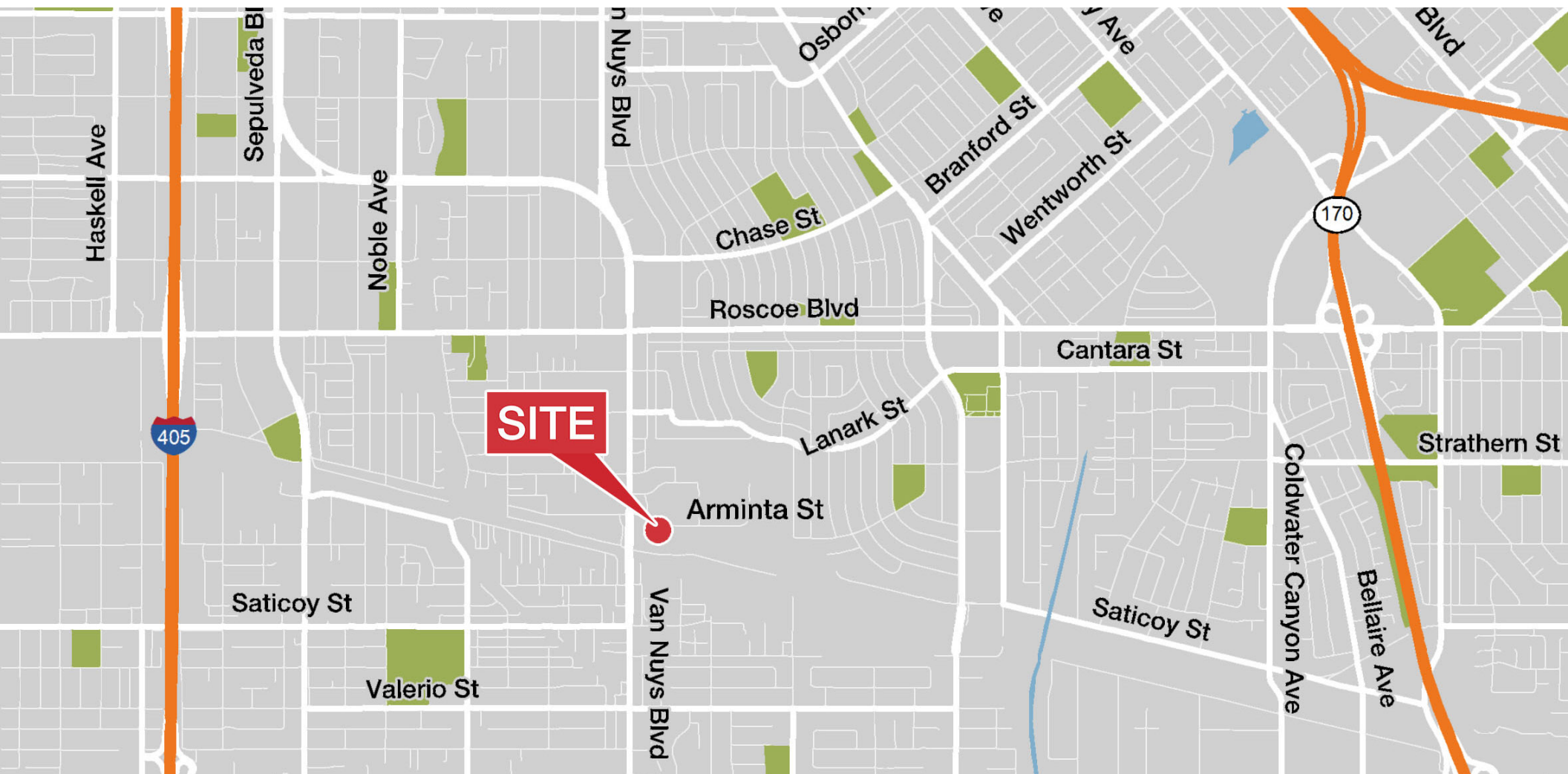

For more information:

**Chris Jackson**  
CEO  
818 933 2368  
cjackson@naicapital.com  
DRE License #01255538

**Todd Lorber**  
Executive Vice President  
818 933 2376  
tlorber@naicapital.com  
DRE License #01014637

15821 Ventura Blvd.  
Suite 320  
Encino, CA 91436  
[naicapital.com](http://naicapital.com)

No warranty, express or implied, is made as to the accuracy of the information contained herein. This information is submitted subject to errors, omissions, change of price, rental or other conditions, withdrawal without notice, and is subject to any special listing conditions imposed by our principals. Cooperating brokers, buyers, tenants and other parties who receive this document should not rely on it, but should use it as a starting point of analysis, and should independently confirm the accuracy of the information contained herein through a due diligence review of the books, records, files and documents that constitute reliable sources of the information described herein.