



**CUSHMAN &
WAKEFIELD**



MFG Space for Sublease

**462-472
VISTA WAY, MILPITAS**

23,184-29,630 SF

PROPERTY HIGHLIGHTS

23,184 SF of
Manufacturing Space
for Sublease

Heavy Power Available

16' - 18' Clear Heights

23,184 SF available for sublease with 6,446 SF also available for expansion for total of 29,630 SF.

Two (2) Docks and
Two (2) Grade Doors

3.1/1000 parking,
±71 spaces

Master Lease
Expiration: 12/31/2031



SITE PLAN

23,184 SF available for sublease with 6,446 SF
also available for expansion for total of 29,630 SF

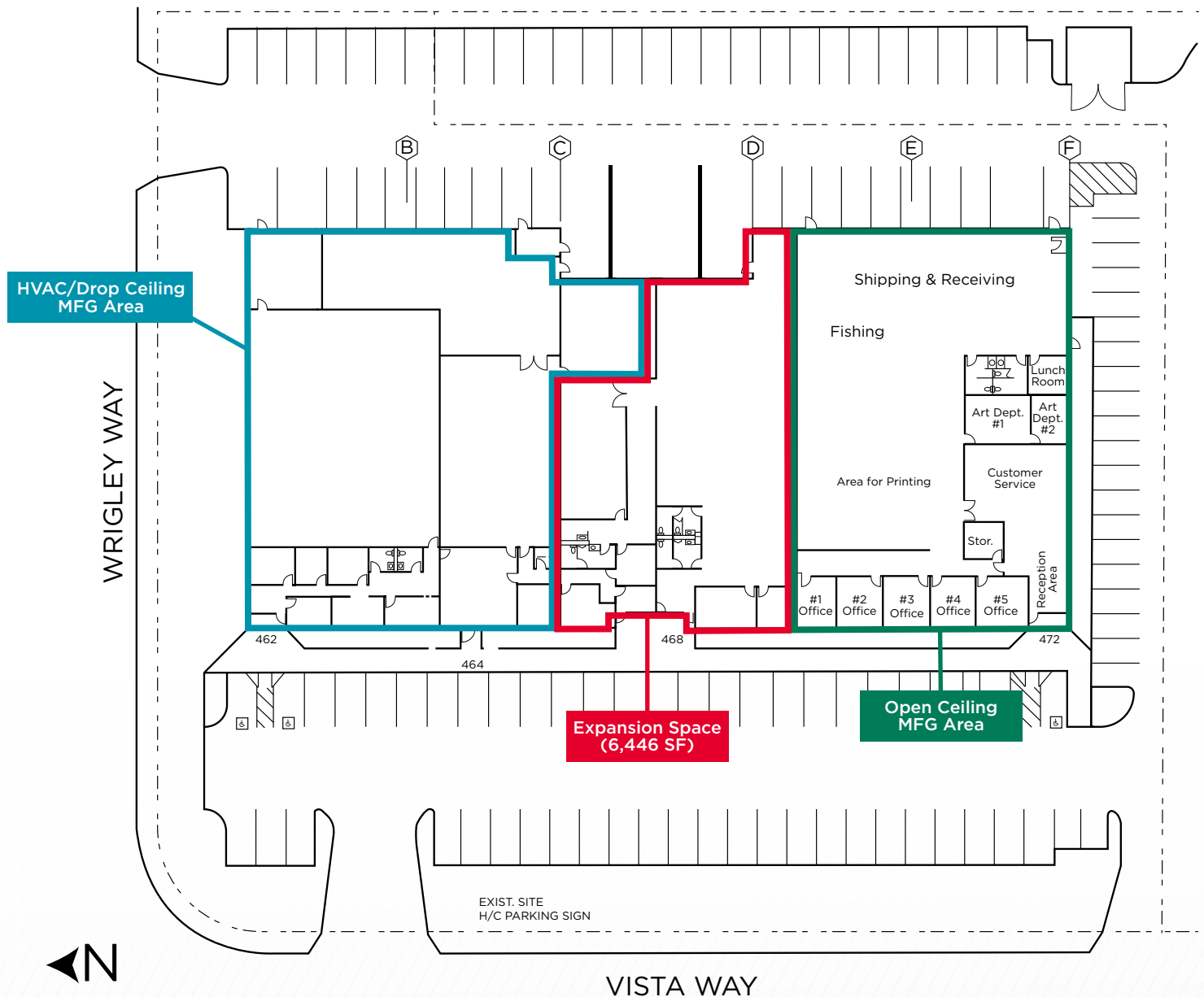



CONTACT

JEFF POWERS
Managing Director
+1 510 891 5821
jeff.powers@cushwake.com

MICHAEL KARP
Managing Director
+1 510 813 0113
michael.karp@cushwake.com

©2025 Cushman & Wakefield. All rights reserved. The material in this presentation has been prepared solely for information purposes, and is strictly confidential. Any disclosure, use, copying or circulation of this presentation (or the information contained within it) is strictly prohibited, unless you have obtained Cushman & Wakefield's prior written consent. The views expressed in this presentation are the views of the author and do not necessarily reflect the views of Cushman & Wakefield. Neither this presentation nor any part of it shall form the basis of, or be relied upon in connection with any offer, or act as an inducement to enter into any contract or commitment whatsoever. NO REPRESENTATION OR WARRANTY IS GIVEN, EXPRESS OR IMPLIED, AS TO THE ACCURACY OF THE INFORMATION CONTAINED WITHIN THIS PRESENTATION, AND CUSHMAN & WAKEFIELD IS UNDER NO OBLIGATION TO SUBSEQUENTLY CORRECT IT IN THE EVENT OF ERRORS.



**CUSHMAN &
WAKEFIELD**