

**AVISON
YOUNG**

3381 Steeles Ave E

Markham, ON
Office Sublease

17,602 sf
available for
sublease



Stan Krawitz
Principal, Broker
+1 416 822 9636
stan.krawitz@avisonyoung.com

Paul Kay
Principal, Sales Representative
+1 416 799 4455
paul.kay@avisonyoung.com



Platinum
member

Avison Young Commercial Real Estate Services, LP, 222 Bay Street, Suite 2500, Toronto, ON M5K 1J5 +1 416 955 0000

© 2023, Avison Young. Information contained herein was obtained from sources deemed reliable and, while thought to be correct, have not been verified. Avison Young does not guarantee the accuracy or completeness of the information presented, nor assumes any responsibility or liability for any errors or omissions therein.



Details



Sublease Space
17,602 sf
+ 1,541 sf shared



Asking Rent
To Be Negotiated



Additional Rent
\$20.09 psf



Sublease Term
July 30, 2029



Occupancy
Immediate

Highlights

Opportunity

- Premises are built-out with 17 offices, 4 conference rooms, 2 meeting rooms, 93 workstations, copy room, kitchenette, storage room and private washrooms
- Bright space with floor to ceiling windows providing incredible views
- Immediate access to Hwy 404 via Steeles Avenue East and convenient TTC bus routes and nearby GO transit

CAMPUS BOASTS STATE-OF-THE-ART TECHNOLOGICAL ADVANCEMENTS AND ABUNDANT QUALITY AMENITIES.

3381 STEELES AVENUE EAST SERVICES TENANTS WITH RESTAURANTS, FITNESS ROOM, CAR SERVICES AND SPORTS/ RECREATION.

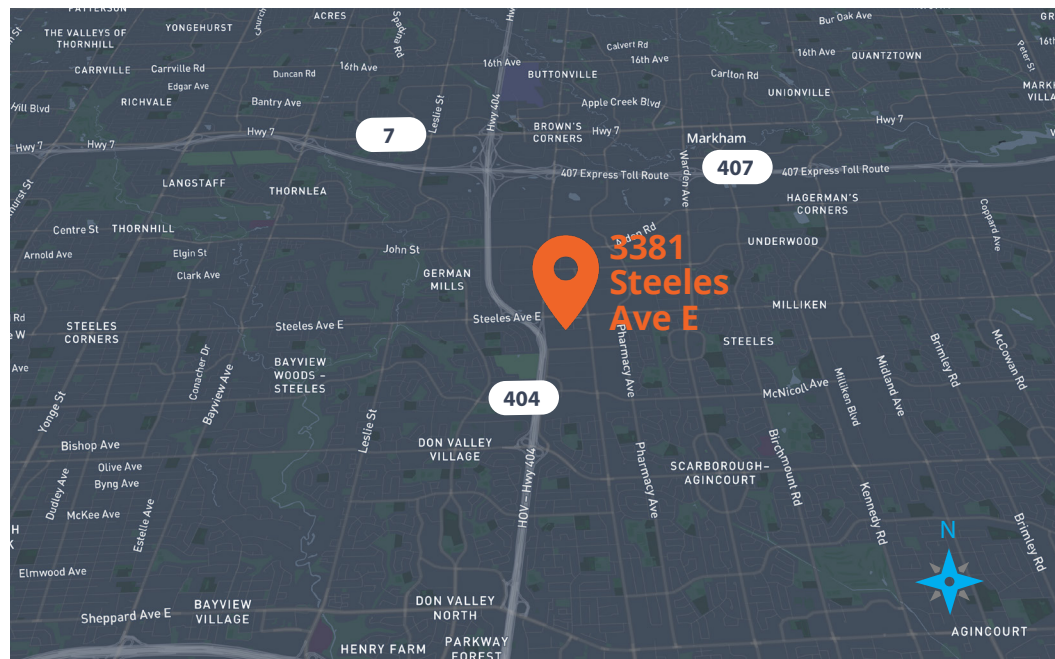



Floor Plan | 2nd Floor

Full Floor Space

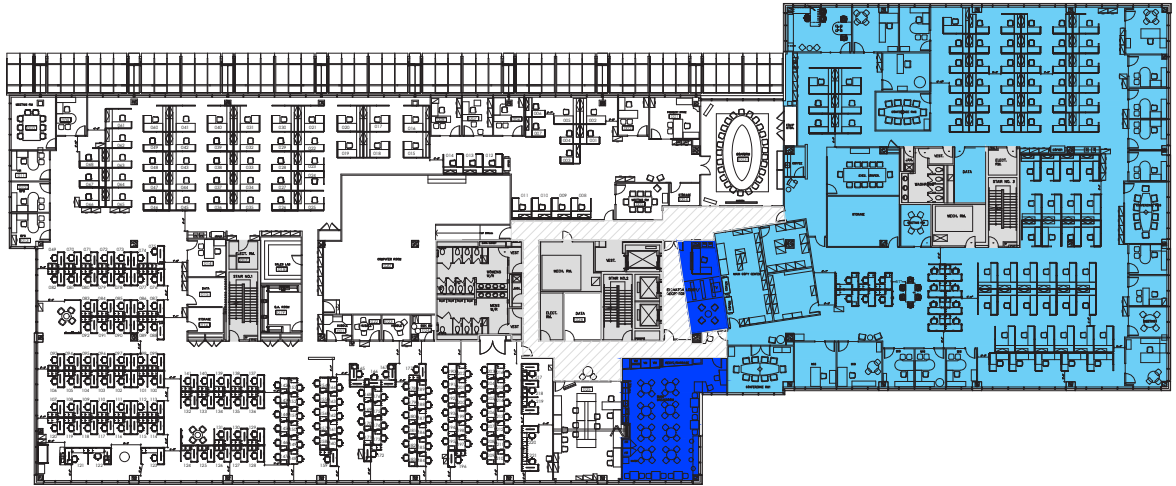

Sublease & Shared Space

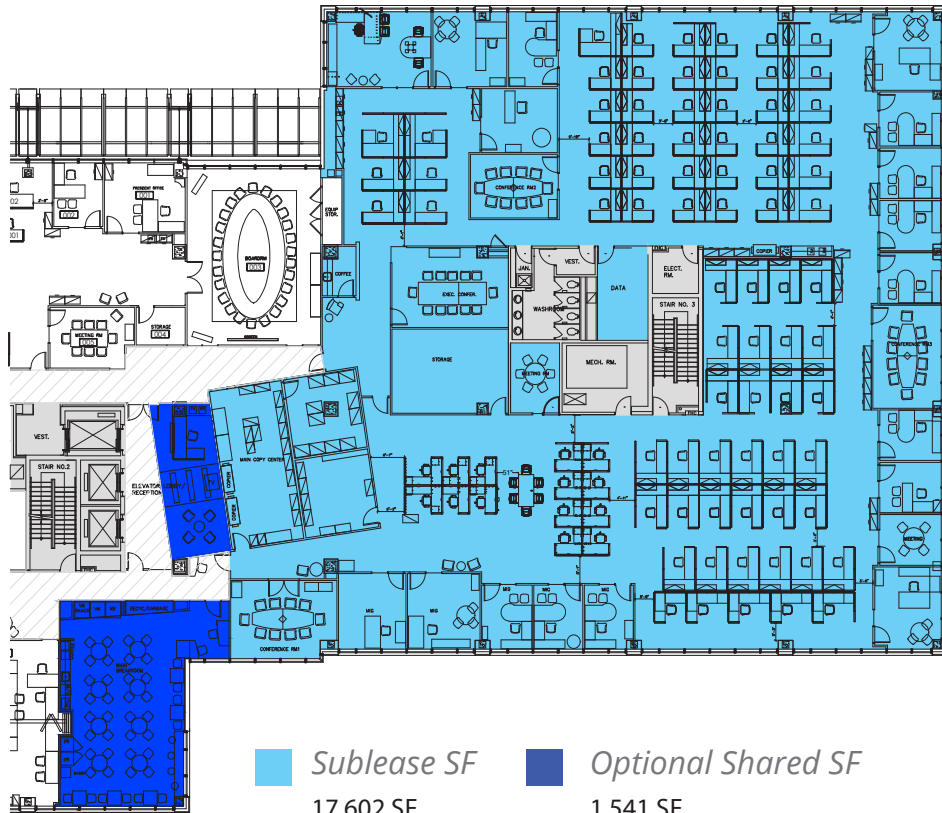

Sublease SF
17,602 SF

Optional Shared SF
1,541 SF

All measurements are approximate.

Stan Krawitz
Principal, Broker
+1 416 822 9636
stan.krawitz@avisonyoung.com

Paul Kay
Principal, Sales Representative
+1 416 799 4455
paul.kay@avisonyoung.com

Avison Young Commercial Real Estate Services, LP, Brokerage
222 Bay Street, Suite 2500, Toronto, ON M5K 1J5 +1 416 955 0000

avisonyoung.ca

