

An aerial photograph of a large commercial shopping center. The image shows several large, interconnected retail buildings with flat roofs, surrounded by extensive parking lots filled with cars. The area is bordered by a multi-lane road on the right and a wooded area on the left. The overall scene depicts a busy commercial hub.

FOR LEASE

MULTIPLE SPACES AVAILABLE

Hillcrest Market Place

1905 EAST MAIN STREET . SPARTANBURG . SC 29307

exclusively listed by:

BRIAN SCURLOCK bscurlock@pintailcre.com | 864.568.3301
REYNOLDS FLOWE reynolds@pintailcre.com | 864.980.8951

The logo for Pintail, featuring a stylized green leaf or feather graphic above the word "PINTAIL" in a serif font.

PINTAIL

join strong national retailers

Anchored by Publix, Hillcrest Market Place is filled with strong national retailers including Marshalls, Petco, Ross, Hibbett Sports, Chico's and NCG Cinema.

ABOUT HILLCREST MARKET PLACE

ADDRESS	1905 East Main Street Spartanburg, SC 29307
COUNTY	Spartanburg
TOTAL SIZE	±360,277 SF
PARKING	Ample on-site parking
HIGH VISIBILITY	27,000+ VPD on East Main Street
HIGHER EDUCATION	Close proximity to ±3,000 Higher Education Students (Wofford and Converse Colleges)

The information contained herein has been given to us by the owner of the property or other sources we deem reliable. We have no reason to doubt its accuracy, but we do not guarantee it. All information should be verified prior to purchase or lease.





AVAILABLE SPACE

1	PAD A2	±43,560 SF	4	PAD B	±9,612 SF	7	SR21B	±2,237 SF
2	MP09	±2,400 SF	5	SR13	±1,335 SF	8	03B	±7,070 SF
3	MP10	±2,150 SF	6	SLBAR	±7,720 SF	9	SL12	±3,225 SF

[VIEW INTERACTIVE MAP](#)

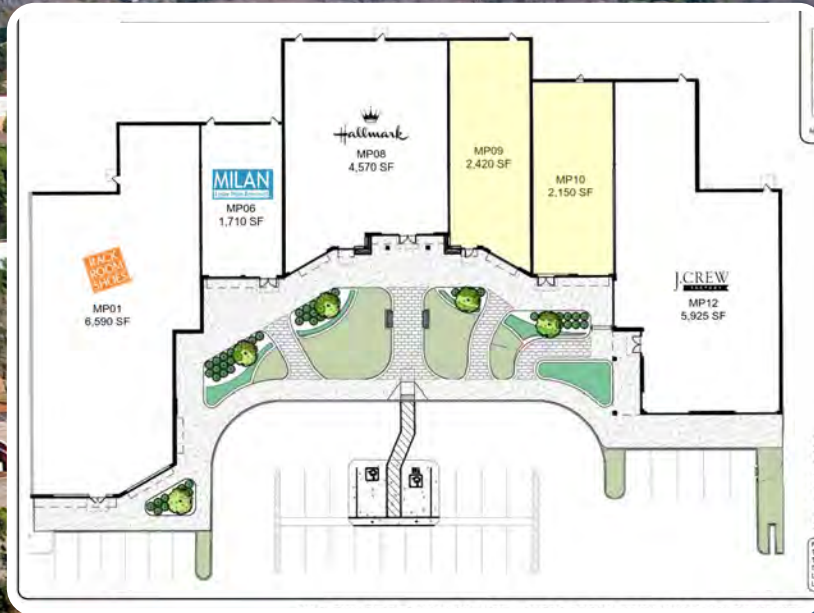

AVAILABLE

MP09 2,400 SF

MP10 2,150 SF



AVAILABLE
PAD A2
±43,560 SF

AVAILABLE
SR13
±1,335 SF





AVAILABLE
SLBAR
±7,720 SF

AVAILABLE
SR21B
±2,237 SF

SURROUNDING AREA



HILLCREST
MARKET
PLACE

FERNWOOD GLENDALE RD

EMAIN ST



CURRENT TENANTS

Tropical Smoothie Cafe
Whataburger
Chipotle Mexican Grill
Talbots
Nothing Bundt Cakes
Jersey Mike's Subs
Orangetheory Fitness
Mattress Firm
Palm Beach Tan
Taco Dog
Samurai Cajun Seafood
Rack Room Shoes

Japan House
Miss Nails
Lowe's
State Farm
A Creative Cloth
Salon East
Watchworks
Gorgeous Nail
Thomas Academy of Martial Arts
AT&T
Salons by JC
Sharonview Federal Credit Union

Spectrum
Garner's Natural Foods
Bath & Body Works
The UPS Store
Hibbett Sports
Ultraskin Wax Center
Club Pilates
Direct Tools
The Joint Chiropractic
Partners in Primary Care
Bliss Nails & Spa
Little Caesars Pizza

Chico's
Marshalls
NCG Cinema
Stone Lighting
Supercuts
Hobby Lobby
Petco
Five Below
Ross Dress for Less
Publix
Trash Talkerz
Banner's Hallmark
J. Crew

PRIME LOCATION

Spartanburg, South Carolina is ideally located at the intersection of Interstates 85 and 26, providing convenient access to Greenville, SC, Asheville, NC, and Charlotte, NC. The city is minutes from Greenville-Spartanburg International Airport and the South Carolina Ports Authority's Inland Port, both in Greer, SC. Residents are less than half a day's drive from three additional international airports (CLT, BNA, and ATL) and South Carolina Ports Authority's Coastal Port in Charleston, SC.

Spartanburg's steady economic growth over the years can be attributed to it's ideal location, highly skilled work force, attractive cost of living, and top schools and undergrad programs.

2023 DEMOGRAPHICS

	0-1 MILE	1-3 MILE	3-5 MILE
POPULATION	5,131	30,497	38,488
PROJ. ANNUAL GROWTH (2023-28)	0.04%	0.26%	0.36%
DAYTIME POPULATION	8,695	52,650	39,924
TOTAL HOUSING UNITS	2,428	12,466	14,617
HOUSING UNITS (RENTED)	39.2%	36.8%	35.2%
HOUSING UNITS (OWNED)	53.7%	52.8%	53.1%
AVERAGE HOUSEHOLD INCOME	\$88,045	\$82,672	\$63,507
MEDIAN HOME VALUE	\$236,770	\$218,654	\$151,978
MEDIAN AGE	47.3	41.4	38.3

*Sources: esri, OneSpartanburg







for more information on the retail spaces available, please contact:

BRIAN SCURLOCK bscurlock@pintailcre.com | 864.568.3301

REYNOLDS FLOWE reynolds@pintailcre.com | 864.980.8951

