

For Lease

Sparks Industrial Warehouse



600-656 Dunn Cir.
Sparks, NV 89431

Casey Prostinak, SIOR
Vice President
775.813.2866
cprostinak@logicCRE.com
S.0177148.LLC

Listing Snapshot



\$0.80 PSF NNN*
Lease Rate



± 14,700 - 30,960 SF**
Available Square Footage

*NNN Lease Rate excludes: NNN expenses - estimated at \$0.17 PSF/Mo., utilities, telecommunications, maintenance and repair of Premises. To be further detailed in Lease.

**Estimated demising spaces of ± 14,700 SF & ± 16,260 SF, subject to change based on final measurements and space requirements of tenant.

Property Highlights

- Clear Height: 19'-21'
- Four (4) dock-high doors
- One (1) grade door (12' x 14' H)
- Column Spacing: 44' x 22' & 44' x 18'
- 33/2,000 sprinkler rating
- Two (2) 1,600 Amp, 480Y/277V, 3-phase panels
- One (1) additional 200 Amp Panel
- Office size: ± 1,848 SF

Northern Nevada Transit Times

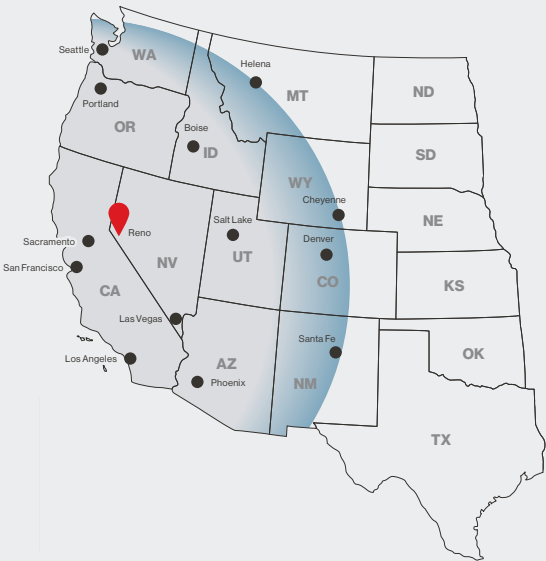

1-Day Truck Service

San Francisco, CA
Sacramento, CA
Los Angeles, CA
Portland, OR
Seattle, WA
Boise, ID
Salt Lake, UT
Las Vegas, NV
Phoenix, AZ

2-Day Truck Service

Helena, MT
Cheyenne, WY
Denver, CO
Santa Fe, NM





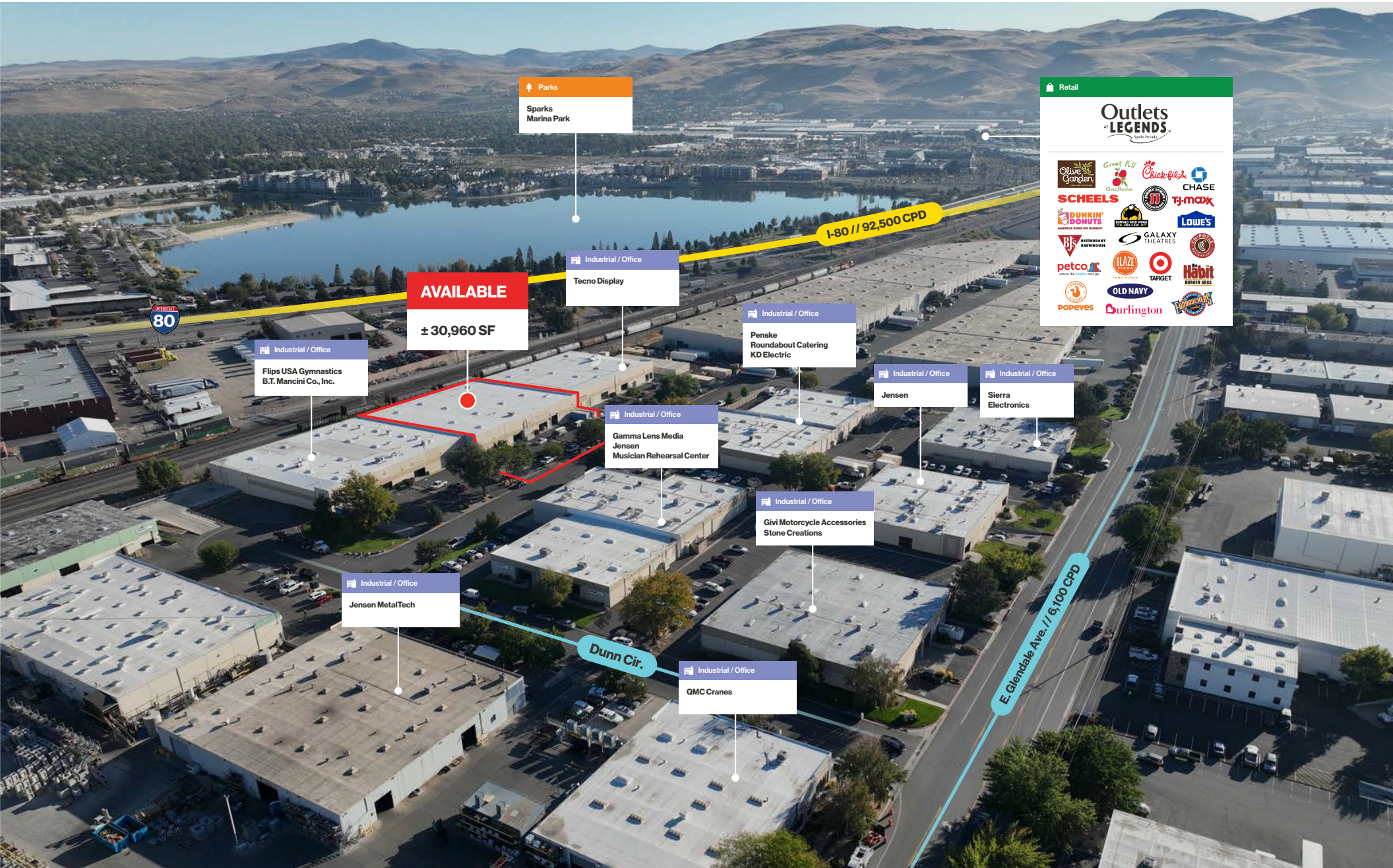

Site Plan

Available NAP



Floor Plan

● Grade Level Door ▲ Dock Door △ Knockout for Dock Door ◻ Dock with Pit

Option 1

± 14,700 SF

Option 2

± 16,260 SF

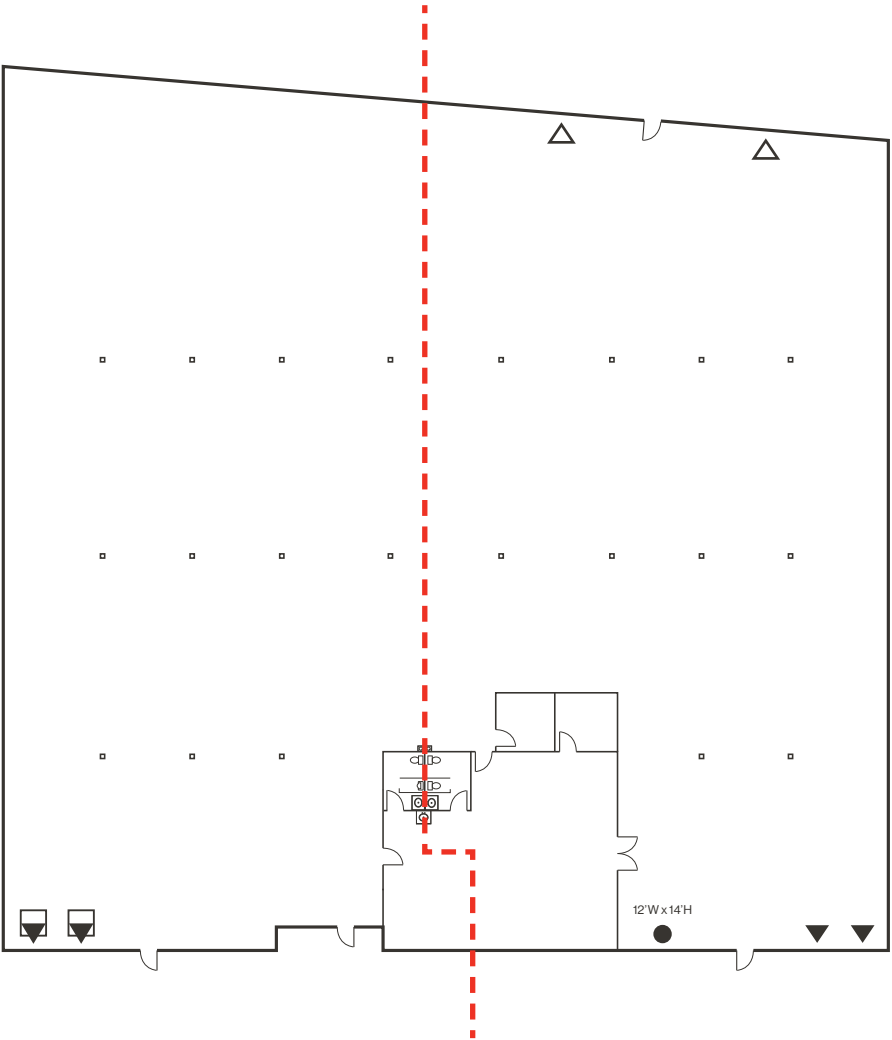

Option 3

± 30,960 SF

Floor Plan
Column Spacing

- Columns
- Grade Level Door
- Dock Door
- Knockout for Dock Door
- Dock with Pit

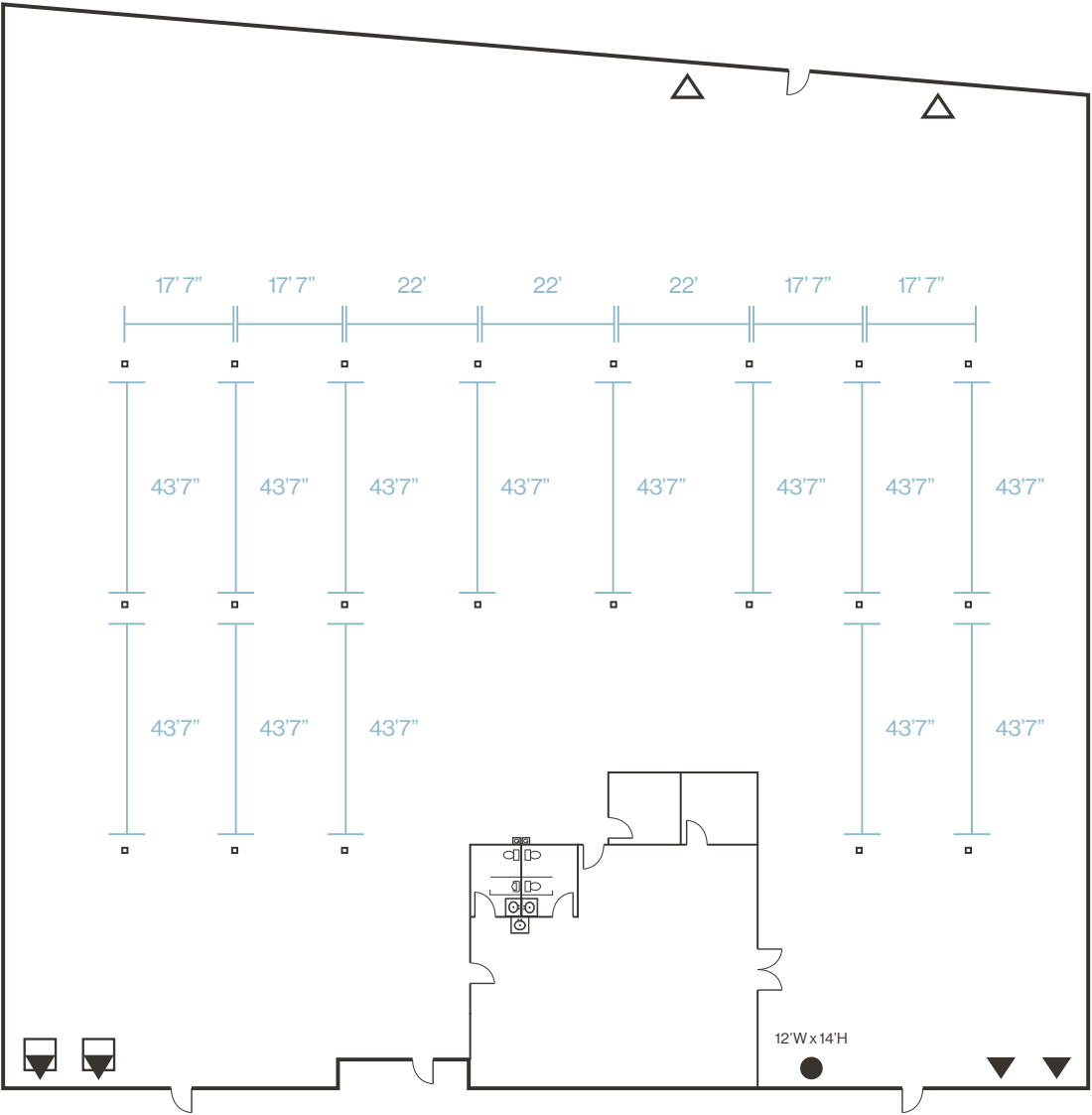

Property Photos



Property Photos



LOGIC Commercial Real Estate

Specializing in Brokerage and Receivership Services

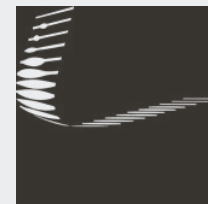

LOGIC



Join our email list and
connect with us on LinkedIn

The information herein was obtained from sources deemed reliable; however LOGIC Commercial Real Estate makes no guarantees, warranties or representation as to the completeness or accuracy thereof.

For inquiries please reach out to our team.

Casey Prostinak, SIOR

Vice President

775.813.2866

cprostinak@logicCRE.com

S.0177148.LLC