

FOR LEASE

# 920 MATLEY LANE



**Industrial**  
PRODUCT TYPE



**±2,883–3,010**  
AVAILABLE SF



**\$1.25**  
LEASE RATE



**Now**  
AVAILABLE



**Derek Carroll** CCIM, SIOR  
Vice President  
(775) 225 4105  
dcarroll@naialliance.com  
NRED N°: BS.0145531



**Mason La Fond** CCIM  
Associate  
(775) 336 4628  
mlafond@naialliance.com  
NRED N°: S.202632



**Brandy Zirkle**  
Property Manager  
(775) 336 4621  
bzirkle@naialliance.com  
NRED N°: S.68822 PM. 163084

**NAI Alliance**

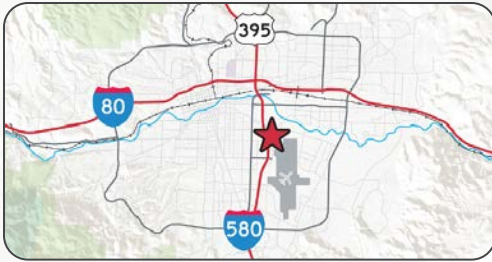

### Property Highlights

This building presents multiple flex industrial units in the Central Reno submarket. Located 0.5 miles from the freeway on-ramp this property offers ample parking, economic lease rate, and a functional real estate product for it's tenants.

### Property Details

|                       |                                   |
|-----------------------|-----------------------------------|
| <b>Address</b>        | 920 Matley Lane<br>Reno, NV 89502 |
| <b>Building Size</b>  | ±20,390 SF                        |
| <b>Available Size</b> | ±2,883 - 3,010 SF                 |
| <b>Lot Size</b>       | ±1.33 AC                          |
| <b>Lease Rate</b>     | \$1.25/SF                         |
| <b>Lease Type</b>     | NNN - Triple Net                  |
| <b>OPEX</b>           | \$0.26                            |
| <b>Ceiling Height</b> | 18'                               |
| <b>Column Spacing</b> | Clear                             |
| <b>Grade Door</b>     | 1                                 |
| <b>Power</b>          | 225A   120V   3P                  |
| <b>Parking Ratio</b>  | 5.78                              |
| <b>APN</b>            | 013-321-32                        |
| <b>Year Built</b>     | 1986                              |

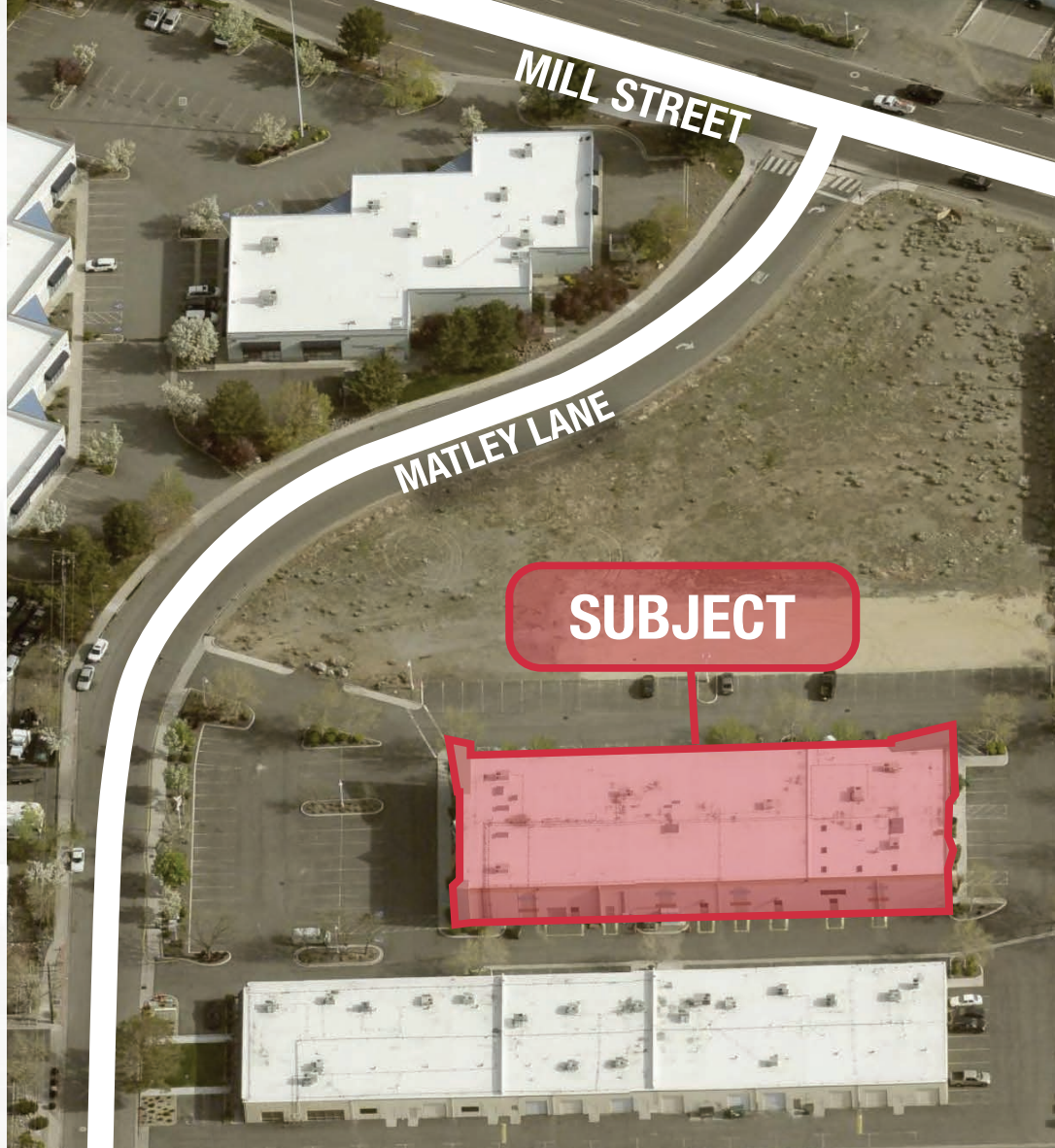

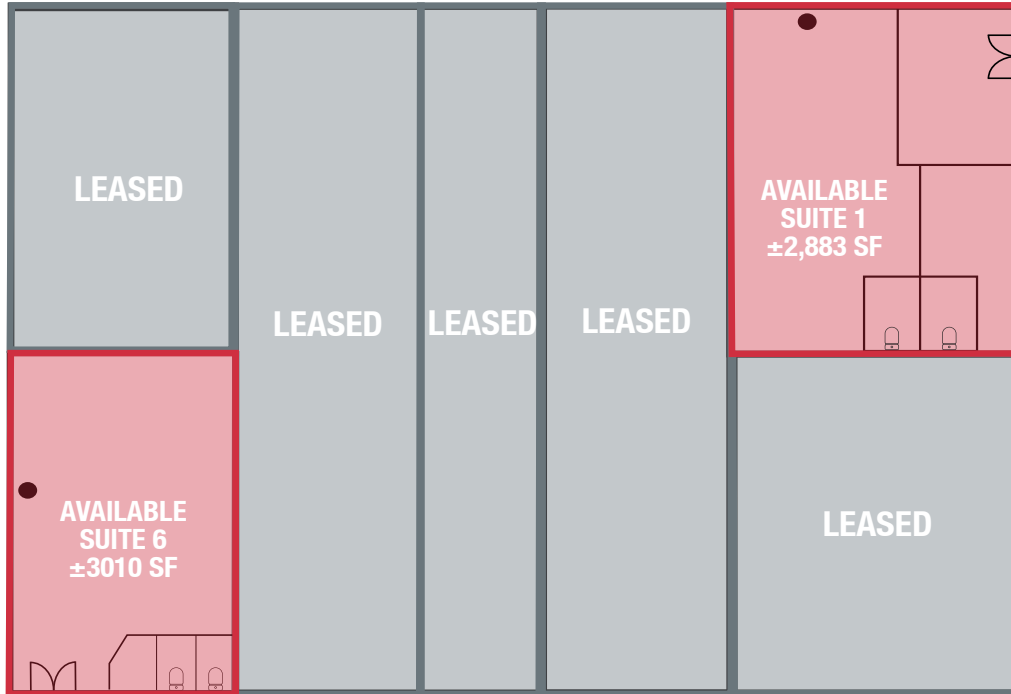

● Drive-In

| Suite Number | Size (SF) | Available | Drive-In Door | Notes  |
|--------------|-----------|-----------|---------------|--|
| Suite 1      | ±2,883    | Now       | 1             | 2 Offices, 2 Restrooms, ±70% Warehouse Space                   |
| Suite 6      | ±3,010    | Now       | 1             | 1 Private Office, 2 Restrooms w/ showers, ±90% Warehouse Space |



**Industrial**

PRODUCT TYPE



**±2,883-3,010**

AVAILABLE SF



**\$1.25**

LEASE RATE



**Now**

AVAILABLE



Suite 1 - Office





**Industrial**  
PRODUCT TYPE



**±2,883-3,010**  
AVAILABLE SF



**\$1.25**  
LEASE RATE



**Now**  
AVAILABLE



Suite 6 - Warehouse



**Industrial**  
PRODUCT TYPE

**±2,883-3,010**  
AVAILABLE SF

**\$1.25**  
LEASE RATE

**Now**  
AVAILABLE

### 5-MILE KEY FACTS



**252,944**  
POPULATION



**5.6%**  
UNEMPLOYMENT



**2.3**  
HOUSEHOLD  
SIZE (AVG.)



**36**  
MEDIAN  
AGE

### 5-MILE INCOME FACTS



**\$72,327** MEDIAN  
HOUSEHOLD  
INCOME



**\$41,640** PER CAPITA  
INCOME



**\$100,132** MEDIAN  
NET WORTH

#### HOUSEHOLDS BY ANNUAL INCOME

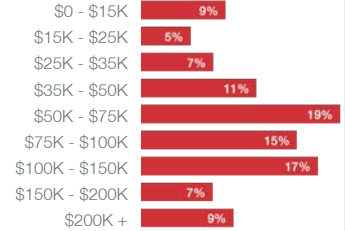

### 5-MILE BUSINESS FACTS



**12,643**  
BUSINESSES



**171,731**  
EMPLOYEES

### 5- MILE EDUCATION FACTS

**13%**

NO HIGH  
SCHOOL  
DIPLOMA



**26%**  
HIGH  
SCHOOL  
GRADUATE



**30%**  
SOME  
COLLEGE



**31%**  
BACHELOR'S  
DEGREE

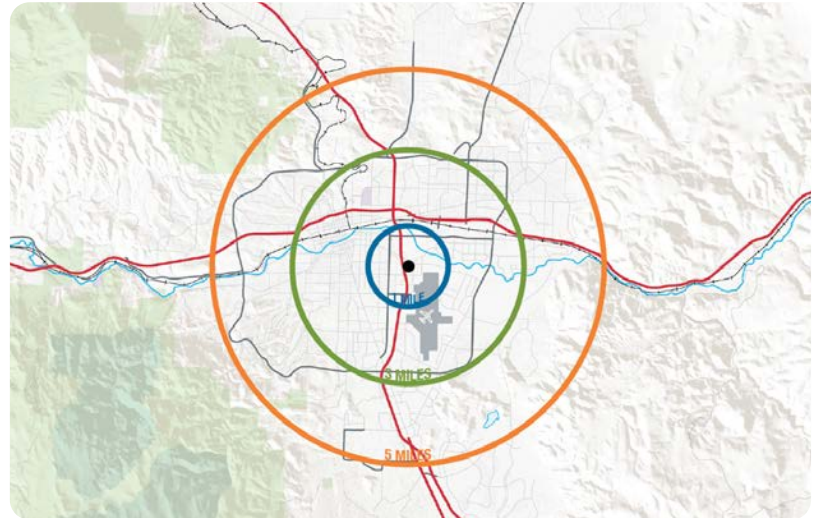

Source: 5 Mile Demographic Profile by ESRI



FOR LEASE | **920** MATLEY LANE



**580**

MILL STREET

MATLEY LANE

**SUBJECT**

**DISTANCE FROM SUBJECT**

|                            |                      |
|----------------------------|----------------------|
| NEAREST <b>580</b> ON-RAMP | .2 MI   1 MIN DRIVE  |
| RENO-TAHOE AIRPORT         | 2 MI   7 MIN DRIVE   |
| SOUTH RENO                 | 7 MI   10 MIN DRIVE  |
| CARSON CITY                | 29 MI   31 MIN DRIVE |

**RENO-TAHOE  
INTERNATIONAL  
AIRPORT**

Nearby Businesses

  
**Industrial**  
PRODUCT TYPE

  
**±2,883–3,010**  
AVAILABLE SF

  
**\$1.25**  
LEASE RATE

  
**Now**  
AVAILABLE









Nevada is a business-friendly state with a very low-regulation environment, a streamlined licensing and approval processes, and a favorable tax environment for business and industry. A state with the workforce, education, and infrastructure in place to support economic development.



## THE BEST IN THE WEST

The Tax Foundation's 2023 State Business Tax Climate Index named Nevada the 7th best in the country. The Index looks at five areas of taxation including corporate tax, individual income tax, sales tax, unemployment insurance tax, and property tax. It is designed to show how well states structure their tax systems and provides a road map for improvement.

### No Tax on

-  Corporate Income Tax
-  Corporate Shares Tax
-  Franchise Tax
-  Personal Income Tax
-  Franchise Tax on Income
-  Inheritance or Gift Tax
-  Unitary Tax
-  Estate Tax

### Tax Abatement on

-  Sales & Use Tax
-  Modified Business Tax
-  Personal Property Tax
-  Real Property Tax (for Recycling)
-  Aviation Parts Tax
-  Data Center Tax



## 61 OPPORTUNITY ZONE DESIGNATIONS

In June 2018, 61 of Nevada's low-income census tracts received official designation as Qualified Opportunity Zones (QOZ) by the U.S. Department of Treasury and the IRS. The tax incentives reduce taxes on realized capital gains that are quickly reinvested into these designated census tracts by providing three benefits:

-  The deferral of taxes
-  A reduction in taxes by 10 to 15 percent
-  The exclusion of capital gains tax on appreciation if held for 10 years

Sources: 2022 State Business Tax Climate Index provided by the Tax Foundation  
Tax + Opportunity Zone incentive details provided by the Nevada Governor's Office of Economic Development

FOR LEASE

**920** MATLEY LANE

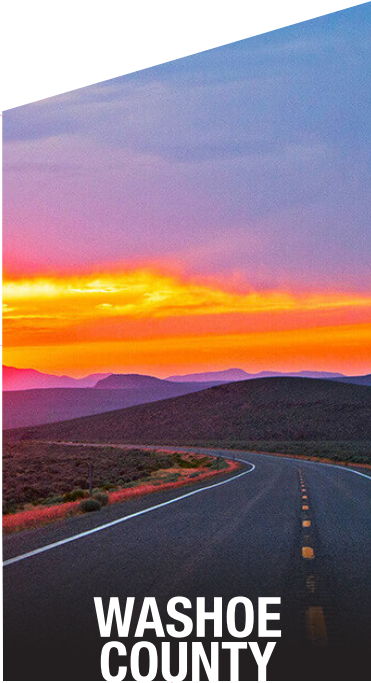

## WASHOE COUNTY

Washoe County is in the Northwest corner of Nevada, along the California and Oregon borders. Since 2010, the population of Washoe County has grown by nearly 20%. It is the second most populous county in Nevada, behind Clark County.



## CITY OF RENO

Named #1 Small City by *BestCities.org* in 2020, the Reno area hosts over 5m annual visitors for events like the Reno Rodeo, Street Vibrations, and more. Reno is home to a robust mix of the world's top businesses and a burgeoning arts community.



## TAHOE RENO INDUSTRIAL CENTER

Tahoe Reno Industrial Center is the largest industrial park in the world. It offers many unparalleled benefits including pre-approved industrial uses, 7-day turnaround on grading permits, 30-day turnaround on building permits, and in-place roads and utilities.



## LAKE TAHOE

Lake Tahoe is less than 25 miles from downtown Reno, a short drive for Northern Nevada's residents and visitors. Tahoe is a year-round outdoor attraction offering beautiful beaches and views, sports and relaxation, and gourmet food and beverage experiences.

About Northern Nevada



**Derek Carroll** SIOR, CCIM

Vice President  
(775) 225 4105  
dcarroll@naialliance.com  
NRED N°: BS.0145531



**Mason La Fond** CCIM

Associate  
(775) 336 4628  
mlafond@naialliance.com  
NRED N°: S.202632



**Brandy Zirkle**

Property Manager  
(775) 336 4621  
bzirkle@naialliance.com  
NRED N°: S.68822 PM.163084

NO WARRANTY OR REPRESENTATION, EXPRESS OR IMPLIED, IS MADE AS TO THE ACCURACY OF THE INFORMATION CONTAINED HEREIN, AND THE SAME IS SUBMITTED SUBJECT TO ERRORS, OMISSIONS, CHANGE OF PRICE, RENTAL OR OTHER CONDITIONS, PRIOR SALE, LEASE OR FINANCING, OR WITHDRAWAL WITHOUT NOTICE, AND OF ANY SPECIAL LISTING CONDITIONS IMPOSED BY OUR PRINCIPALS NO WARRANTIES OR REPRESENTATIONS ARE MADE AS TO THE CONDITION OF THE PROPERTY OR ANY HAZARDS CONTAINED THEREIN ARE ANY TO BE IMPLIED.

