

3 REASONS TO CHOOSE OFFICE EVOLUTION ARLINGTON ROSSLYN



CONVENIENCE

- Minutes from The Rosslyn Metro
- ▶ 10 minutes from Reagan National
- ▶ 35 Minutes from Dulles International
- ▶ 10 minutes from Washington DC



PROFESSIONALISM

- ▶ Private, secure, soundproof private offices
- ▶ Network of business professionals
- ▶ Business counsel and development



AMENITIES

- ▶ Meeting Rooms
- ▶ Training Rooms
- ▶ Fitness Center
- ▶ Amenities Center
- ▶ Beverages and Refreshments

WE ARE AN EXPERIENCE, NOT A TRANSACTION!



office evolution[®]

ARLINGTON-ROSSLYN

TRANSIT AND TOURIST ATTRACTIONS

TRANSIT/SUBWAY

Rosslyn Transit Stop	6 min walk	0.4 mi
Court House Transit Stop	12 min walk	0.9 mi
Clarendon Transit Stop	5 min drive	2.0 mi
Arlington Cemetery Transit Stop	3 min drive	1.6 mi
Foggy Bottom-GWU Transit Stop	4 min drive	2.0 mi

COMMUTER RAIL

Crystal City Commuter Rail (Manassas, Fredericksburg Lines)	7 min drive	3.4 mi
L'Enfant Commuter Rail (Manassas, Fredericksburg Lines)	8 min drive	3.7 mi
Union Station Commuter Rail (Manassas, Fredericksburg Lines)	10 min drive	4.7 mi
Union Station Commuter Rail (Brunswick, Camden, Penn Lines)	10 min drive	4.7 mi
Alexandria Commuter Rail (Manassas, Fredericksburg Lines)	16 min drive	7.2 mi

AIRPORT

Ronald Reagan Washington National Airport	10 min drive	4.7 mi
Washington Dulles International Airport	39 min drive	24.7 mi

NEARBY TOURIST ATTRACTIONS

- » Dark Star Park
- » Arlington National Cemetery
- » The White House
- » National Cathedral
- » The View DC
- » The Capitol
- » Smithsonian Institution



YOUR OFFICE PACKAGE INCLUDES

- **Business center Manager** to take care of all of your business needs
- **Secure and Private Workspace** with several security checkpoints within the building and your suite
- **Full service kitchen** with complimentary coffee/tea and refreshments
- **Shared Workspace** with coffee bar and entertainment
- **Secure High-Speed Wifi** (wired or wireless)
- **Meeting room credits** at your home location
- **Mail services**
 - Prominent Rosslyn business address
 - Mail handling and reception
 - Private Secure Mailbox
- **Telephone services**
 - Local phone number
 - Personal receptionist
 - Call transferring and forwarding and other call features available

DO YOUR BEST WORK HERE

Our development team takes care in designing our locations to provide affordable workspaces that enhance our members' work. When you walk into your office, you enter an oasis for whatever type of work you need to get done, whether it's ideating, strategizing, or taking confidential calls. Without question, our private offices provide a turnkey, flexible, and scalable solution where you will do your best work.

WORKSPACE ACROSS THE NATION

- 24/7 access to work from 72+ locations across the US
- 50% discounted meeting rooms nationwide
- Join a national network of great business minds



FIND INSPIRATION IN OUR LOCATION

Providing Dreamers, Risk-Takers, and Doers with a growing national network of locally owned and operated workspaces close to home that are affordable, safe, and inspired.

Our inspired workspaces below.

RECEPTION



PRIVATE OFFICE



SHARED WORKSPACE



CONFERENCE ROOM



ABOUT OFFICE EVOLUTION

**DREAMERS
RISK-TAKERS
AND DOERS**
INSPIRED HERE.

With 72+ locations across 60+ cities and 25+ states, we are the largest national network of locally owned and operated workspaces close to home that are affordable, safe, and inspired. Founded in 2003 in Boulder, CO by Mark Hemmeter, we support our Ohana (Hawaiian for family) of Dreamers, Risk-Takers, and Doers who dare to chase their passions.

DREAMERS | RISK-TAKERS | DOERS

INSPIRED HERE.



- Conference Rooms
- Common Areas
- Podcast Room
- Private Office
- Team Office
- Private Office Plus

Arlington
1530 Wilson Boulevard, Suite 650
Arlington, VA 22209
571.347.1010

officeevolution®

Want to have your own brand new private offices for your company or firm? A private and confidential workspace? Look no further!

This office suite is located on the first floor of the newly renovated office building at 1530 Wilson Boulevard in the heart of Rosslyn, just three blocks from the Rosslyn Metro and 12 minutes from the nation's capital

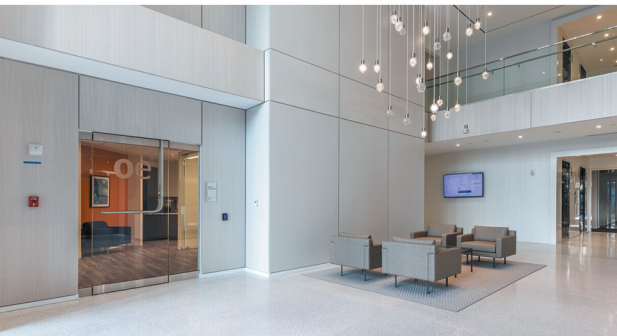

The team suite is equipped with:

- 9 private offices
- Large state-of-the-art conference room that seats up to 8 with the latest A/V technologies and teleconferencing capabilities
- Copy/print room with cloud-based printing and document production with professional grade shredder
- Contemporary kitchen with unlimited beverages and refreshments and commercial-grade coffee and tea machine
- 24/7 access
- Business address included and mailing services (if needed)
- On-site fitness center as part of the building's amenities
- Amenities room with outdoor seating

The 9 private offices (6 with window views) are equipped with:

- High Speed internet, wired or wireless
- Fully furnished and soundproof private offices
- Electronic rising desks
- Ergonomic seating and
- Locked cubicles

Conference room features

- Latest Polycom technology for teleconferencing
- Soundproof with privacy glass for confidential War Room meetings
- State of the art visual display and HD camera with panoramic and zoom view for large team meetings
- Ergonomic seating
- A/V hookups and technology for presentations and conferences
- Exclusive use of the conference room for meetings, hosting, client relations and more!

If any special accommodations including private tech stack for your own Internet setup please let us know and we can facilitate those requests.

officeevolution[®]

ARLINGTON-ROSSLYN



PRIVATE OFFICES

Soundproof, executive style amenity-rich private offices

MEETING ROOMS

Soundproof with Cutting Edge A/V tech

TRAINING ROOMS

Modular Floor Plan and Furniture with Huddle Room and Breakout Rooms