

For Lease

MILLENNIUM CENTRE

4909 49 STREET
RED DEER, ALBERTA

DEMOGRAPHICS



Population
100,418



Median Age
43



Household Income
\$93,098

BUILDING DETAILS



Parking
282 stalls



Neighbourhood
Downtown



Traffic Count
20,000 vpd

HIGHLIGHTS

- 7 storey downtown office/retail building located across from City Hall in downtown Red Deer with 282 above ground parking & 53 underground stalls
- On site security
- Strong tenant mix from financial and legal institution to government office
- RDC off site campus, high trafficked food court
- New major retail tenants

Rates:

Market

Leasable Areas:

Unit 101: 2,180 sq. ft.

Unit 104B: 1,264 sq. ft.

Unit 106: 1,307 sq. ft.

Unit 108: 5,121 sq. ft.

Unit 109: 1,810 sq. ft.

Unit 110: 1,224 sq. ft.

Op Costs & Taxes:

\$15.64 psf (est)

Term:

5 - 10 years

Parking:

Market Rates

HEAD OFFICE
Suite 300, 1324 - 11 Avenue SW
Calgary, Alberta T3C 0M6
Toll Free 1.800.750.6766
AvenueCommercial.com

AVENUE | Commercial
Real Estate Solutions

FLOOR PLAN

4909 49 Street, Red Deer, Alberta

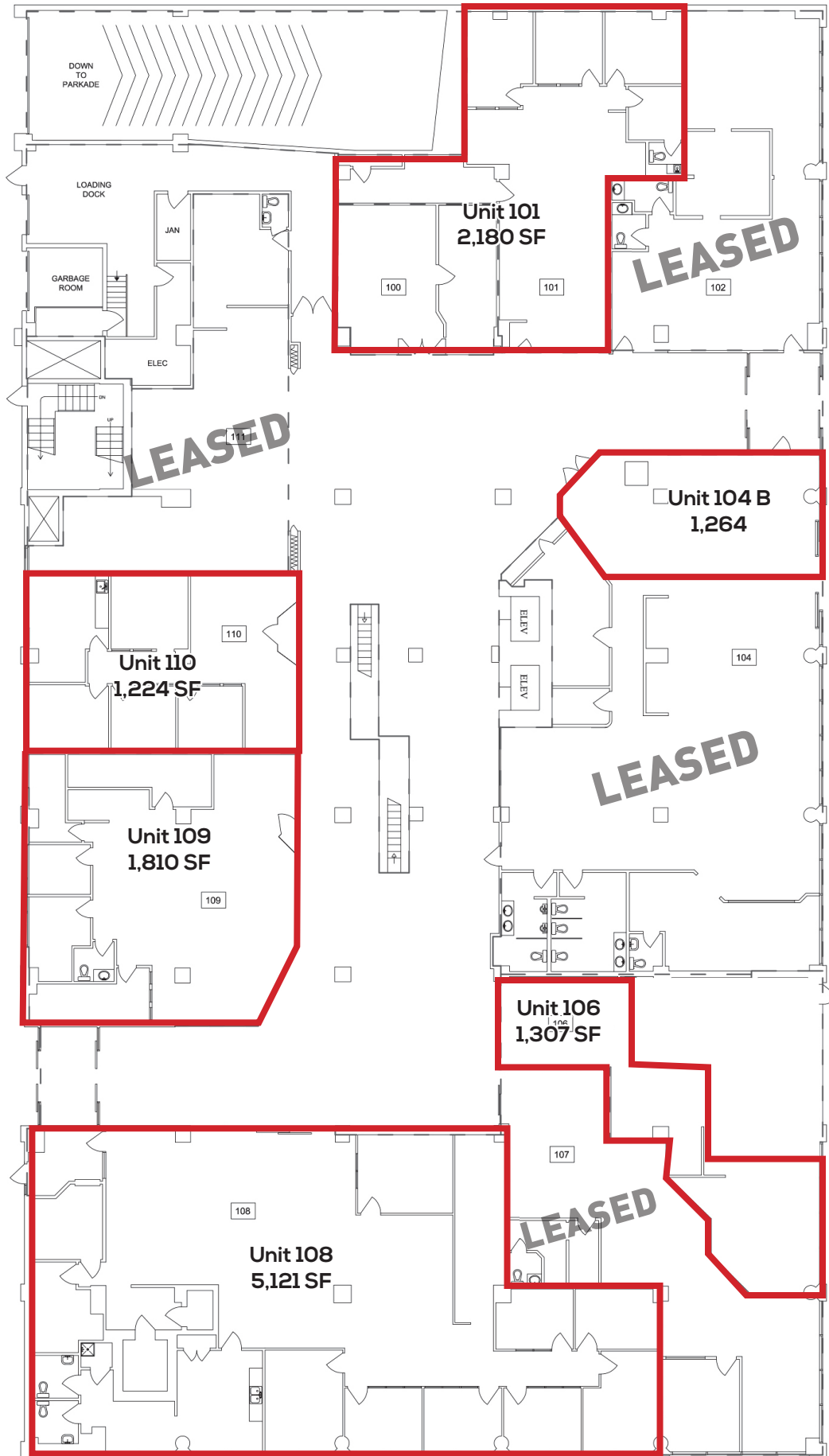

Suite 101 - 2,180 sq. ft. - Former Registry Office



HEAD OFFICE

Suite 300, 1324 - 11 Avenue SW
Calgary, Alberta T3C 0M6

Main 403.802.6766
Toll Free 800.750.6766

AvenueCommercial.com

Suite 106 - 1,307 sq. ft.



Suite 110 - 1,224 sq. ft.



LOCATION

4909 49 Street, Red Deer, Alberta



CHOOSE YOUR AVENUE

Commercial / Residential / Financing / Property Management / Investments

Lorrie Whiteway

Associate

403.619.8255

lwhiteway@avenuecommercial.ca

Steven Butt

President

403.802.6766

sbutt@avenuecommercial.com

This brochure is intended for information purposes only and should not be relied upon for accurate factual information by the recipients hereof. The information contained herein is based on information which Avenue Commercial deems reliable. The information contained herein is subject to change without notice.

HEAD OFFICE

Suite 300, 1324 – 11 Avenue SW
Calgary, Alberta T3C 0M6

Main 403.802.6766

Toll Free 800.750.6766

AvenueCommercial.com

