



Previous Davey Tree Expert Company Location



**Get more
information**

Paul French, Principal
M +1 610 308 1961
paul.french@avisonyoung.com

Dave Smith, Principal
M +1 609 314 4864
david.smith@avisonyoung.com

Will Ciarlone, Associate
M +1 484 889 8491
william.ciarlone@avisonyoung.com

Property Summary

For Sale

603 Witmer Road, Horsham, PA 19044



Available Space	+/- 2,000 SF office +/- 4,000 SF warehouse
Historic Use	Davey Tree Expert Company
Zoning	R2
Historic Non-Conforming Use	Landscaper / Contractor Facility
Acres	4.6 AC
Drive-Ins	5 drive-ins
County	Montgomery
2023 Total Population (5 mi)	205,433
Median Household Income (5 mi)	\$96,477



Get more information

Paul French, Principal
M +1 610 308 1961
paul.french@avisonyoung.com

Dave Smith, Principal
M +1 609 314 4864
david.smith@avisonyoung.com

Will Ciarlone, Associate
M +1 484 889 8491
william.ciarlone@avisonyoung.com

Local Access Map

Horsham, PA

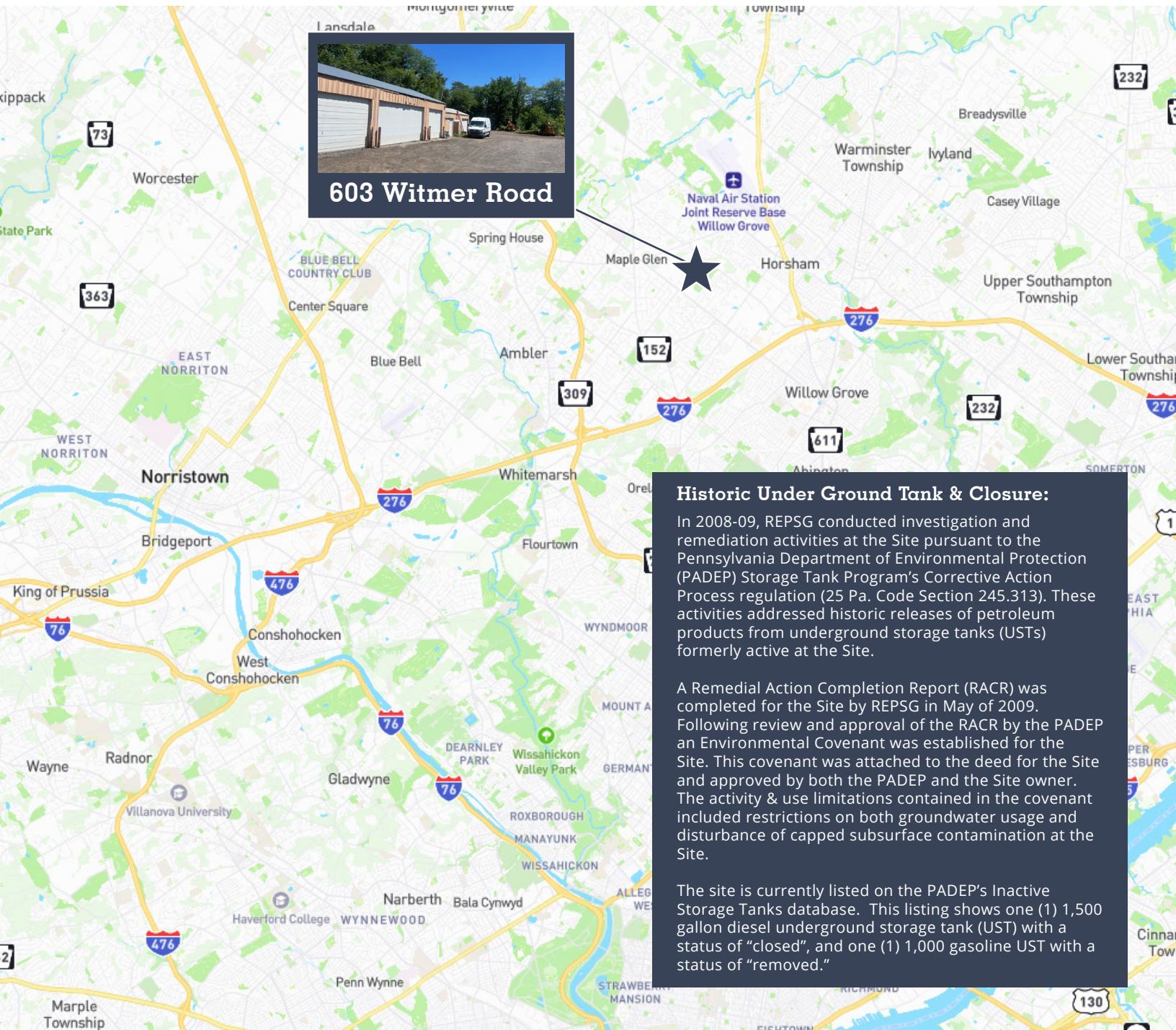

Get more information

Paul French
Principal
M +1 610 308 1961
paul.french@avisonyoung.com

David Smith
Principal
M +1 609 314 4864
david.smith@avisonyoung.com

Will Ciarlon
Associate
M +1 484 889 8491
william.ciarlone@avisonyoung.com

Proposed Site Plan

For Sale
603 Witmer Road, Horsham, PA 19044



**Get more
information**

Paul French, Principal
M +1 610 308 1961
paul.french@avisonyoung.com

Dave Smith, Principal
M +1 609 314 4864
david.smith@avisonyoung.com

Will Ciarlone, Associate
M +1 484 889 8491
william.ciarlone@avisonyoung.com

Proposed Building Plan

For Sale
603 Witmer Road, Horsham, PA 19044

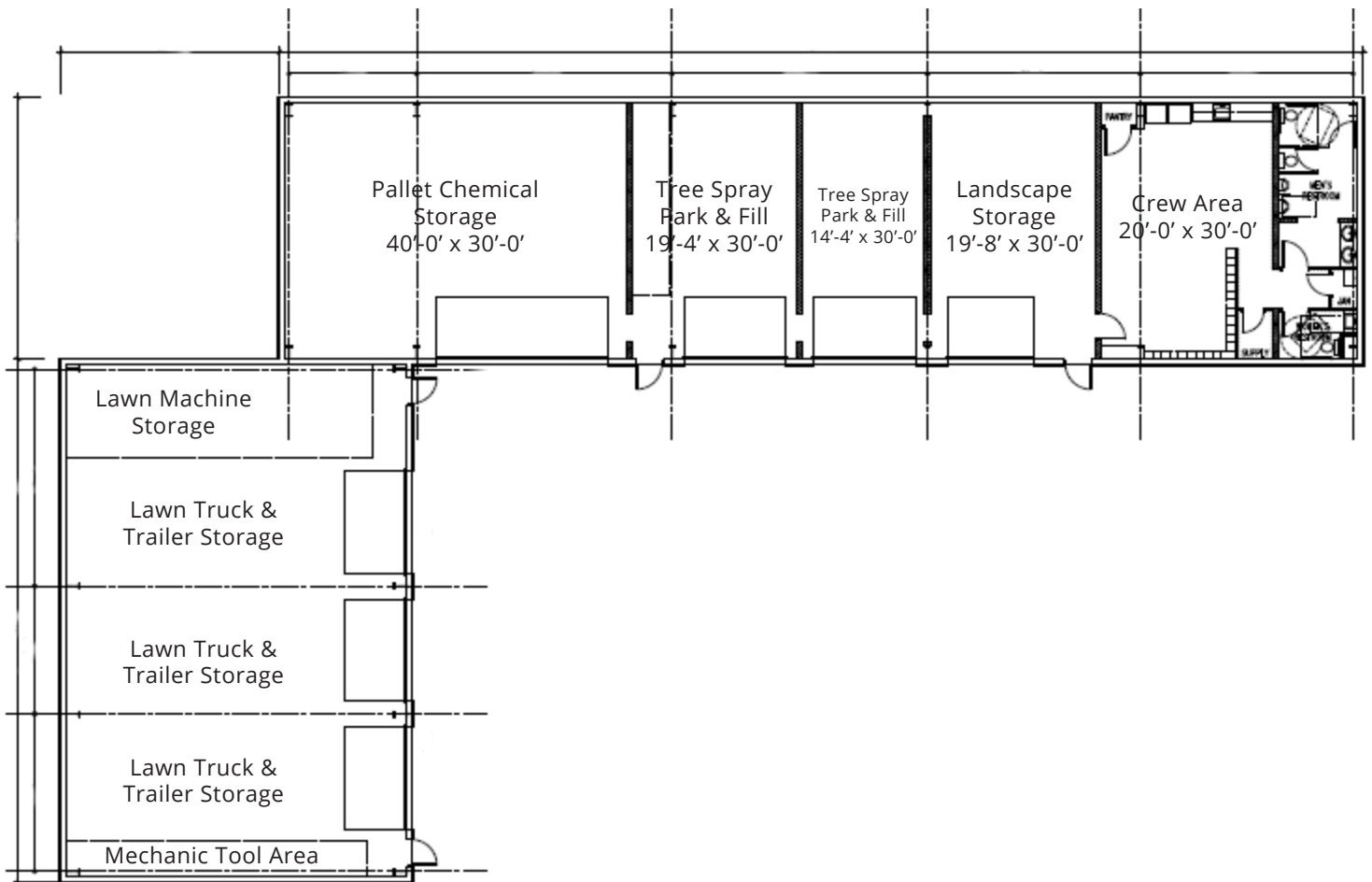

Get more information

Paul French, Principal
M +1 610 308 1961
paul.french@avisonyoung.com

Dave Smith, Principal
M +1 609 314 4864
david.smith@avisonyoung.com

Will Ciarlone, Associate
M +1 484 889 8491
william.ciarlone@avisonyoung.com