

# THE LANSBURGH

WASHINGTON, DC

2,965-6,830 SF 2ND GEN RESTAURANT AND RETAIL SPACES AVAILABLE

RAPPAPORT







# THE LANSBURGH

## WASHINGTON, DC

- | Retail and restaurant opportunity in the heart of Penn Quarter
- | Ample customer parking in building garage and central loading dock
- | Co-tenants include The Shakespeare Theater, Jaleo, China Chilcano, and Matchbox
- | One block from the National Mall, two blocks from Capital One Arena, and National Portrait Gallery

### DEMOGRAPHICS 2022

	0.25 MILE	0.5 MILE	1 MILE
 POPULATION	2,094	8,974	38,460
 DAYTIME POPULATION	36,367	108,970	273,517
 HOUSEHOLD INCOME	\$202,132	\$154,316	\$129,871
 TRAFFIC COUNTS	22,475 on 7th Street NW		

### AREA RETAILERS



**THE LANSBURGH  
WASHINGTON, DC**

**DC CONVENTION CENTER**  
2.3M SF EVENT SPACE  
1,027 CONVENTIONS IN 2016  
~1 MILLION ATTENDEES

**UNION STATION**  
31,000 METRO COUNTS

**CITY CENTER**



Dior  
FIG & OLIVE  
GUCCI  
BVLGARI

**CARNEGIE LIBRARY**



**GALLERY PLACE**



**NEW YORK AVENUE**

**8TH STREET**

**H STREET**

**G STREET**



**MASSACHUSETTS AVENUE**



**700 13TH STREET NW**



**E STREET 7,527 VPD**

**7TH STREET NW 22,475 VPD**

**CAPITAL ONE ARENA**  
~2.4 MILLION ANNUALLY  
20,000 SEATS



**CAPITOL CROSSING**  
2.2M SF  
75K SF RETAIL  
8,000 NEW EMPLOYEES  
(DAYTIME TRAFFIC)

**THE CAPITOL**



**THE LANSBURGH BUILDING**



**NATIONAL MALL**  
33.8M VISITORS ANNUALLY

**PENNSYLVANIA AVENUE 13,747 VPD**

# 7TH STREET RESTAURANT OPPORTUNITY

THE LANSBURGH | WASHINGTON, DC

2,965 SF 2ND GEN RESTAURANT SPACE AVAILABLE

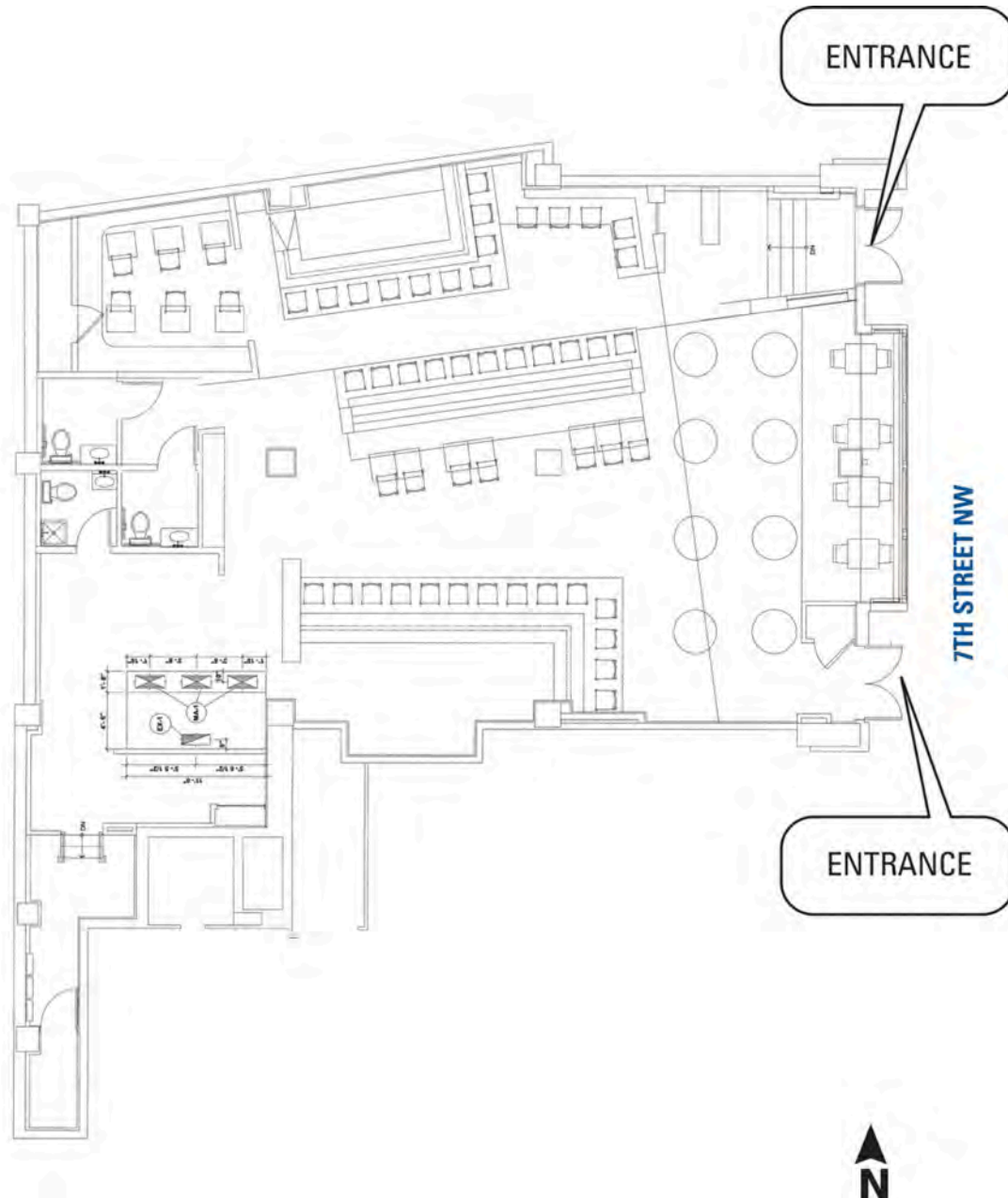

**8TH AND E CORNER RETAIL SPACE**  
**THE LANSBURGH | WASHINGTON, DC**  
**6,830 RETAIL SPACE AVAILABLE**

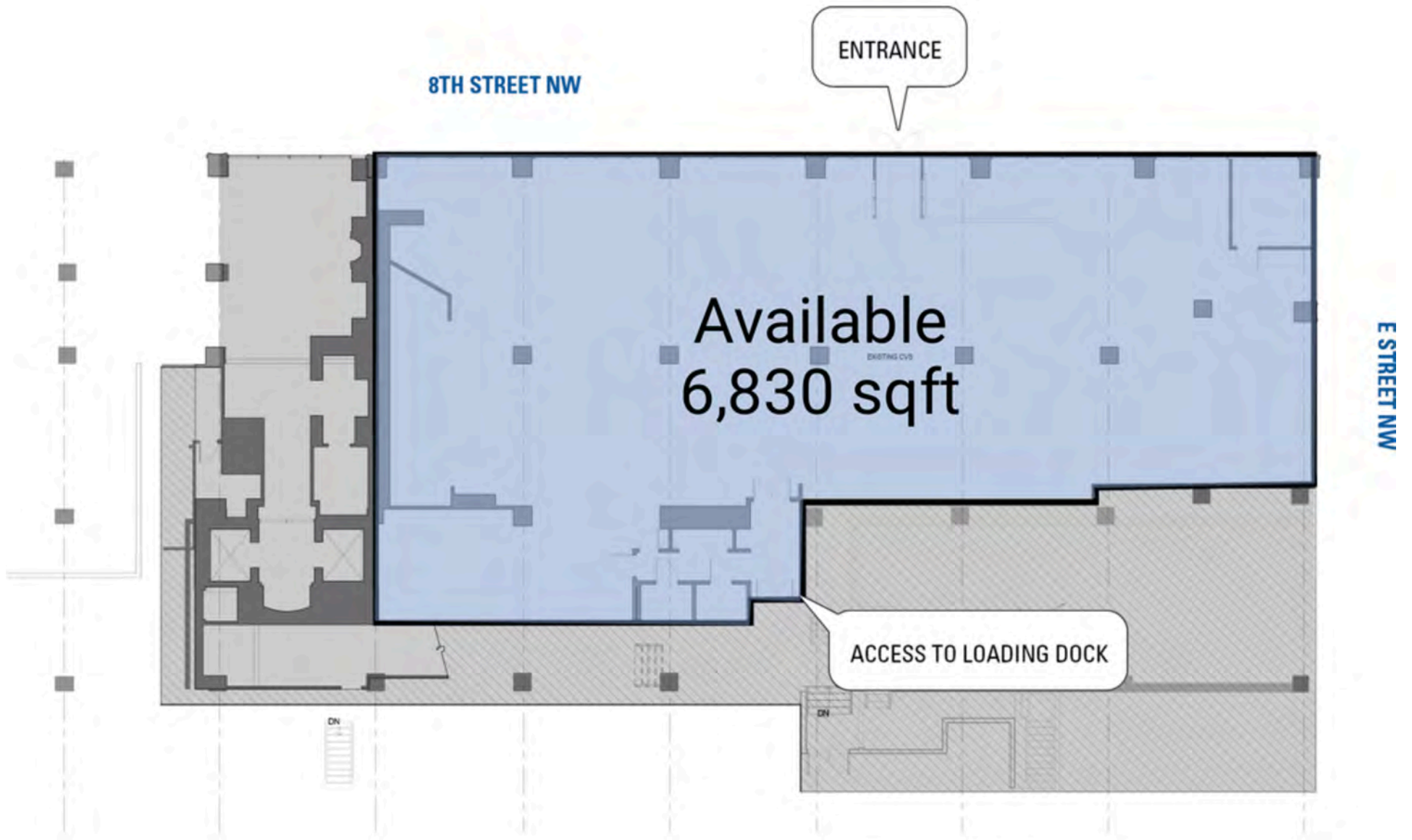

# RAPPAPORT

**THE LANSBURGH | 444 7TH ST NW, WASHINGTON, DC**

**Bill Dickinson | [bdickinson@rappaportco.com](mailto:bdickinson@rappaportco.com) | 703.310.6983**

**Mike Howard | [mhoward@rappaportco.com](mailto:mhoward@rappaportco.com) | 571.382.1219**

**Melissa Webb | [mwebb@rappaportco.com](mailto:mwebb@rappaportco.com) | 571.382.1227**

**[rappaportco.com](http://rappaportco.com)**