

# FOR LEASE

## CHESTERFIELD MEADOWS

6411-6551 Centralia Road | Chesterfield, VA 23832



**S.L. NUSBAUM**  
REALTY CO.



**BOB BUTCHER**

Senior Vice President

O. 804.320.7600

C. 804.387.8194

bbutcher@slnusbaum.com

**ANDREW THACKER**

Vice President

O. 804.320.7600

C. 804.357.6075

athacker@slnusbaum.com





# PROPERTY SUMMARY

## CHESTERFIELD MEADOWS

6411-6551 Centralia Road | Chesterfield, VA 23832



S.L. NUSBAUM  
REALTY CO.

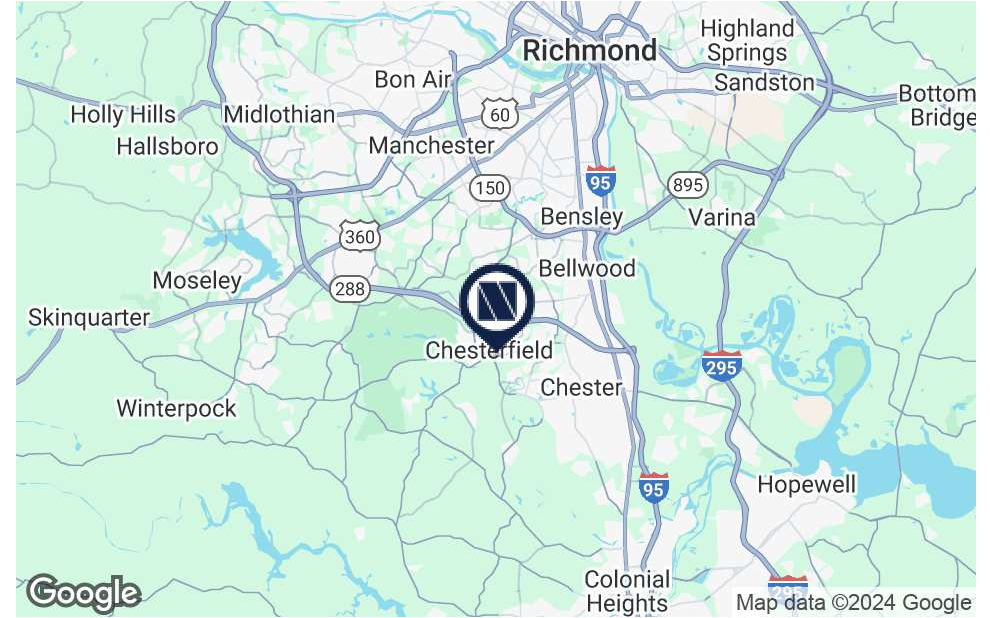

### OFFERING SUMMARY

Lease Rate:	Contact Agents
Building Size:	167,146 SF
Available SF:	1,200 - 1,375 SF

### DEMOGRAPHICS

	1 MILE	3 MILES	5 MILES
Total Population	5,419	31,148	87,841
Daytime Population	9,735	31,427	79,853
Total Households	2,052	11,878	32,639
Average HH Income	\$81,240	\$104,645	\$101,108

### PROPERTY OVERVIEW

Located at the signalized intersection of Centralia Road and Iron Bridge Road.

### PROPERTY HIGHLIGHTS

- A thriving trade area - less than one mile from Chesterfield County Courthouse complex
- Daytime employment  $\pm 7,399$  within 1 mile;  $\pm 16,111$  within 3 miles;  $\pm 33,407$  within 5 miles
- Located in the highly sought after residential growth corridor
- Features excellent access and exposure on Centralia and Iron Bridge Roads and close proximity to Rt. 288

# SITE PLAN

## CHESTERFIELD MEADOWS

6411-6551 Centralia Road | Chesterfield, VA 23832



S.L. NUSBAUM  
REALTY CO.

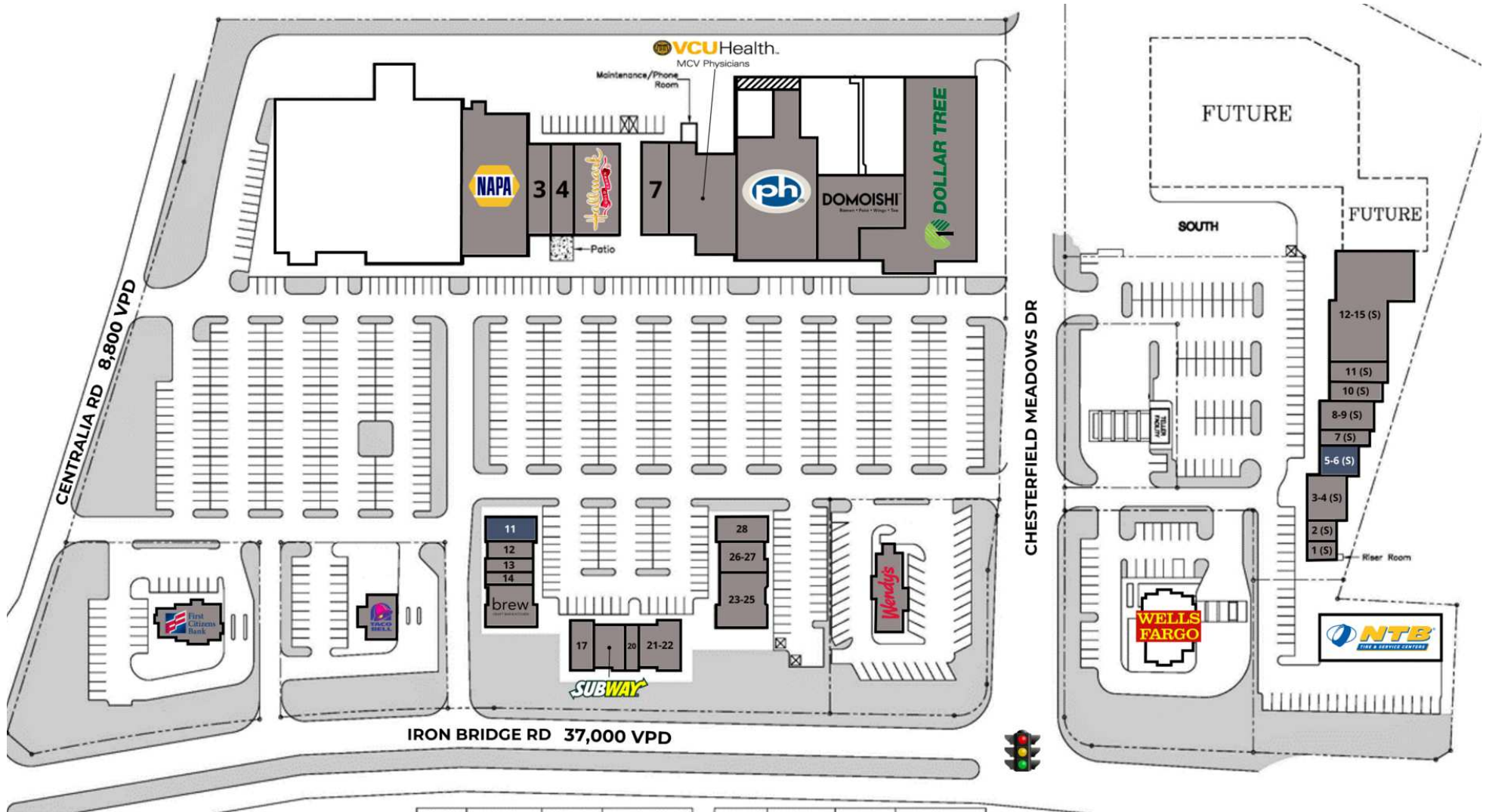

### LEGEND

- Available
- Unavailable



# VACANCY OVERVIEW

## CHESTERFIELD MEADOWS

6411-6551 Centralia Road | Chesterfield, VA 23832



**S.L. NUSBAUM**  
REALTY CO.



### AVAILABLE SPACES

	SUITE	TENANT	SIZE
■	11	Available	1,375 SF
■	5-6 (South)	Available	1,200 SF



# TRADE AREA

## CHESTERFIELD MEADOWS

6411-6551 Centralia Road | Chesterfield, VA 23832



S.L. NUSBAUM  
REALTY CO.





# ADDITIONAL PHOTOS

CHESTERFIELD MEADOWS

6411-6551 Centralia Road | Chesterfield, VA 23832



S.L. NUSBAUM  
REALTY CO.





# CONTACT INFORMATION

## CHESTERFIELD MEADOWS

6411-6551 Centralia Road | Chesterfield, VA 23832



S.L. NUSBAUM

REALTY CO.

### BOB BUTCHER

Senior Vice President

C. 804.387.8194

O. 804.320.7600

bbutcher@slnusbaum.com

### ANDREW THACKER

Vice President

C. 804.357.6075

O. 804.320.7600

athacker@slnusbaum.com

### COMMITMENT. INTEGRITY. EXCELLENCE. SINCE 1906.

Serving the Southeast and Mid-Atlantic region for well over a century, S.L. Nusbaum Realty Co. continues to provide a comprehensive experience for our clients and customers in all aspects of the multifamily and commercial real estate industry.

[CLICK HERE TO LEARN MORE](#)

PROUD PARTNER

**XTEAM**

RETAIL ADVISORS

[CLICK HERE TO LEARN MORE](#)

### DISCLAIMER:

No warranty or representation, expressed or implied, is made to the accuracy or completeness of the information contained herein, and same is submitted subject to errors, omissions, change of price, rental or other conditions, withdrawal without notice, and to any special listing conditions imposed by the property owner(s). As applicable, we make no representation as to the condition of the property (or properties) in question.