

OVERALL FLOOR PLAN | 4,500 SF

Large, open “brick and timber” creative space with high ceilings, natural light and outdoor patio access. Wide variety of seating and event options from formal to informal. Free parking onsite. Walking distance to The Healdsburg Plaza, restaurants, shopping and tasting rooms.



The Vault

Stunning room with 65" Hi-def cast compatible TV, walnut ceiling, and blasted concrete walls. Former bank vault. Seats up to 8.



Fireplace Lounge

High-ceilinged 'lounge' with a range of seating options including couches, soft chairs, and high-top tables. Striking central fireplace and private bar with mini-frig, icemaker, and sink.

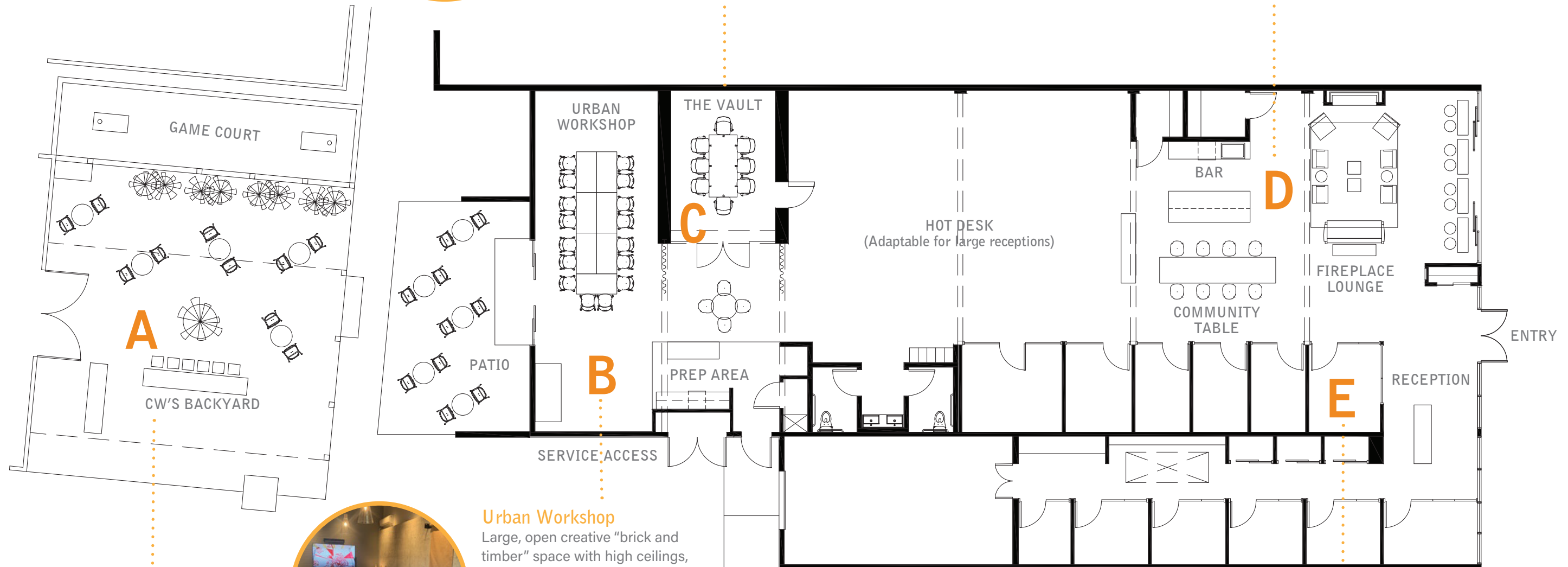

Urban Workshop

Large, open creative “brick and timber” space with high ceilings, natural light, and patio access. 85" Hi-def cast compatible TV. Large pin-up walls and whiteboard. Wide variety of seating options from formal to informal. See options available on insert.



CW'S Backyard

Hidden, quiet, open-air patio in the back of CraftWork. Overhead Tivoli lighting. Easily access for Food Trucks and caterers. Outdoor games and music. Large rustic bar with plenty of flexible seating options.



The Closer

Comfortable, daylit space designed for small meetings and breakout groups. Seats up to four with round table and cast compatible hided 55" TV screen.