

FOR LEASE



RETAIL / OFFICE / MEDICAL

5900 E 82nd Street, Indianapolis, IN 46250



PROPERTY OVERVIEW

Prime space available for retail, office, or medical uses right in front of Castleton Square Mall on East 82nd Street with facades facing both south and east.

SUMMARY

AVAILABLE SF:	1,500 - 11,050 SF	POPULATION (5 MI):	83,525
LEASE RATE:	\$19.74 /SF NNN	AVG HH INCOME (5 MI):	\$61,192

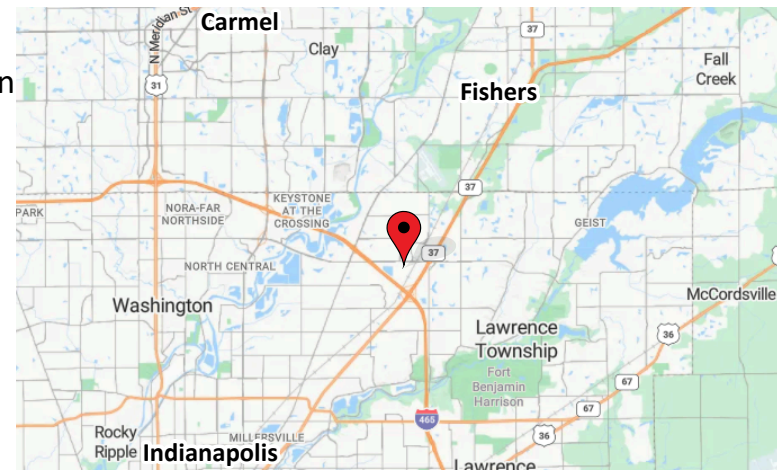

KW COMMERCIAL
G2 Real Estate Group
8555 N River Road,
Ste. 200
Indianapolis, IN 46240

ROBERT BUTCHER
Director, Commercial Broker
rbutcher@g2reg.com

O: (317) 564-7100
C: (317) 281-2514
IN #RB18000445

Each Office Independently Owned and Operated kwcommercial.com

FOR LEASE



RETAIL / OFFICE / MEDICAL

5900 E 82nd Street, Indianapolis, IN 46250

(SOUTHEAST CORNER) FLOOR PLAN

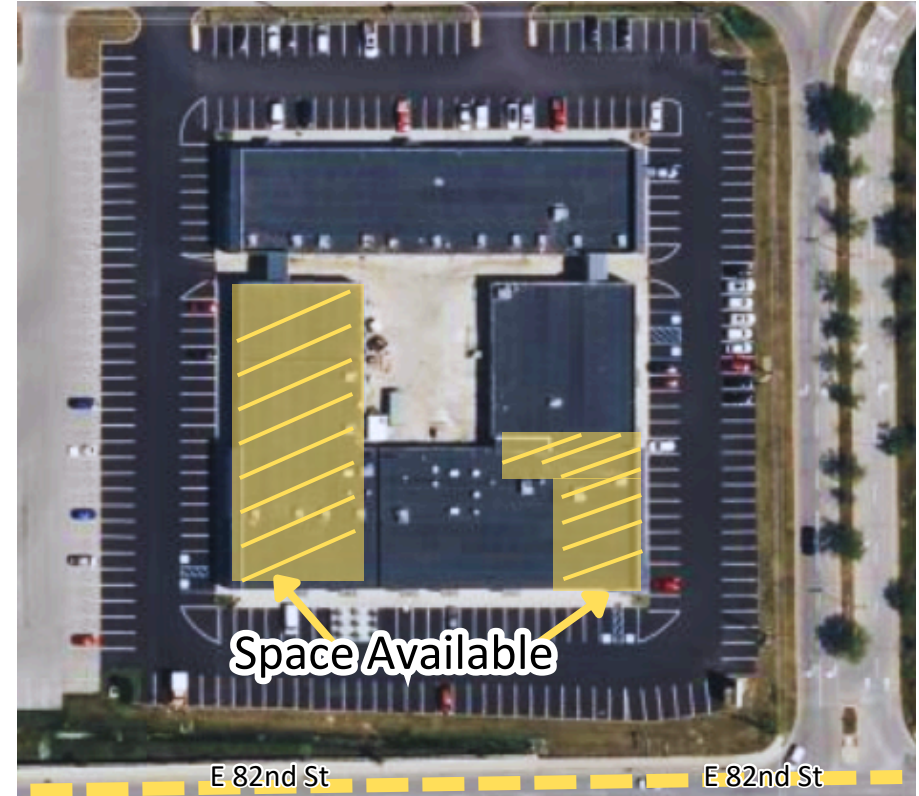
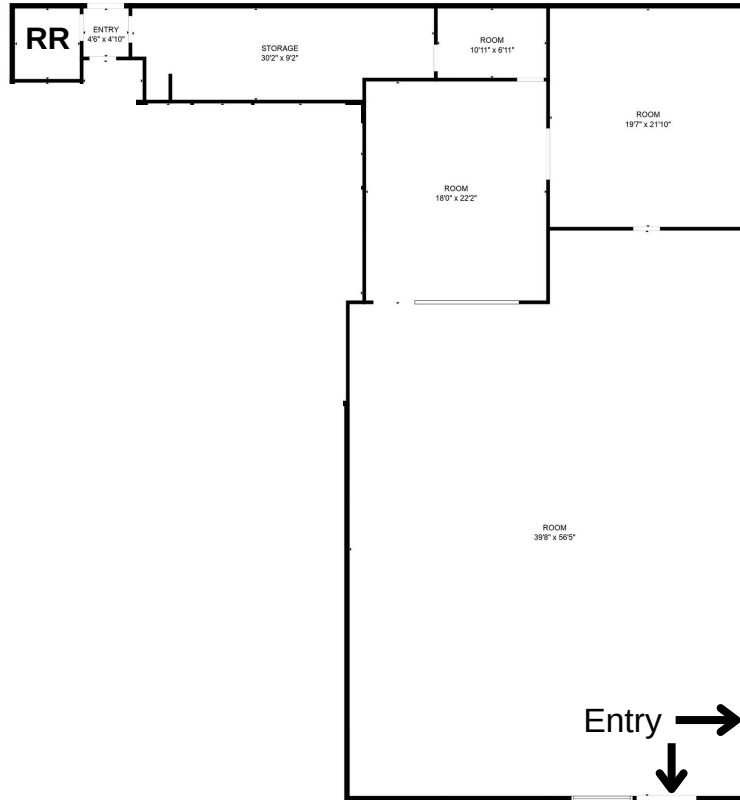

TOTAL OF SIX (6) AVAILABLE SPACES

- 1,500 SF
- 2,000 SF
- 3,150 SF
- 3,500 SF
- 7,900 SF
- 11,050 SF

MAX CONTIGUOUS SPACE = 11,050 SF

KW COMMERCIAL 8555 N River Road,
G2 Real Estate Group Ste. 200
Indianapolis, IN 46240

ROBERT BUTCHER O: (317) 564-7100
Director, Commercial Broker C: (317) 281-2514
rbutcher@g2reg.com IN #RB18000445

Each Office Independently Owned and Operated kwcommercial.com