



Central Deer Valley

21602, 21616 & 21628 North Central Ave.
Phoenix, AZ 85024



INDUSTRIAL SUITES AVAILABLE FOR LEASE

21602 N CENTRAL AVE
SUITE 3*
±2,060 SF | \$1.50 IG

21602 N CENTRAL AVE
SUITE 4*
±2,060 SF | \$1.50 IG

21616 N CENTRAL AVE
SUITE 8
±1,225 SF | \$1.50 MG

***SUITES ARE CONTIGUOUS**

- LOCATED DIRECTLY ACROSS FROM DEER VALLEY AIRPORT
- IMMEDIATE ACCESS TO I-17 & LOOP 101
- PART OF A ±52,860 SF PROJECT
- ZONING: A-1, CITY OF PHOENIX
- 12' CLEAR HEIGHT, 10'X10' OVERHEAD DOOR
- 1986 CONSTRUCTION
- 86 SURFACE PARKING SPACES AVAILABLE

Keith Clark
M: 602.740.7869
kclark@cpiaz.com



COMMERCIAL PROPERTIES INC.

Locally Owned. Globally Connected. CORFAC

TEMPE: 2323 W University Drive, Tempe, AZ 85281 | 480.966.2301
SCOTTSDALE: 8767 E Via de Commercio, Suite 101, Scottsdale, AZ 85258 | www.cpiaz.com

The information contained herein has been obtained from various sources. We have no reason to doubt its accuracy; however, J & J Commercial Properties, Inc. has not verified such information and makes no guarantee, warranty or representation about such information. The prospective buyer or lessee should independently verify all dimensions, specifications, floor plans, and all information prior to the lease or purchase of the property. All offerings are subject to price change, prior sale, lease, or withdrawal from the market without prior notice. Effective: 10/23/25

Central Deer Valley

21602, 21616 & 21628 NORTH CENTRAL AVE.
PHOENIX, AZ 85024

INDUSTRIAL SUITES AVAILABLE FOR LEASE

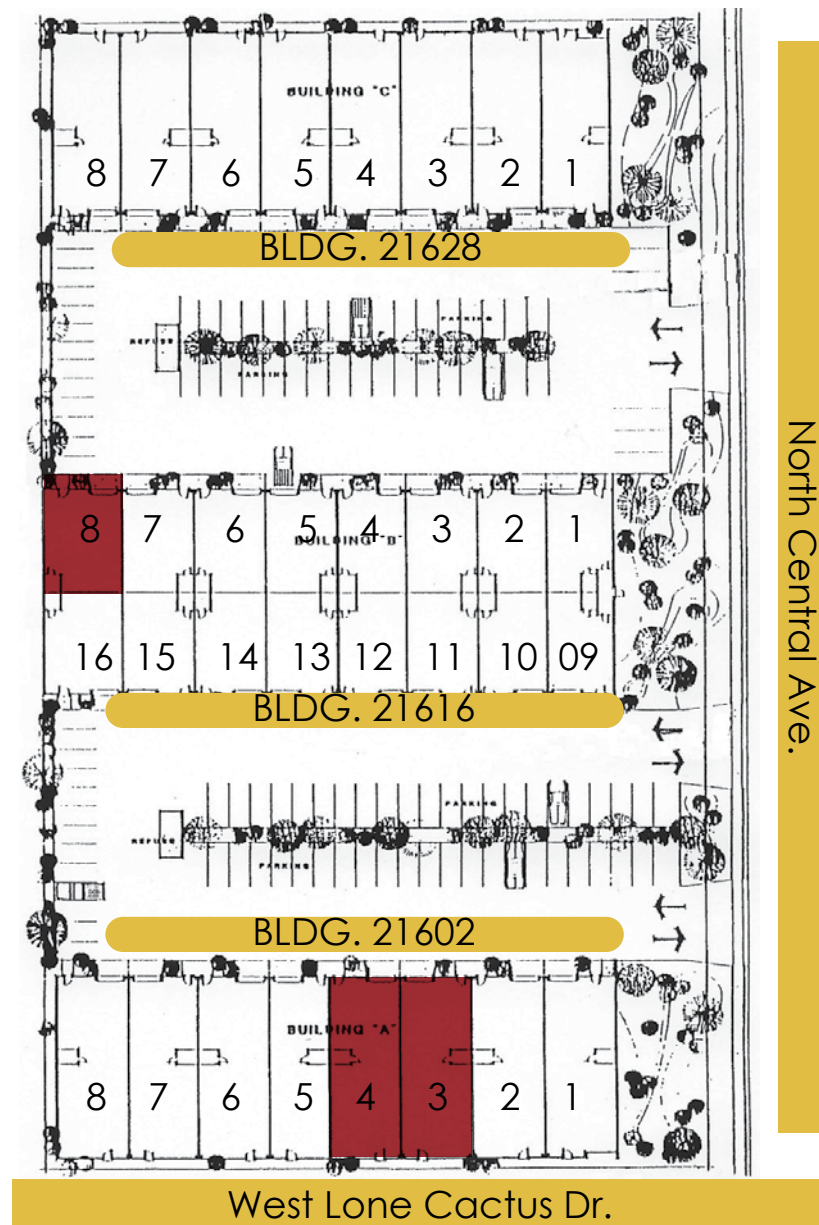

AVAILABLE SUITES

Keith Clark
M: 602.740.7869
kclark@cpiaz.com



COMMERCIAL PROPERTIES INC.

Locally Owned, Globally Connected. CORFAC

TEMPE: 2323 W University Drive, Tempe, AZ 85281 | 480.966.2301
SCOTTSDALE: 8767 E Via de Commercio, Suite 101, Scottsdale, AZ 85258 | www.cpiac.com