

SHORT TERM, MOVE-READY, INDUSTRIAL SPACE FOR SUBLEASE



5201 Phillip Lee Drive

ATLANTA, GEORGIA 30336

STREAM



5201 Phillip Lee

ATLANTA, GEORGIA 30336

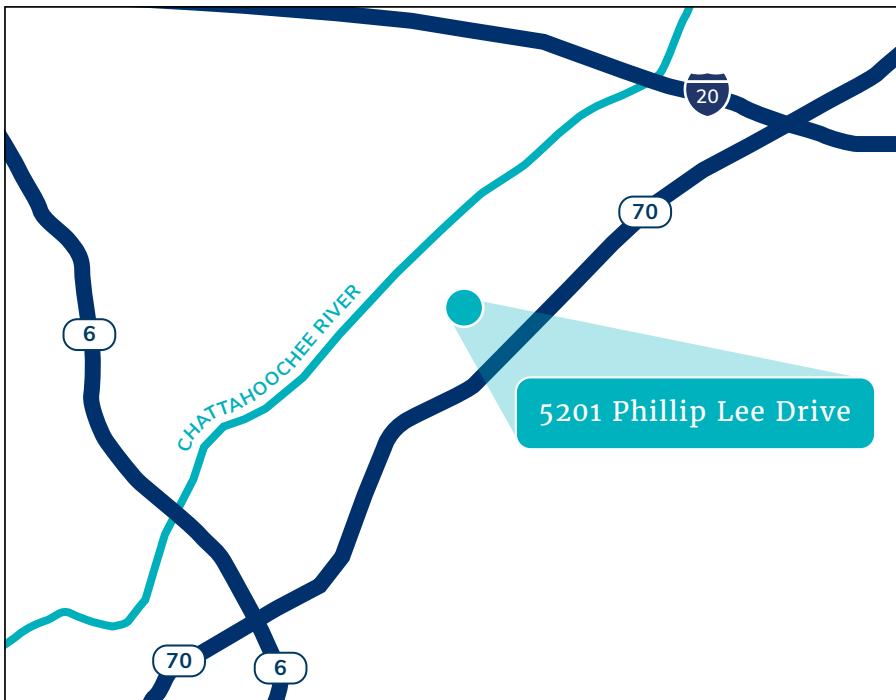

■ AVAILABILITY HIGHLIGHTS

Available Through 03/31/2029
(Will Accommodate as short as 6 Months)

Size 136,608 SF

Office 2,204 SF

Dock Count 19 Dock Doors

Drive-In 1

Ceiling Height 22'

Column Spacing 45' x 25"



5201 Phillip Lee

ATLANTA, GEORGIA 30336

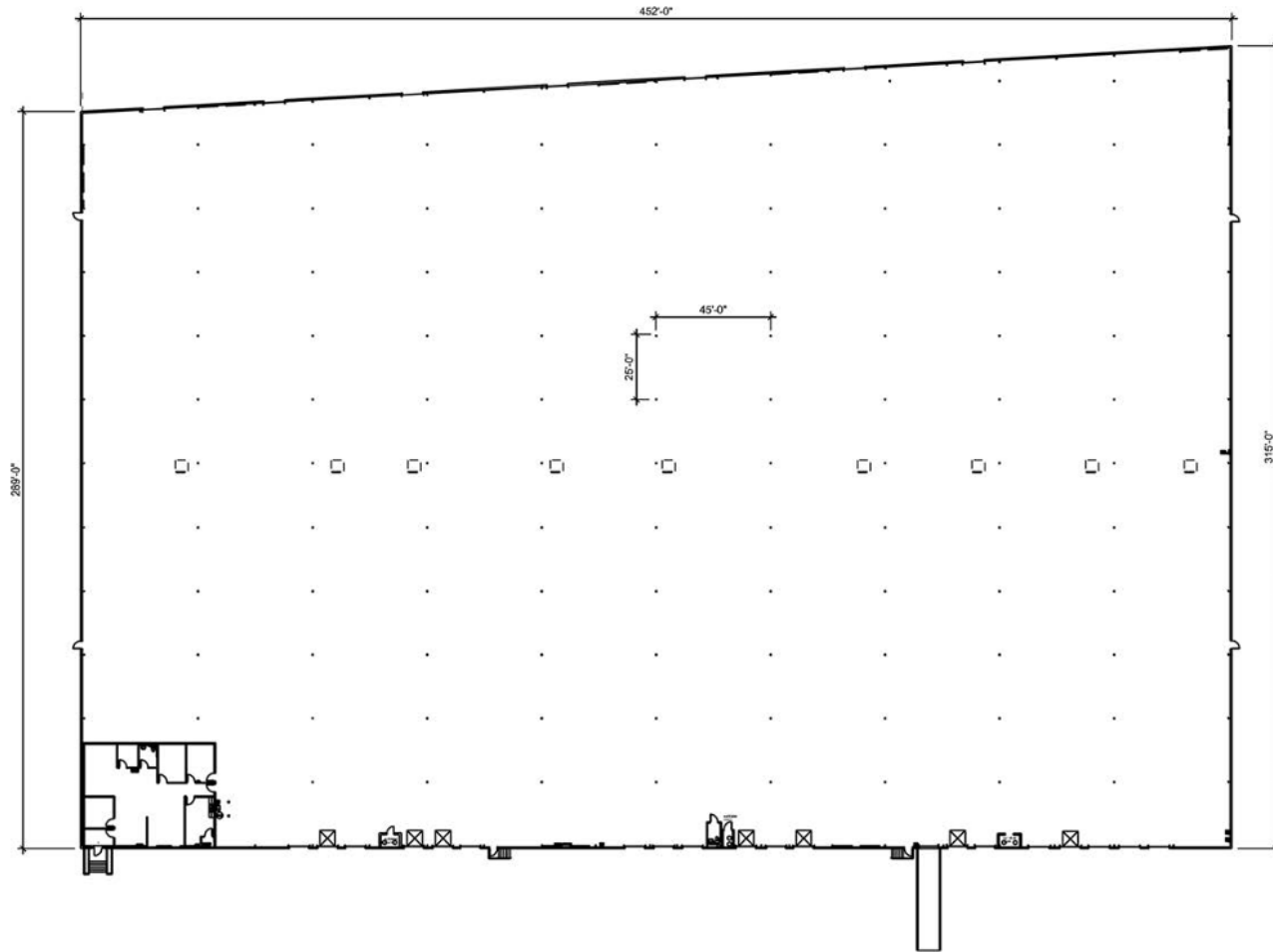

TOTAL
136,608 RSF



5201 Phillip Lee

ATLANTA, GEORGIA 30336





JACK SALLIS

Senior Vice President

jack.sallis@streamrealty.com

404.962.8651

EMILY LAFFERTY

Analyst

emily.lafferty@streamrealty.com

404.962.8690