

# FLEX FOR SUBLEASE

756 Harmon Avenue, Columbus, OH, 43223



## Property Summary

Building Size:	3,360 SF
Dock Door:	(1) 10'x10' Door
Drive-in Door:	(1) 8'x10' Door
Ceiling Height:	12'
Office:	160 SF
Monthly Rate:	\$3,570.00* MG
*Tenant pays utilities	

## Property Overview

- Outstanding Freeway access including I-70, I-71, OH 315, I-270
- 9.6 miles to John Glenn International
- 29 miles to Intel
- LED Lighting
- 1 Dock, 1 Drive-In and 2 man doors
- Secure truck court with 24/7 Access
- **Sublease though April 30, 2027**



**Douglas D. Smith**  
dsmith@cutlercigroup.com  
(614) 869-7139



# FLEX FOR SUBLEASE

756 Harmon Avenue, Columbus, OH, 43223  
Site Location

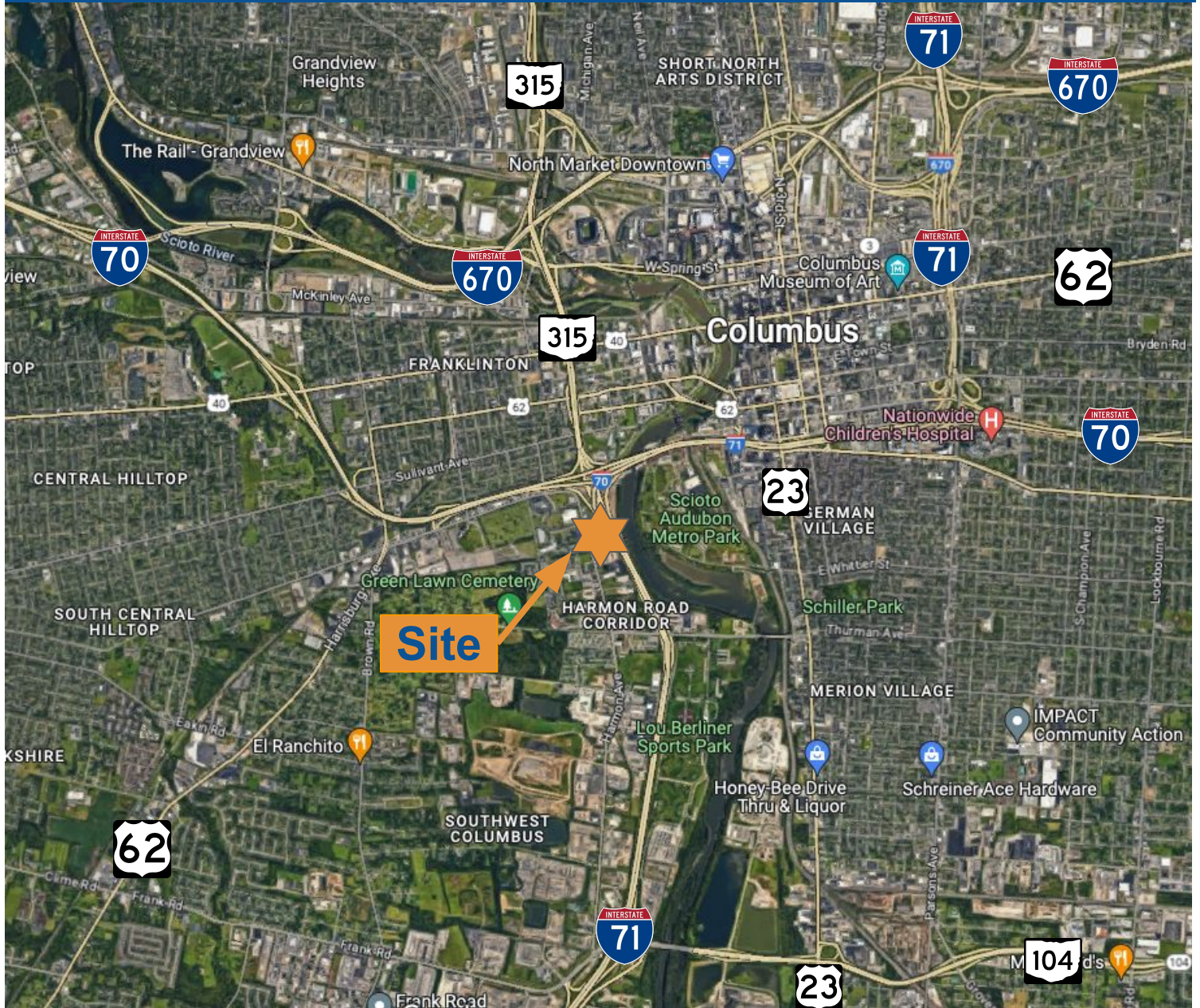

**3,360 SF**  
**Sublease through April 30, 2027**

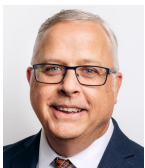

**Douglas D. Smith**  
dsmith@cutlercigroup.com  
(614) 869-7139



# FLEX FOR SUBLEASE

756 Harmon Avenue, Columbus, OH, 43223  
Floor Plan

See next page for keyed photos

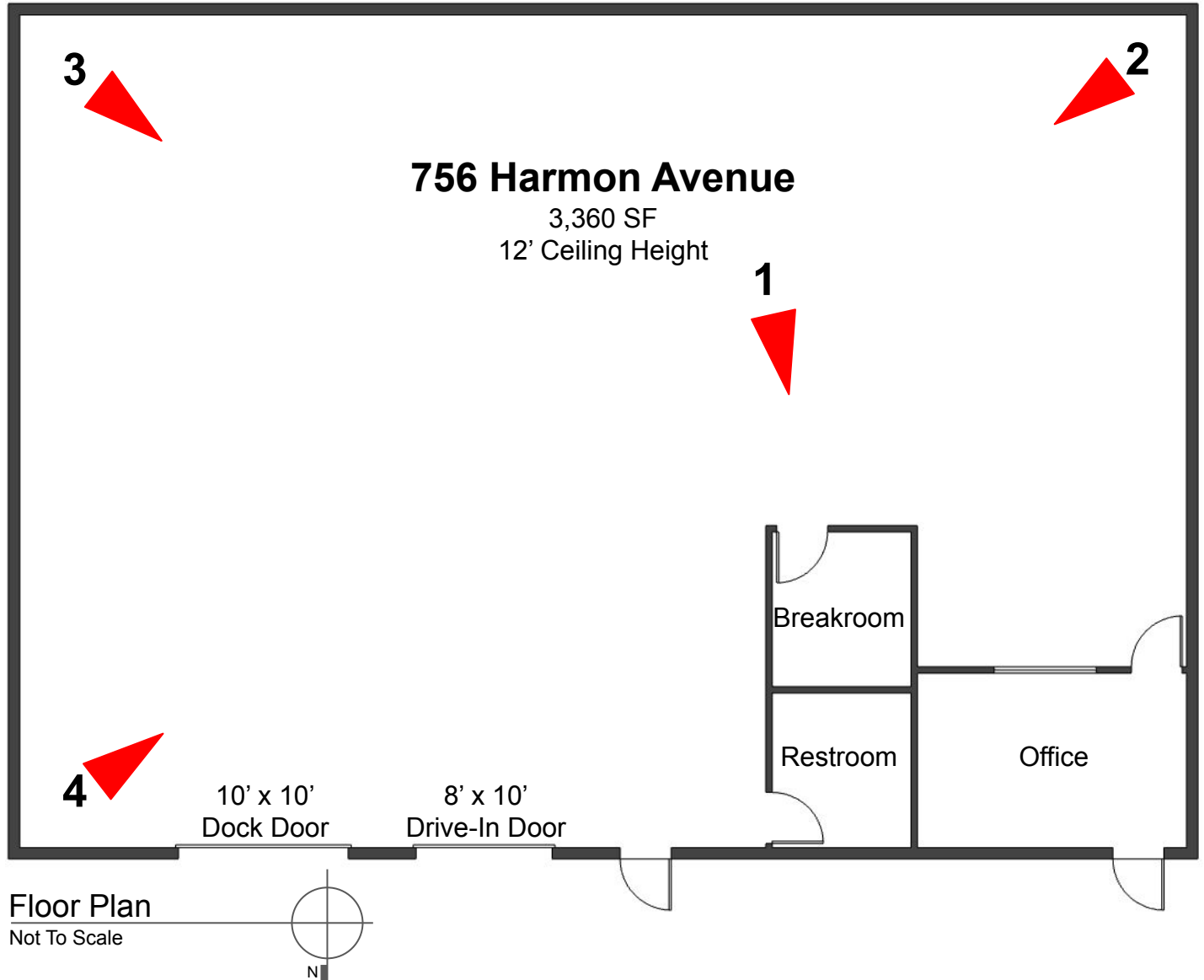

**3,360 SF**  
**Sublease through April 30, 2027**

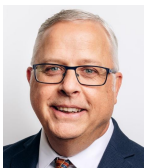

**Douglas D. Smith**  
dsmith@cutlercigroup.com  
(614) 869-7139



# FLEX FOR SUBLEASE

756 Harmon Avenue, Columbus, OH, 43223  
Interior Photos



**3,360 SF**  
**Sublease through April 30, 2027**



**Douglas D. Smith**  
dsmith@cutlercigroup.com  
(614) 869-7139



# FLEX FOR SUBLEASE

756 Harmon Avenue, Columbus, OH, 43223  
Exterior Photos



**3,360 SF**  
**Sublease through April 30, 2027**



**Douglas D. Smith**  
dsmith@cutlercigroup.com  
(614) 869-7139



# FLEX FOR SUBLEASE

756 Harmon Avenue, Columbus, OH, 43223  
Proximity to Intel

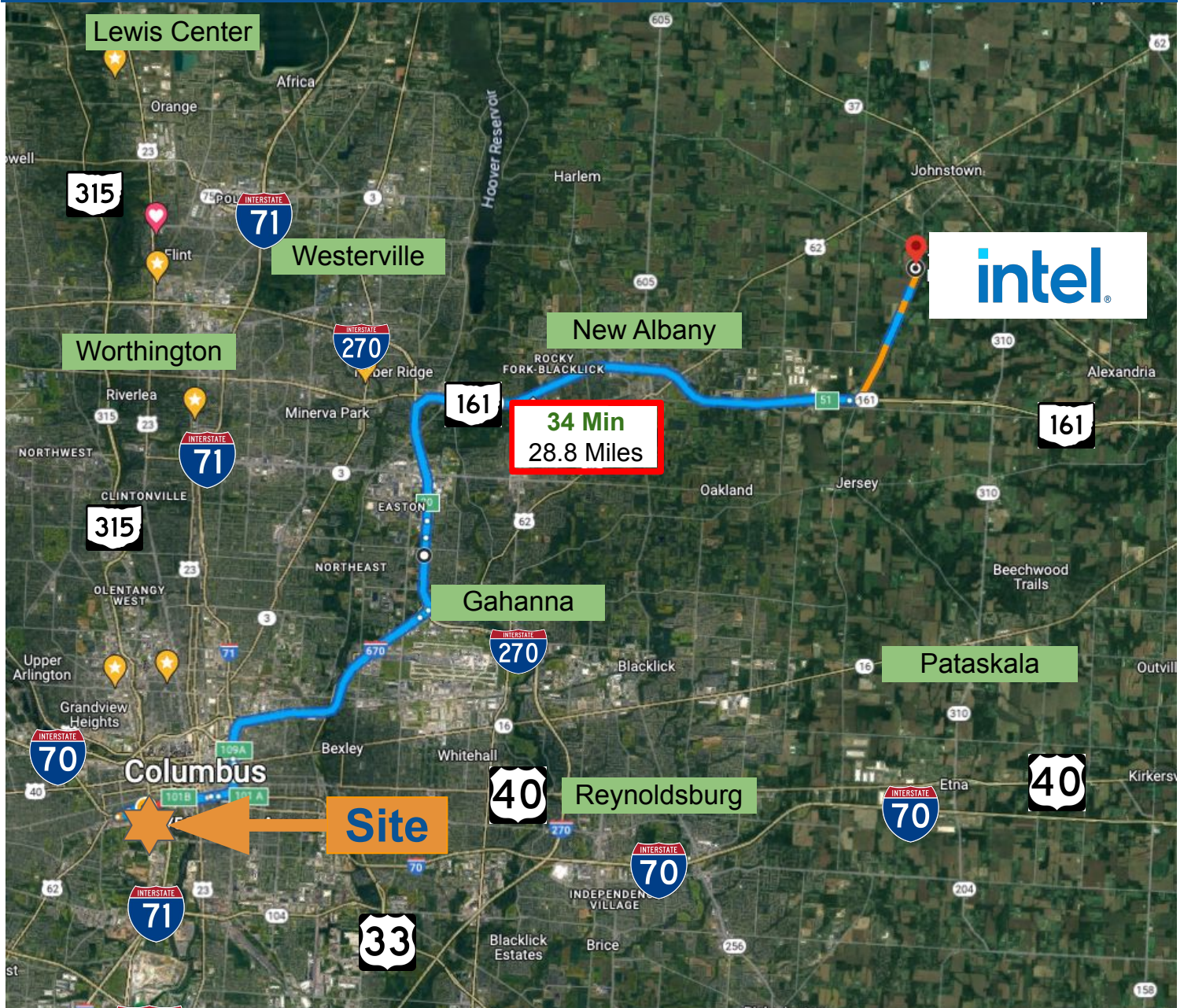

28.8 Miles to Intel (34 Minutes)  
Sublease through April 30, 2027



**Douglas D. Smith**  
dsmith@cutlercigroup.com  
(614) 869-7139

