



±7,274 SF INDUSTRIAL FACILITY
FOR LEASE 5731 MCFADDEN AVE. SUITE A
 HUNTINGTON BEACH | CA



**7,274 SF
 INDUSTRIAL
 FACILITY**



**±2,000 SF
 OFFICE**



**TWO (2) GL DOORS
 (10' X 10')**



**200 AMPS
 (120/208V) *
 VERIFY**

FOR MORE INFORMATION, CONTACT US:



MIKE BARREIRO, SIOR
 E.V.P | PRINCIPAL
 P: 949.355.8500
 mbarreiro@daumcre.com
 CA DRE License #01712620



DEVIN RAY
 VICE PRESIDENT
 M: 714.322.1252
 dray@daumcre.com
 CA DRE License #02018130



DOUGLAS A. CLAMAN
 FOUNDER & MANAGING PRINCIPAL
 P: 310.251.6656
 daclaman@jaadpartners.com
 CA DRE License #01871655



D/AQ Corp. #01129558. Maps Courtesy ©Google & ©Microsoft. Although all information is furnished regarding for sale, rental or financing from sources deemed reliable, such information has not been verified and no express representation is made nor is any to be implied as to the accuracy thereof, and it is submitted subject to errors, omissions, changes of price, rental or other conditions, prior sale, lease or financing, or withdrawal without notice.

FOR LEASE: 7,274 SF INDUSTRIAL FACILITY

±7,274 SF
INDUSTRIAL
FACILITY

5731 MCFADDEN AVE., SUITE A
HUNTINGTON BEACH | CA

FOR LEASE

PROPERTY HIGHLIGHTS

- 7,274 SF Industrial Facility
- ±2,000 SF Office
- 14' Warehouse Clearance
- Two (2) GL Doors (10' x 10')
- 200 Amps (120/208v) * Verify
- Five (5) Private Offices
- Break Room
- Two (2) Restrooms
- McFadden Street Frontage
- Professionally Managed Business Park



ABOUT
THE
PROPERTY

D/AQ Corp. #01129558. Maps Courtesy ©Google & ©Microsoft. Although all information is furnished regarding for sale, rental or financing from sources deemed reliable, such information has not been verified and no express representation is made nor is any to be implied as to the accuracy thereof, and it is submitted subject to errors, omissions, changes of price, rental or other conditions, prior sale, lease or financing, or withdrawal without notice.

±7,274 SF
INDUSTRIAL
FACILITY

5731 MCFADDEN AVE., SUITE A
HUNTINGTON BEACH | CA

FOR LEASE



FOR MORE INFORMATION, CONTACT US:



MIKE BARREIRO, SIOR
E.V.P | PRINCIPAL
P: 949.355.8500
mbarreiro@daumcre.com
CA DRE License #01712620



DEVIN RAY
VICE PRESIDENT
M: 714.322.1252
dray@daumcre.com
CA DRE License #02018130



DOUGLAS A. CLAMAN
FOUNDER & MANAGING PRINCIPAL
P: 310.251.6656
daclaman@jaadpartners.com
CA DRE License #01871655



 **DAUM**
COMMERCIAL REAL ESTATE SERVICES

±7,274 SF
INDUSTRIAL
FACILITY

5731 MCFADDEN AVE., SUITE A
HUNTINGTON BEACH | CA

FOR LEASE

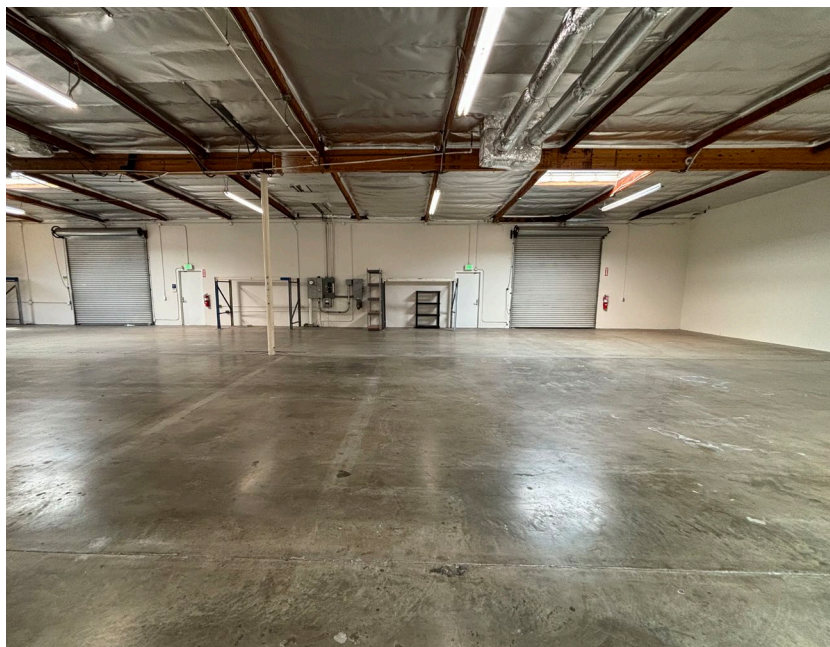

FOR MORE INFORMATION, CONTACT US:



MIKE BARREIRO, SIOR
E.V.P | PRINCIPAL
P: 949.355.8500
mbarreiro@daumcre.com
CA DRE License #01712620



DEVIN RAY
VICE PRESIDENT
M: 714.322.1252
dray@daumcre.com
CA DRE License #02018130



DOUGLAS A. CLAMAN
FOUNDER & MANAGING PRINCIPAL
P: 310.251.6656
daclaman@jaadpartners.com
CA DRE License #01871655



 **DAUM**
COMMERCIAL REAL ESTATE SERVICES

±7,274 SF
INDUSTRIAL
FACILITY

FLOOR PLAN

5731 MCFADDEN AVE., SUITE A
HUNTINGTON BEACH | CA

FOR LEASE

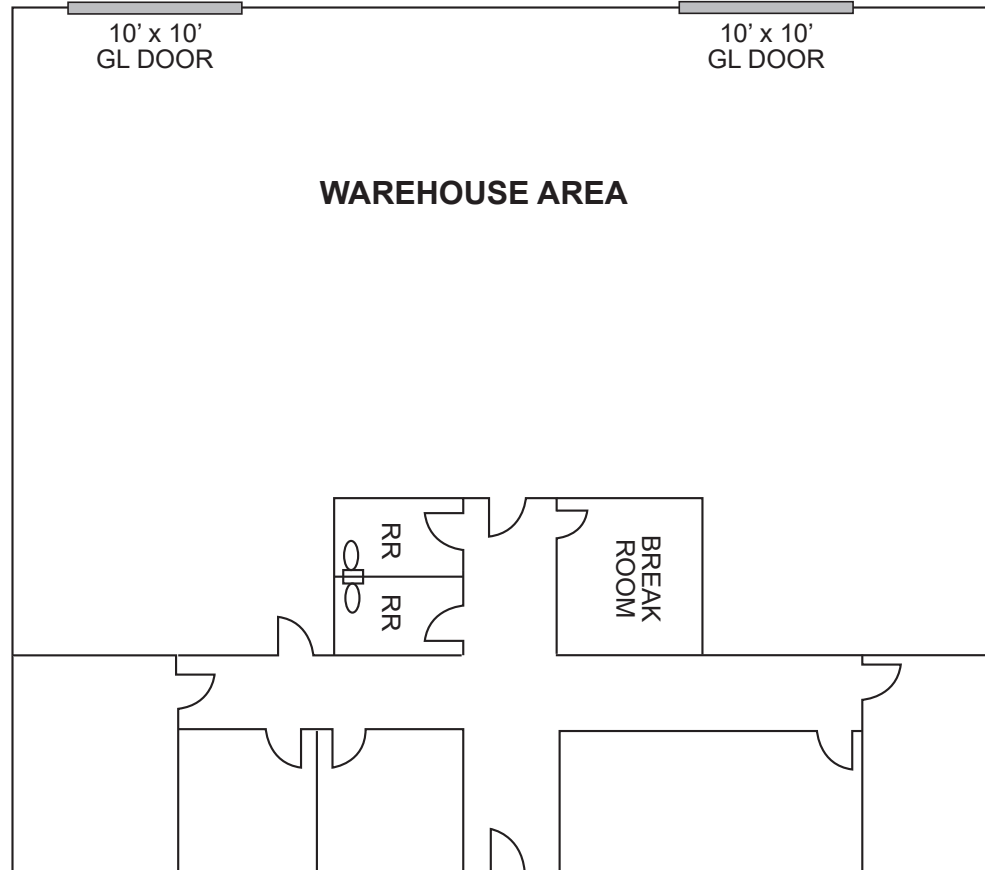

FOR MORE INFORMATION, CONTACT US:



MIKE BARREIRO, SIOR
E.V.P | PRINCIPAL
P: 949.355.8500
mbarreiro@daumcre.com
CA DRE License #01712620



DEVIN RAY
VICE PRESIDENT
M: 714.322.1252
dray@daumcre.com
CA DRE License #02018130



DOUGLAS A. CLAMAN
FOUNDER & MANAGING PRINCIPAL
P: 310.251.6656
daclaman@jaadpartners.com
CA DRE License #01871655



±7,274 SF
INDUSTRIAL
FACILITY

5731 MCFADDEN AVE., SUITE A
HUNTINGTON BEACH | CA

FOR LEASE



Google

FOR MORE INFORMATION, CONTACT US:



MIKE BARREIRO, SIOR
E.V.P | PRINCIPAL
P: 949.355.8500
mbarreiro@daumcre.com
CA DRE License #01712620



DEVIN RAY
VICE PRESIDENT
M: 714.322.1252
dray@daumcre.com
CA DRE License #02018130



DOUGLAS A. CLAMAN
FOUNDER & MANAGING PRINCIPAL
P: 310.251.6656
daclaman@jaadpartners.com
CA DRE License #01871655

