



Commercial and Industrial Real Estate
Sales and Leasing
Property Management

Joey Betbeze
3345 Halls Mill Road
Mobile, Alabama 36606

Office: 251.476.4111
Cell: 251.554.8145

JoeyBetbeze@BetbezeRealty.com
www.BetbezeRealty.com

OFFICE/WAREHOUSE SPACE FOR LEASE

**1110 Leroy Stevens Road
Mobile, Alabama 36695**



Approximately 2,000 square foot office/warehouse space located in west Mobile. 1,000 square feet of newly renovated office space and 1,000 square feet of open warehouse space.



- 2,000 square foot office/warehouse space.
- 1,000 s.f. of office space.
- 1,000 s.f. of warehouse space.
- One 10' x10' overhead door.
- Small yard.
- **\$1,75000/Mo.**

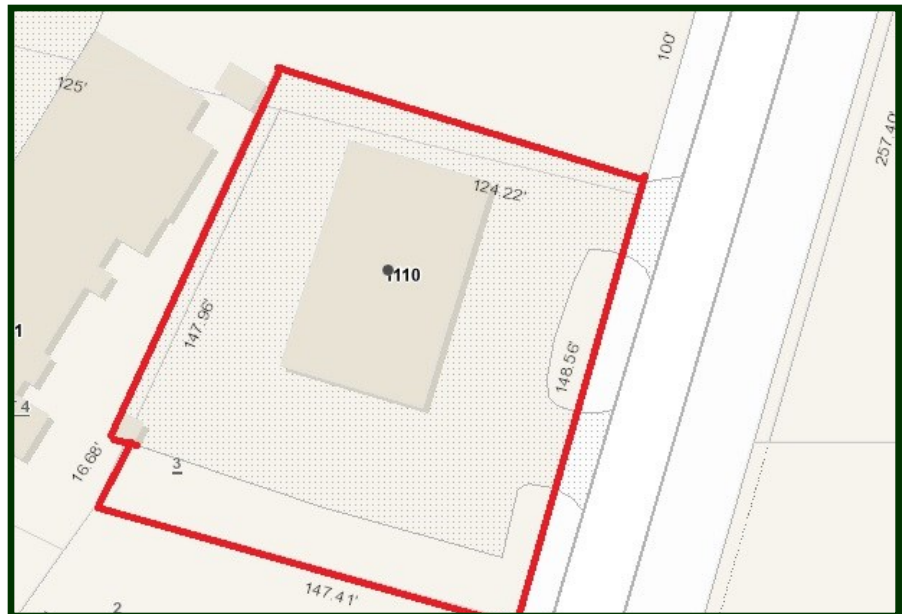

Located approximately 1 mile south of Airport Blvd. and approximately .2 miles from the intersection of Leroy Stevens Road and Dawes Road.

The information above has been obtained from sources believed reliable. While we do not doubt its accuracy we have not verified it and make no guarantee, warranty or representation about it. It is your responsibility to independently confirm its accuracy and completeness. Any projections, opinions, assumptions, or estimates used are for example only and do not represent the current or future performance of the property. The value of this transaction to you depends on tax and other factors which should be evaluated by your tax, financial, and legal advisors. You and your advisors should conduct a careful, independent investigation of the property to determine to your satisfaction the suitability of the property for your needs.











