

# WESTERVILLE

## OFFICE FOR LEASE

575 CHARRING CROSS DRIVE, WESTERVILLE, OH 43081



JEFF MEYER VICE PRESIDENT

MOBILE 614.301.4212  
JMEYER@EQUITY.NET



The information contained herein has been obtained from the property owner or other sources that we deem reliable. Although we have no reason to doubt its accuracy, no representation or warranty is made regarding the information, and the property is offered "as is". The submission may be modified or withdrawn at any time by the property owner.

# PROPERTY HIGHLIGHTS

- +/- 2,800 SF available (Suite A)
- First floor space built out as medical office
- Near St. Ann's Hospital
- Close proximity to I-270
- Walking distance to shopping and dining
- Monument signage
- Lease rate: \$19.00 psf full service gross
- Available now

## WESTERVILLE

OFFICE FOR LEASE

575 CHARRING CROSS DRIVE, WESTERVILLE, OH 43081





# SPACE PLAN

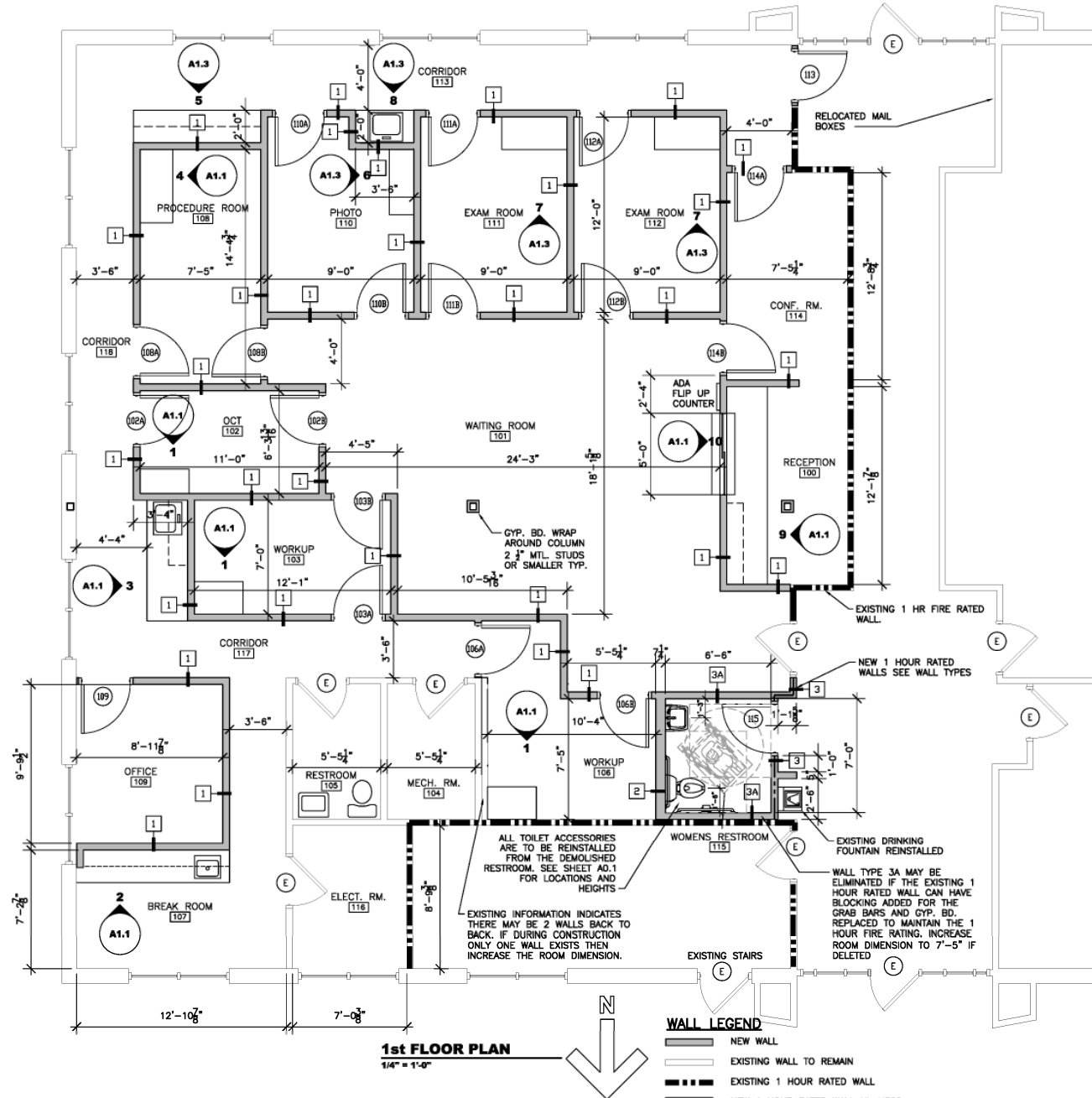

# PHOTOS





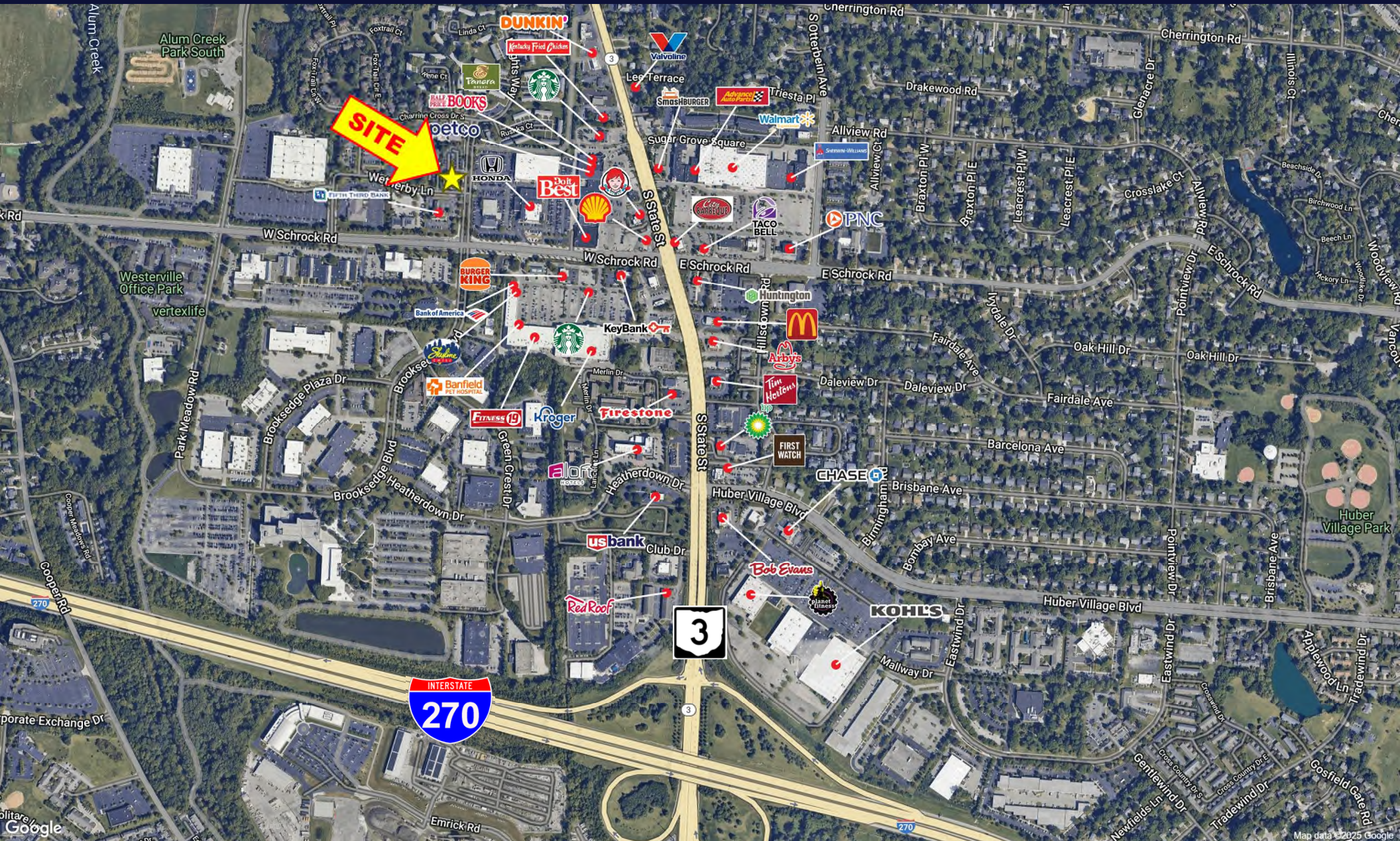



# 1-MILE RADIUS DEMOS

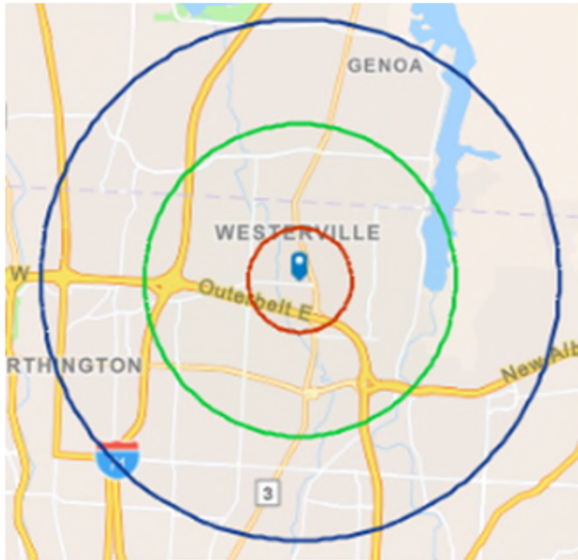

## KEY FACTS

**8,569**  
Population

**2.3**  
Average  
Household Size

**38.0**  
Median Age

**\$77,302**  
Median Household Income

## BUSINESS

**969**

Total Businesses

**11,853**

Total Employees

## EDUCATION

**3%**

No High School  
Diploma

**23%**

High School  
Graduate

**29%**

Some  
College

**45%**

Bachelor's/Grad/Prof  
Degree

## INCOME

**\$41,399**  
Per Capita  
Income

**\$77,302**  
Median  
Household  
Income

**\$101,515**  
Average  
Household  
Income

## EMPLOYMENT

**72.0**  
White  
Collar %

**12.5**  
Blue  
Collar %

**15.5**  
Services  
%

**equity** | brokerage

The information contained herein has been obtained from the property owner or other sources that we deem reliable. Although we have no reason to doubt its accuracy, no representation or warranty is made regarding the information, and the property is offered "as is." The submission may be modified or withdrawn at any time by the property owner.

# 3-MILE RADIUS DEMOS

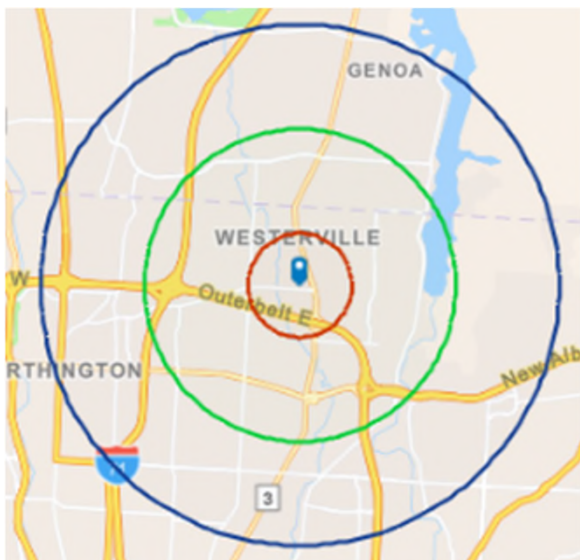

## KEY FACTS

**105,707**  
Population

**2.5**  
Average  
Household Size

**37.2**  
Median Age

**\$79,078**  
Median Household Income

## BUSINESS

**4,386**

Total Businesses

**58,835**

Total Employees

## EDUCATION

**5%**

No High School  
Diploma

**23%**

High School  
Graduate

**25%**

Some  
College

**47%**

Bachelor's/Grad/Prof  
Degree

## INCOME



**\$41,943**  
Per Capita  
Income



**\$79,078**  
Median  
Household  
Income



**\$105,436**  
Average  
Household  
Income

## EMPLOYMENT



**67.7**  
White  
Collar %



**15.9**  
Blue  
Collar %



**16.3**  
Services  
%

**equity** | brokerage

The information contained herein has been obtained from the property owner or other sources that we deem reliable. Although we have no reason to doubt its accuracy, no representation or warranty is made regarding the information, and the property is offered "as is." The submission may be modified or withdrawn at any time by the property owner.

# 5-MILE RADIUS DEMOS

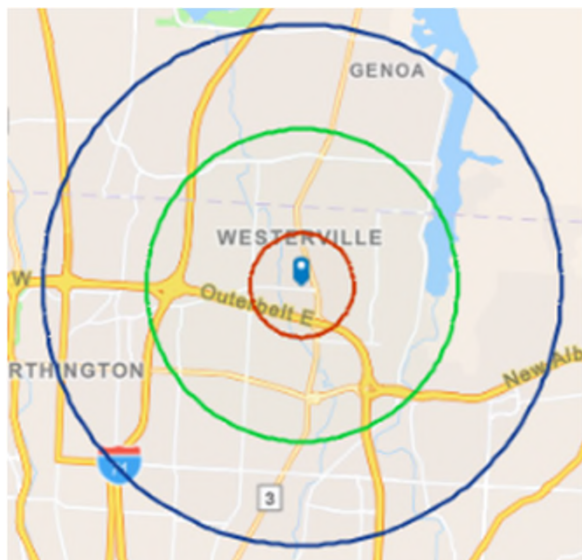

## KEY FACTS

**266,267**

Population



**2.5**

Average  
Household Size



**36.5**

Median Age

**\$80,677**

Median Household Income

## BUSINESS



**10,533**

Total Businesses



**156,620**

Total Employees

## EDUCATION



**6%**

No High School  
Diploma



**21%**

High School  
Graduate



**24%**

Some  
College



**49%**

Bachelor's/Grad/Prof  
Degree

## INCOME



**\$44,563**

Per Capita  
Income



**\$80,677**

Median  
Household  
Income



**\$110,337**

Average  
Household  
Income

## EMPLOYMENT



**69.3**

White  
Collar %



**15.8**

Blue  
Collar %



**14.9**

Services  
%

**equity** | brokerage

The information contained herein has been obtained from the property owner or other sources that we deem reliable. Although we have no reason to doubt its accuracy, no representation or warranty is made regarding the information, and the property is offered "as is." The submission may be modified or withdrawn at any time by the property owner.