

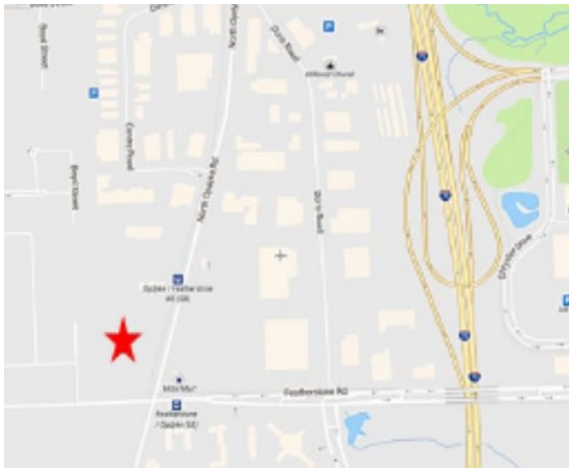

815 N. OPDYKE RD

AUBURN HILLS, MI



FOR SUBLEASE

Property Highlights

- 26,593 SF Available For Sublease
- Fully A/C Warehouse-Lab Space
- Ample Parking
- 30' Ceiling Height
- 1 (12'x14') Grade Level Door
- Term Through January 2032

For information, please contact:

GEOFF HILL

Executive Managing Director

t 248-350-1492

geoff.hill@ngkf.com

CHRIS HILL

Director

t 248-350-1192

chris.hill@ngkf.com

TEDDY O'KEEFE

Associate

t 248-447-2715

teddy.okeefe@ngkf.com

27725 Stansbury Blvd, Suite 300,
Farmington Hills, MI 48334

nrmk.com

NEWMARK

The information contained herein has been obtained from sources deemed reliable but has not been verified and no guarantee, warranty or representation, either express or implied, is made with respect to such information. Terms of sale or lease and availability are subject to change or withdrawal without notice.

Sublease

815 N Opdyke Rd Auburn Hills, MI 48326-2475



Pricing Information:

Lease Rate Range:	\$9.95-\$9.95 NNN
Lease Type:	NNN
Sale Price:	N/A
Price per SF:	N/A
Real Estate Taxes psf:	\$0.00
Building Insurance psf:	\$0.00
CAM psf:	N/A

Property Details:

Total Building Area:	109,565 sf	Parcel ID:	14-23-351-009 & 010
Min/Max Available:	26,593 sf	Parking Description:	70+
Office Area:	20,000 sf	Rail Served:	No
Property Type:	General Industrial	Cranes:	No
Tenancy:	Multi-tenant	Heat:	Fully HVAC
Year Built:	01/01/2018	Clear Height Min/Max:	30.0'
Year Renovated:		Grade/Dock Doors:	1 / N/A
Zoning:	Lt. Industrial	Sprinkler:	Yes
Site/Parcel Area:	7.20 acres	Power:	1,600 amps, 480 volt

Comments:

Heavy power with fully air-conditioned warehouse/lab space, office can be removed for additional warehouse/lab space, LED lights, 12'x14' grade level door, high end finishes, high ceilings.

Geoffrey Hill

248.350.1492

Geoff.Hill@nrmk.com

Chris Hill

248.350.1192

Chris.Hill@nrmk.com

Teddy O'Keefe

248.320.5216

Theodore.Okeefe@nrmk.com

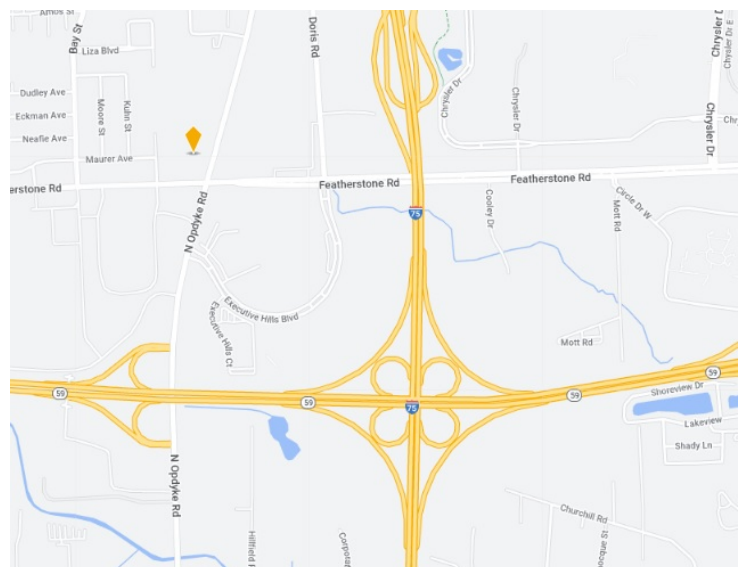

815 N. OPDYKE RD – FLOOR PLAN

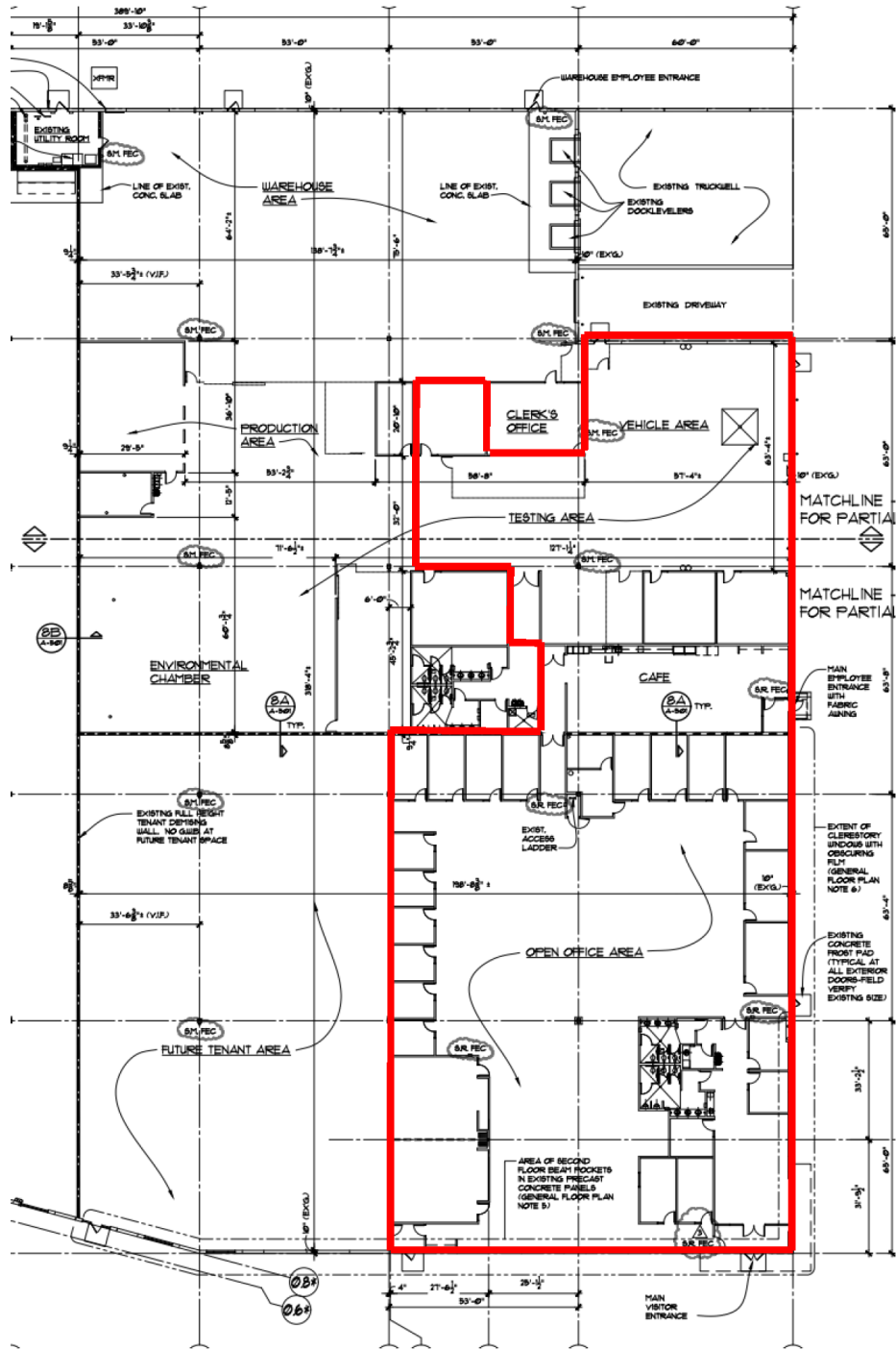

CONTACT

GEOFF HILL

Executive Managing Director

t 248-350-1492

geoff.hill@ngkf.com

CHRIS HILL

Director

t 248-350-1192

chris.hill@ngkf.com

TEDDY O'KEEFE

Associate

t 248-447-2715

teddy.okeefe@ngkf.com

815 N. OPDYKE RD – PHOTOS



CONTACT

GEOFF HILL

Executive Managing Director

t 248-350-1492

geoff.hill@ngkf.com

CHRIS HILL

Director

t 248-350-1192

chris.hill@ngkf.com

TEDDY O'KEEFE

Associate

t 248-447-2715

teddy.okeefe@ngkf.com

NEWMARK