

29C Hayward St
 First Floor
 W/Mezzanine 7,235 GSF
 1/8" = 1'-0" 6/11/23

Shop
25.5 sq ft.

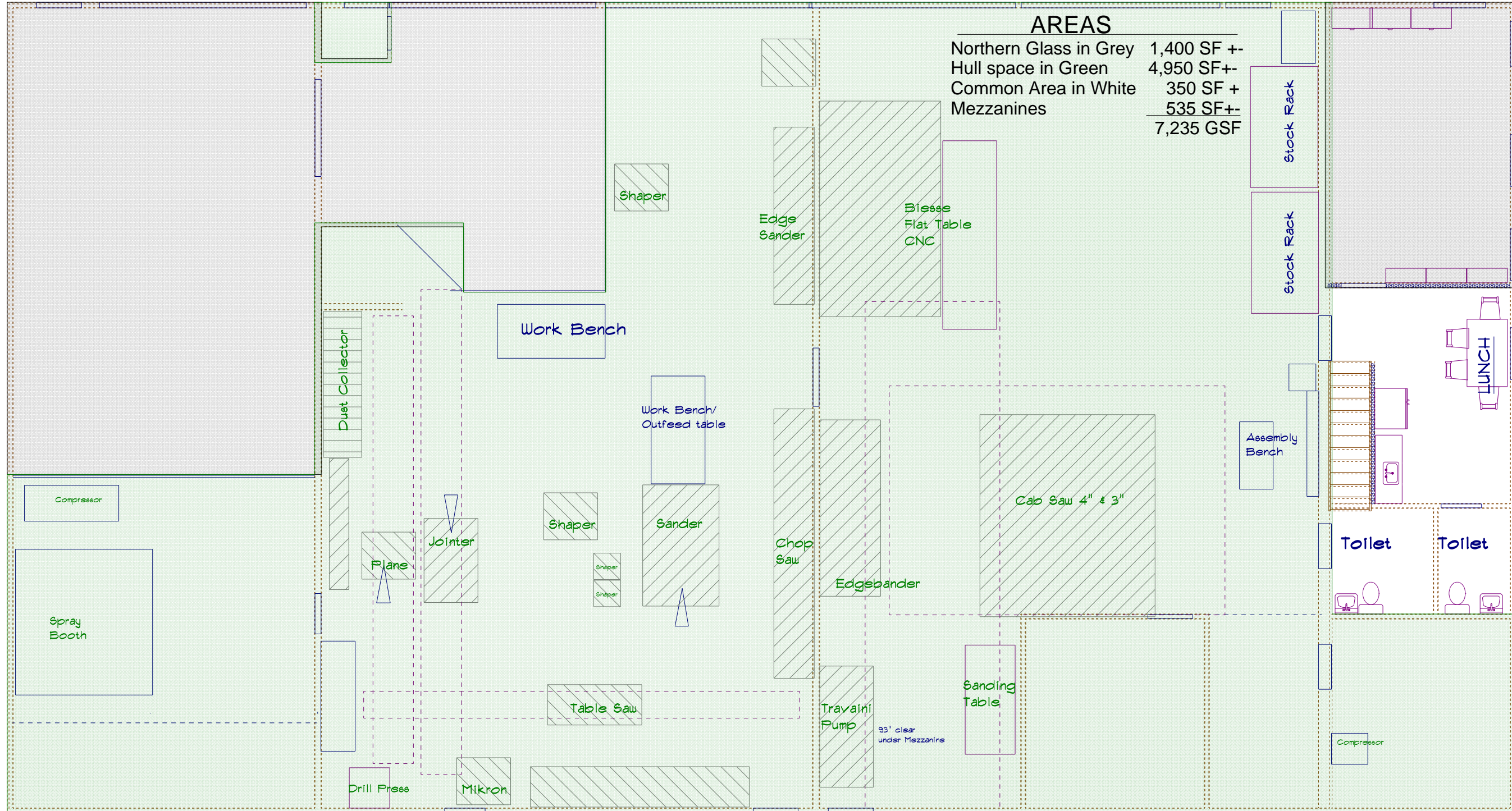

AREAS	
Northern Glass in Grey	1,400 SF +-
Hull space in Green	4,950 SF+-
Common Area in White	350 SF +
Mezzanines	535 SF+-
	<u>7,235 GSF</u>

111'-8" ±

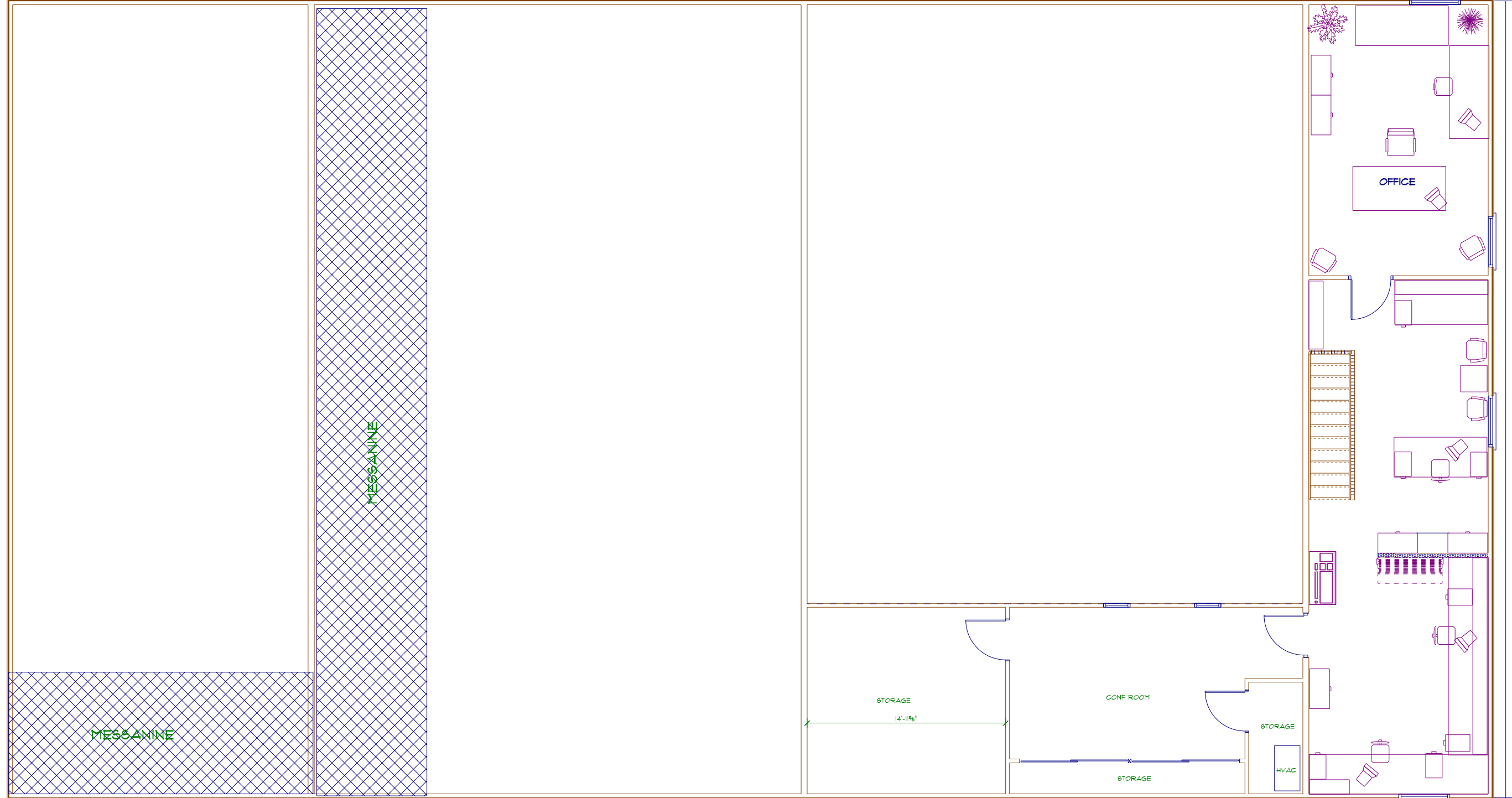

60'-0" ±

29C Hayward
2nd Floor GSF 1,425SF
1/8" = 1'-0" 3/14/01