



### NOTICE OF INFORMATION FROM OTHER SOURCES

USE OF THIS FORM BY PERSONS WHO ARE NOT MEMBERS OF THE TEXAS ASSOCIATION OF REALTORS®, INC. IS NOT AUTHORIZED.  
©Texas Association of REALTORS®, Inc. 2008

To: \_\_\_\_\_

From: **Bertholf Commercial Real Estate** (Broker)

Property Address: **201 E Houston Street, Sherman, TX 75090**

Date: **June 27, 2024**

(1) Broker obtained the attached information, identified as **building square footage being 11,407 square feet.**  
from **Blue Water Valuation Services**

(2) Broker has relied on the attached information and does not know and has no reason to know that the information is false or inaccurate except: **n.a.**

(3) **Broker does not warrant or guarantee the accuracy of the attached information. Do not rely on the attached information without verifying its accuracy.**

**Bertholf Commercial Real Estate**

Broker

By:  6/27/2024  
**Noel Cobb**

Receipt of this notice is acknowledged by:

Signature \_\_\_\_\_ Date \_\_\_\_\_

Signature \_\_\_\_\_ Date \_\_\_\_\_



Blue Water Valuation Services  
**SKETCH ADDENDUM**

File No. N/A  
 Loan No. N/A

Borrower Sherman Lodge  
 Property Address 201 E Houston St  
 City Sherman County Grayson State TX Zip Code 75020  
 Lender/Client Terrin Bertholf Address Bertholf Commercial Real Estate,

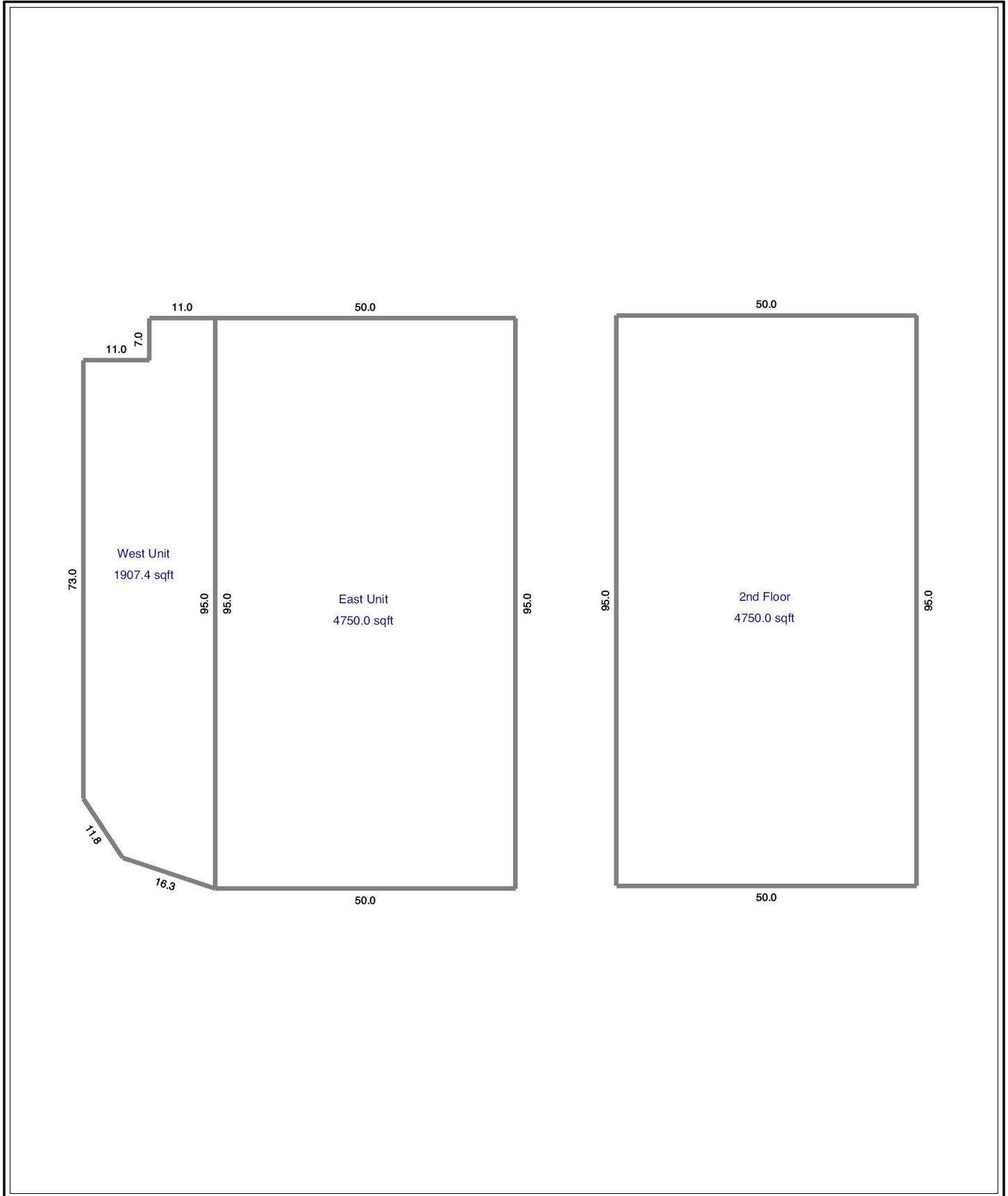

Note: The areas on the sketch were mathematically calculated by the mobile inspection app, Inspect-a-Lot, using the standard polygon area formula. To ensure the values have not been altered, they are imported directly from the inspection app and displayed in "read-only" fields that cannot be edited or altered.

Gross Living Area	Sq Ft.	Non Gross Living Area	Sq Ft.
2nd Floor	4750		
East Unit	4750		
West Unit	1907		
<b>Total Living Area</b>	<b>11407</b>		