

FOR LEASE

Everett Professional Building

2328 NW EVERETT STREET, PORTLAND, OR 97210



PROPERTY DESCRIPTION

Newly renovated professional building located on NW Everett Street just west of thriving NW 23rd Avenue retail. The space is approximately 750 SF and has been brought to shell condition. It has ground floor access and a lovely brick patio. There is on-site parking available.

PROPERTY HIGHLIGHTS

- Prosperous Alphabet Dist. Neighborhood
- Parking lot
- Surrounded by synergistic retail and food options
- 6 blocks from Legacy Good Sam Medical Center
- Excellent freeway access

OFFERING SUMMARY

Lease Rate: \$1,995/mo. Gross
Available SF: +/- 750 SF

DEMOGRAPHICS

	1 MILE	3 MILES	5 MILES
Total Households:	29,398	87,280	192,904
Total Population:	46,971	160,673	412,704
Average HH Income:	\$103,524	\$109,835	\$120,618

STEVE HAGAN

Director
Licensed in Oregon
C: 503.490.4152
O: 503.222.5100
email address@doubean.com

Doug Bean & Associates, Inc. | 1200 NW Naito Parkway #180 | Portland, OR 97209

DOUGBEAN.COM

Information contained herein has been obtained from others and is considered to be reliable. However, a prospective purchaser or lessee is expected to verify all information to their own satisfaction



Floor Plan

2328 NW EVERETT STREET, PORTLAND, OR 97210

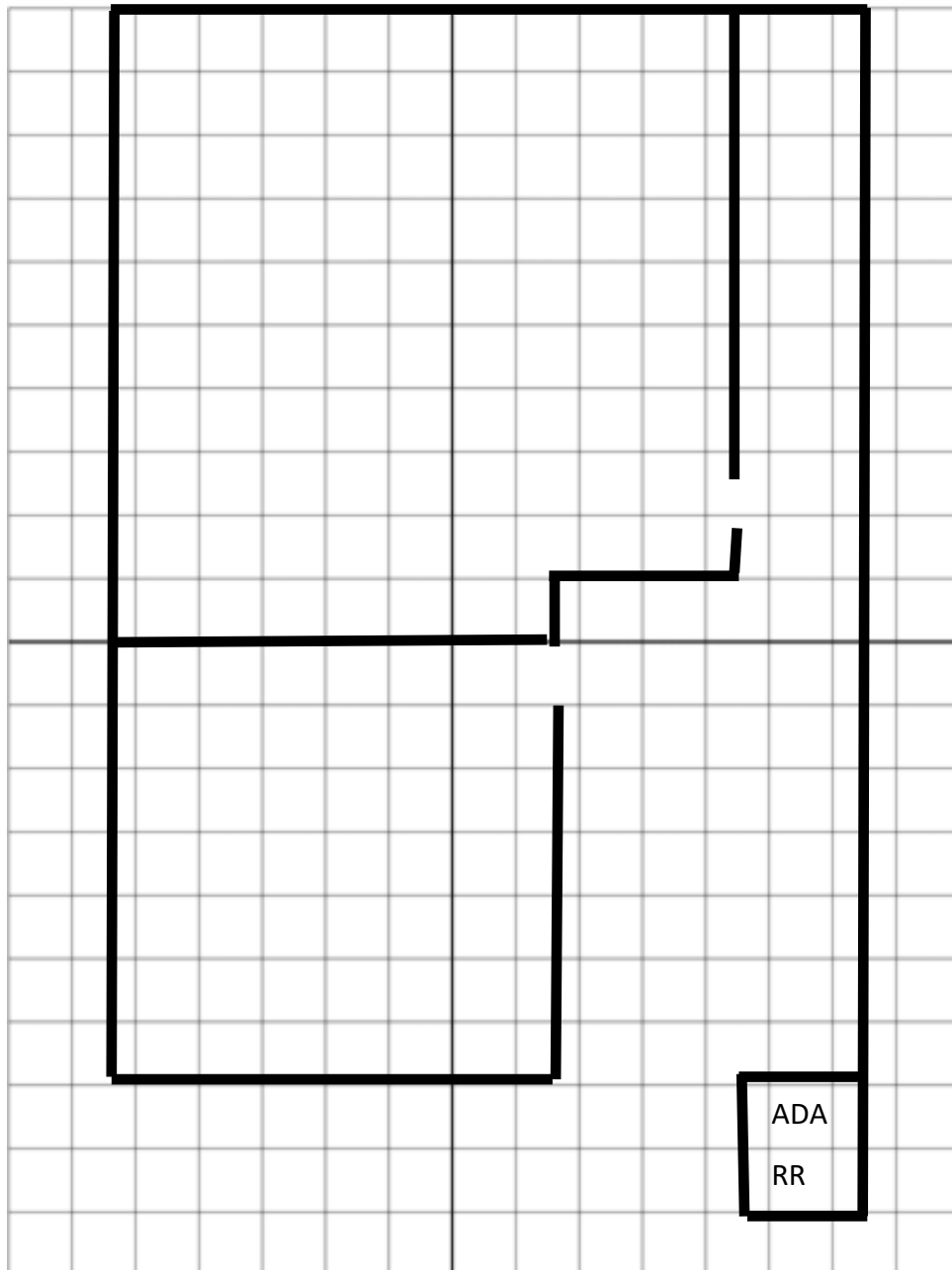

STEVE HAGAN

Director
Licensed in Oregon
C: 503.490.4152
O: 503.222.5100
email address@dougbbean.com

Doug Bean & Associates, Inc. | 1200 NW Naito Parkway #180 | Portland, OR 97209

DOUGBEAN.COM

Information contained herein has been obtained from others and is considered to be reliable. However, a prospective purchaser or lessee is expected to verify all information to their own satisfaction



Additional Photos

2328 NW EVERETT STREET, PORTLAND, OR 97210



STEVE HAGAN

Director
Licensed in Oregon
C: 503.490.4152
O: 503.222.5100
email address@dougbear.com

Doug Bear & Associates, Inc. | 1200 NW Naito Parkway #180 | Portland, OR 97209

DOUGBEAR.COM

Information contained herein has been obtained from others and is considered to be reliable. However, a prospective purchaser or lessee is expected to verify all information to their own satisfaction



Map

2328 NW EVERETT STREET, PORTLAND, OR 97210



STEVE HAGAN

Director

Licensed in Oregon

C: 503.490.4152

O: 503.222.5100

email address@doughbean.com

Doug Bean & Associates, Inc. | 1200 NW Naito Parkway #180 | Portland, OR 97209

DOUGBEAN.COM

Information contained herein has been obtained from others and is considered to be reliable. However, a prospective purchaser or lessee is expected to verify all information to their own satisfaction

