

# 1755 West Oak Pkwy

**SUITE 200, MARIETTA, GA 30062**

**38,637 sq. ft.**  
AVAILABLE

**16,893 sq. ft.**  
OFFICE SPACE

**4 total**  
DOCK DOORS

**Rear load**  
CONFIGURATION

**24'**  
CLEAR HEIGHT

**220**  
PARKING SPACES

## Features

38,637 sq. ft. suite in a 87,248 sq. ft. single-story office/distribution building.

Efficient operations with 4 dock doors with option to add 4 more.

Ample parking with 220 auto spots.

Features spacious kitchen and tenant lounge.

Located 2 miles from I-75 and 4 miles from I-575.





# Building Specifications

Building Size	87,648 sq. ft.
Available	38,637 sq. ft.
Office Space	16,893 sq. ft.
Clear Height	24'
Column Spacing	40' x 40'
Dock Doors	4 (9' x 10') doors
Format	Rear load
Automobile Parking	220 spaces
Sprinklers	Wet
Lighting	LED
HVAC in Warehouse	Available
Power	4,000 amps

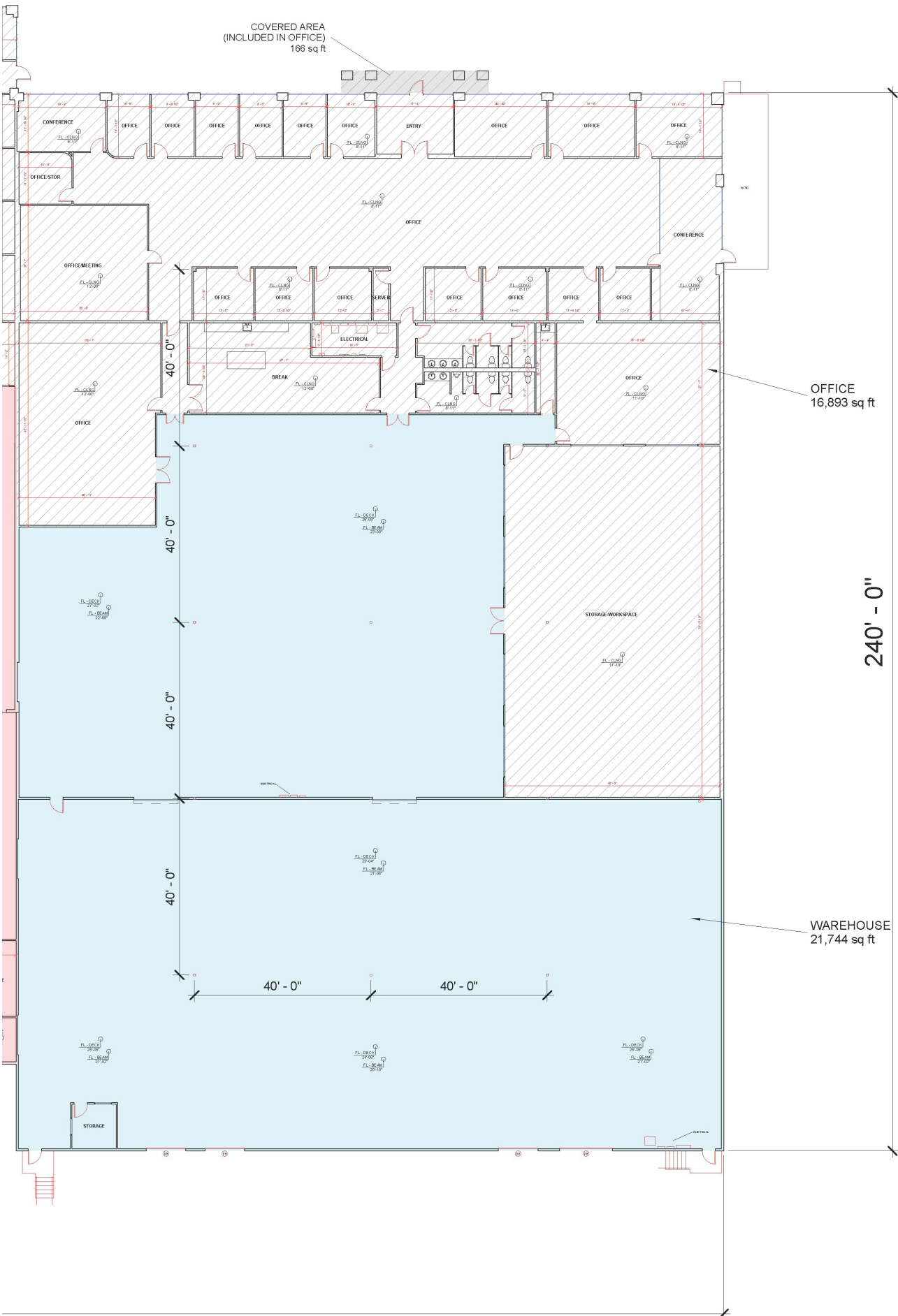



220

Automobile  
Parking



24'

Clear  
Height



40'x40'

Column  
Spacing



4

Dock  
Doors



Rear Load

Configuration

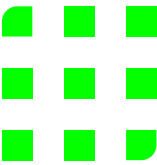

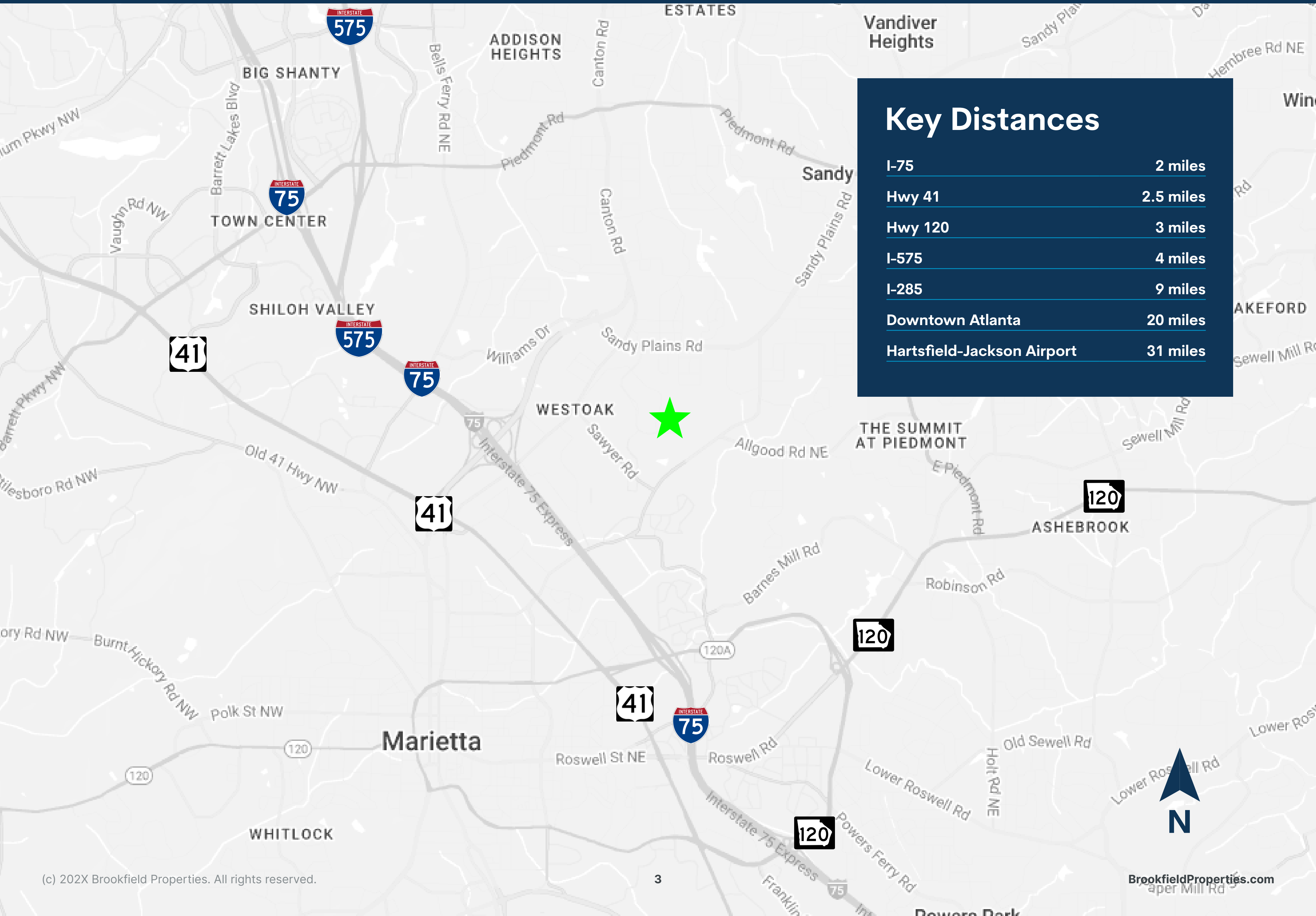



# 1755 West Oak Parkway

SUITE 200, MARIETTA, GA 30062



## Leasing Contacts

**John Gosnell**

404.563.0608

[jgosnell@strategicrepartners.com](mailto:jgosnell@strategicrepartners.com)

[www.strategicrepartners.com](http://www.strategicrepartners.com)

**Peyton Murray**

706.474.3940

[peyton.murray@brookfieldproperties.com](mailto:peyton.murray@brookfieldproperties.com)

[www.brookfieldproperties.com](http://www.brookfieldproperties.com)



All information regarding property for sale, rental or financing is from sources deemed reliable, but no warranty or representation is made to the accuracy thereof and same is submitted to errors, omissions, change of price, rental or other conditions prior to sale, lease or financing or withdrawal without notice. No liability of any kind is to be imposed on the broker herein.

## Brookfield Properties

