



RETAIL  
PROPERTY  
**FOR LEASE**



# BAYVIEW

7924-7930 CHESAPEAKE BLVD, NORFOLK, VA 23518



Owner/Agent  
Managed and Leased by KPM LLC

**SUSAN SPRINGER**

757.560.3931  
susans@kotarides.com

**CHRIS GOOD**

757.513.2500  
chrisg@kotarides.com

PROPERTY SUMMARY



**PROPERTY DESCRIPTION**

Convenient retail space immediately off the signalized intersection of Chesapeake Boulevard and E. Little Creek Road near CVS and WaWa.

**PROPERTY HIGHLIGHTS**

- Over 34,000 VPD at the intersection of Chesapeake Blvd. and E. Little Creek Road
- Pylon signage available
- Serves the Little Creek Amphibious Base community with 19,000 daytime population
- Above average WaWa and CVS locations nearby according to placer.ai CVS: 80% nationally; ranked 4th out of 21 locations locally. WaWa: 70% nationally; ranked 8th out of 22 locations locally

**OFFERING SUMMARY**

Lease Rate:	\$13.50 - 16.00 SF/yr (Gross)
Number of Units:	2
Available SF:	2,702 - 6,886 SF
Building Size:	25,816 SF

DEMOGRAPHICS	1 MILE	5 MILES	10 MILES
Total Households	5,652	43,704	86,763
Total Population	14,388	101,434	214,216
Average HH Income	\$64,088	\$63,302	\$67,484



Owner/Agent  
Managed and Leased by KPM LLC

SUSAN SPRINGER

757.560.3931  
susans@kotarides.com

CHRIS GOOD

757.513.2500  
chrisg@kotarides.com

LOCATION MAP

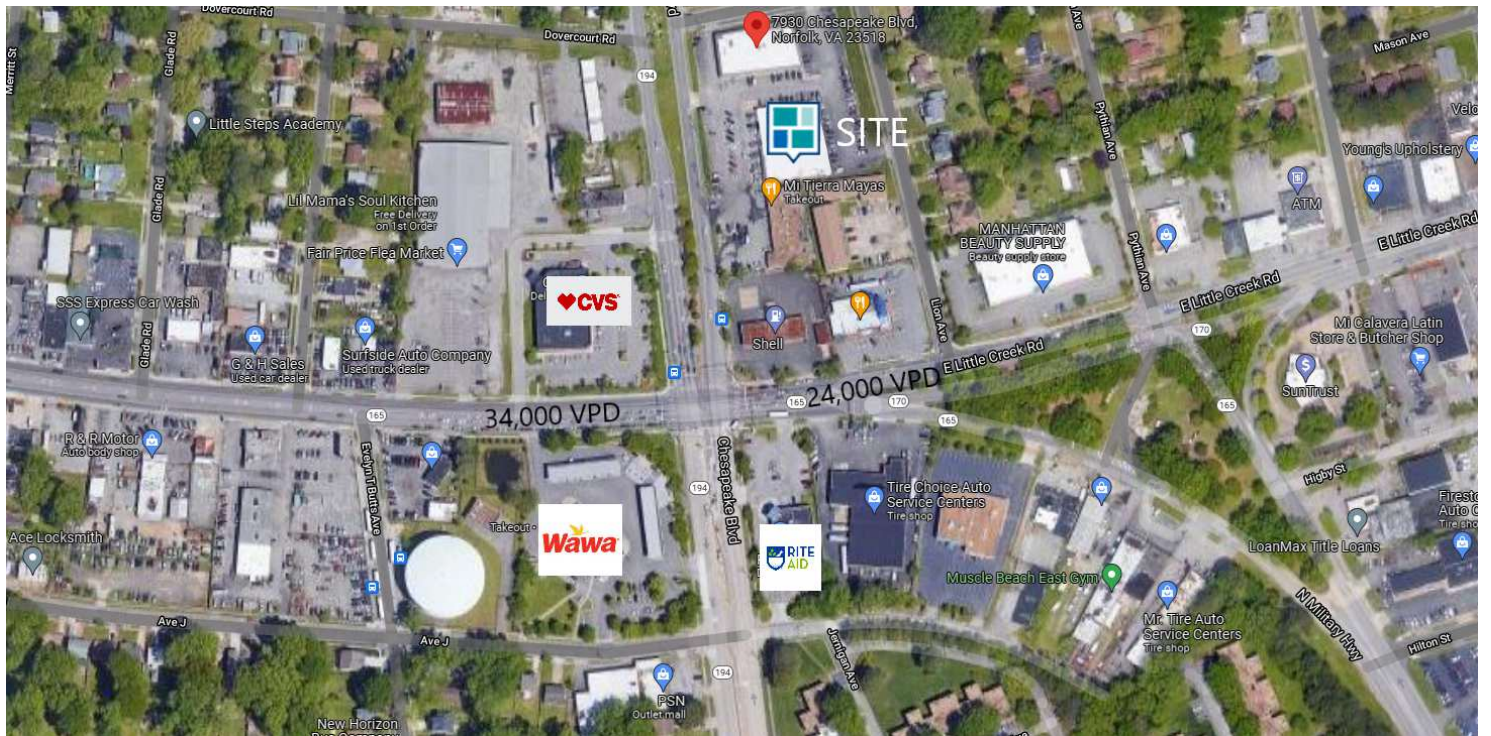

Owner/Agent  
Managed and Leased by KPM LLC

SUSAN SPRINGER

757.560.3931  
susans@kotarides.com

CHRIS GOOD

757.513.2500  
chrsg@kotarides.com

# SITE PLAN

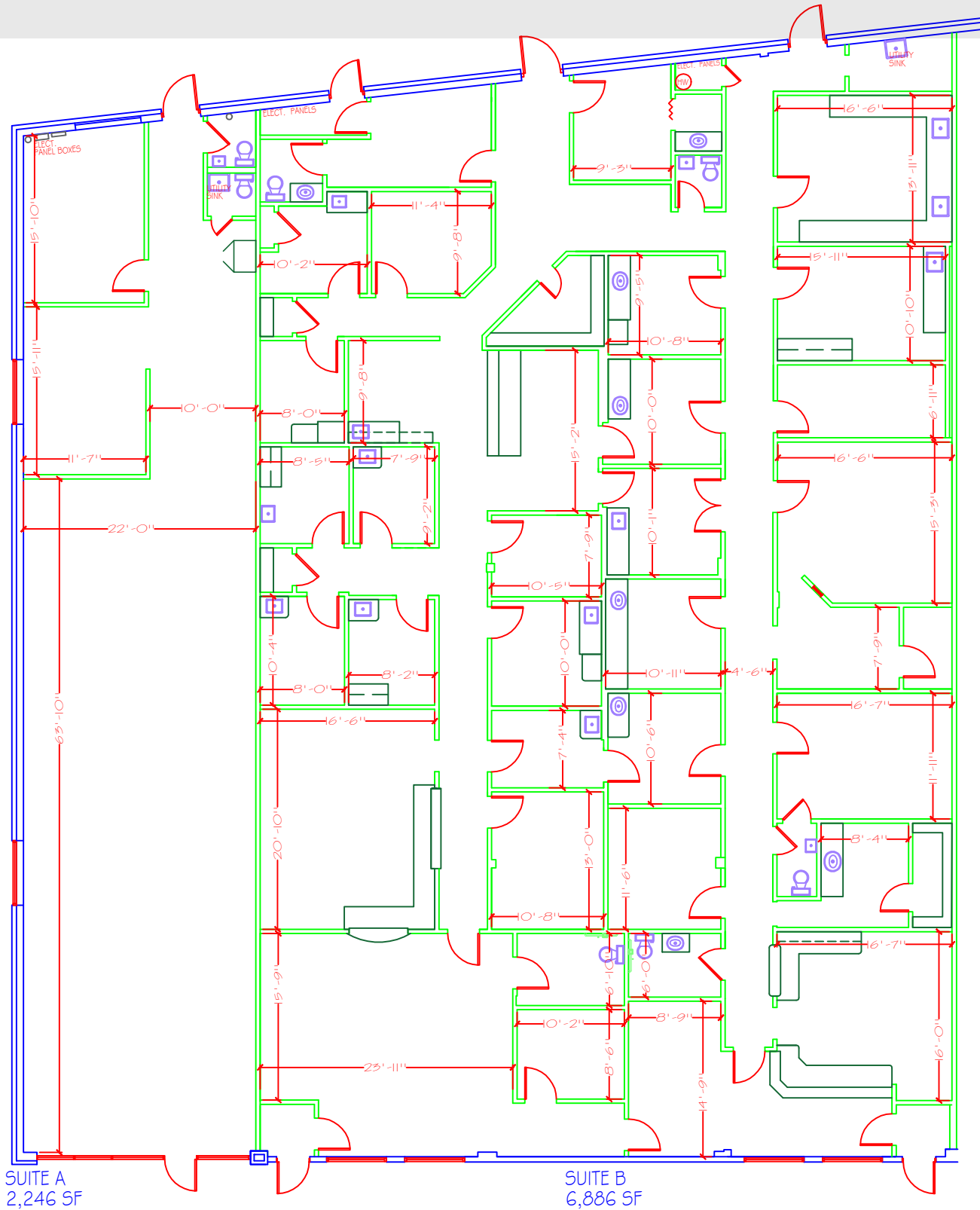

SUITE A  
2,246 SF

SUITE B  
6,886 SF



Owner/Agent  
Managed and Leased by KPM LLC

SUSAN SPRINGER

757.560.3931  
susans@kotarides.com

CHRIS GOOD

757.513.2500  
chrisg@kotarides.com

## LEASE SPACES

## LEASE INFORMATION

Lease Type:	Gross	Lease Term:	Negotiable
Total Space:	2,702 - 6,886 SF	Lease Rate:	\$13.50 - \$16.00 SF/yr

## AVAILABLE SPACES

SUITE	TENANT	SIZE (SF)	LEASE TYPE	LEASE RATE	DESCRIPTION
5	Available	2,702 SF	Gross	\$16.00 SF/yr	-
8-10	Available	6,886 SF	Gross	\$13.50 SF/yr	-



Owner/Agent  
Managed and Leased by KPM LLC

**SUSAN SPRINGER**

757.560.3931  
susans@kotarides.com

**CHRIS GOOD**

757.513.2500  
chrisg@kotarides.com

DEMOGRAPHICS MAP & REPORT

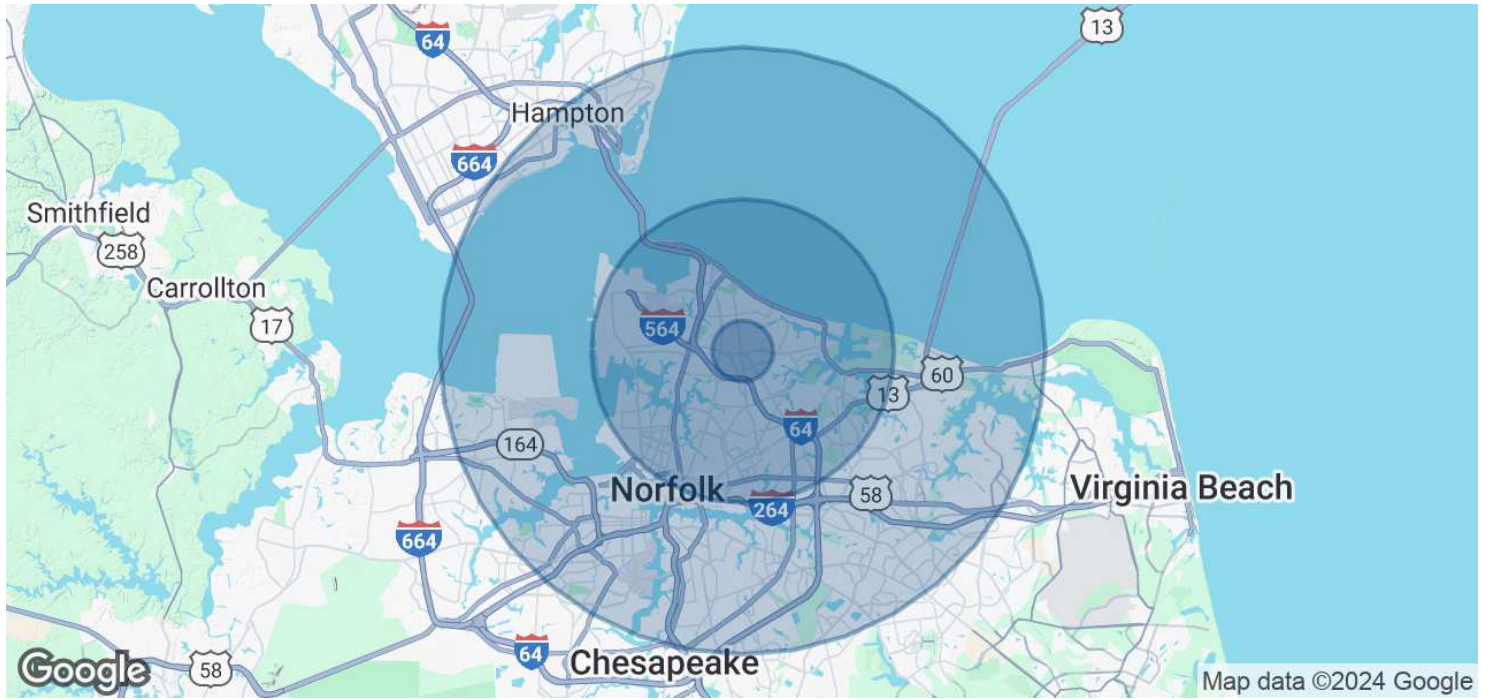

POPULATION	1 MILE	5 MILES	10 MILES
Total Population	14,388	101,434	214,216
Average Age	36.6	35.5	34.0
Average Age (Male)	31.8	33.9	32.7
Average Age (Female)	43.5	38.3	36.0

HOUSEHOLDS & INCOME	1 MILE	5 MILES	10 MILES
Total Households	5,652	43,704	86,763
# of Persons per HH	2.5	2.3	2.5
Average HH Income	\$64,088	\$63,302	\$67,484
Average House Value	\$291,916	\$244,260	\$241,727

\* Demographic data derived from 2020 ACS - US Census



Owner/Agent  
Managed and Leased by KPM LLC

SUSAN SPRINGER

757.560.3931  
susans@kotarides.com

CHRIS GOOD

757.513.2500  
chrisg@kotarides.com