



ATLANTA COMMERCIAL
REAL ESTATE BROKERS

JONESBORO RETAIL SPACE AVAILABLE

B2: 1,100 SF Retail

B6: 1,100 SF Retail

Near US 41, Jonesboro Rd, Hwy 138
Pylon Signage

SPIVEY PLAZA
1423 STOCKBRIDGE ROAD, B2
JONESBORO, GA 30236

DON EDWARDS

Associate Broker/Commercial Director
(770) 324-3457
don@dbeproperties.com
119563, GA

MARKIE CLARY

Associate
470-626-5746
markie@atlmetrocre.com
239-529-8774

YOUR SIGN

YOUR SIGN





Property Overview

Highly visible retail center on the busy Stockbridge Rd. in Jonesboro, GA. Spivey Plaza has a dedicated turn lane, two access points, pylon signage and ample parking, making this space everything a thriving business needs. The spaces available: a former dance studio and a former bakery with an under the sink grease trap. Spivey Plaza neighbors include: Lucky's Grocery Store, Janetta's House of Nursing Wound Care & IV Hydration and Builders of Tomorrow.

Property Highlights

- Property is under renovations to enhance curb appeal
- Pylon signage and building signage
- High visibility and traffic counts (10,500)
- General Business zoning for variety of uses
- Ample parking, two access points, dedicated turn lane
- Near City Green/Center
- Convenient to Hwy 54, Hwy 138 and US 41
- 10 Miles to Hartsfield-Jackson International Airport

Address::	1423 Stockbridge Road
City, ST, Zip:	Jonesboro, GA 30236
County:	GA - Clayton
Available:	1,100 sq ft
Parking Ratio:	10:1000
Type:	Retail



**Rear of Building - Ample Parking for
overflow cars or trucks**
1,100 SF - \$16.36 + \$2.73 CAM =\$ 1,749.92

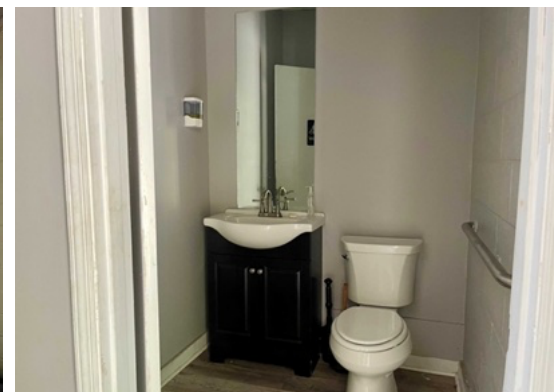

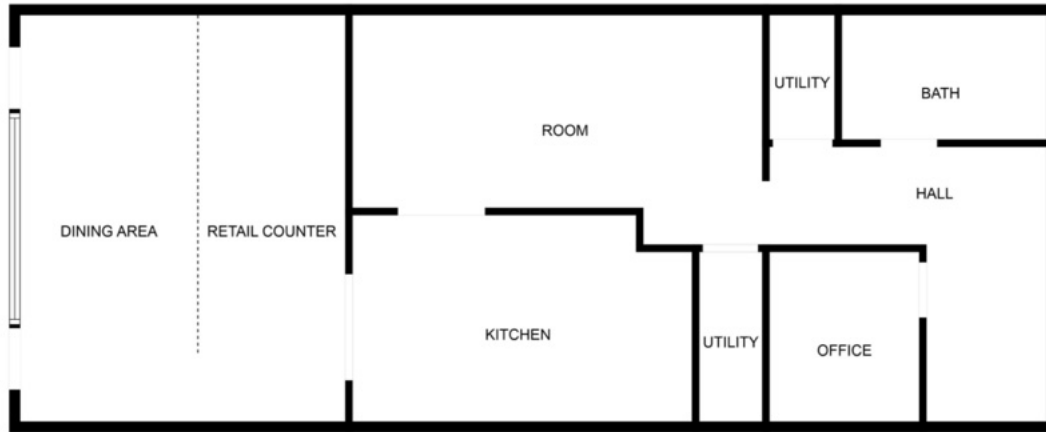

MEASUREMENTS ARE CALCULATED BY CUBICASA TECHNOLOGY. DEEMED HIGHLY RELIABLE BUT NOT GUARANTEED.

Former bakery with an under the sink grease trap.
Rear of Building - Ample Parking for overflow cars or trucks

1,100 SF - \$16.36 + \$2.73 CAM
= \$1,749.92 / month





Spivey Plaza is convenient to Hwy 138 (Walt Stephens Rd), Jonesboro Rd (Hwy 54) and US 41. Just a quick 3 minutes to the desirable Lee Park and City Center and surrounded by new development. It's just 10 miles to the Hartsfield-Jackson International Airport or 15 miles from the vibrant and bustling Downtown, Grant Park and Beltline.

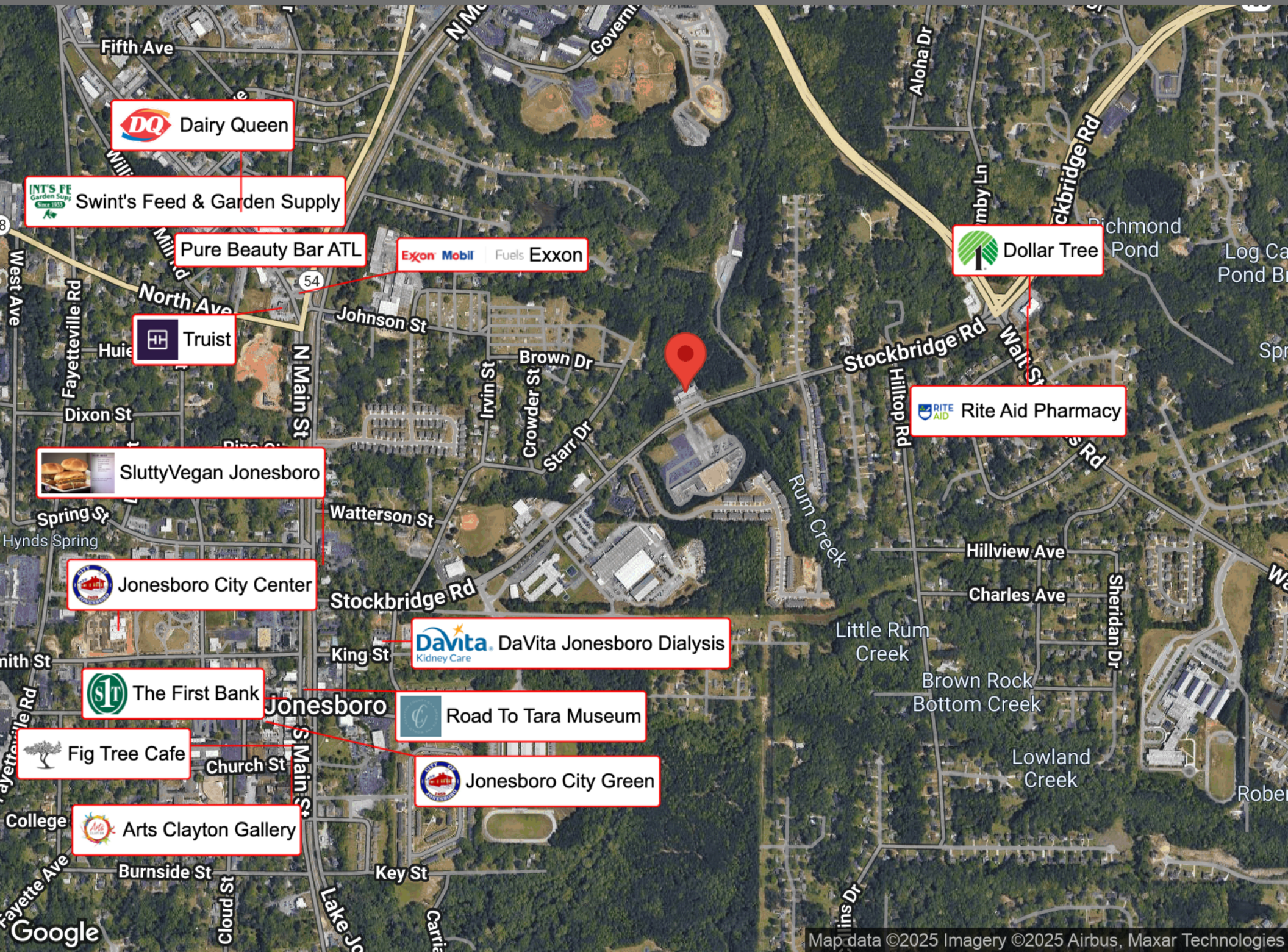

 Dairy Queen

 Swint's Feed & Garden Supply

 Pure Beauty Bar ATL

 Exxon Mobil Fuels Exxon

 Dollar Tree

 Truist

 Rite Aid Pharmacy

 SluttyVegan Jonesboro

 Jonesboro City Center

 Davita DaVita Jonesboro Dialysis

 The First Bank



 Road To Tara Museum

 Fig Tree Cafe

 Jonesboro City Green

 Arts Clayton Gallery

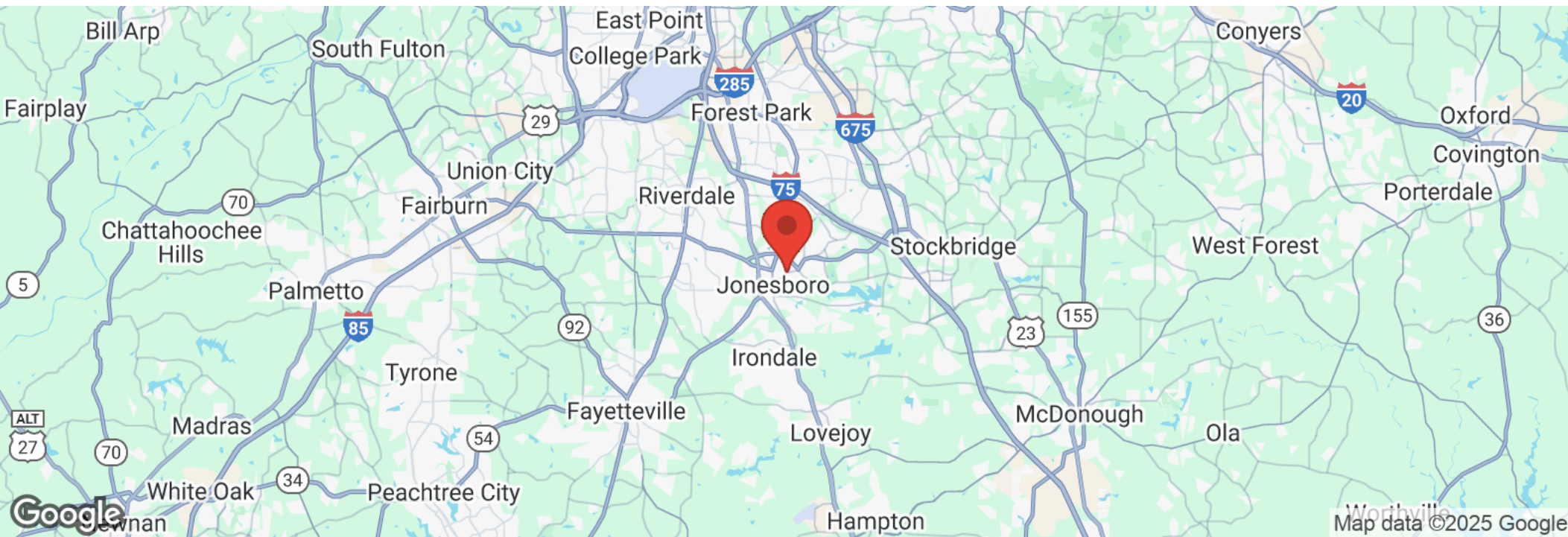

Jonesboro, GA

Uncover Jonesboro, Georgia, a historical gem with growth and development in Clayton County, located just 10 miles from the Atlanta Airport and a short 15-miles to downtown Atlanta. This tight-knit community provides a small-town allure while offering easy access to modern amenities. Immerse yourself in local festivals, green spaces, and a rich history.



DEMOGRAPHICS

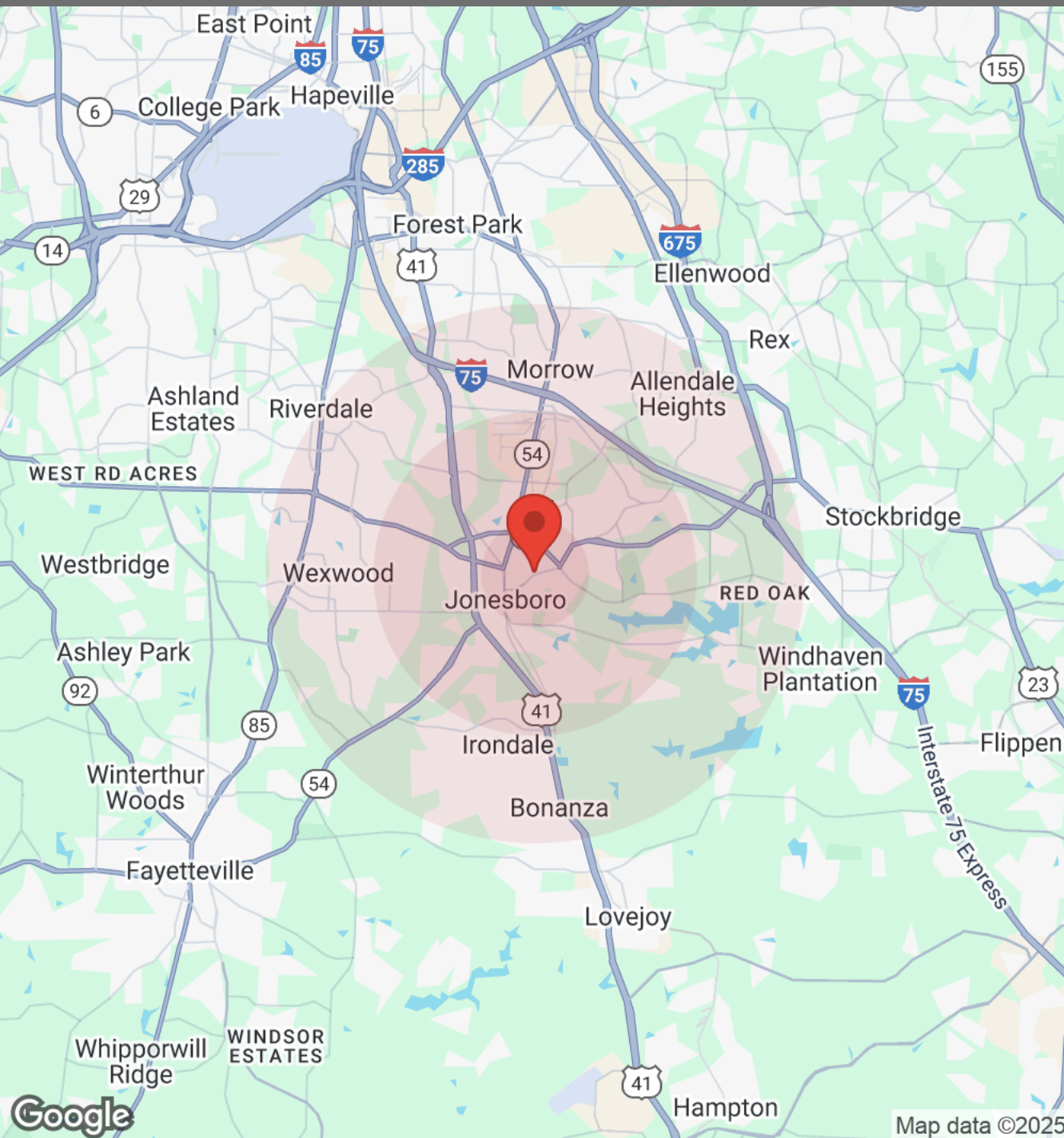

Population	1 Mile	3 Miles	5 Miles
Male	2,148	27,960	85,206
Female	2,577	30,823	95,241
Total Population	4,725	58,783	180,447

Age	1 Mile	3 Miles	5 Miles
Ages 0-14	997	11,748	37,176
Ages 15-24	657	8,355	27,280
Ages 25-54	1,754	23,242	72,566
Ages 55-64	565	6,974	21,114
Ages 65+	752	8,463	22,312

Race	1 Mile	3 Miles	5 Miles
White	565	5,802	15,518
Black	3,197	41,148	124,942
Am In/AK Nat	8	82	217
Hawaiian	2	12	54
Hispanic	572	7,512	24,667
Asian	266	2,927	11,097
Multi-Racial	94	1,087	3,356
Other	21	212	595

Income	1 Mile	3 Miles	5 Miles
Median	\$51,875	\$70,098	\$62,505
< \$15,000	366	2,394	6,594
\$15,000-\$24,999	111	923	4,384
\$25,000-\$34,999	200	1,870	5,726
\$35,000-\$49,999	180	2,183	8,391
\$50,000-\$74,999	222	3,908	12,248
\$75,000-\$99,999	252	3,206	9,801
\$100,000-\$149,999	259	4,050	10,258
\$150,000-\$199,999	70	1,431	3,905
> \$200,000	109	1,435	2,909

Housing	1 Mile	3 Miles	5 Miles
Total Units	1,943	23,339	70,081
Occupied	1,767	21,402	64,217
Owner Occupied	840	10,655	31,533
Renter Occupied	927	10,747	32,684
Vacant	175	1,938	5,864

We obtained the information above from sources we believe to be reliable. However, we have not verified its accuracy and make no guarantee, warranty or representation about it. It is submitted subject to the possibility of errors, omissions, change of price, rental or other conditions, prior sale, lease or financing, or withdrawal without notice. We include projections, opinions, assumptions or estimates for example only, and they may not represent current or future performance of the property. You and your tax and legal advisors should conduct your own investigation of the property and transaction.



DONALD B EDWARDS JR

Commercial Director and Associate Broker

Licensed in 1984, Don has completed hundreds of commercial real estate transactions across the USA including industrial, retail, office, medical, multifamily, land, timber, mining and multi family residential, as well as, landlord and tenant representation, property management and site selection for national franchises. As the head of the trust real estate department for all the South Trust Banks, he was responsible for a full staff and a \$750M portfolio of diverse assets including retail, office, medical, industrial, land, mining, timber, farms, leases, mortgages, property inspections and asset management from coast to coast. In addition, he has over 18 years of commercial and residential construction experience. His land deals have included assemblages, out parcels, and development sites for all asset classes. Don is a past president of the Association of Georgia Real Estate Exchangors, and has executed numerous 1031 exchanges. In addition, he has passed all of the CCIM course work.



Cell: 770.324.3457
Office: 770-240-2004
don@dbeproperties.com

Administrative Contact:
admin@dbeproperties.com

Showing Contact:
Markie Clary 239-529-8774
markie@atlmetrocre.com

DISCLAIMER

All materials and information received or derived from DBE Properties, its directors, officers, agents, advisors, affiliates and/or any third party sources are provided without representation or warranty as to completeness, veracity, or accuracy, condition of the property, compliance or lack of compliance with applicable governmental requirements, developability or suitability, financial performance of the property, projected financial performance of the property for any party's intended use or any and all other matters.

Neither DBE Properties, its directors, officers, agents, advisors, or affiliates makes any representation or warranty, express or implied, as to accuracy or completeness of the any materials or information provided, derived, or received. Materials and information from any source, whether written or verbal, that may be furnished for review are not a substitute for a party's active conduct of its own due diligence to determine these and other matters of significance to such party. DBE Properties will not investigate or verify any such matters or conduct due diligence for a party unless otherwise agreed in writing.

EACH PARTY SHALL CONDUCT ITS OWN INDEPENDENT INVESTIGATION AND DUE DILIGENCE.

Any party contemplating or under contract or in escrow for a transaction is urged to verify all information and to conduct their own inspections and investigations including through appropriate third-party independent professionals selected by such party. All financial data should be verified by the party including by obtaining and reading applicable documents and reports and consulting appropriate independent professionals. DBE Properties makes no warranties and/or representations regarding the veracity, completeness, or relevance of any financial data or assumptions. DBE Properties does not serve as a financial advisor to any party regarding any proposed transaction.

All data and assumptions regarding financial performance, including that used for financial modeling purposes, may differ from actual data or performance. Any estimates of market rents and/or projected rents that may be provided to a party do not necessarily mean that rents can be established at or increased to that level. Parties must evaluate any applicable contractual and governmental limitations as well as market conditions, vacancy factors and other issues in order to determine rents from or for the property. Legal questions should be discussed by the party with an attorney. Tax questions should be discussed by the party with a certified public accountant or tax attorney. Title questions should be discussed by the party with a title officer or attorney. Questions regarding the condition of the property and whether the property complies with applicable governmental requirements should be discussed by the party with appropriate engineers, architects, contractors, other consultants, and governmental agencies. All properties and services are marketed by DBE Properties in compliance with all applicable fair housing and equal opportunity laws.