

# 734 Grand Avenue

RIDGEFIELD, NJ 07657

## 11,500 SF LAST UNIT! INDUSTRIAL FOR LEASE



### Property Features

- 70,785 SF
- 2.7 acres
- Two units available
- Ample shared parking
- Wet sprinkler system
- Power: 3-phase; 200 amp

### Last Unit Remaining!



- Unit B: 11,500 SF
- 830 SF office (air conditioned)
- 1 interior tailgate
- 16' ceiling height
- 20' x 20' column spacing

### FOR MORE INFORMATION

**Andrew Somple, SIOR | Senior Vice President**  
201 488 5800 x151 | [asomple@naihanson.com](mailto:asomple@naihanson.com)

**Jessica Curry, CCIM | Associate**  
201 488 5800 x199 | [jcurry@naihanson.com](mailto:jcurry@naihanson.com)



FOLLOW US!     | Offices: Teterboro | Parsippany | Allentown • [naihanson.com](http://naihanson.com) | [naisummit.com](http://naisummit.com) • Member of NAI Global with 325+ Offices Worldwide

#### SERVICES OFFERED

Brokerage • Property Management • Corporate Services • Financing • Logistics • Healthcare • Tenant Representation • Cold Storage • Investment Services

The information contained herein has been obtained from sources considered to be reliable, but no guarantee of its accuracy is made by NAI James E. Hanson

# 734 Grand Avenue

RIDGEFIELD, NJ 07657

## PROPERTY INFORMATION

### Overview



TOTAL AVAILABLE  
11,500 SF



OFFICE AVAILABLE  
830 SF



LOADING  
One (1)



CEILING HEIGHT  
16'



COLUMN SPACING  
20' x 20'



PARKING  
AMPLE SHARED



POWER  
3-PHASE; 200 AMP



SPRINKLER  
WET

### Description

Strategically designed for flexible industrial operations with separate office spaces to provide for dedicated administrative areas. On-site parking available to accommodate staff and logistics needs and ample truck access with multiple tailgates for streamlined logistics.

### Prime Industrial Location

Ridgefield is part of a growing industrial hub, offering proximity to key clients and vendors. Situated in Ridgefield, NJ, with easy access to major transportation corridors. Minutes from the George Washington Bridge, I-95, NJ Turnpike, and Route 46—seamless access to New York City and surrounding markets. Close to Port Newark and Port Elizabeth for efficient import/export logistics.

Demographics	1 Mile	3 Miles	5 Miles
Total Population	26,541	240,625	1,604,992
Average HH Income	\$120,562	\$125,764	\$119,396

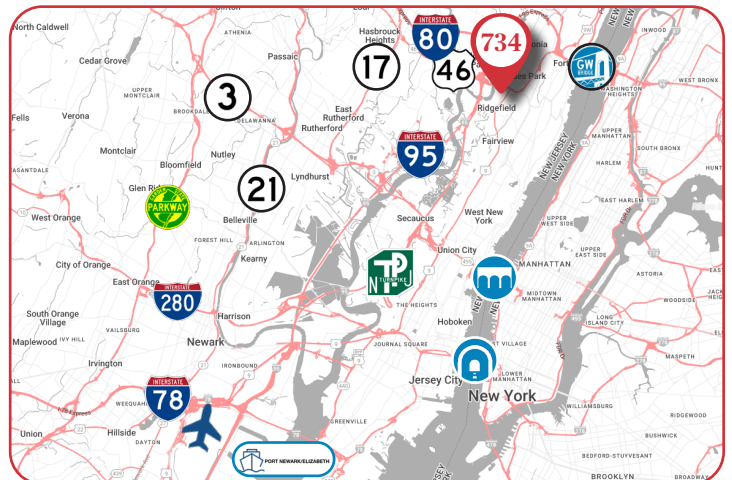

**734 Grand Avenue**  
RIDGEFIELD, NJ 07657

# UNIT B FLOOR PLAN

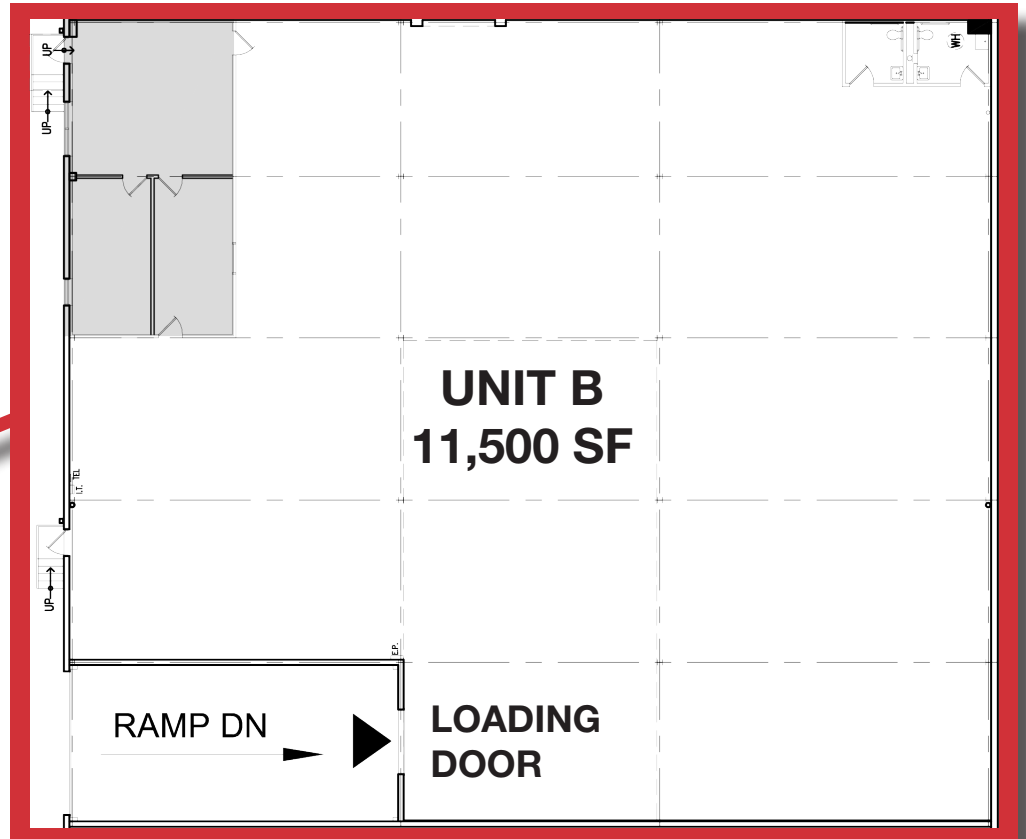
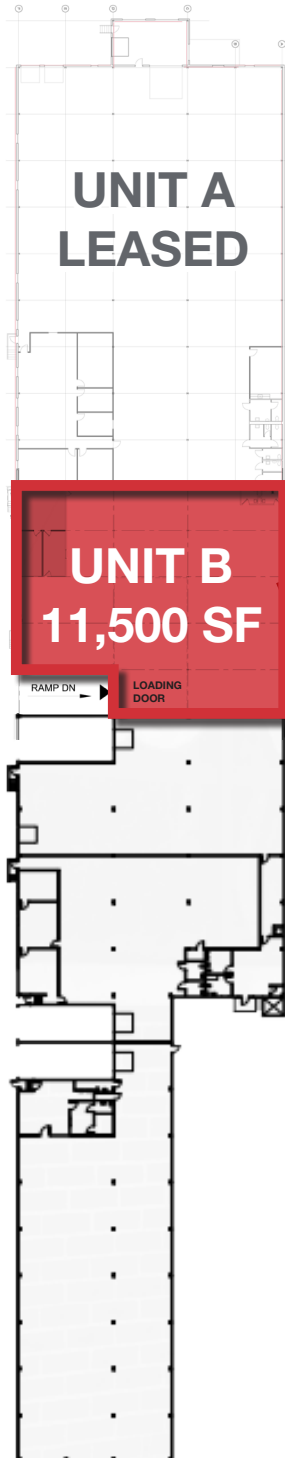

**734 Grand Avenue**  
RIDGEFIELD, NJ 07657

**UNIT B**  
PHOTOS



**NAI James E. Hanson**  
COMMERCIAL REAL ESTATE SERVICES, WORLDWIDE

The information contained herein has been obtained from sources considered to be reliable, but no guarantee of its accuracy is made by NAI James E. Hanson