

Village of Golf

4840 Woolbright Road,
Boynton Beach, FL 33426



PROPERTY HIGHLIGHTS

- + ±6,112 SF - ±20,000 SF Office/Warehouse on ±3.3 Acres
- + Freestanding Building with Yard Area
- + 10% Office Buildout
- + Several Oversized Grade Level Loading Doors
- + Concrete column-free construction
- + Business park setting conveniently surrounded by brand new Publix and Starbucks anchored shopping center
- + Prime location in South Palm Beach County with close proximity to I-95

Contact Us

KIRK NELSON
Executive Vice President
+1 561 716 9936
kirk.nelson@cbre.com

ROBERT C. SMITH
Executive Vice President
+1 561 707 5558
robert.c.smith@cbre.com

Lease Rate – CALL FOR DETAILS

*Subject to Size of Space, Credit of Tenant, Required Improvements, Lease Term, Etc.

Warehouse/Office With Yard - ±6,112 SF - ±20,000 SF on ±3.3 Acres

4840 Woolbright Road | Boynton Beach, FL 33426

For Lease

Locational Aerial



Site Plan

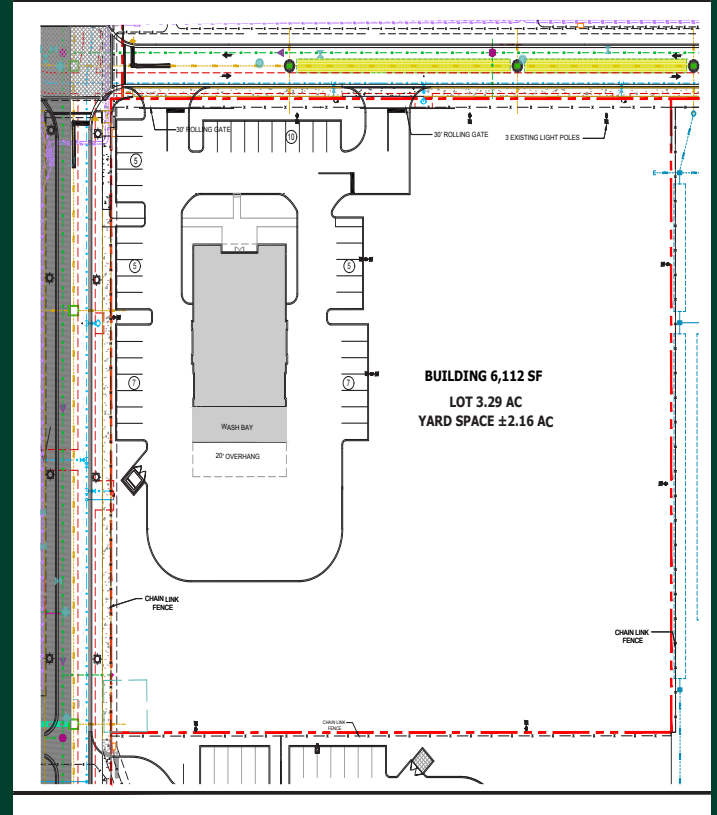

Additional Photos



Contact Us

KIRK NELSON
Executive Vice President
+1 561 716 9936
kirk.nelson@cbre.com

ROBERT C. SMITH
Executive Vice President
+1 561 707 5558
robert.c.smith@cbre.com

© 2024 CBRE, Inc. All rights reserved. This information has been obtained from sources believed reliable, but has not been verified for accuracy or completeness. You should conduct a careful, independent investigation of the property and verify all information. Any reliance on this information is solely at your own risk. CBRE and the CBRE logo are service marks of CBRE, Inc. All other marks displayed on this document are the property of their respective owners, and the use of such logos does not imply any affiliation with or endorsement of CBRE. Photos herein are the property of their respective owners. Use of these images without the express written consent of the owner is prohibited.