



# 3375 E. WOOD VALLEY ROAD

Acreage for Residential Development





# 3375 E. WOOD VALLEY ROAD

## INTRODUCTION

### IN THE HEART OF BUCKHEAD

Harry Norman, Realtors proudly presents 3375 E. Valley Rd., an extraordinary property located in the heart of Buckhead, one of Atlanta's most affluent and sought-after neighborhoods. Boasting a prominent location, this exclusive piece of real estate offers immense potential for discerning buyers. Situated just a short five-minute drive from the Buckhead Triangle and a mere 15 minutes from Downtown Atlanta, the property offers unrivaled convenience for navigating the city. Its strategic positioning ensures easy access to key amenities, entertainment venues, and thriving business districts. With the state and city experiencing substantial population growth, this coveted location presents an exceptional opportunity to create a secluded dream home tailored to your unique vision. Alternatively, the property's expansive grounds can be subdivided to accommodate multiple properties, catering to a range of possibilities. Whether you envision crafting an idyllic sanctuary or pursuing a development venture, 3375 E. Valley Rd. provides an ideal canvas to realize your ambitions. Take advantage of this rare offering and unlock the potential that this prime Buckhead address holds.



# 3375 E. WOOD VALLEY ROAD

## INTRODUCTION

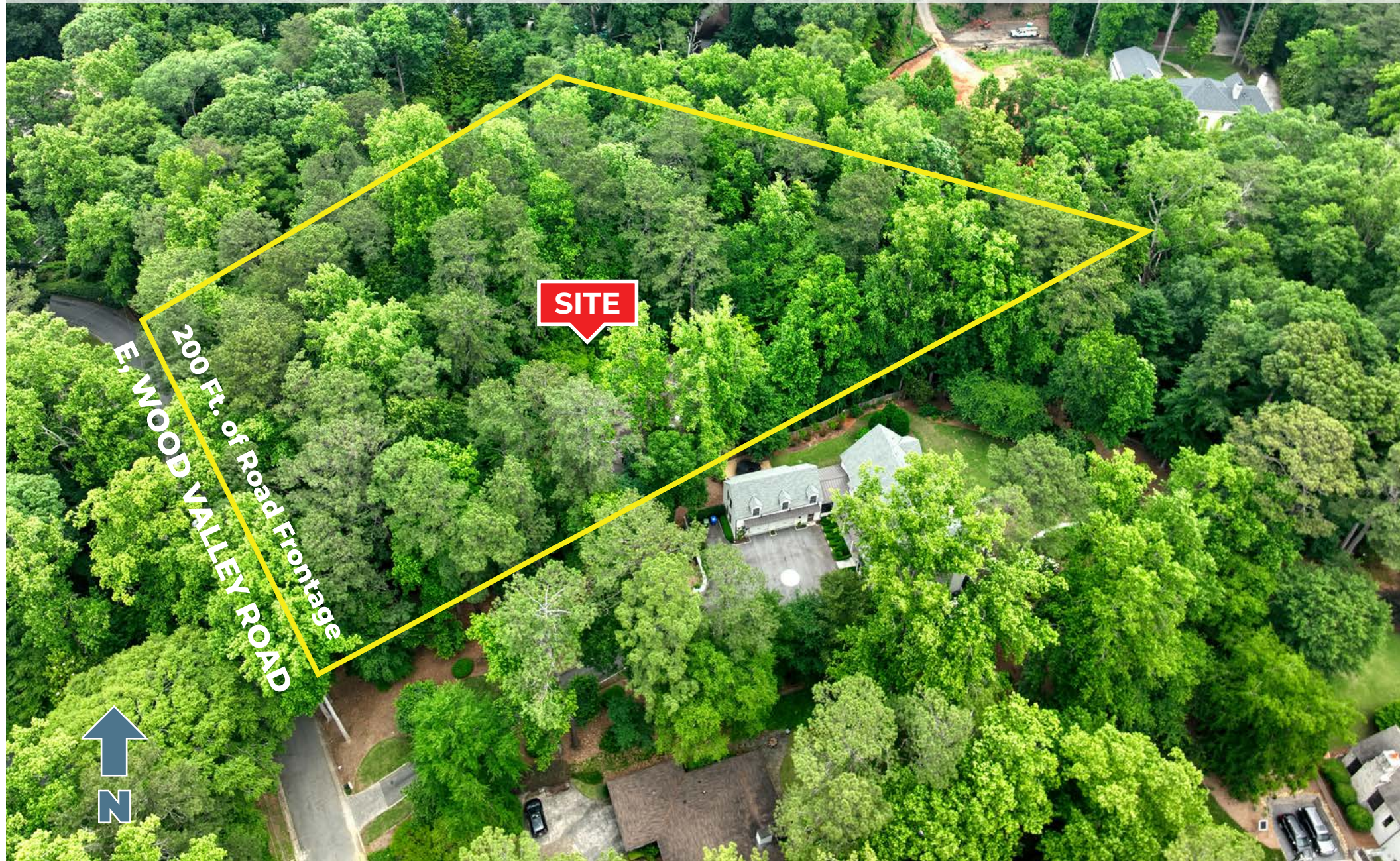

**SITE**

200 Ft. of Road Frontage  
E, WOOD VALLEY ROAD





# 3375 E. WOOD VALLEY ROAD

PROPERTY FEATURES | LISTED AT: \$1,795,000

E, WOOD VALLEY ROAD

## FEATURES

- ACREAGE  
ZONED R-3 RESIDENTIAL IN CITY OF ATLANTA
- 2 MINUTES TO INTERSTATE 75, 5 MINUTES FROM BUCKHEAD BUSINESS DISTRICT, 10 MINUTES FROM MIDTOWN ATLANTA, 15 MINUTES TO DOWNTOWN ATLANTA
- 200+ FEET OF FRONTAGE ON E. WOOD VALLEY RD.  
SUBDIVISIBLE LOT
- 2,100+/- SF HOME







# 3375 E. WOOD VALLEY ROAD

## DRIVE TIME MAP

- 5 MIN
- 10 MIN
- 15 MIN

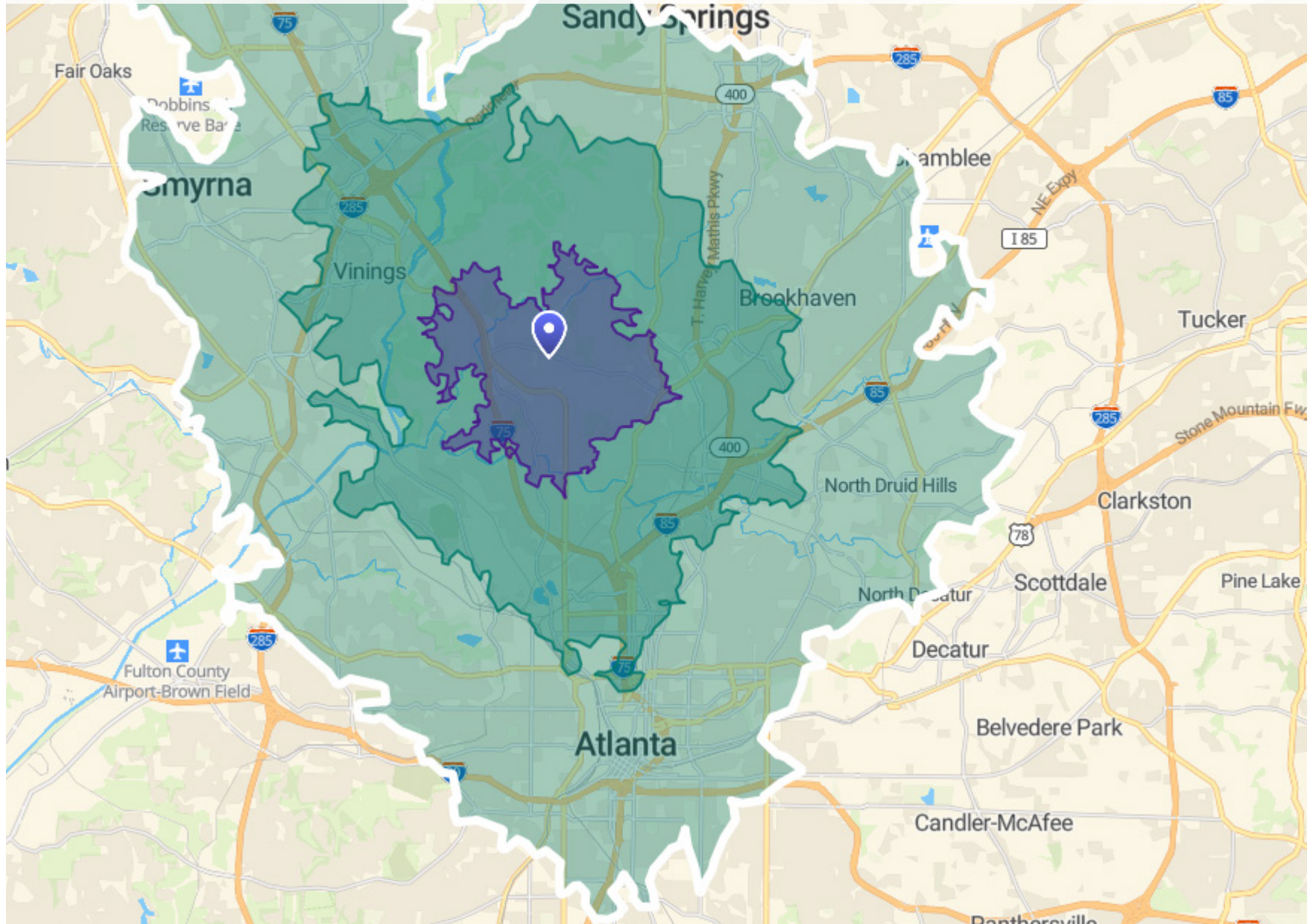



# 3375 E. WOOD VALLEY ROAD

## RADIAL MAP

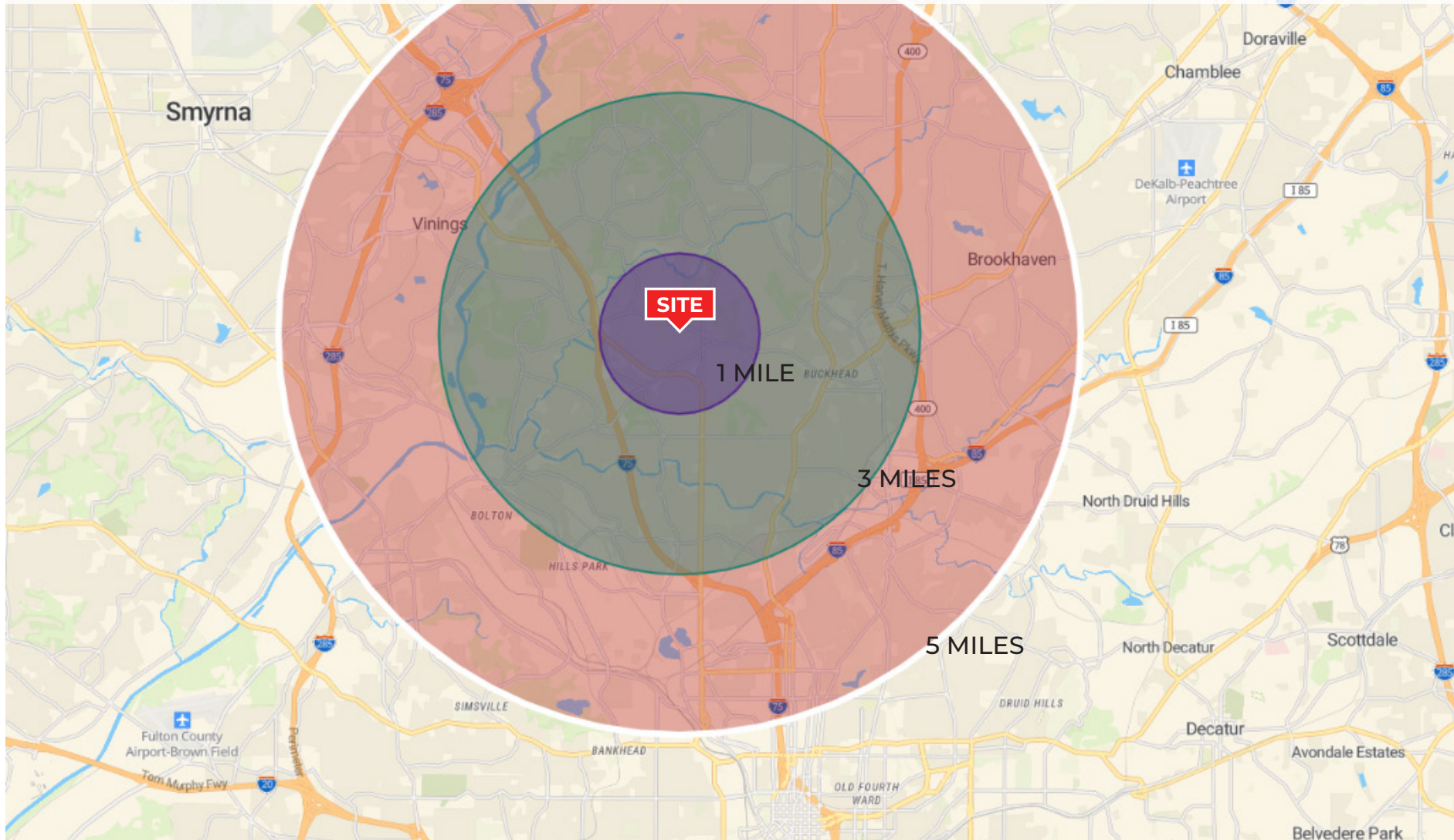

5 MILES

3 MILES

1 MILE



# 3375 E. WOOD VALLEY ROAD

## POINTS OF INTEREST

- Schools:**
  - 1 Warren T. Jackson Elementary School
  - 2 Sutton Middle School
  - 3 Sutton Middle School 6th Grade Campus
  - 4 North Atlanta High School
  - 5 Pace Academy
  - 6 Westminster School
  - 7 The Lovett School
  - 8 Atlanta Speech School
  - 9 The Galloway School
  - 10 Atlanta International School
  - 11 Atlanta Classical Academy
- Points of Interest:**
  - 12 Chastain Park and Golf Course
  - 13 Chastain Park Amphitheater
  - 14 Chatahoocche River Walking Trails
  - 15 Bobby Jones Golf Course and Bitsy Grant Tennis Center
  - 16 Northside Beltline Access
  - 17 Piedmont Hospital
  - 18 Atlanta History Center
  - 19 Governor's Mansion
  - 20 Cherokee Town & Country Club
  - 21 Capital City Country Club
  - 22 Ansley Country Club
  - 23 Atlanta Polo Club
  - 24 Cross Creek Golf Club
  - 25 Top Golf
  - 26 YMCA at Buckhead
  - 27 Garden Hills Pool
- Shopping & Dining:**
  - 28 West Paces Ferry Shopping Center
  - 29 Vinings Jubilee
  - 30 Cumberland Mall
  - 31 Truist Park and The Braves Battery
  - 32 Lenox Mall
  - 33 Phipps Plaza Mall
  - 34 Buckhead Village District
  - 35 Buckhead Bar District
  - 36 The Peach Shopping Center
  - 37 Lindbergh Shopping Mall
  - 38 Peachtree Battle Shopping Mall
  - 39 Moores Mill Center

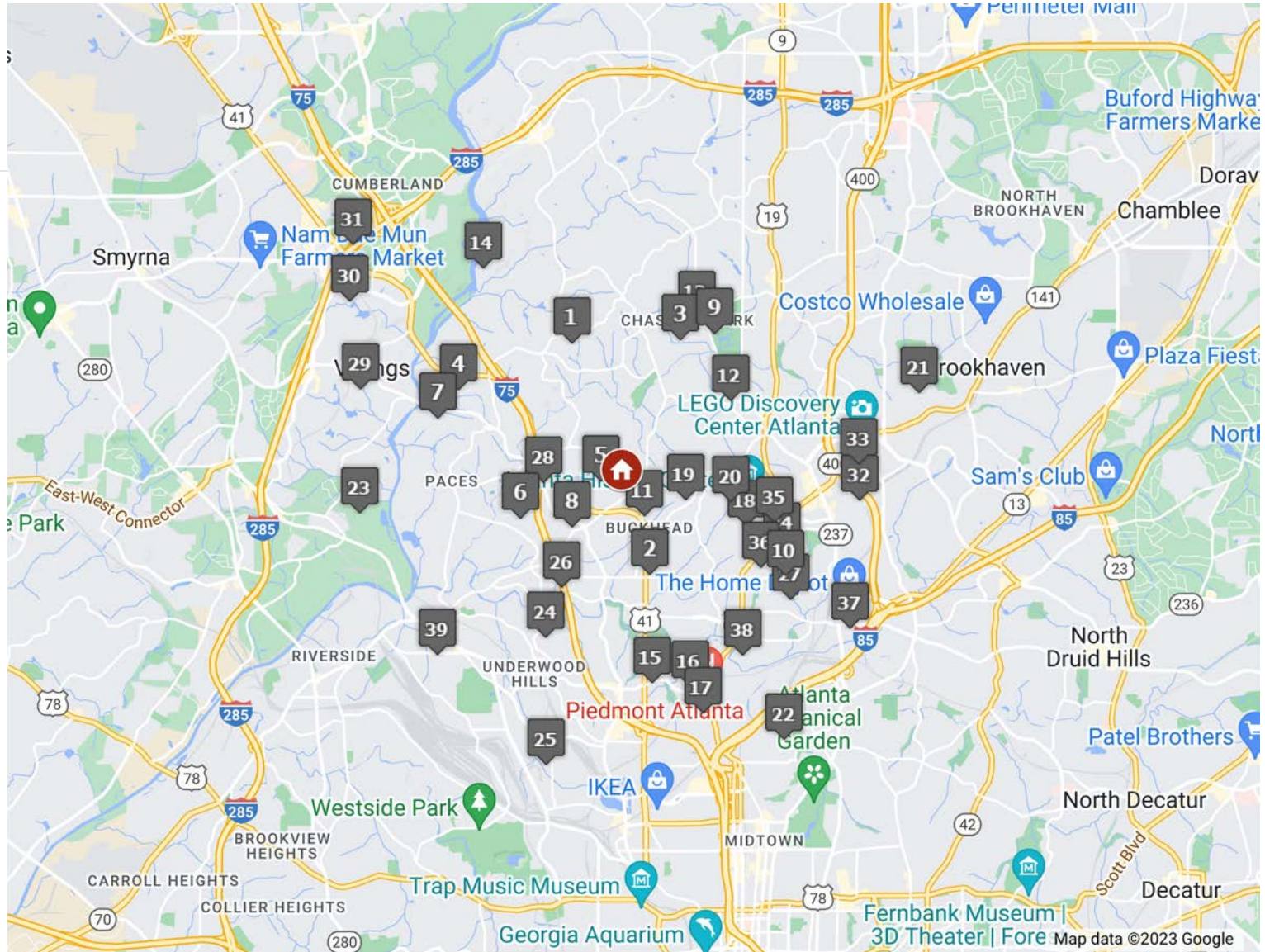





# 3375 E. WOOD VALLEY ROAD

## THE 30327 LIFE

### SOUGHT-AFTER RESIDENTIAL AREA

The 30327 ZIP code is an exclusive and sought-after residential area located in Atlanta, Georgia. Known for its prestigious neighborhoods and luxurious homes, this affluent enclave offers a unique blend of sophistication, natural beauty, and convenient access to urban amenities.

Nestled in the picturesque hills of North Atlanta, the 30327 ZIP code encompasses prestigious communities such as Buckhead, Chastain Park, and Sandy Springs. With a reputation for elegance and charm, this area is home to magnificent mansions, sprawling estates, and private gated communities that exude opulence.

Residents of the 30327 ZIP code enjoy a serene and tranquil environment, with lush greenery, tree-lined streets, and meticulously manicured landscapes. The area is renowned for its spacious lots, providing ample privacy and a serene retreat from the bustling city.

In addition to its natural beauty, the 30327 ZIP code offers a host of amenities and attractions. Chastain Park, one of the largest parks in Atlanta, is a prominent feature, providing residents with extensive green spaces, walking trails, a golf course, tennis courts, and an amphitheater for outdoor concerts.

The area also boasts a vibrant dining and shopping scene, with high-end boutiques, upscale restaurants, and gourmet markets catering to the sophisticated tastes of its residents. From fine dining experiences to trendy cafes and boutiques, the 30327 ZIP code offers a diverse range of options for entertainment and leisure.

Proximity to Atlanta's bustling city center is another advantage of the 30327 ZIP code. Residents can easily access the vibrant cultural scene, world-class museums, theaters, and professional sports stadiums that the city has to offer. Additionally, the area benefits from convenient transportation links, making it easy to navigate and explore the greater Atlanta area.

Overall, the 30327 ZIP code represents a captivating blend of exclusivity, natural beauty, and urban convenience. With its prestigious neighborhoods, luxurious homes, and a plethora of amenities, this area continues to attract discerning individuals seeking an upscale and refined lifestyle in the heart of Atlanta.



# 3375 E. WOOD VALLEY ROAD

## AREA HOME SALES



### AREA HOME SALES SINGLE FAMILY RESIDENCES 30327 ZIP CODE

YEAR	RESALES		NEW CONSTRUCTION	
	AVERAGE PRICE	VOLUME	AVERAGE PRICE	VOLUME
2023 YTD*	\$1,939,026.00	86	\$3,228,000.00	5
2022	\$1,744,512.00	263	\$4,222,100.00	10
2021	\$1,672,268.00	412	\$2,963,955.00	21
2020	\$1,522,677.00	363	\$2,591,709.00	27



# 3375 E. WOOD VALLEY ROAD ZONING

The property is currently zoned R-3 in The City of Atlanta. R-3 zoning is meant to provide lots of a medium size at a density of not more than one dwelling for 18,000 square feet (.413 Acres), and a road frontage of not less than 100 feet.

[CLICK FOR ZONING CODE](#)



# 3375 E. WOOD VALLEY ROAD ZONING

FOR ADDITIONAL INFORMATION OR TO  
SETUP A PROPERTY TOUR, PLEASE CONTACT:



**ANDREW O'CALLAGHAN**

REALTOR®

404-316-6307 direct

404.261.2700 office

[andrew.ocallaghan@harrynorman.com](mailto:andrew.ocallaghan@harrynorman.com)



**SHIRLEY SHARP**

ASSOCIATE BROKER

404-291-2273 direct

404.261.2700 office

[shirley.sharp@harrynorman.com](mailto:shirley.sharp@harrynorman.com)

