

0" 1" 2" 3" 4" 5" 6" 7" 8" 9" 10" 11" 12" 13" 14" 15" 16" 17" 18"

R
Q
P
N
M
L
K
J
H
G
F
E
D
C
B
A



DH&W

ARCHITECTURE INTERIORS PLANNING
1001 Carter Street - Chattanooga - 37402
423 | 266 | 4816 www.dhw-architects.com



JC Curtis -Spec Building

Project Street Address Goes Here...
Project City, State, & Zip Goes Here...

August 26 2024
Drawn: Hausler
File: TBD

Revisions

Key Plan

ALL DRAWINGS AND WRITTEN MATERIAL CONSTITUTE ORIGINAL WORK OF THE ARCHITECT AND MAY NOT BE REPRODUCED, USED, OR DISCLOSED WITHOUT CONSENT OF THE ARCHITECT.
© 2024 DH&W ARCHITECTS. ALL RIGHTS RESERVED.
NOTE THAT THESE DRAWINGS ARE PRODUCED IN COLOR AND ARE TO BE USED IN COLOR.

PRELIMINARY

Title:
Site Plan and Rendering

Scale:
Sheet No.

A100

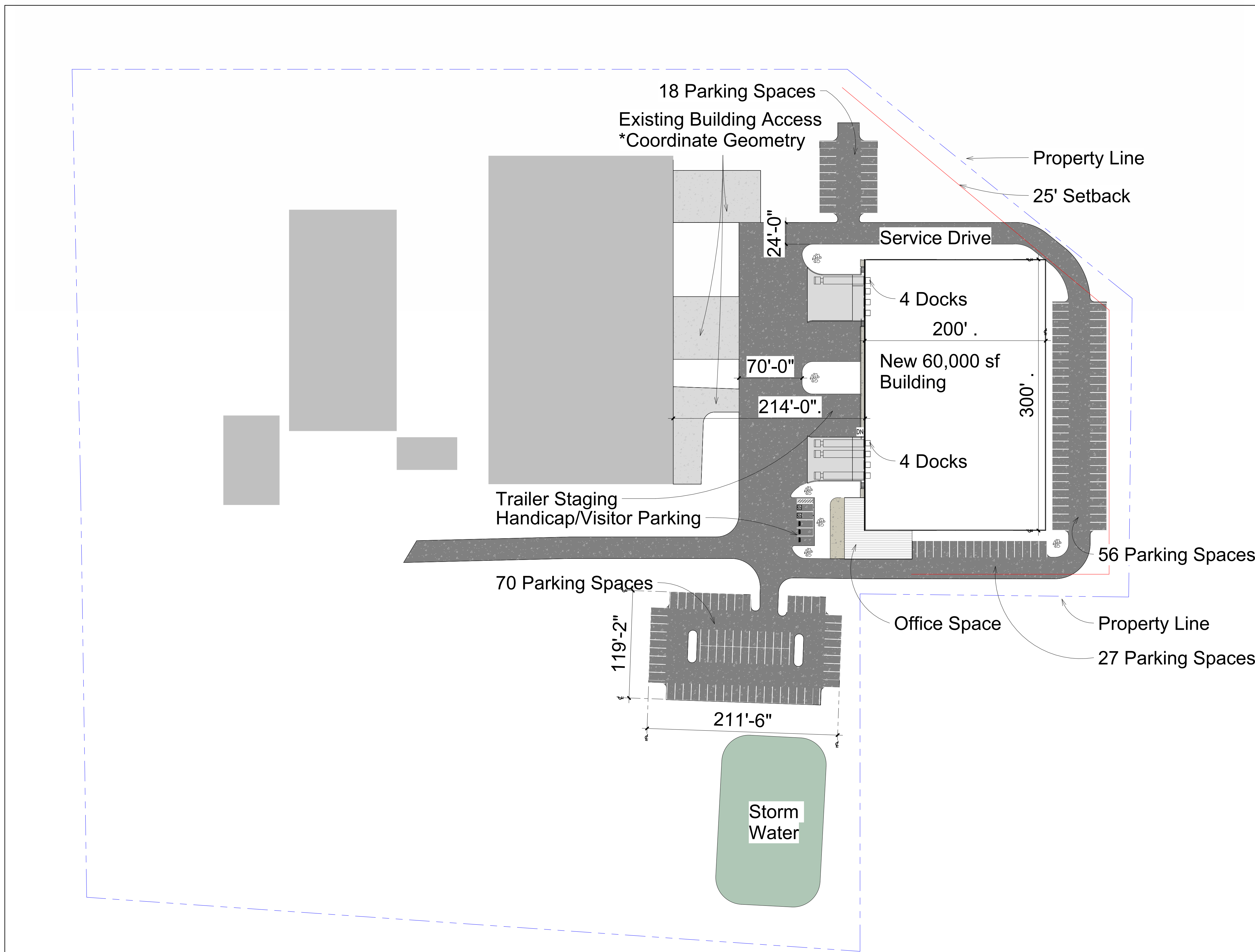

A12 Conceptual Site Plan
A100 1" = 60'-0" Dimensions

1 2 3 4 5 6 7 8 9 10 11 12 13 14 15 16 17 18



DH&W

ARCHITECTURE INTERIORS PLANNING
 1001 Carter Street - Chattanooga - 37402
 423 | 266 | 4816 www.dhw-architects.com

JC CURTIS
 CONSTRUCTION

JC Curtis -Spec Building

Project Street Address Goes Here...
 Project City, State, & Zip Goes Here...

August 26 2024
 Drawn: Author
 File: TBD

Revisions:

Key Plan

ALL DRAWINGS AND WRITTEN MATERIAL CONSTITUTE ORIGINAL WORK OF THE ARCHITECT AND MAY NOT BE REPRODUCED, COPIED, OR DISCLOSED WITHOUT CONSENT OF THE ARCHITECT. © 2024 DH&W ARCHITECTS. ALL RIGHTS RESERVED. NOTE THAT THESE DRAWINGS ARE PRODUCED IN COLOR AND ARE TO BE USED IN COLOR.

PRELIMINARY

Title:
Conceptual Site Plan

Scale:
 Sheet No.

A18 **Conceptual Site Plan**

A101