

For lease

6190 Regency Parkway
Suite 304, Norcross, GA



Building size 58,733 s.f.

Available size 6,288 s.f.

Office size 1,686 s.f.

Clear height 18'

Dock-high doors 2

Drive-in doors 1

Truck court depth 100'

Configuration Rear load

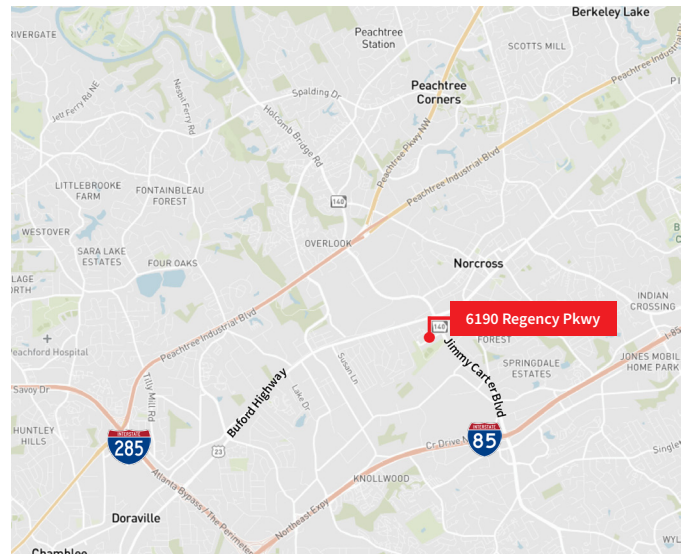

6190 Regency Parkway, Suite 304, Norcross, GA

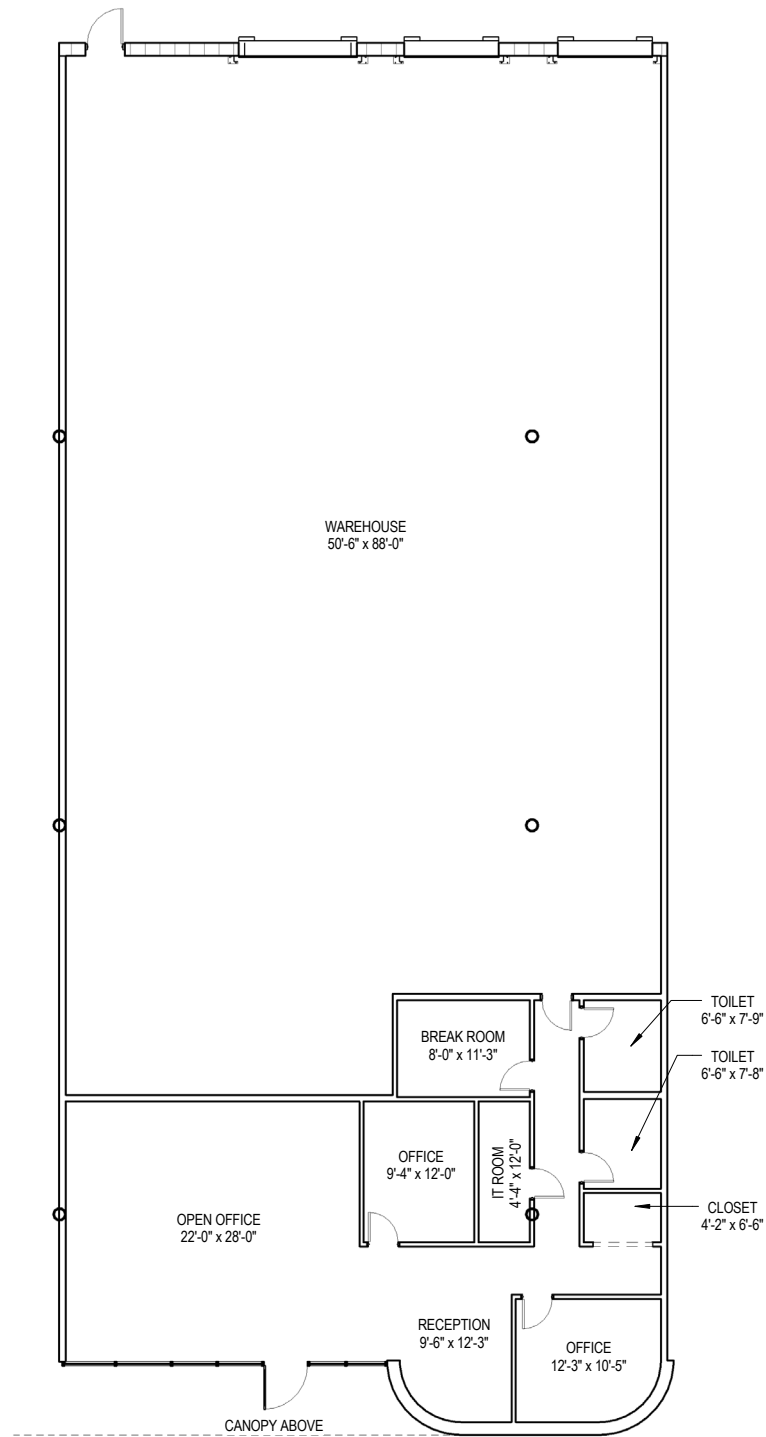

Reed Davis, SIOR
Executive Managing Director
reed.davis@jll.com
+1 404 995 2227

Hannah Dillard
Associate
hannah.dillard@jll.com
+1 404 995 2250



RICHLAND
CAPITAL HOLDINGS