

# Cosmopolitan on the Canal

Downtown Indianapolis Office Sublease

310 West Michigan Street  
Indianapolis, IN 46202  
[www.cbre.com/310WMichigan](http://www.cbre.com/310WMichigan)

6,282 SF Available



# Property Highlights

The Cosmopolitan is conveniently located in the Central Business District of Indianapolis, IN. Walking distance from many retail amenities, Monument Circle, Mass Ave, the Central Canal and the IUPUI Campus.

**+ Suite 2: 6,282 SF**

- Lease Expiration Feb 28, 2024
- Includes 15 Covered/Reserved Parking Spaces in the Attached Garage

- + Modern, Open Floor Plan with Abundant Natural Light
- + Furniture Included
- + Attached Parking Garage and Adjacent Surface Parking Available

**+ Rate:** Contact Broker

## Suite 2 | 6,282 SF

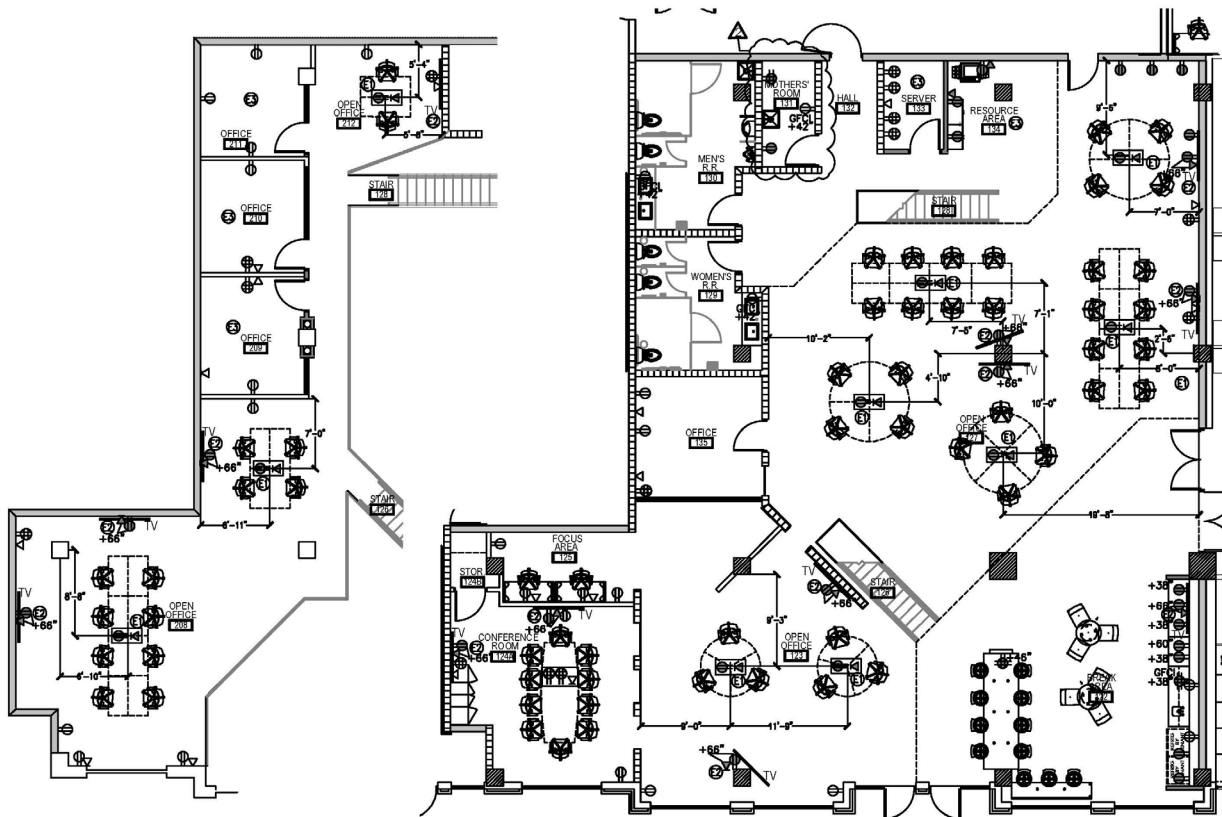

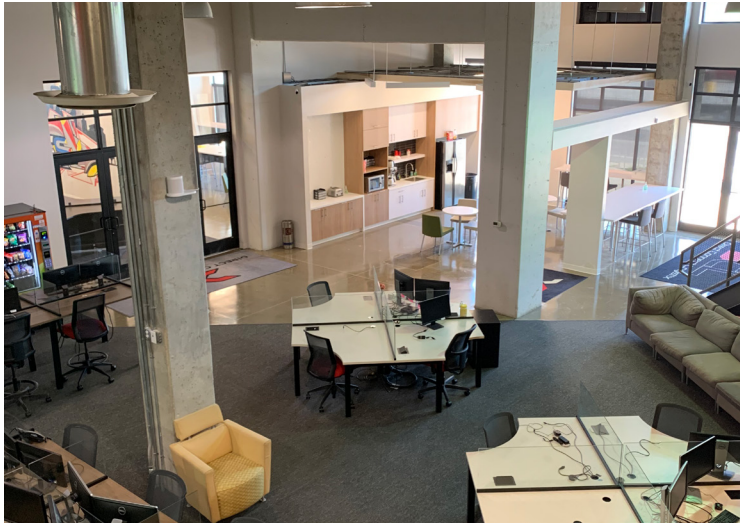

## Contact Us

### Jeff Merritt

Vice President  
+1 317 269 1040  
jeff.merritt@cbre.com

### Lindsey Bridgewater

Associate Broker  
+1 317 269 1131  
lindsey.bridgewater@cbre.com

© 2022 CBRE, Inc. All rights reserved. This information has been obtained from sources believed reliable, but has not been verified for accuracy or completeness. You should conduct a careful, independent investigation of the property and verify all information. Any reliance on this information is solely at your own risk. CBRE and the CBRE logo are service marks of CBRE, Inc. All other marks displayed on this document are the property of their respective owners, and the use of such logos does not imply any affiliation with or endorsement of CBRE. Photos herein are the property of their respective owners. Use of these images without the express written consent of the owner is prohibited.