

201 FLEX INDUSTRIAL

4220 West 2100 South | Salt Lake City, UT 84120

201 FLEX INDUSTRIAL

4220 West 2100 South | Salt Lake City, UT 84120

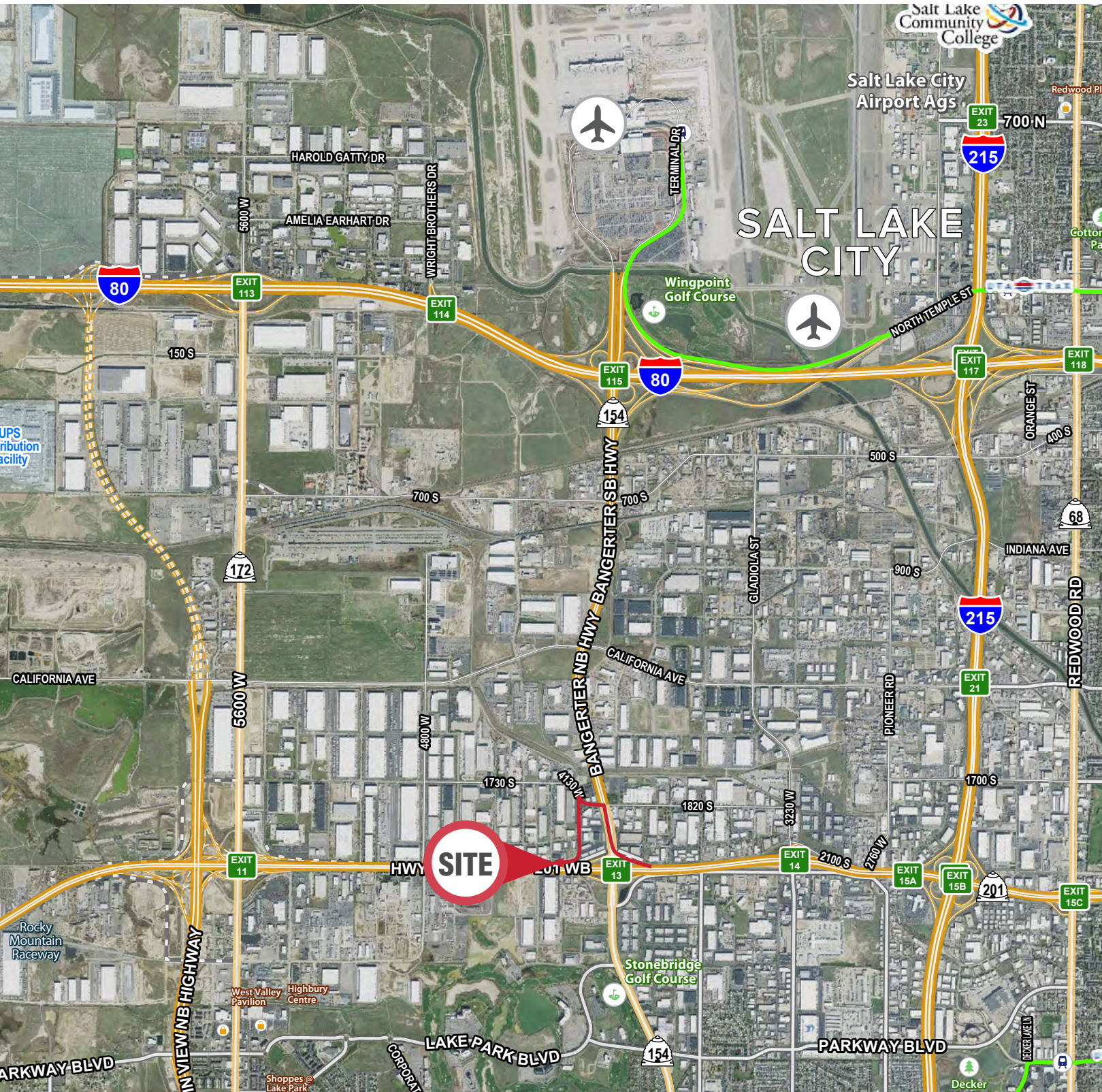

FOR LEASE

\$1.35 PSF NNN

Property Highlights

- Total Available SF: 2,116 SF
 - Warehouse SF: 1,397 SF
 - Office SF: 719 SF
- Clear Height: 19'
- One (1) Automatic 10'x12' GL Door
- Fire Sprinkler System
- One (1) Gas Forced Heater
- Temperature Controlled Warehouse
- Zoning: M-1
- Power: 200 Amp 120/208V 3 Phase-4 Wire
- Two (2) Restrooms
- LED Lighting Throughout Warehouse
- Skylight in Warehouse
- Security System Installed
- Access: Great access from Bangerter and highway exposure on Highway 201
- Location: Located within Centennial Industrial Park on Salt Lake City's west side, this property offers exceptional access to four major freeways — I-15, I-80, the 201 Freeway, and Bangerter Highway. The park's central position in the Salt Lake Valley provides convenient connectivity to the Salt Lake City International Airport and Union Pacific's Intermodal Facility.

Contact

SKYLER PETERSON, SIOR
Executive Vice President
m 801.656.7354
speterson@legendcommercial.com

TRE BOURDEAUX, SIOR
Vice President
m 801.824.0397
tbourdeaux@legendcommercial.com

PARKER TAGGART
Senior Associate
m 801.928.1815
ptaggart@legendcommercial.com



801.930.6750 | www.legendcommercial.com
2180 S 1300 E, Suite 240 | Salt Lake City, UT 84106

Contact

SKYLER PETERSON, SIOR
Executive Vice President
m 801.656.7354
speterson@legendcommercial.com

TRE BOURDEAUX, SIOR
Vice President
m 801.824.0397
tbourdeaux@legendcommercial.com

PARKER TAGGART
Senior Associate
m 801.928.1815
ptaggart@legendcommercial.com



801.930.6750 | www.legendcommercial.com
2180 S 1300 E, Suite 240 | Salt Lake City, UT 84106

201 FLEX INDUSTRIAL

4220 West 2100 South | Salt Lake City, UT 84120

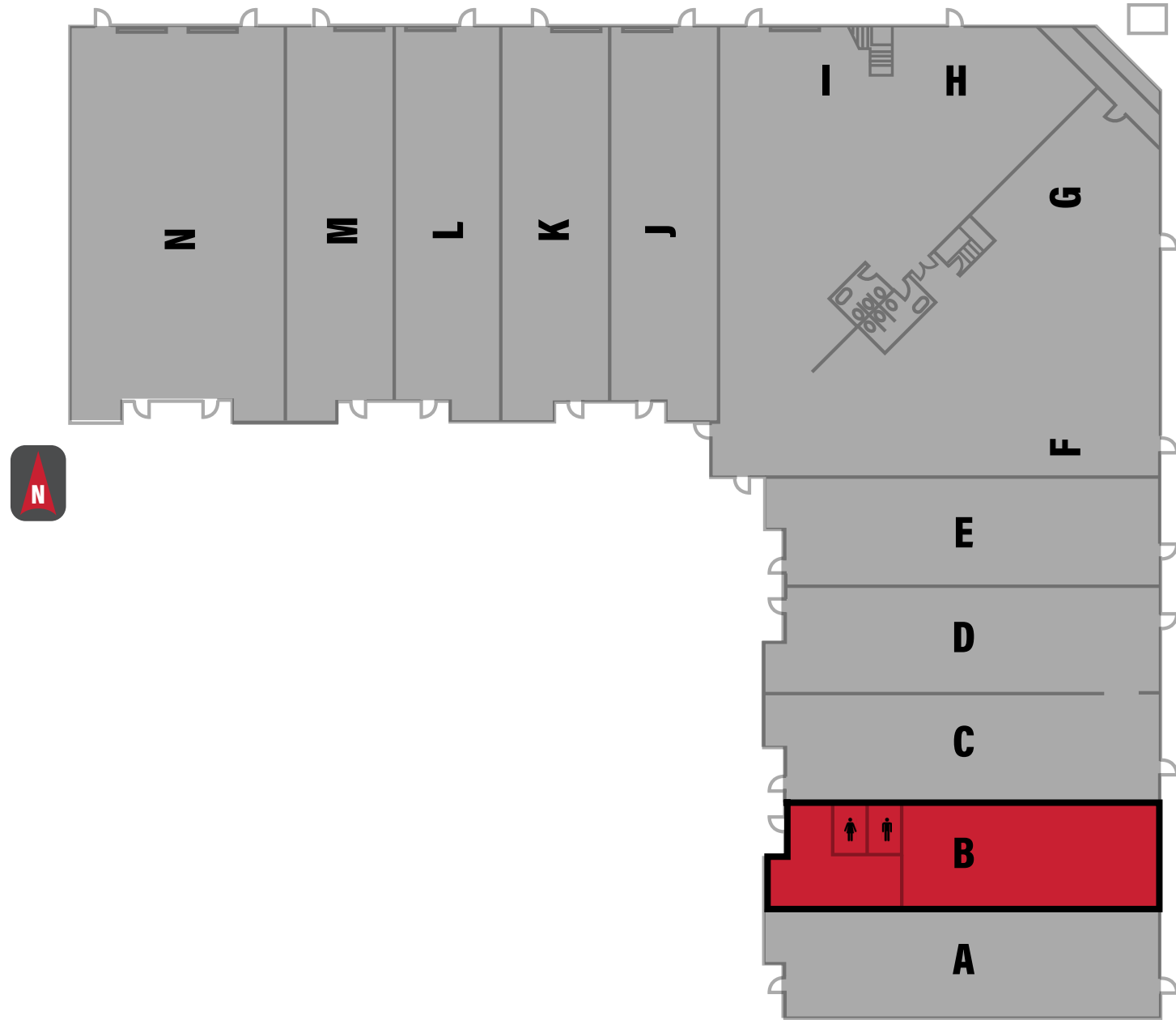

Suite B - 2,116 SF

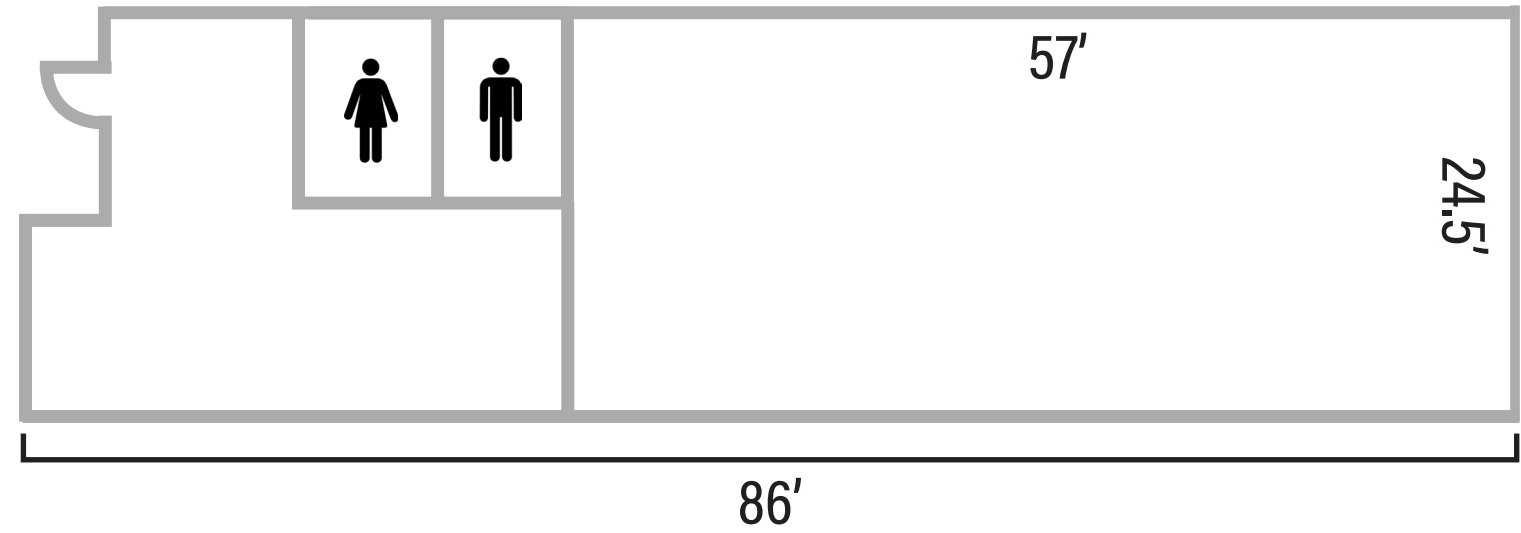

Suite	Square Footage
A	LEASED
B	2,116
C	LEASED
D	LEASED
E	LEASED
F/G	LEASED
H/I	LEASED
J	LEASED
K	LEASED
L	LEASED
M	LEASED
N	LEASED

Contact

SKYLER PETERSON, SIOR
Executive Vice President
m 801.656.7354
speterson@legendcommercial.com

TRE BOURDEAUX, SIOR
Vice President
m 801.824.0397
tbourdeaux@legendcommercial.com

PARKER TAGGART
Senior Associate
m 801.928.1815
ptaggart@legendcommercial.com



Contact

SKYLER PETERSON, SIOR
Executive Vice President
m 801.656.7354
speterson@legendcommercial.com

TRE BOURDEAUX, SIOR
Vice President
m 801.824.0397
tbourdeaux@legendcommercial.com

PARKER TAGGART
Senior Associate
m 801.928.1815
ptaggart@legendcommercial.com

