

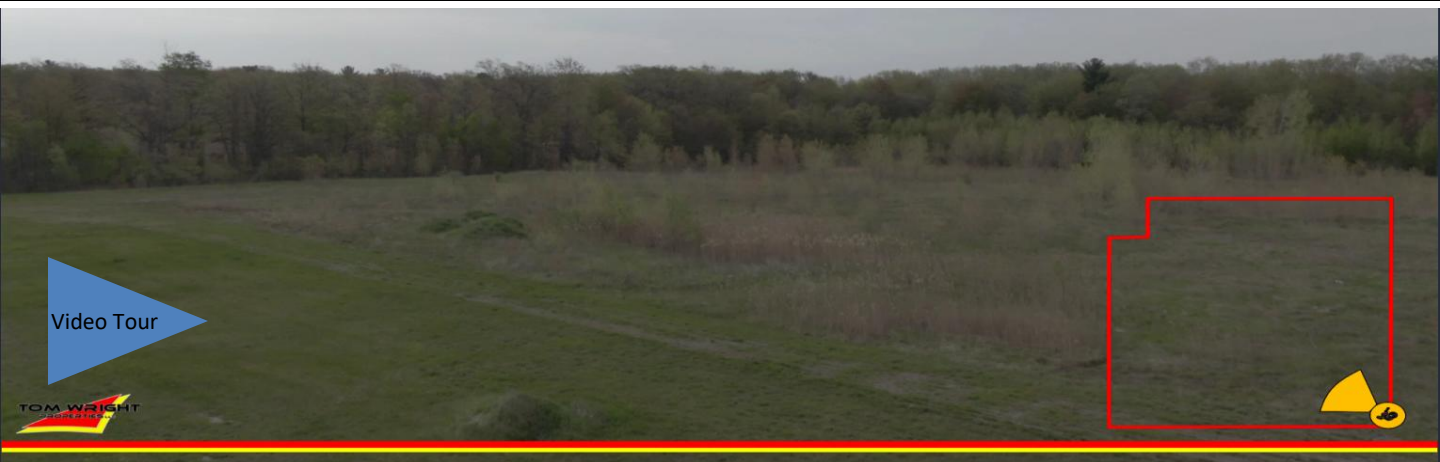

# 10000 Gratiot Rd, Saginaw, MI



Video Tour

## 13.85 Acres of Prime Real-Estate

East



As seen in video

**This property** is conveniently located eight miles West of down town Saginaw, 10 miles West of I-75 and 14 miles South West of MBS International airport with easy access in and out of the property and is zoned B3.

**It is** in the path of Saginaw's Westward growth and has easy access to both East and West bound traffic on Gratiot Rd with a turn-around located in front of property.

**Features:**

- Vehicle traffic per day: 8,800+ vehicles (MDOT report)
- Under three minutes from major retailers
- Frontage on Gratiot Rd: 726.98 feet
- Second turn-around within 200' West of property
- Property depth: 839.59 feet
- Four highway billboards provide \$1,400 yearly rental
- Authorized uses: office, restaurant, retail, warehouse....

**Click** on the blue arrow to watch a video tour of this property to fully appreciate all that it offers.

West



As seen in video

|         |                                    |
|---------|------------------------------------|
| ADDRESS | 10000<br>Gratiot Rd,<br>Saginaw MI |
|---------|------------------------------------|

|         |     |
|---------|-----|
| SQ. FT. | N/A |
|---------|-----|

|         |       |
|---------|-------|
| ACREAGE | 13.85 |
|---------|-------|

|              |               |
|--------------|---------------|
| ASKING PRICE | \$<br>600,000 |
|--------------|---------------|

|                       |              |
|-----------------------|--------------|
| ASKING PRICE PER Acre | \$<br>43,321 |
|-----------------------|--------------|

For more information contact

### Tom Wright Properties LLC

Direct Phone (734) 282-2522  
 Direct Fax (734) 939-0110  
 Mobile and Text (734) 558-6060

tomwright@tomwright.biz

Find us  
on



The information contained herein is from sources deemed to be reliable but not guaranteed and is subject to change or withdrawal without notice.