

# Office Spaces | For Lease

**CBRE**

410 Saint-Nicolas Street  
Montreal (Quebec)

CBRE URBAN PROPERTIES | MONTREAL







Suite 505



Suite 560



Suite 560



Suite 560



Suite 560

# Lease Terms

<b>Term</b>	5 years
<b>Additional Rent</b>	\$13.00 per sq. ft. Base Year 2024
<b>Net Rent</b>	\$18.00 per sq. ft.
<b>Tenant Improvement Allowance</b>	TBD
<b>Hydro / In-Suite Cleaning</b>	Included
<b>Availability</b>	Immediate



# Floor Plans

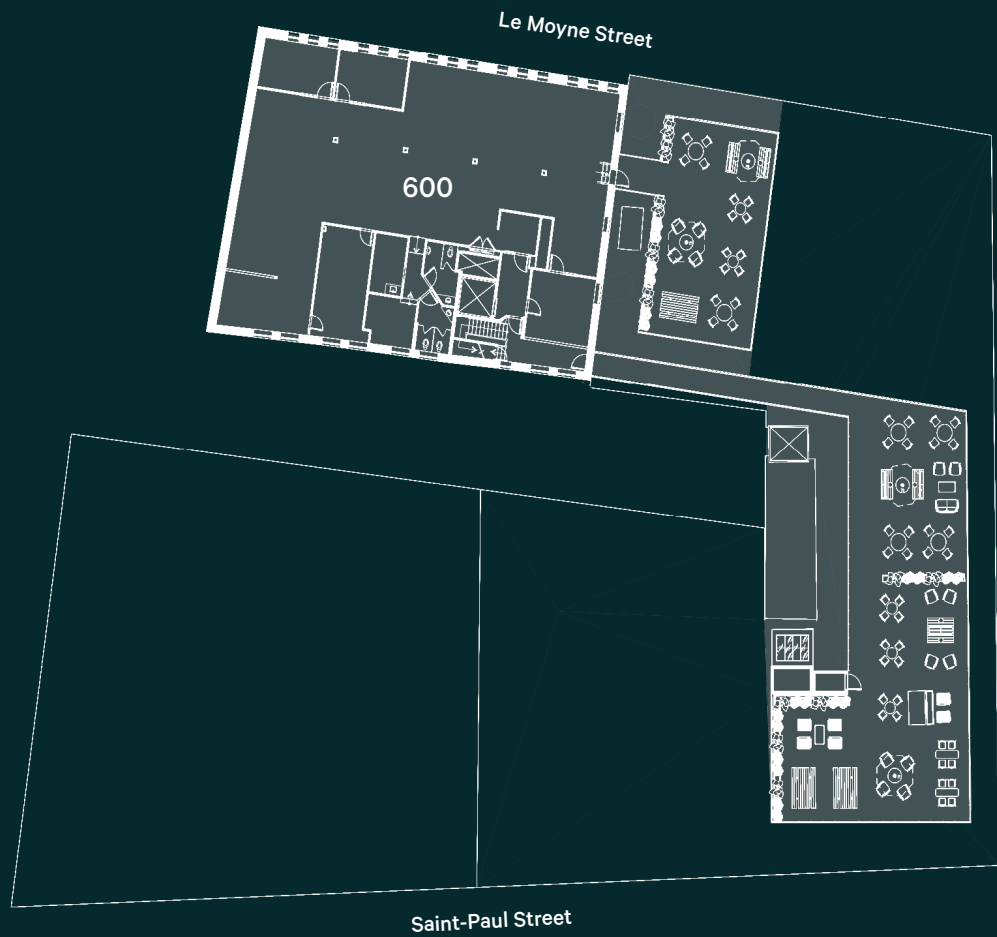
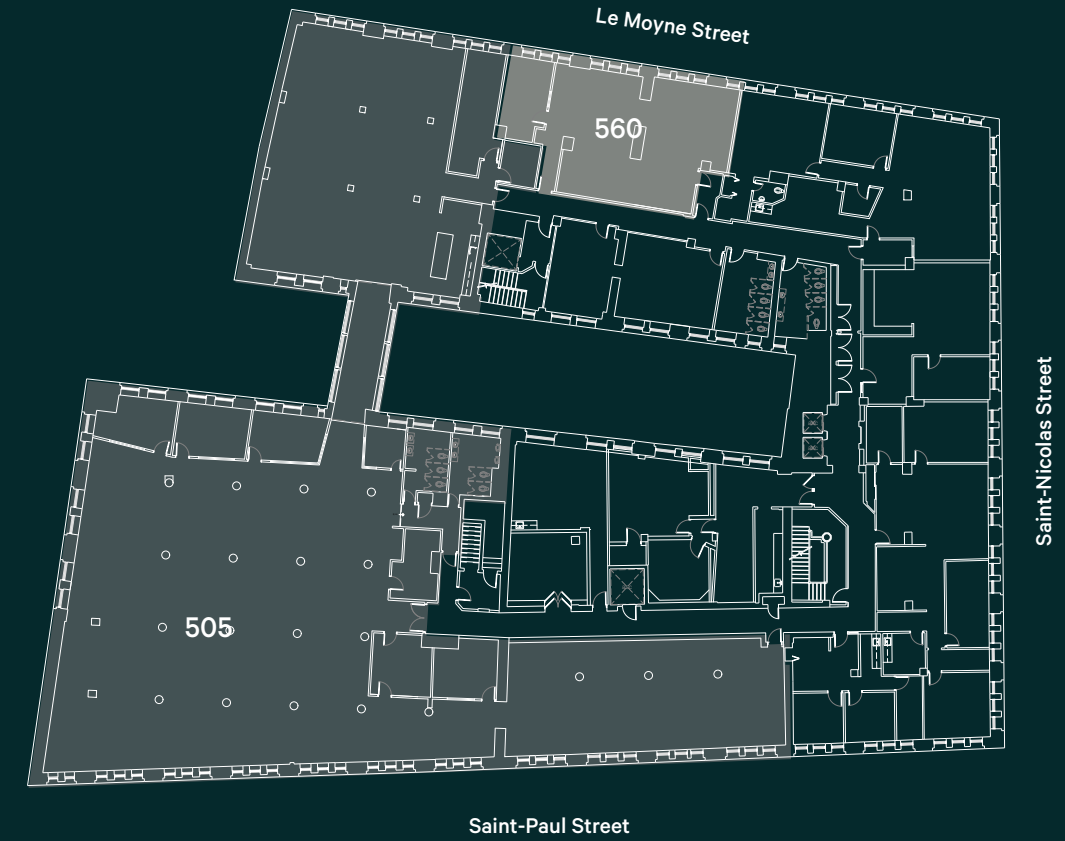

Suite		SQ. FT.
101		7,924
104		1,152
505	LOUÉ	13,112
560		1,469
600		4,657
Possible private rooftop terrace		Full floor



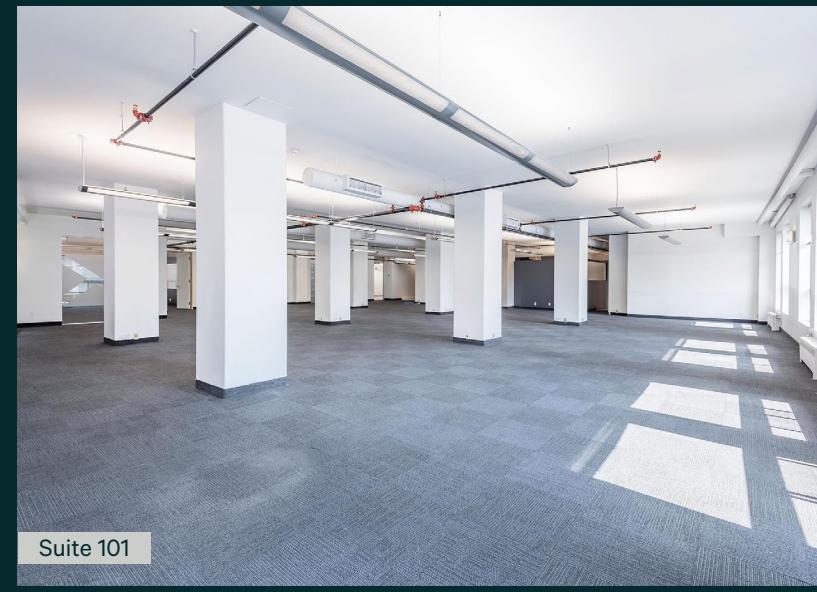

# Property Details



Located on Saint-Nicolas Street between Saint-Pierre and Le Moyne streets



Numerous amenities located in close proximity



The space benefits from natural light



Move in ready suites available



7-min walk to the Place-D'Armes metro station





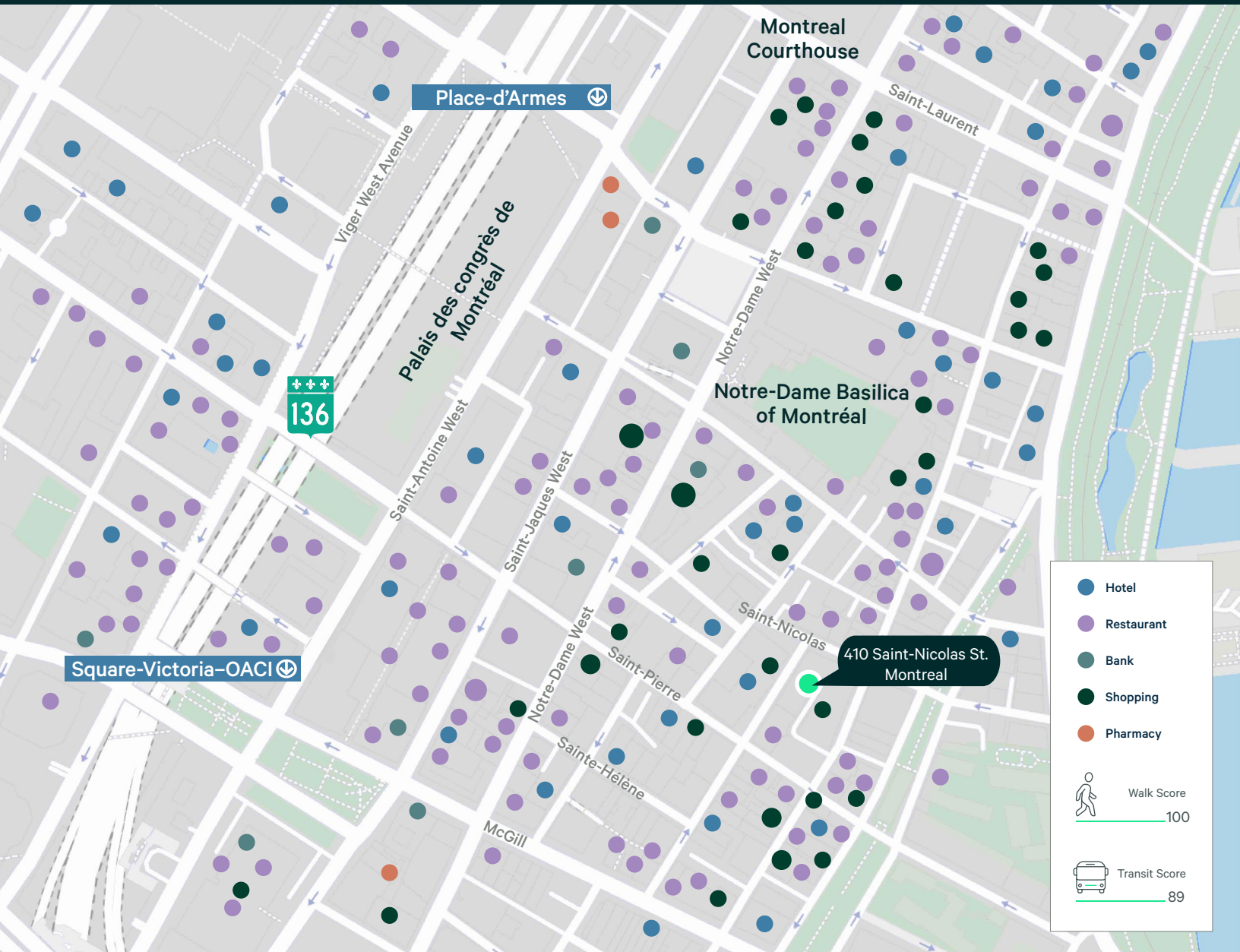

## Contact Us

**Christopher Rundle**  
Vice President  
Real Estate Broker  
+1 514 375 0818  
christopher.rundle@cbre.com

**Bryan Greenberg**  
Associate Vice President  
Commercial Real Estate Broker  
+1 514 375 2507  
bryan.greenberg@cbre.com

**Amanda Angela Herbu**  
Associate  
Commercial Real Estate Broker  
+1 514 375 0456  
amanda.herbu@cbre.com

CBRE Limited, Real Estate Agency | 1250 René-Lévesque Blvd West, Suite 2800 | Montréal, Québec H3B 4W8 | +1 514 849 6000 | www.cbre.ca

This disclaimer shall apply to CBRE Limited, Real Estate Agency, and to all other divisions of the Corporation; to include all employees and independent contractors ("CBRE"). The information set out herein, including, without limitation, any projections, images, opinions, assumptions and estimates obtained from third parties (the "Information") has not been verified by CBRE, and CBRE does not represent, warrant or guarantee the accuracy, correctness and completeness of the Information. CBRE does not accept or assume any responsibility or liability, direct or consequential, for the Information or the recipient's reliance upon the Information. The recipient of the Information should take such steps as the recipient may deem necessary to verify the Information prior to placing any reliance upon the Information. The Information may change and any property described in the Information may be withdrawn from the market at any time without notice or obligation to the recipient from CBRE. CBRE and the CBRE logo are the service marks of CBRE Limited and/or its affiliated or related companies in other countries. All other marks displayed on this document are the property of their respective owners. All Rights Reserved. Mapping Sources: Canadian Mapping Services canadamapping@cbre.com; DMTI Spatial, Environics Analytics, Microsoft Bing, Google Earth.