

TELEMUNDO BUILDING

4107 W. Spruce St. | Tampa, FL 33607

FOR LEASE



TMC
THE MAHR COMPANY

PROPERTY DETAILS

- Prime Westshore Location
- Ample Parking & Competitive Rates
- Easy Ingress/Egress
- Less than 1 mile to International Plaza Mall
- Very close proximity to Tampa International Airport
- Great professional mix of tenants
- Convenient access to all main Roadways to Pinellas County and all points North South East and West

1st Floor Available Suite:

- Suite 101: 3,502 SF



Interior photos are of Suite 205.

PARKING RATIO:

5:1,000

RENTAL RATE:

\$27.50/SF
Full Service

LEASE TERM:

Negotiable
Short Term Welcome

BUILDING SIZE:

2 Stories;
32,634 RSF



Based in Tampa Bay Florida | Statewide Emphasis | National Network

tmc-themahrcompany.com

4107 W. SPRUCE FLOOR PLANS

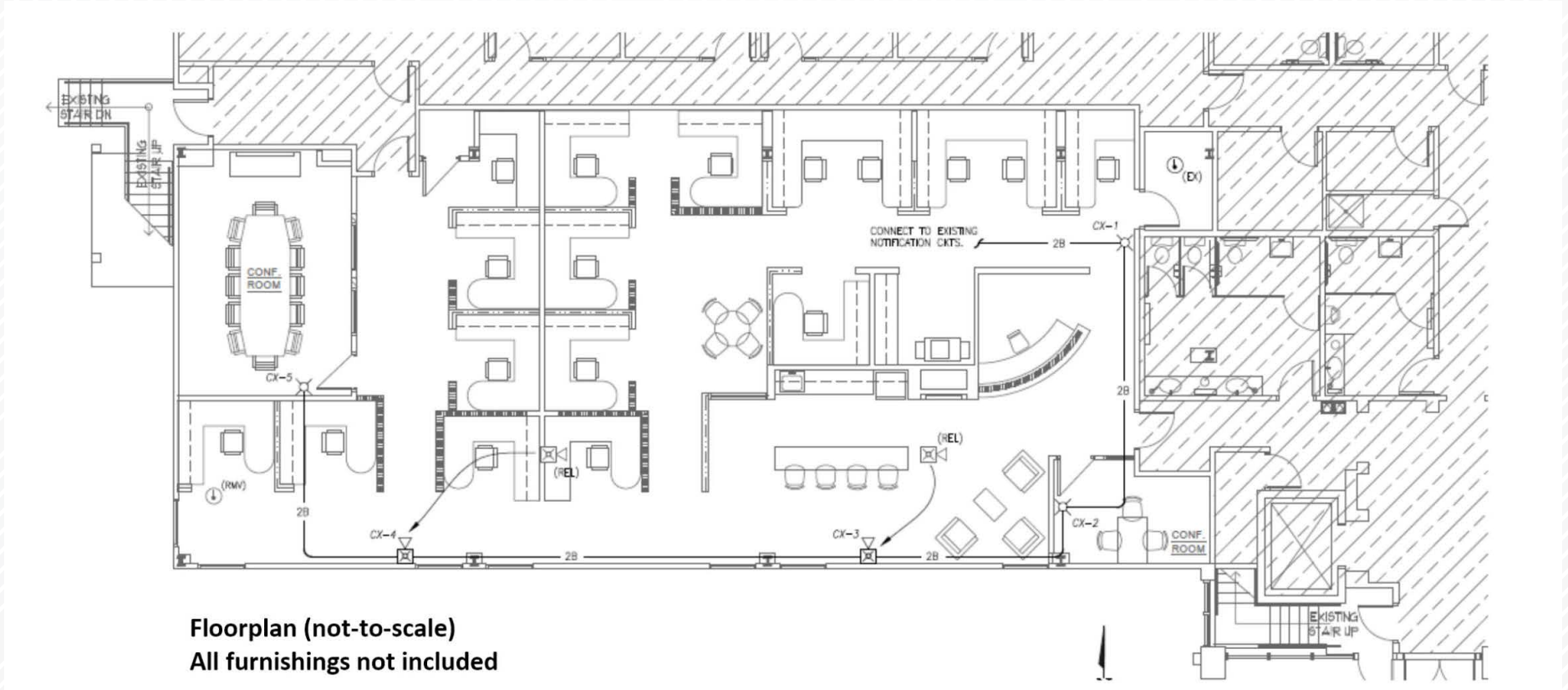



4950 W Kennedy Blvd.
Suite 301
Tampa, FL 33609
813.835.4888

Amy Cox
813.205.2427
acox@mahrcompany.com

Thomas Grandoff
813.299.0399
tgrandoff@mahrcompany.com

tmc-themahrcompany.com

The material contained herein together with and including but not limited to all attachments, images, exhibits, url's, and documents is based in part upon information supplied by the owner of the property, their representative(s) or agents, and in part upon information obtained by TMC The Mahr Company from sources it deems reliable. Summaries of any documents are not intended to be comprehensive or all inclusive but rather only outlines of some of the provisions contained therein. No warranty or representation, expressed or implied, is made as to the accuracy or completeness of the information contained herein, and same is submitted subject to errors, omissions, change of price, term, rates, rental or other conditions, withdrawal without notice, unavailability of proposed space, and to any other conditions imposed by building owners, their representative(s) or agents. The recipient of this information must rely on their own due diligence, investigation, evaluation and judgment as to the advisability of this transaction.



PROPERTY LOCATION

4107 W Spruce St. is ideally located in the Westshore Business District. Located on W Spruce St. situated one parcel to the East of the NE Corner of the intersection of W. Spruce St. & Lois Ave.

Based in Tampa Bay Florida | Statewide Emphasis | National Network