



OFFERING MEMORANDUM

17-UNIT TOWNHOME STYLE APARTMENT COMPLEX

2109 NORTH WHITE AVENUE
LA VERNE, CA 91750



Sale Details

2109 NORTH WHITE AVENUE
LA VERNE, CA 91750



Sale Price: \$12,485,000.00
Occupancy: 9 of 17 Units Leased
APN: 8377-019-032
Lot Size: 24,546 Square Feet
GBA: 22,900 Square Feet

- ✓ Newly developed spacious townhomes with 2 car garages, balconies, and more
- ✓ Located walking distance to the Gold Line Train Station (Now Operating), with a 30 min ride to Pasadena and a 60 min ride to Downtown Los Angeles
- ✓ All New appliances included in each unit



📞 909-482-1060

🏠 492 West Foothill Boulevard, Claremont, CA 91711

✉️ trc@renkenco.com

2109 NORTH WHITE AVENUE
LA VERNE, CA 91750

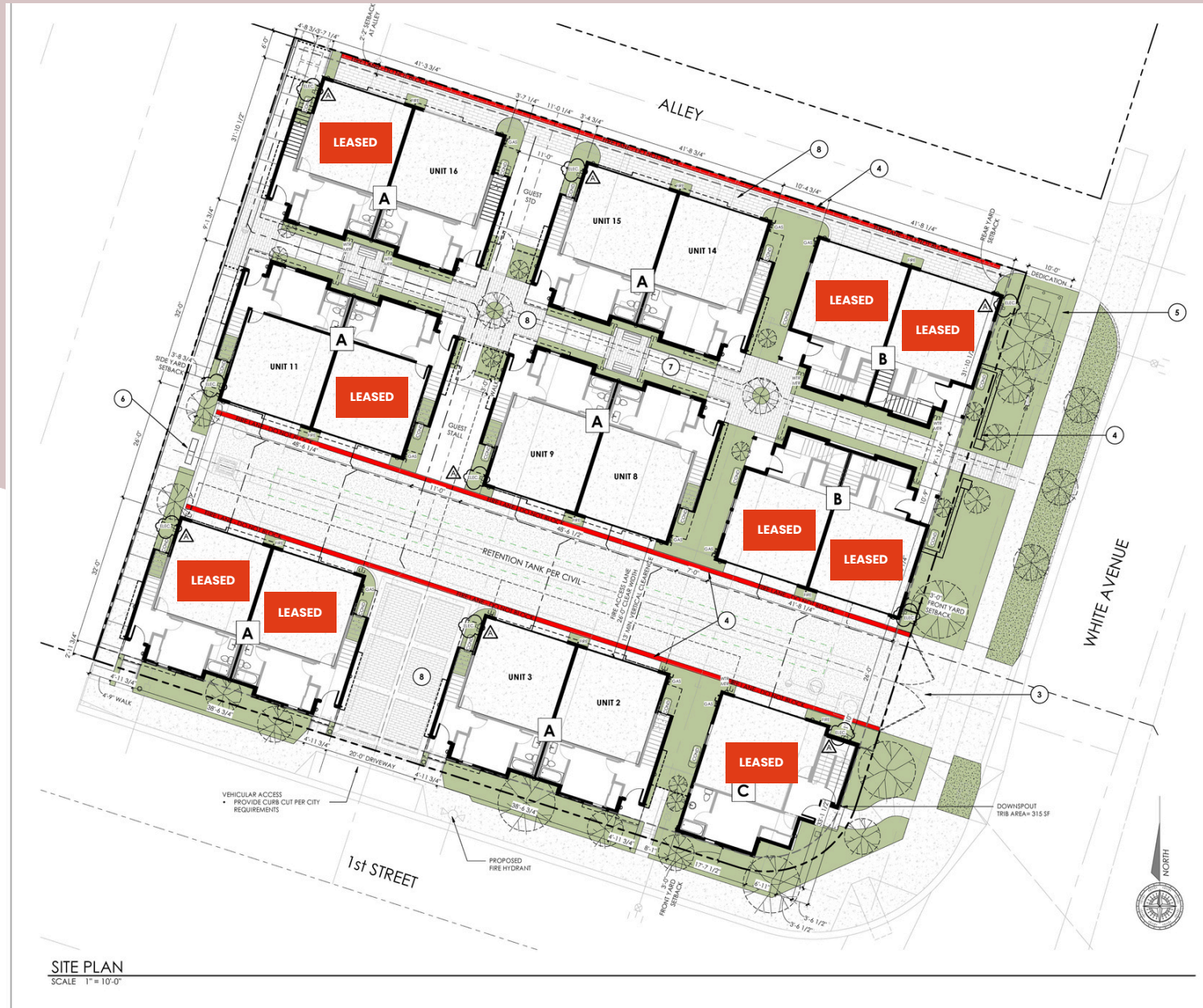

909-482-1060



492 West Foothill Boulevard, Claremont, CA 91711



 trc@renkenco.com

Floor Plans

2109 NORTH WHITE AVENUE
LA VERNE, CA 91750

PLAN A:
3 BED / 3.5 BATH
1,350 SQUARE FEET
12 UNITS



Plan A Floor 1



Plan A Floor 2



Plan A Floor 3

PLAN B:
2 BED / 2.5 BATH
1,300 SQUARE FEET
4 UNITS



Plan B Floor 1



Plan B Floor 2



Plan B Floor 3

PLAN C:
4 BED / 4 BATH
1,500 SQUARE FEET
1 UNIT



Plan C Floor 1



Plan C Floor 2



Plan C Floor 3



909-482-1060

492 West Foothill Boulevard, Claremont, CA 91711

trc@renkenco.com

Unit Images

2109 NORTH WHITE AVENUE
LA VERNE, CA 91750



**apartments come unfurnished*



 909-482-1060

 492 West Foothill Boulevard, Claremont, CA 91711

 trc@renkenco.com

Unit Images

2109 NORTH WHITE AVENUE
LA VERNE, CA 91750



**apartments come unfurnished*



 909-482-1060

 492 West Foothill Boulevard, Claremont, CA 91711

 trc@renkenco.com

Financials

2109 NORTH WHITE AVENUE
LA VERNE, CA 91750

| Revenue | |
|-------------------------------|------------------|
| Gross Potential Rent | \$738,120 |
| RUBS | \$35,700 |
| Effective Gross Income | \$773,820 |
| Expenses | |
| Management Fee (3.00% of EGI) | \$23,215 |
| Utilities | \$11,400 |
| Repairs and Maintenance | \$5,000 |
| Property Taxes | \$139,368 |
| Contract Services | \$12,000 |
| Insurance | \$21,000 |
| Total Expenses | \$211,983 |
| Net Operating Income | \$561,873 |



La Verne

2109 NORTH WHITE AVENUE
LA VERNE, CA 91750



La Verne was once a turn of the century “boom town” created when the Santa Fe Railroad pushed west through California. Originally called Lordsburg by its founder, it was for many years a thriving agricultural community that grew and shipped citrus around the country. In 1909, the town adopted the slogan “Heart of the Orange Empire” and its groves flourished in fragrant rows that stretched across the lap of the San Gabriel Mountains. Today, La Verne is a city of more than 33,000 residents and is a well-balanced community with a diversity of land uses and a good mix of residential, commercial, and industrial features. La Verne is home to the University of La Verne (founded in 1891), Brackett Airport, and several public and private schools.

The City of La Verne encompasses an area of nine square miles, and while incorporated in 1906, it was founded in 1887. La Verne is located in the eastern portion of the San Gabriel Valley and surrounded by the city of San Dimas to the west; the city of Pomona to the south; the cities of Pomona and Claremont, and unincorporated Los Angeles County to the east; and the Angeles National Forest to the north. La Verne is located 30 minutes from both downtown Los Angeles and Orange County civic centers. La Verne is served by the Foothill (210), San Bernardino (10), and Orange (57) Freeways.

Specific plans for Lordsburg, San Polo Business Park, Foothill Boulevard, and Arrow Highway have identified prime commercial parcels and have streamlined the approval processes for compatible projects. Modern amenities and sound infrastructure complement La Verne’s small-town charm, creating a desirable environment in which to live and work.



Lordsburg

2109 NORTH WHITE AVENUE
LA VERNE, CA 91750

- 4 BLOCKS FROM DOWNTOWN LA VERNE
- 3 BLOCKS FROM UNIVERSITY OF LA VERNE
- 3 BLOCKS FROM LOS ANGELES FAIRPLEX
- 2 BLOCKS FROM THE METRO GOLD LINE (NOW OPERATING)

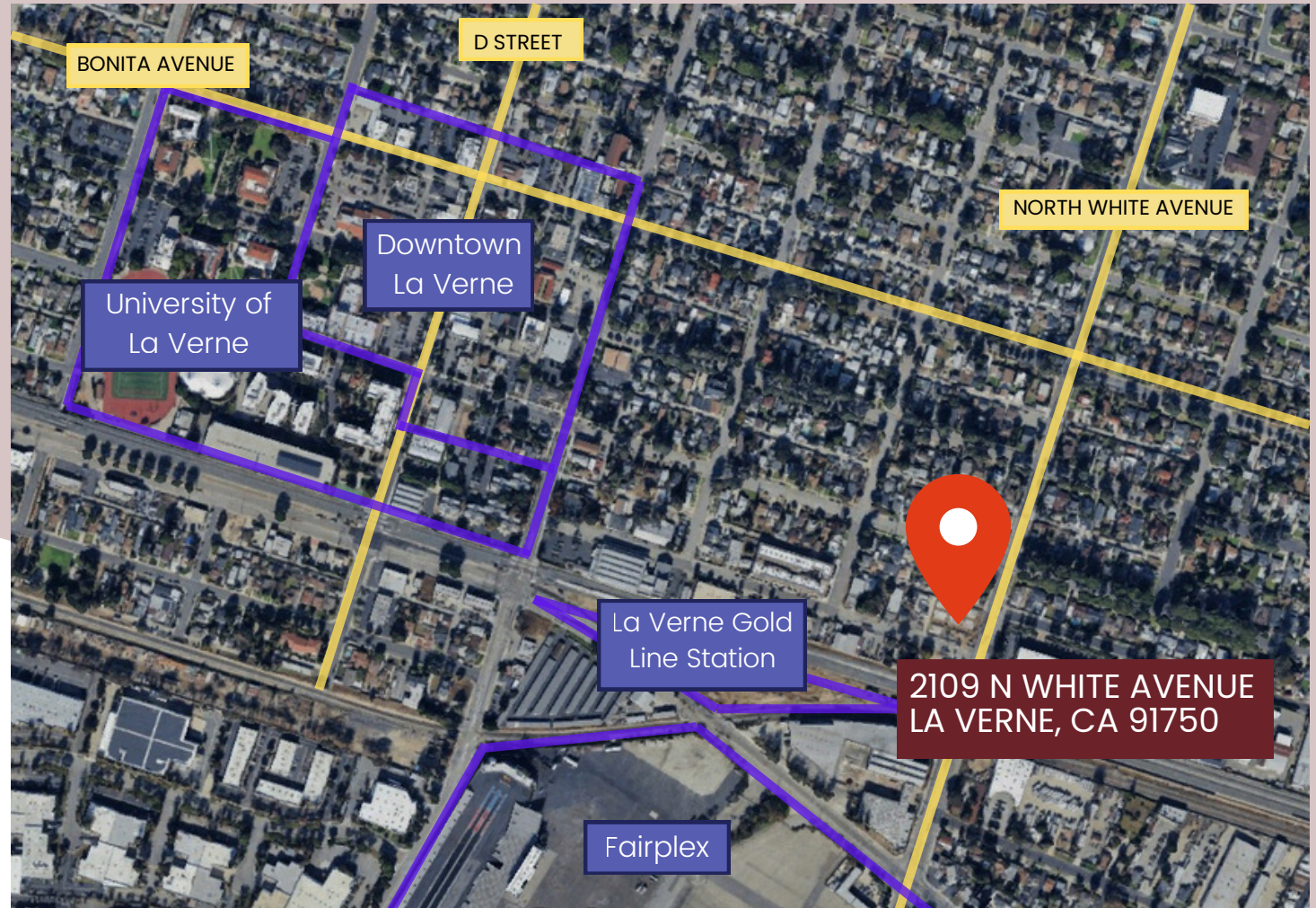

📞 909-482-1060

🏠 492 West Foothill Boulevard, Claremont, CA 91711

✉️ trc@renkenco.com

Nearby Schools

2109 NORTH WHITE AVENUE
LA VERNE, CA 91750

9/10

J. Marion Roynon
Elementary School

9/10

Ramona Middle
School

9/10

Bonita High School

Private Schools:
Damien High School
University of La Verne

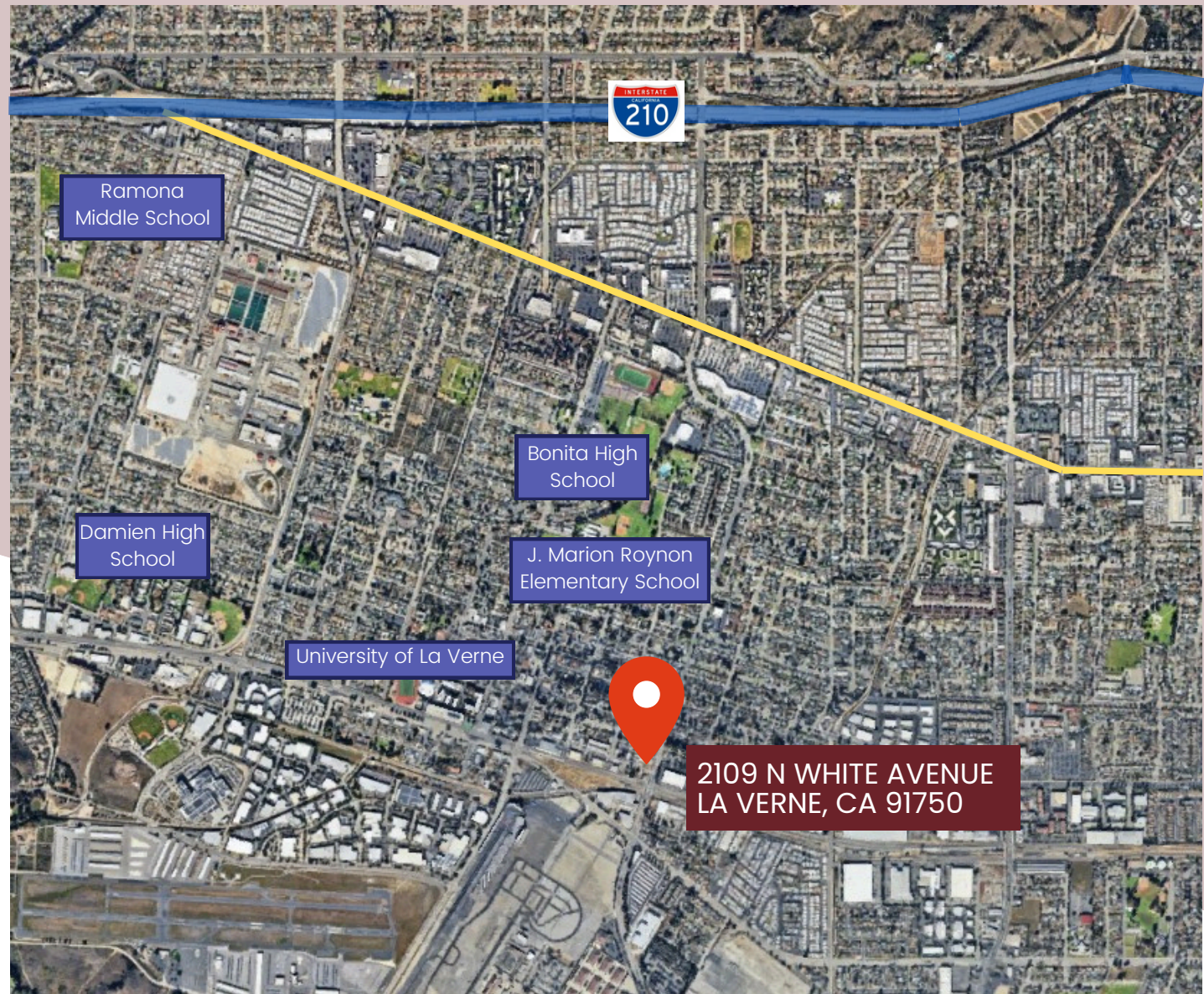

📞 909-482-1060

🏠 492 West Foothill Boulevard, Claremont, CA 91711

✉️ trc@renkenco.com

La Verne

2109 NORTH WHITE AVENUE
LA VERNE, CA 91750

POPULATION: 30,666

MEDIAN AGE: 45.18

LABOR FORCE: 15,917

TOTAL BUSINESSES: 1,333

MEDIAN HOUSEHOLD INCOME: \$107,829



909-482-1060

492 West Foothill Boulevard, Claremont, CA 91711

trc@renkenco.com



CONTACT:



Bobby Del Real
909-482-1060
Bobby.DelReal@RenkenCo.com
DRE #01844221



Kelly Arft
909-482-1060
Kelly.Arft@RenkenCo.com
DRE #01231023



© 2025 The Renken Company. All rights reserved. All information contained herein is from sources deemed reliable, however not representation or warranty is made to the accuracy thereof.