

Available SF 26,800 SF

Industrial For Lease

Building Size 57,525 SF

PRICE REDUCED!!!



Address:

3628 Noakes St, Los Angeles, CA 90023

Cross Streets:

Esperanza St/Noakes St

Excellent Centrally Located Distribution Space
18' Minimum Clear Height
6 Dock High Loading Positions/2 with Load Levelers
*Sprinklered *Skylights *M3 Zoning
Good Access to 5 Fwy Ramps & Freeway Hub

Lease Rate/Mo: \$23,852
Lease Rate/SF: \$0.89
Lease Type: Gross
Available SF: 26,800 SF
Minimum SF: 26,800 SF
Prop Lot Size: POL
Term: 3-5 years w/Periodic COLA's
Sale Price: NFS
Sale Price/SF: NFS
Taxes:
Yard: No
Zoning: M3-1-CUGU

Sprinklered: Yes
Clear Height: 18'
GL Doors/Dim: 0
DH Doors/Dim: 6 / (3) 20'x10'
A: 400 V: 220 O: 3 W: 3
Construction Type: TILT UP
Const Status/Year Blt: Existing / 1969

Whse HVAC: No
Parking Spaces: 27 / Ratio: 1.0:1
Rail Service:
Specific Use: Warehouse/Distribution

Office SF / #: 1,080 SF / 4
Restrooms: 5
Office HVAC: None
Finished Ofc Mezz: 0 SF
Include In Available: No
Unfinished Mezz: 0 SF
Include In Available: No
Possession: Now
Vacant: Yes
To Show: Call broker
Market/Submarket: CBD
APN#: 5192-017-002

Listing Company: Dorin Realty Company
Agents: [Mark Whitman 213-627-0007](mailto:mwhitman@dorinrealty.com)
Listing #: 42318543
Notes: All details must be verified. Additional 275 amps, 220 volts, 1 phase service. Racking may be available.

Listing Date: 04/07/2025

FTCF: CB250Y175S000



Mark Whitman
mwhitman@dorinrealty.com
213-627-0007

AIRCRE Powered by **MOODY'S**

3628 Noakes Street, Los Angeles, CA 90023

Noakes Street

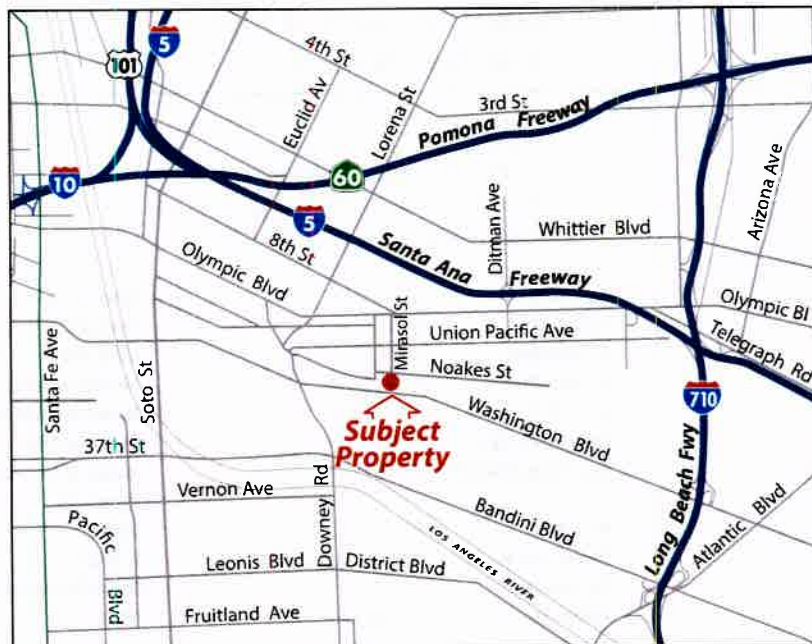
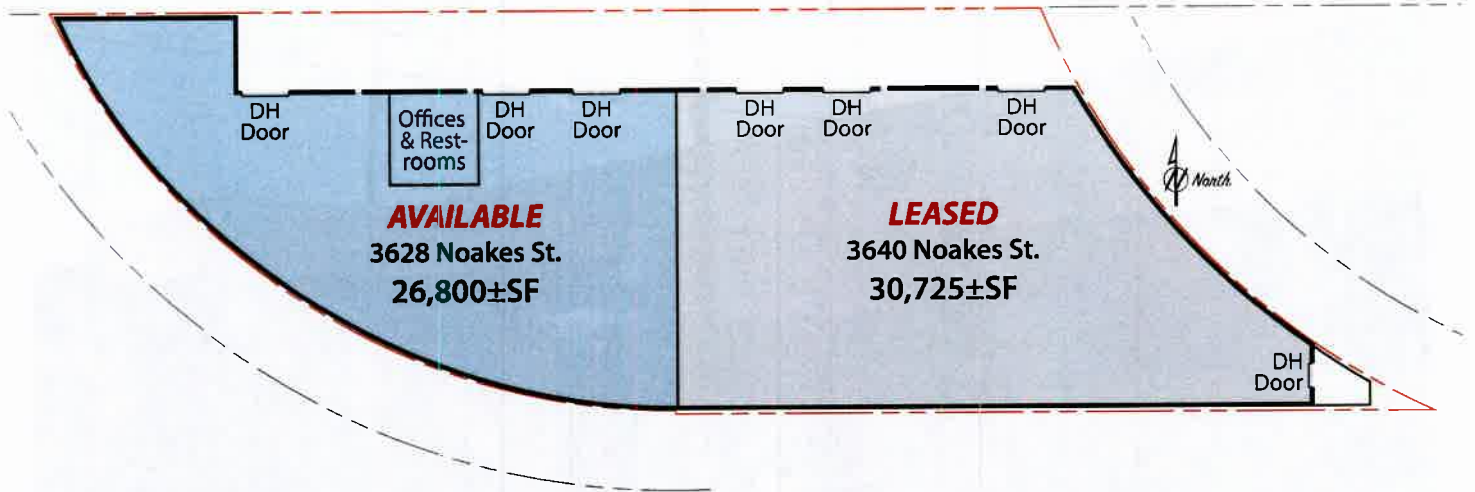

Contact exclusive agent:

Mark Whitman

Lic. No. 00918875

mwhitman@dorinrealty.com

213-627-0007 Ext 124

4555 Pacific Blvd., Vernon, CA 90058-2207

Industrial and Commercial Real Estate Specialists
Since 1959

www.dorinrealty.com

The information contained herein is from sources we believe to be reliable but, we do not guarantee its accuracy. All measurements & dimensions are approximations and are not to scale. Clients are encouraged to verify their accuracy.