

**Watt Plaza - North Tower**  
**1875 Century Park East**  
**Los Angeles, CA 90067**

**Sublease**  
**Available**

### Space Profile

<b>Premises</b>	22nd Floor/Office #9 with one secretarial bay, large corner office
<b>Rental Rate</b>	Call for pricing
<b>Availability</b>	90 days. Temporary corner office available immediately
<b>Term</b>	1-6 years
<b>Parking</b>	Available through Tenant's allocation at prevailing building rates

### Features

- Corner office with spectacular Northern upper floor views of golf course
- Brand new finishes throughout suite (improvements completed in 2023)
- Shared use of fully stocked kitchen, two (2) full-height glass conference rooms with state-of-the-art video conferencing capabilities and reception area
- Internet, VoIP phone system and copy/printing available
- Workstation adjacent to private office available for additional cost
- Beautifully remodeled Watt Plaza common areas and lobby

### Administrative Bay



### For More Information

**Jeffrey D. Mintz**

213.430.2458 direct | 310.739.9306 mobile

[jmintz@cresa.com](mailto:jmintz@cresa.com)

BRE# 00756938

Even though obtained from sources deemed reliable, no warranty or representation, express or implied, is made as to the accuracy of the information herein, and it is subject to errors, omissions, change of price, rental or other conditions, withdrawal without notice, and to any special listing conditions imposed by our principals.



555 South Flower Street, Suite 4650, Los Angeles, CA 90071

### Conference Room



**22nd Floor**

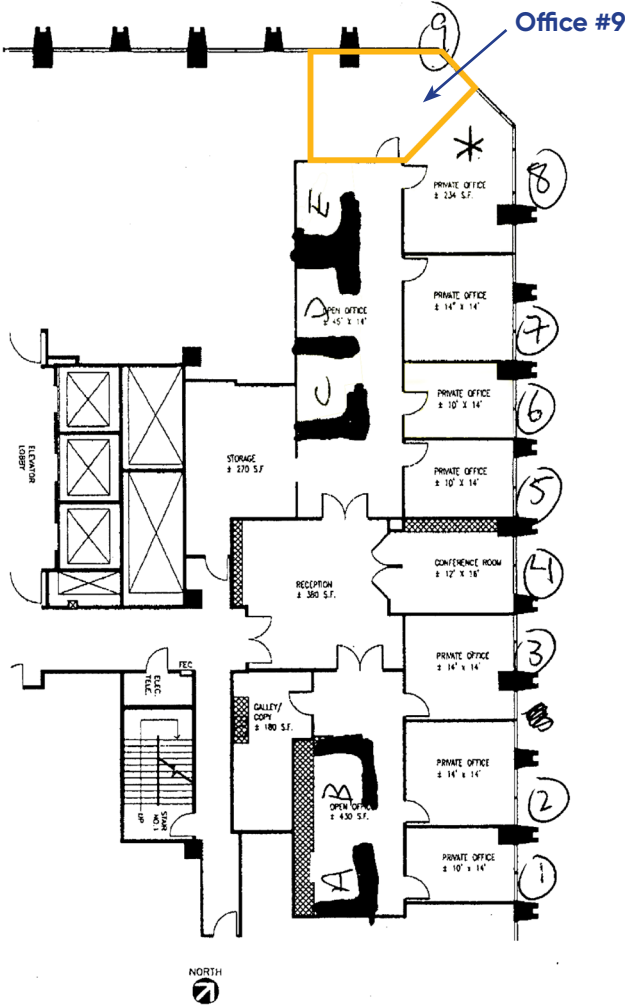

**For More Information**

**Jeffrey D. Mintz**  
 213.430.2458 direct  
 310.739.9306 mobile  
 jmintz@cresa.com  
 BRE# 00756938