

3600 SOUTH BLVD | SUITE 325 | +4,201 SFTHE STATION <sup>AT</sup>  
LoSo

## PROJECT DETAILS:

- 2,000 SF fitness center and locker rooms, featuring Peloton bikes
- Operable windows throughout
- Indoor-outdoor workspace on every floor
- 70-person training room with private terrace
- Located at the Scaleybark Light Rail Stop and Charlotte Rail Trail
- LEED Silver and Fitwell Healthy Building Design Certified



STATION 4

GETTING HERE IS EASY

THE STATION AT  
LoSo



LOCATED ON SOUTH BOULEVARD STEPS FROM THE SCALEY PARK LIGHT RAIL STATION



GETTING TO THE STATION AT LOSO, GETTING HERE IS EASY BY CAR, LIGHT RAIL OR VIA BIKE (THE RAIL TRAIL)

SURROUNDING AMENITIES

ON-SITE RETAIL:



**HIVE FITNESS**

**BREWERS AT 4001 YANCEY CLT**

**Queen Park SOCIAL**

**OMG**

**RALLY**

**LOWER LEFT CO BREWING**

**Sugar Creek BREWING COMPANY**

**PROTAGONIST BEER**

**CROSSFIT MECKLENBURG**

**Gilde**

**RED CLAY**

**THE EVERYDAY Market**

**YAMA**

**PHAS BURRITO**

**SUPPERCLUB SOUTHWEST**

**STATE OF CONFUSION**

**BURR & BERRY Coffee**

**MOCCO BISTRO**

**TONY'S PIZZA**

**KUNGFUTEA**

**ANYTIME FITNESS**

**Goldie's**

**SEOUL BOWL**

**Jersey Mike's SUBS**

THIRD FLOOR: SUITE 325 | 4,201 SF



**SUITE 325**  
**4,201 RSF**

← south charlotte/  
woodlawn road

south boulevard

uptown →

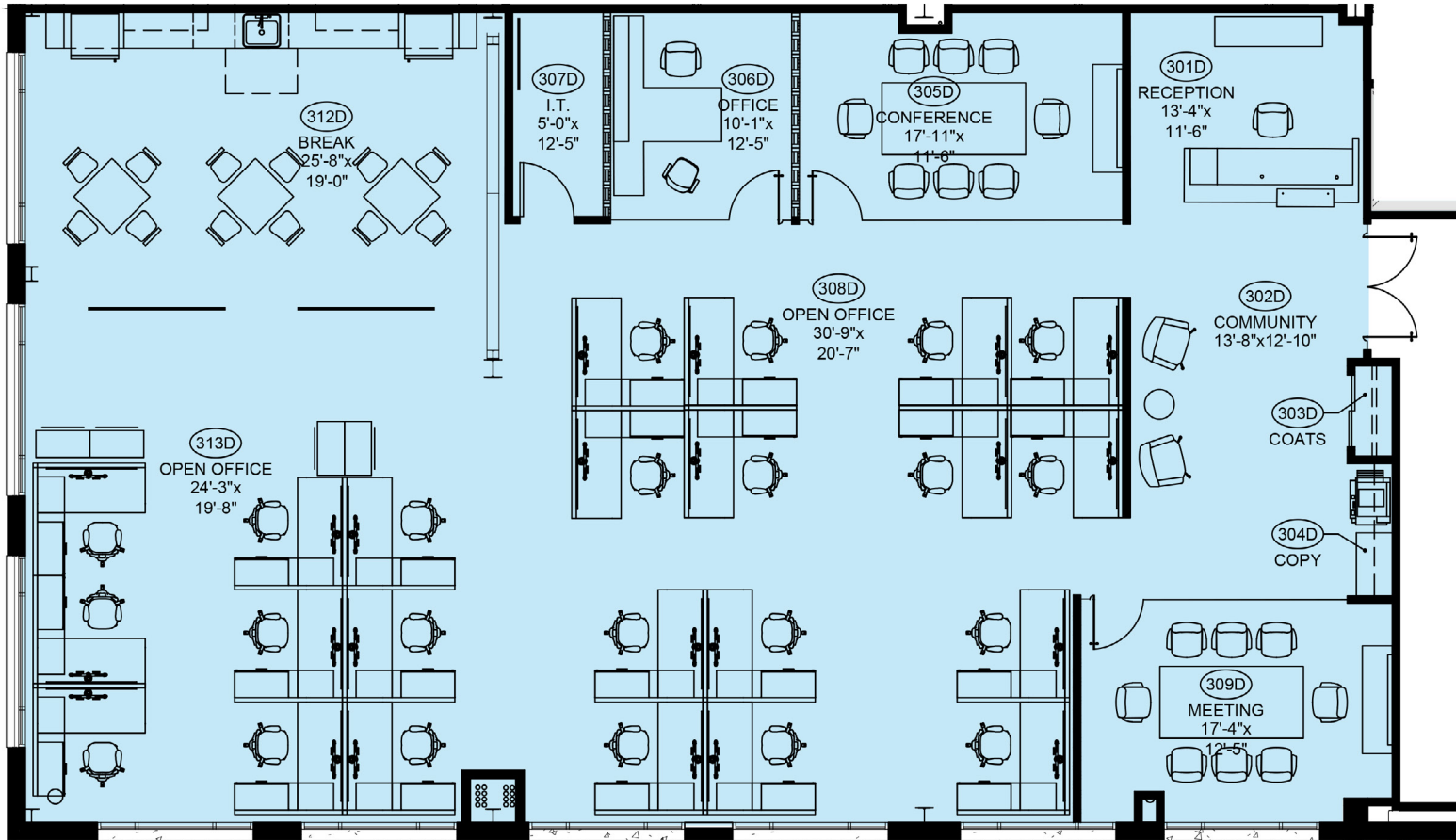

← south charlotte/  
woodlawn road

south boulevard

uptown →

THE STATION AT

LOSO

**OFFICE**

**Beacon Partners**

**Erin Shaw**

Managing Director | Office Investments

704.926.1414

[erin@beacondevelopment.com](mailto:erin@beacondevelopment.com)

**Claire Shealy**

Associate | Office

704.926.1409

[claire@beacondevelopment.com](mailto:claire@beacondevelopment.com)

[thestationatloso.com](http://thestationatloso.com)

**RETAIL**

**Thrift Commercial  
Real Estate Services**

Charles Thrift

704.622.1795

[charles@thriftcres.com](mailto:charles@thriftcres.com)

[thriftcres.com](http://thriftcres.com)

Beacon Partners is a Carolina-based real estate firm specializing in the development, acquisition, and operation of industrial, office and mixed-use properties.



[beacondevelopment.com](http://beacondevelopment.com)