

NEW RETAIL FOR LEASE

2025 Delivery



ENCINO PLACE

16101 Ventura Blvd, Encino, CA 91436



Jones Lang LaSalle Brokerage, Inc. | CA License #01856260

THIS IS THE PLACE

Encino Place is in the heart of the vibrant Encino neighborhood. Ideal for fitness, restaurant and beauty.

Encino Place Customer Base (within 3 miles):

- \$156,723 - Average Household Income
- \$1.2 Million - Average Home Value
- 153,323 - Daytime Population
- \$3.1 Billion - Retail Spending

Property Highlights:

- Prominent corner location with high visibility along Ventura Boulevard
- Situated amongst LA's most affluent communities
- Multimillion-dollar modern & refreshed exterior renovations coming Q1 2025
- Tremendous opportunity to establish retail and restaurant presence
- Customizable size configurations for small, medium and large tenants
- Abundant onsite parking within subterranean garage with over 500 stalls



1,500 to 15,000 SF Available

RENTALIZED LOOK

Completing Q1 2025



Strong co-tenancy

Michelin Star Sushi by Scratch

Scratch Pasta

Scratch Bar

California Pizza Kitchen

Coffee Bean



SITE PLANS

Floor 1

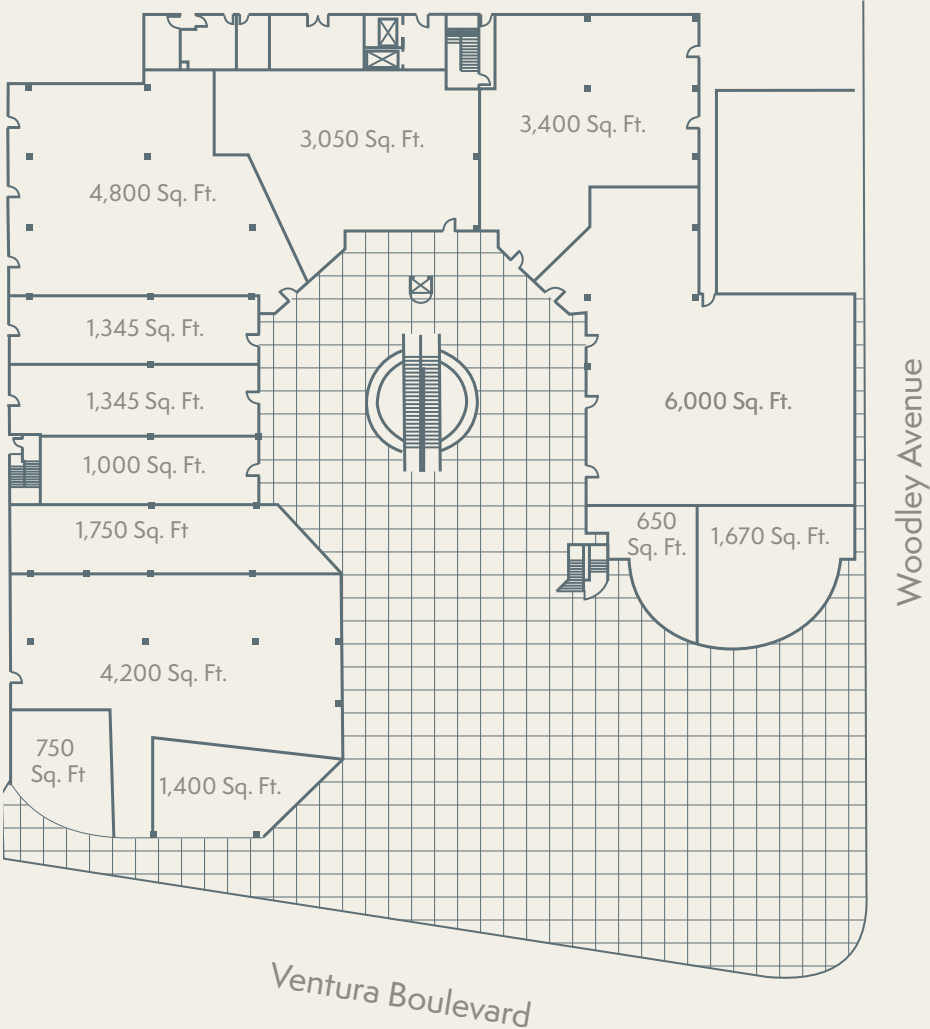

Floor 2

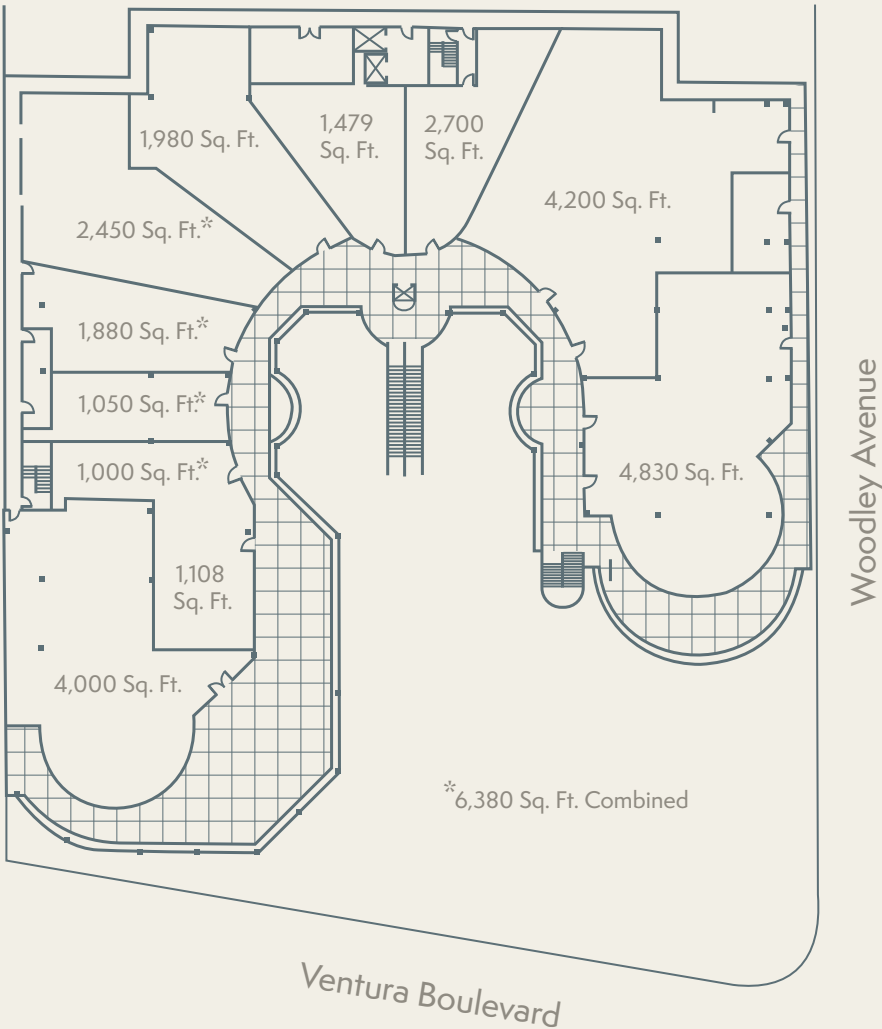



ENCINO PLACE

Ventura Boulevard
41,972 Cars Per Day

NOTABLE NEIGHBORS

- | | | |
|---|--|--|
| 1. Encino Courtyard
-Western Bagel
-Target
-Crumb
-Shake Shack
-Pressed Juicery
-Planet Fitness | 8. Maria's Italian Kitchen | 15. Benihana |
| 2. Coral Tree Cafe | 9. Sushi KATSU-YA | 16. Davenport's Restaurant |
| 3. Buca di Beppo | 10. Gelson's Encino | 17. California Chicken Cafe |
| 4. Versailles Restaurant | 11. Encino Marketplace
-Solidcore
-Sweetgreen
-See's Candies
-Sweet Lady Jane
-Amazon Fresh | 18. Le Pain Quotidien |
| 5. Mulberry Street Pizzeria | 12. Mendocino Farms | 19. Sherman Oaks Galleria
-Ben & Jerry's
-Burke Williams Spa
-Frida Mexican Cuisine
-P.F. Chang's
-The Cheesecake Factory |
| 6. Equinox Encino | 13. Claudine Artisan Kitchen & Bakeshop | |
| 7. Drybar | 14. Sadaf Restaurant | |



Matthew Fainchtein

Managing Director
matthew.fainchtein@jll.com
+1 310 430 2548
CA Lic. # 01503546

Ryan Hawley

Vice President
ryan.hawley@jll.com
+1 213 393-3300
CA Lic. # 02146998

Natalie V. Wagner, CCIM

Executive Vice President
natalie@lockehouse.com
+1 (805) 232 4550
CA Lic. # 01868161

Dennis Borowsky

Senior Vice President
dborowsky@lockehouse.com
+1 (949) 922 6506
CA Lic. # 00882780

ENCINO PLACE

16101 Ventura Blvd, Encino, CA 91436



Although information has been obtained from sources deemed reliable, neither Owner nor JLL makes any guarantees, warranties or representations, express or implied, as to the completeness or accuracy as to the information contained herein. Any projections, opinions, assumptions or estimates used are for example only. There may be differences between projected and actual results, and those differences may be material. The Property may be withdrawn without notice. Neither Owner nor JLL accepts any liability for any loss or damage suffered by any party resulting from reliance on this information. If the recipient of this information has signed a confidentiality agreement regarding this matter, this information is subject to the terms of that agreement. © 2024 Jones Lang LaSalle IP, Inc. All rights reserved.