

# FOR LEASE OFFICE SUITES



## 3201 Airpark | Santa Maria, CA

Quality office suite available at a well-maintained, desirable location adjacent to the Santa Maria Airport. Plenty of parking, and utilities are included.

Jerry Schmidt

805.928.2800 ext. 107

Jerry@PacificaCRE.com

Lic #0095042

Pat Palangi

805.928.2800 ext. 105

Pat@PacificaCRE.com

Lic #01105680

Mike Kelly

805.928.2800 ext. 113

Mike@PacificaCRE.com

Lic #01800988

PO Box 250 | Santa Maria, CA 93456 | [PacificaCommercialRealty.com](http://PacificaCommercialRealty.com)



Information contained herein has been obtained from the owner of the property or from other sources deemed reliable. We have no reason to doubt its accuracy, but we do not guarantee it.



# FOR LEASE 3201 Airpark, Santa Maria, CA



## Lease & Property Details:

- Lease Rate: \$1.95/SF/Mo, FSG
- Suite 205: +/-1,550 SF
- Suite 106: +/-1,581 SF
- Zoning: CPO
- Utilities and janitorial included
- Ample parking in two lots
- Multiple common area restrooms
- Elevator-served
- Tenant pays for its own phone/internet/IT service

# FOR LEASE 3201 Airpark, Santa Maria, CA

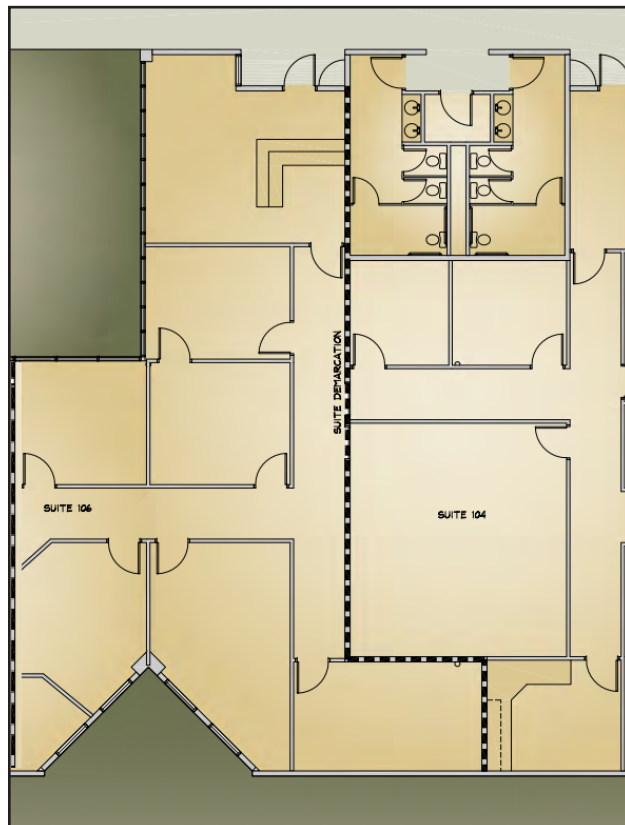

**Suite 106**  
**+/-1,581 SF**

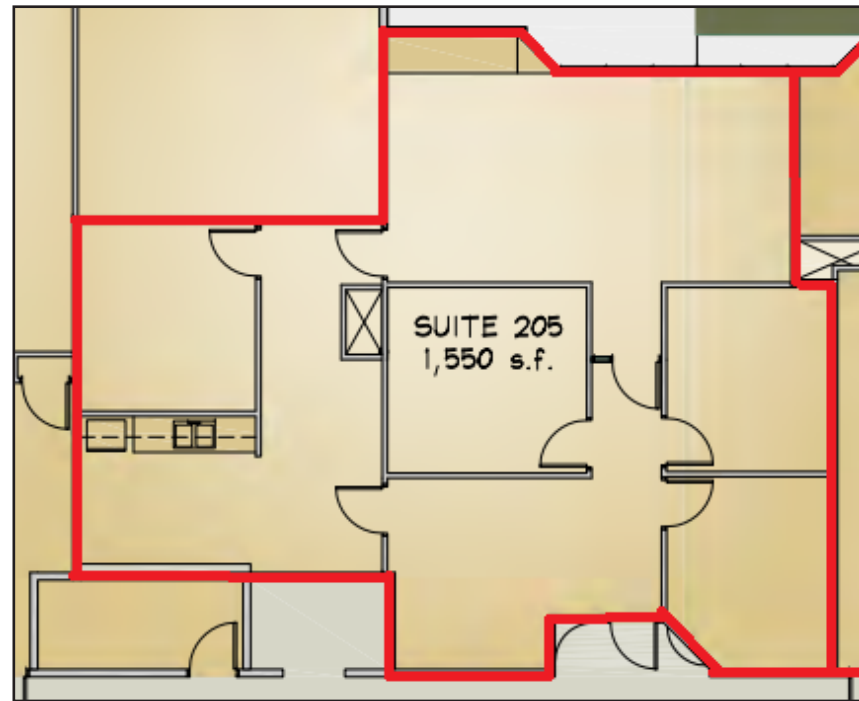

**Suite 205**  
**+/-1,550 SF**



Jerry Schmidt  
805.928.2800 ext. 107  
Jerry@PacificaCRE.com  
Lic #0095042

Pat Palangi  
805.928.2800 ext. 105  
Pat@PacificaCRE.com  
Lic #01105680

Mike Kelly  
805.928.2800 ext. 113  
Mike@PacificaCRE.com  
Lic #01800988

PO Box 250 | Santa Maria, CA 93456 | [PacificaCommercialRealty.com](http://PacificaCommercialRealty.com)

Information contained herein has been obtained from the owner of the property or from other sources deemed reliable. We have no reason to doubt its accuracy, but we do not guarantee it.



# FOR LEASE 3201 Airpark, Santa Maria, CA

