

FOR SUBLEASE

# TAYLORSVILLE OFFICE



## PROPERTY DETAILS

4548 SOUTH ATHERTON DRIVE, SUITES 220 & 230  
TAYLORSVILLE, UT 84123

- Great sublease office space available immediately
- Under market rents
- Approximately 3,890 SF (could be subdivided)
- Furniture negotiable
- Great space with a conference room, seven offices, small break room and large training area/cubical space
- Lease end date: February 28, 2029
- Lease rate: \$16/SF, full service

## 2024 DEMOS



### EST. POPULATION

1 MILE » 17,332  
3 MILE » 145,487  
5 MILE » 399,834



### EST. HOUSEHOLDS

1 MILE » 6,743  
3 MILE » 53,841  
5 MILE » 149,205



### EST. AVERAGE HH INCOME

1 MILE » \$87,031  
3 MILE » \$102,753  
5 MILE » \$109,286



**MOUNTAIN WEST**  
COMMERCIAL REAL ESTATE

## BRIEONA PAPPAS

bpappas@mwcre.com  
direct 801.556.5377  
[View Profile](#)

**FULL SERVICE  
COMMERCIAL REAL ESTATE**  
312 East South Temple  
Salt Lake City, UT 84111  
Office 801.456.8800  
[www.mwcre.com](http://www.mwcre.com)

# FLOOR PLAN

# TAYLORSVILLE OFFICE

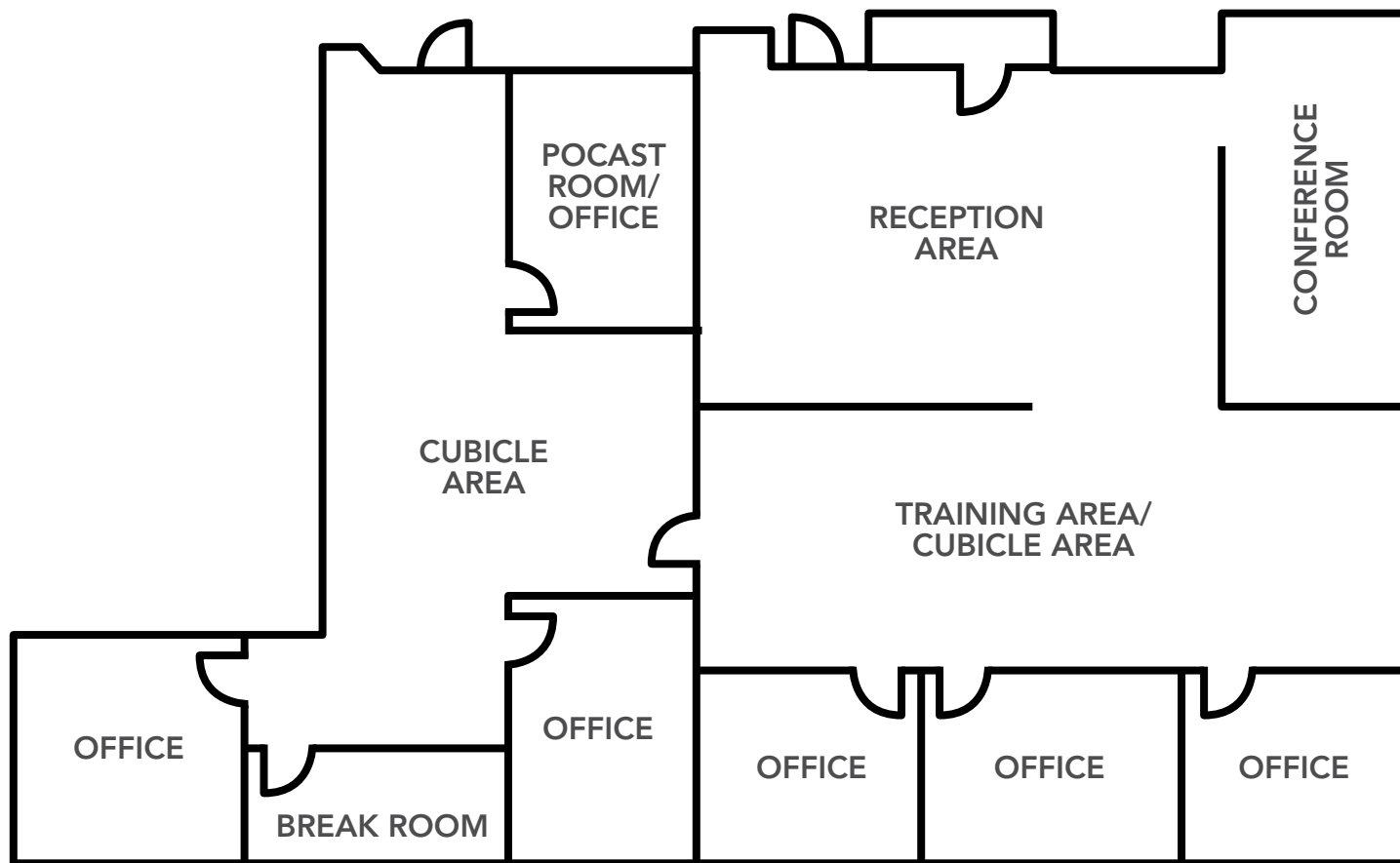

Not to Scale



**MOUNTAIN WEST**  
COMMERCIAL REAL ESTATE

**BRIEONA PAPPAS**

[bpappas@mwcre.com](mailto:bpappas@mwcre.com)

direct 801.556.5377

[View Profile](#)

**FULL SERVICE  
COMMERCIAL REAL ESTATE**

312 East South Temple

Salt Lake City, UT 84111

Office 801.456.8800

[www.mwcre.com](http://www.mwcre.com)





**MOUNTAIN WEST**  
COMMERCIAL REAL ESTATE

**BRIEONA PAPPAS**

bpappas@mwcre.com

direct 801.556.5377

[View Profile](#)



**FULL SERVICE  
COMMERCIAL REAL ESTATE**

312 East South Temple

Salt Lake City, UT 84111

Office 801.456.8800

[www.mwcre.com](http://www.mwcre.com)





**MOUNTAIN WEST**  
COMMERCIAL REAL ESTATE

**BRIEONA PAPPAS**

bpappas@mwcre.com

direct 801.556.5377

[View Profile](#)

**FULL SERVICE  
COMMERCIAL REAL ESTATE**

312 East South Temple

Salt Lake City, UT 84111

Office 801.456.8800

[www.mwcre.com](http://www.mwcre.com)