

Edenvale Shopping Center

RESTAURANT / RETAIL SPACE FOR LEASE

Property Highlights

- + ±2,999 SF Available for Lease
- + Former restaurant space
- + Anchored by Mercado California, Autozone
- + \$2.50 PSF NNN - NNN's :
- + Easy Access to Hwys 101 & 87 and Blossom Hill Road
- + Abundant Parking
- + High Traffic Area - 37,000+ ADT

Contact Us

Marie Anderson
Vice President
+1 408 453 7468
marie.anderson@cbre.com
Lic. 00919144

Terence Fox
Senior Associate
+1 408 453 7477
terence.fox@cbre.com
Lic. 02068798

5316 Monterey Road
San Jose, CA 95111
www.cbre.com



Interior Photos



© 2024 CBRE, Inc. All rights reserved. This information has been obtained from sources believed reliable, but has not been verified for accuracy or completeness. You should conduct a careful, independent investigation of the property and verify all information. Any reliance on this information is solely at your own risk. CBRE and the CBRE logo are service marks of CBRE, Inc. All other marks displayed on this document are the property of their respective owners, and the use of such logos does not imply any affiliation with or endorsement of CBRE. Photos herein are the property of their respective owners. Use of these images without the express written consent of the owner is prohibited.

Property Photos



© 2024 CBRE, Inc. All rights reserved. This information has been obtained from sources believed reliable, but has not been verified for accuracy or completeness. You should conduct a careful, independent investigation of the property and verify all information. Any reliance on this information is solely at your own risk. CBRE and the CBRE logo are service marks of CBRE, Inc. All other marks displayed on this document are the property of their respective owners, and the use of such logos does not imply any affiliation with or endorsement of CBRE. Photos herein are the property of their respective owners. Use of these images without the express written consent of the owner is prohibited.

Floor & Site Plan

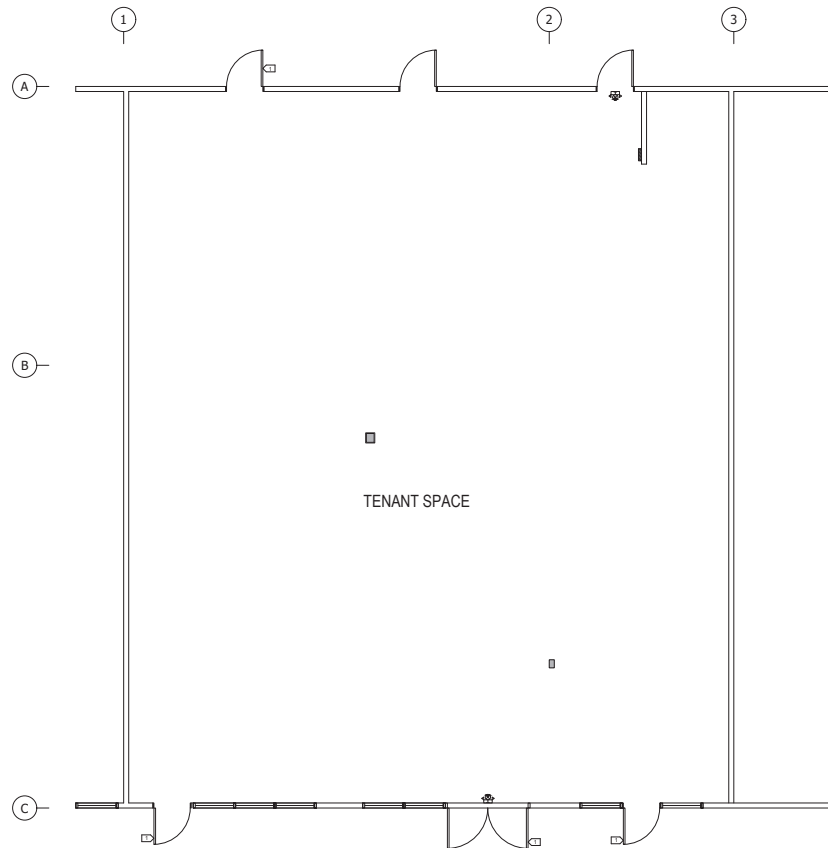

FLOOR PLAN

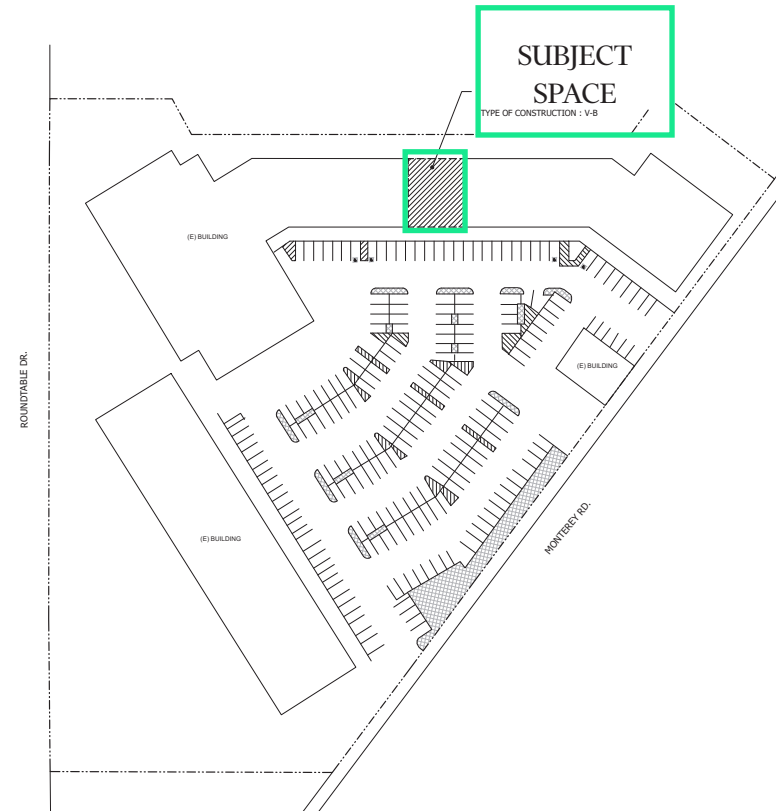

SITE PLAN

© 2024 CBRE, Inc. All rights reserved. This information has been obtained from sources believed reliable, but has not been verified for accuracy or completeness. You should conduct a careful, independent investigation of the property and verify all information. Any reliance on this information is solely at your own risk. CBRE and the CBRE logo are service marks of CBRE, Inc. All other marks displayed on this document are the property of their respective owners, and the use of such logos does not imply any affiliation with or endorsement of CBRE. Photos herein are the property of their respective owners. Use of these images without the express written consent of the owner is prohibited.

Aerial Map & Demographics



2024 Demographics	1 mile	3 miles
2024 Population - Current Year Estimate	32,127	172,797
2024 Households - Current Year Estimate	9,912	53,863
2024 Average Household Income	\$141,625	\$181,027
2024 Housing Units	10,408	56,704

© 2024 CBRE, Inc. All rights reserved. This information has been obtained from sources believed reliable, but has not been verified for accuracy or completeness. You should conduct a careful, independent investigation of the property and verify all information. Any reliance on this information is solely at your own risk. CBRE and the CBRE logo are service marks of CBRE, Inc. All other marks displayed on this document are the property of their respective owners, and the use of such logos does not imply any affiliation with or endorsement of CBRE. Photos herein are the property of their respective owners. Use of these images without the express written consent of the owner is prohibited.

EDENVALE SHOPPING CENTER

5316 Monterey Rd, San Jose, CA

For Lease

Amenities Map



Contact Us

Marie Anderson

Vice President
+1 408 453 7468
marie.anderson@cbre.com
Lic. 00919144

Terence Fox

Senior Associate
+1 408 453 7477
terence.fox@cbre.com
Lic. 02068798

CBRE