



565

Great Northern Way

// 6th Floor

THE OPPORTUNITY

565 Great Northern Way

A full-floor office on Great Northern Way designed for focused work and easy collaboration. The space balances open work areas with well-sized meeting rooms, breakout spaces, and a generous kitchen and lounge that supports how teams actually use the office day to day. Available as a full-floor sublease or in a shared configuration, with capacity for 30+ desks.

Unit	6th Floor
Area	20,891 SF
Availability	30 days' notice
Term Expiry	January 30, 2029
Basic Rent	Contact agents
Additional Rent	\$22.25 PSFPA (2025)



FLOOR PLAN

6th Floor | 20,891 SF

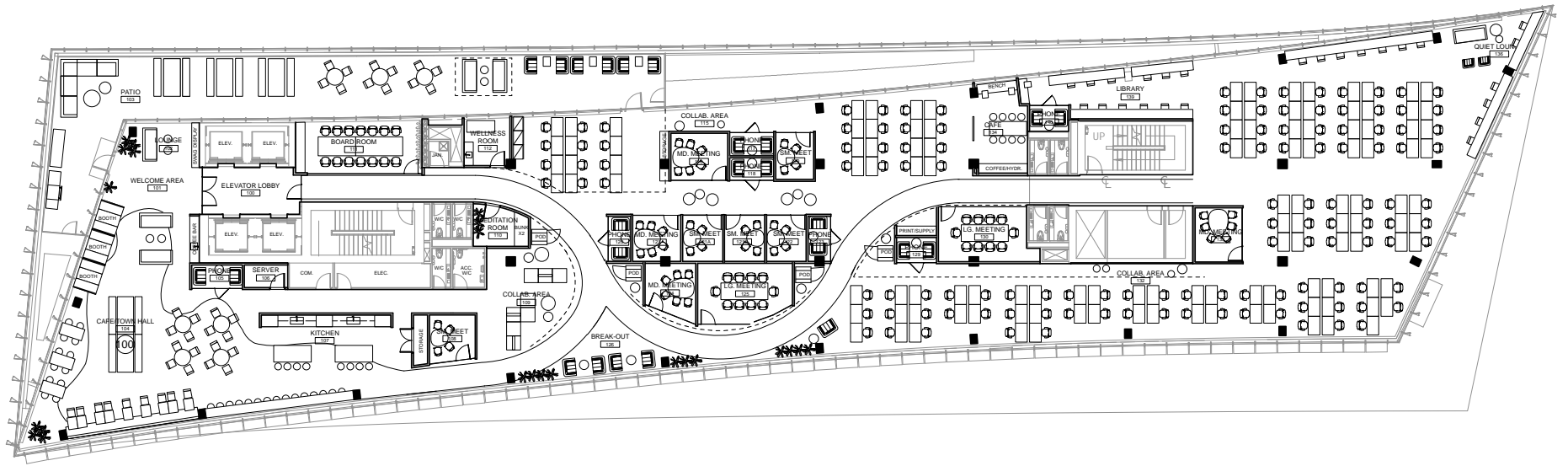



THE BUILDING

A modern, well-managed office building with excellent amenities.

Owned and managed by Low Tide Properties, with a long-term, tenant-first approach.

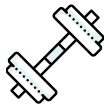

LARGE
GYM



CHANGE
ROOM



SHARED
ROOFTOP
PATIO



ROOFTOP
MEETING
ROOM



ON-SITE
PARKING



LEED GOLD
CERTIFIED



TRANSIT
FRIENDLY



BICYCLE
FRIENDLY



Shared Rooftop Patio



Rooftop Meeting Room



MEET THE NEIGHBOURS

1. Steve's Poké Bar
2. Nemesis Coffee GNW
3. Beta 5 Chocolates
4. Red Truck Beer Company
5. Emily Carr University
6. Kafka's Coffee Roasting and Bakery
7. The Hive Bouldering Gym
8. Starbucks
9. Earnest Ice Cream
10. Craft Beer Market
11. Science World
12. 1933 Liquor Co.
13. Vancouver Community College
14. Centre for Digital Media
15. China Creek North Park

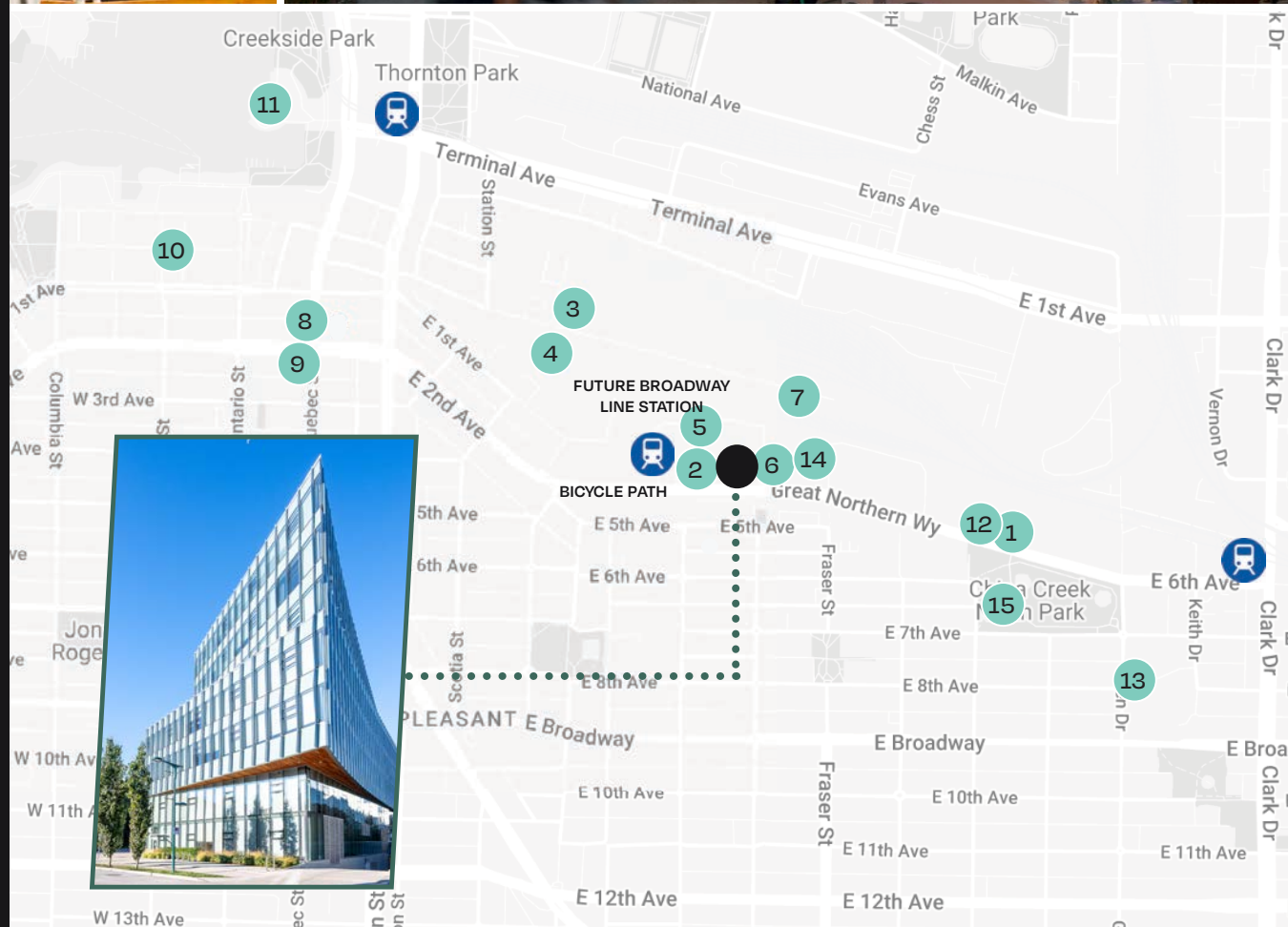



For more information, please contact:



Kelsey Stanger

SENIOR ASSOCIATE

+1 778 877-5445

KELSEY@FLOORSPACE.CA



Matt Carlson

Personal Real Estate Corporation

EXECUTIVE MANAGING DIRECTOR

+1 604 328-4603

MATT@FLOORSPACE.CA

Suite 520 - 900 West Hastings
Vancouver, BC Canada V6E 1E5

FLOORSPACE.CA

This document has been prepared by Floorspace Commercial Inc. for advertising and general information only. All information contained herein is from sources we deem reliable, and we have no reason to doubt its accuracy; however, no guarantee or responsibility is assumed thereof, and it shall not form any part of future contracts. Property information is submitted subject to errors and omissions and all information should be carefully verified. Any interested party should undertake their own inquiries as to the accuracy of the information. All measurements quoted herein are approximate. This publication is the copyrighted property of Floorspace Commercial Inc. and/or its licensor(s). Copyright © 2025 Floorspace Commercial Inc.

