



7333 W. 38th Avenue
Wheat Ridge, CO 80033

WEST 38



Restaurant Users Wanted
Hot emerging urban location
Ground floor retail in luxury apartment complex

3,612 SF AVAILABLE
Lease Rate: Contact Broker for Pricing
NNN: \$14.00/SF (Estimated)

This document has been prepared by Colliers for advertising purposes only. The information contained herein has been obtained from sources we deem reliable. While we have no reason to doubt its accuracy, no warranty or representation is made of the foregoing information. Terms of sale or lease and availability are subject to change or withdrawal without notice.



Colliers
4643 S. Ulster Street | Suite 1000
Denver, CO 80237
303 745 5800
colliers.com/denver

Lisa Vela
303 565 3788
lisa.vela@colliers.com

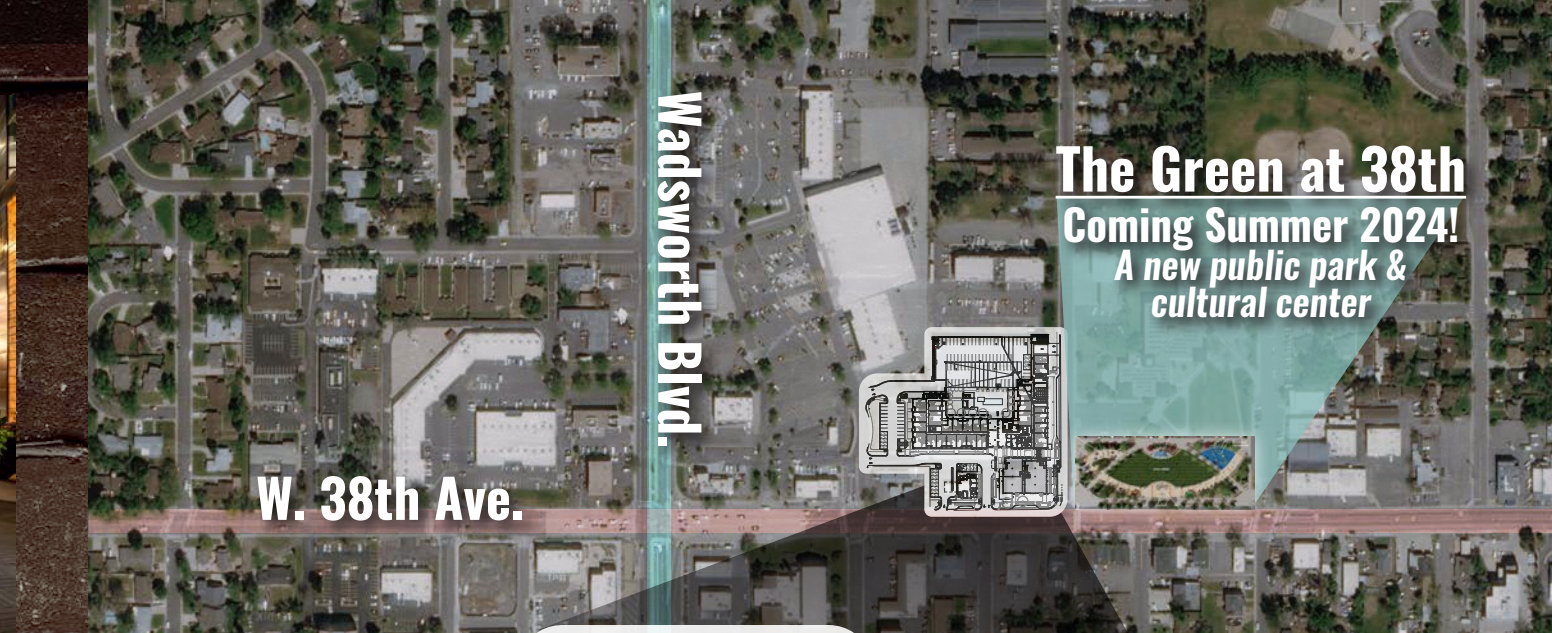

Jay Landt
303 283 4569
jay.landt@colliers.com

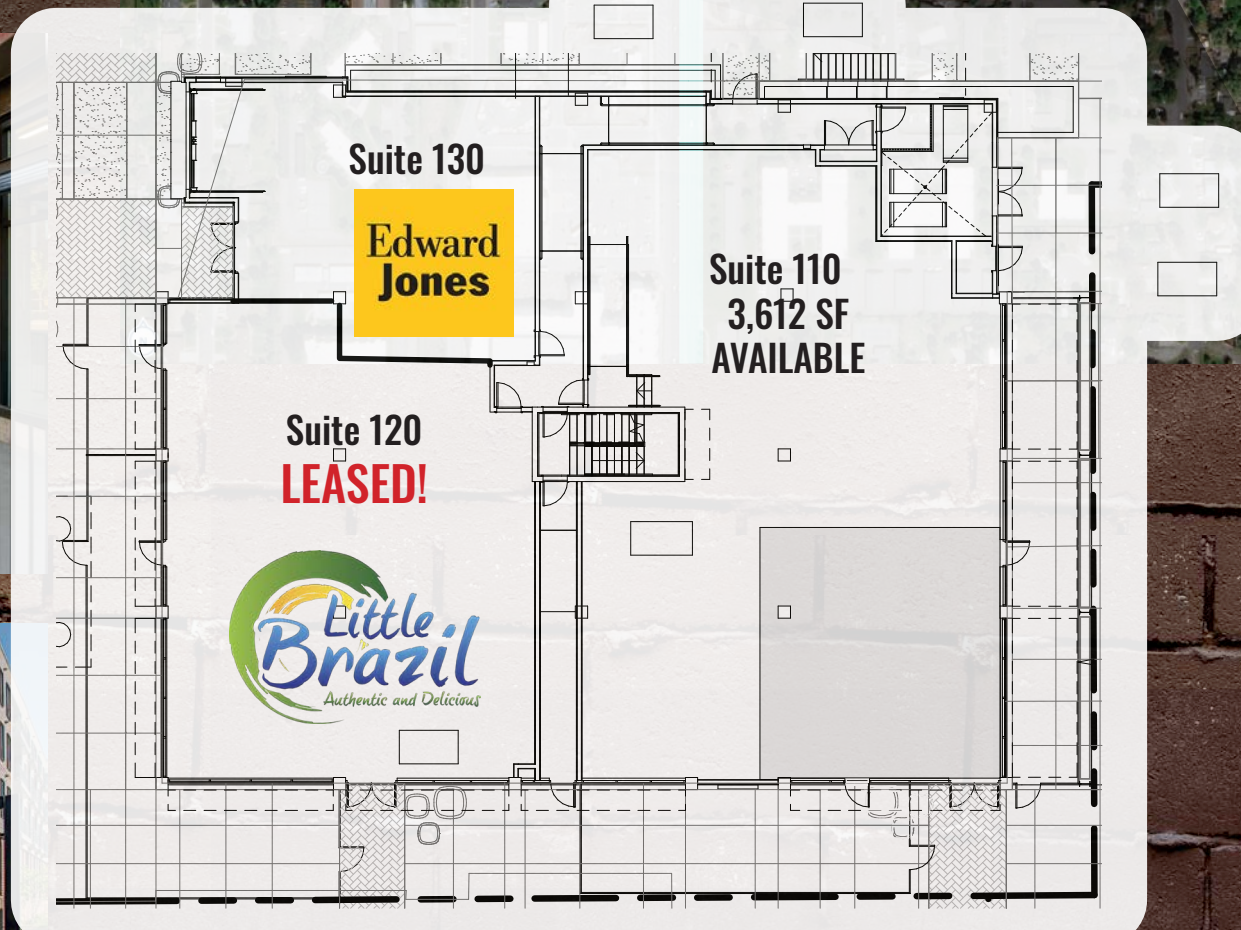

The Green at 38th
Coming Summer 2024!
A new public park & cultural center

Ground floor retail/restaurant space
 in luxury 165-unit apartment building



-  **Located**
 in the emerging 38th Avenue corridor in Wheat Ridge. Next to The Green at 38 - a new public park and cultural center coming soon!
-  **Underserved**
 retail market
-  **Grease**
 trap & hood chase are in place

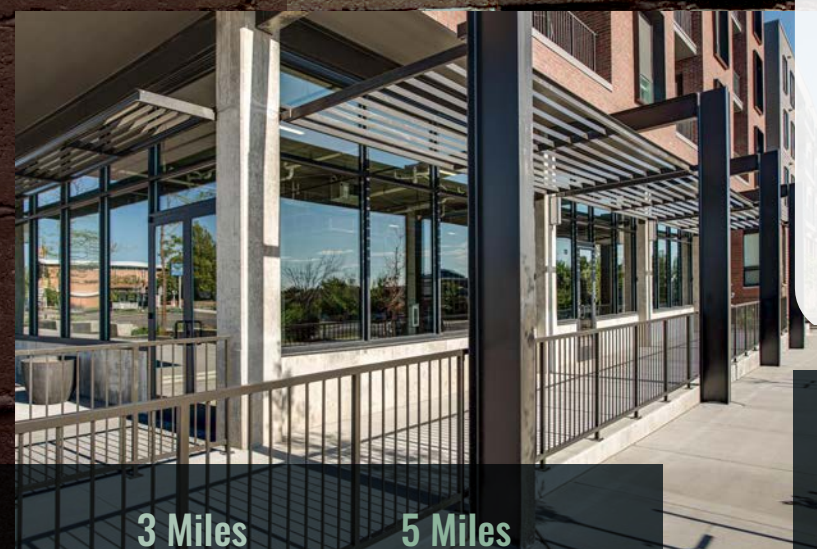

Demographics



	1 Mile	3 Miles	5 Miles
2023 Total Population	14,073	137,947	374,403
2023 Total Daytime Population	14,673	124,954	431,511
Average Household Income	\$105,387	\$110,192	\$115,158

Source: Esri 2023 estimates

Traffic Counts



W. 38th Ave.		Wadsworth Blvd.	
West of Upham St.	17,518 VPD	North of W. 38th Ave.	41,310 VPD
East of Upham St.	16,460 VPD	South of W. 38th Ave.	39,314 VPD

Source: MPSI 2022 estimates